

ORGANIZATIONAL AND DIRECT SUPPORT MAINTENANCE
REPAIR PARTS AND SPECIAL TOOLS LIST

FOR

RADIO SET, AN/PRC-132
(NSN 5820-01-320-8831) (EIC:N/A)

Distribution authorized to the Department of Defense and DOD contractors only for official use or for administrative or operational purposes. This determination was made on 15 December 1991. Other requests for this document will be referred to Commander, US Army Communications-Electronics Command and Fort Monmouth, ATTN: AMSEL-LC-LM-LT, Fort Monmouth, New Jersey 07703-5007.

DESTRUCTION NOTICE - Destroy by any method that will prevent disclosure of contents or reconstruction of the document.

HEADQUARTERS, DEPARTMENT OF THE ARMY
15 AUGUST 1993

Technical Manual
 No. 11-5820-1102-23P

HEADQUARTERS
 DEPARTMENT OF THE ARMY
 Washington, DC, 15 August 1993

ORGANIZATIONAL AND DIRECT SUPPORT MAINTENANCE
 REPAIR PARTS AND SPECIAL TOOLS LIST
 FOR
 RADIO SET, AN/PRC-132
 (NSN: 5820-01-320-8831) (EIC: N/A)

Current as of 15 May 1993

REPORTING ERRORS AND RECOMMENDING IMPROVEMENTS

You can help improve this manual. If you find any mistakes, or if you know of a way to improve the procedures, please let us know. Mail your letter, DA Form 2028 (Recommended Changes to Publications and Blank Forms) or DA Form 2028-2 located in back of this manual direct to: Commander, US Army Communications-Electronics Command and Fort Monmouth, ATTN: AMSEL-LC-LM-LT, Fort Monmouth, New Jersey 07703-5007.

In either case a reply will be furnished direct to you.

TABLE OF CONTENTS

		Page		Illus/ Figure
Section I	INTRODUCTION	1		
Section II	REPAIR PARTS LIST	1-1		
Group 00	AN/PRC-132 Radio Set	1-1		1
Group 01	RT-1648/PRC-132	2-1		2
	0101 Radio Final Assembly	3-1		3
	010101 Control Panel Cover Assembly	4-1		4
	010102 Rear Panel Cover Assembly	5-1		5
	010103 Housing Assembly	6-1		6
	01010301 Power Amp, A13 (No parts breakdown at this level)			
	010104 Chassis Assembly	7-1		7
	01010401 Processor Board Assembly, A1 (No part breakdown at this level)			
	01010402 1st LO Board Assembly, A2 (No parts breakdown at this level)			
	01010403 2nd LO Board Assembly, A3 (No parts breakdown at this level)			
	01010404 RE Product Detector Board Assembly, A7 (No parts breakdown at this level)			

TABLE OF CONTENTS - Continued

	Page	Illus/ Figure
01010405 2nd IF Board Assembly, A8 (No parts breakdown at this level)		
01010406 1st IF Board Assembly, A9 (No parts breakdown at this level)		
01010407 Mixer Board Assembly, A10 (No parts breakdown at this level)		
01010408 Filter 1-4 Board Assembly, A11 (No parts breakdown at this level)		
01010409 Filter 5-7 Board Assembly, A12 (No parts breakdown at this level)		
01010410 Interconnect Board Assembly, A14 (No parts breakdown at this level)		
01010411 Card Cage Assembly (No parts breakdown at this level)		
01010412 Control Panel Assembly (No parts breakdown at this level)		
0101041201 Front Panel Board Assembly, A16 (No parts breakdown at this level)		
Group 02 CY-8629/PRC-132	8-1	8
0201 Cover Assembly	9-1	9
0202 Housing	10-1	10
020201 CY PC Subassembly (No parts breakdown at this level)		
Section III SPECIAL TOOLS LIST (Not applicable)		
Section IV CROSS-REFERENCE INDEXES		
National Stock Number Index	I-1	
Part Number Index	I-2	
Figure and Item Number Index	I-4	

**CHAPTER 1
INTRODUCTION**

1. SCOPE

This manual lists and authorizes spares and repair parts; special tools; special test, measurement, and diagnostic equipment (TMDE); and other special support equipment required for the performance of organizational and direct support maintenance of Radio Set, AN/PRC-132. It authorizes the requisitions, issue, and disposition of spares, repair parts and special tools as indicated by the source, maintenance, and recoverability (SMR) codes.

2. GENERAL

This Repair Parts and Special Tools List is divided into the following sections:

a. *Section II. Repair Parts List.* A list of spares and repair parts authorized by this RPSTL for use in the performance of maintenance. This list also includes parts which must be removed for replacement of the authorized parts. Parts lists are composed of functional groups in ascending item number sequence, with the parts in each group listed in ascending item number sequence. Figure numbers are listed directly beneath the group header. Bulk materials are listed in item name sequence. Repair part kits are listed separately in their own functional group within Section II. Repair parts for reparable special tools are also listed in this section. Items listed are shown on the associated illustration.

b. *Section III. Special Tools List.* Not applicable.

c. *Section IV. Cross-Reference Indexes.* A list, in National item identification number (NIIN) sequence, of all National stock numbered items appearing in the listing, followed by a list in alphabetic sequence of all part numbers appearing in the listings. National stock numbers and part numbers are cross-referenced to each illustration figure and item number appearance. The figure number and item number index lists figure and item numbers in numeric sequence and cross-references National stock number, Commercial and Government Entity Code, and part numbers.

3. EXPLANATION OF COLUMNS (Section II and III)

a. *Item No. (Column (1)).* Indicates the number used to identify items called out in the illustrations.

b. *SMR Code (Column (2)).* The source, maintenance, and recoverability (SMR) code is a five-position code containing supply/requisitioning information, maintenance category authorization criteria and disposition instruction, as shown in the following breakout:

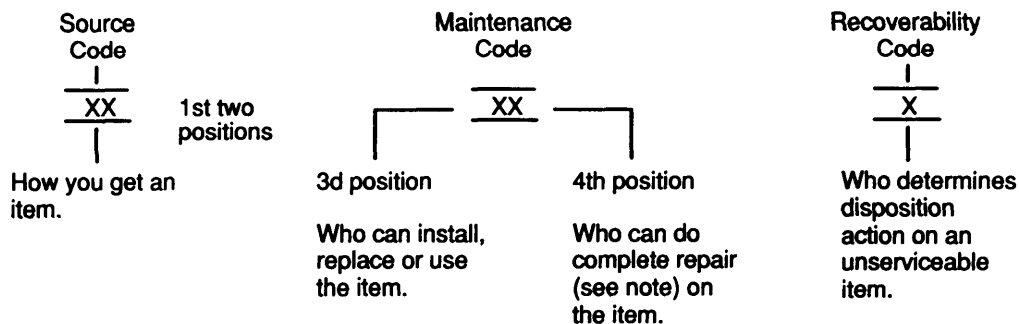

NOTE

Complete repair: Maintenance capacity, capability, and authority to perform all corrective maintenance tasks of the "repair" function in a use/user environment in order to restore serviceability to a failed item.

(1) *Source code.* The source code tells you how to get an item needed for maintenance, repair, or overhaul of an end item/equipment. Explanations of source codes follows:

Code

Explanation

PA
PB
PC
PD
PE
PF
PG

Stocked items: use the applicable NSN to request/requisition items with these source codes. They are authorized to the level indicated by the code entered in the third position of the SMR code.

NOTE

Items coded PC are subject to deterioration.

KD
KF
KB

Items with these codes are not to be requested/requisitioned individually. They are part of a kit which is authorized to the maintenance category indicated in the third position of the SMR code. The complete kit must be requisitioned and applied.

MO – Made at org/AVUM category
MF – Made at DS/AVIM category
MH – Made at GS category
ML – Made at Specialized Repair Activity (SRA)
MD – Made at Depot

Items with these codes are not to be requested/requisitioned individually. They must be made from bulk material which is identified by the part number in the description and usable on code (UOC) column and listed in the Bulk Material group of the repair parts list. If the item is authorized to you by the third position code of the SMR code, but the source code indicates it is made at a higher category, order the item from the higher category of maintenance.

AO – Assembled by org/AVUM category
AF – Assembled by DS/AVIM category
AH – Assembled by GS category
AL – Assembled by SRA
AD – Assembled by Depot

Items with these codes are not to be requested/requisitioned individually. The parts that make up the assembled item must be requisitioned or fabricated and assembled at the category of maintenance indicated by the source code. If the third position code of the SMR code authorizes you to replace the item, but the source code indicates the item is assembled at a higher category, order the item from the higher category of maintenance.

Code	Explanation
XA -	Do not requisition an "XA" coded item. Order its next higher assembly.
XB -	If an "XB" item is not available from salvage, order it using the CAGEC and part number given.
XC -	Installation drawing, diagram, instruction sheet, field service drawing, that is identified by manufacturer's part number
XD -	Item is not stocked. Order an "XD" coded item through normal supply channels using the CAGEC and part number given, if no NSN is available.

NOTE

Cannibalization or controlled exchange, when authorized, may be used as a source of supply for items with the above source codes, except for those source coded "XA" or those aircraft support items restricted by requirements of AR 750-1.

(2) Maintenance Code. Maintenance codes tell you the category of maintenance authorized to USE and REPAIR support items. The maintenance codes are entered in the third and fourth positions of the SMR code as follows:

(a) The maintenance code entered in the third position tells you the lowest maintenance category authorized to remove, replace, and use an item. The maintenance code entered in the third position will indicate authorization to one of the following categories of maintenance.

Code	Application/Explanation
-------------	--------------------------------

- | | |
|-----|---|
| C - | Crew or operator maintenance done within organizational or aviation maintenance. |
| O - | Organizational or aviation unit category can remove, replace, and use the item. |
| F - | Direct support or aviation intermediate category can remove, replace, and use the item. |
| H - | General support category can remove, replace, and use the item. |
| L - | Specialized repair activity can remove, replace, and use the item. |
| D - | Depot category can remove, replace, and use the item. |

(b) The maintenance code entered in the fourth position tells whether or not the item is to be repaired and identifies the lowest maintenance category with the capability to do complete repair (i.e., perform all authorized repair functions). This position will contain one of the following maintenance codes.

NOTE

Some limited repair may be done on the item at a lower category of maintenance, if authorized by the Maintenance Allocation Chart (MAC) and SMR codes.

Code	Explanation
-------------	--------------------

- | | |
|-----|---|
| O - | Organizational or aviation unit is the lowest category that can do complete repair of the item. |
| F - | Direct support or aviation intermediate is the lowest category that can do complete repair of the item. |
| H - | General support is the lowest category that can do complete repair of the item. |
| L - | Specialized repair activity (designate the specialized repair activity) is the lowest category that can do complete repair of the item. |
| D - | Depot is the lowest category that can do complete repair of the item. |
| Z - | Nonreparable. No repair is authorized. |
| B - | No repair is authorized. (No parts or special tools are assigned for the maintenance of a "B" coded |

item.) However, the item may be reconditioned by adjusting, lubricating, etc., at the user category.

(3) *Recoverability code.* Recoverability codes are assigned to items to indicate the disposition action on unserviceable items. The recoverability code is entered in the fifth position of the SMR code as follows:

Recoverability

Code Application/Explanation

- Z - Nonreparable item. When unserviceable, condemn and dispose of the item at the category of maintenance shown in the third position of SMR code.
- O - Repairable item. When uneconomically repairable, condemn and dispose of the item at organizational or aviation unit category.
- F - Repairable item. When uneconomically repairable, condemn and dispose of the item at direct support or aviation intermediate category.
- H - Repairable item. When uneconomically repairable, condemn and dispose of the item at general support category.
- D - Repairable item. When beyond lower category repair capability, return to depot. Condemnation and disposal of item not authorized below depot category.
- L - Repairable item. Condemnation and disposal not authorized below specialized repair activity (SRA).
- A - Item requires special handling or condemnation procedures because of specific reasons (e.g., precious metal content, high dollar value, critical material, or hazardous material. Refer to appropriate manuals/directives for specific instructions.

c. *CAGEC (Column (3)).* The Commercial and Government Entity Code (CAGEC) is a 5-digit numeric code which is used to identify the manufacturer, distributor, or Government agency, etc., that supplies the item.

d. *Part Number (Column (4)).* Indicates the primary number used by the manufacturer (individual, company, firm, corporation, or Government activity), which controls the design and characteristics of the item by means of its engineering drawings, specifications, standards, and inspection requirements to identify an item or range of items.

NOTE

When you use an NSN to requisition an item, the item you receive may have a different part number from the part ordered.

e. *Description and Useable on Code (UOC) (Column (5)).* This column includes the following information.

(1) The Federal item name and, when required, a minimum description to identify the item.

(2) The physical security classification of the item is indicated by the parenthetical entry (N/A) - Not Applicable.

(3) Items that are included in kits and sets are listed below the name of the kit or set.

(4) Spare/repair parts that make up an assembled item are listed immediately following the assembled item line entry.

(5) Part numbers for bulk materials are referenced in this column in the line entry for the item to be manufactured/fabricated.

(6) When the item is not used with all serial numbers of the same model, the effective serial

numbers are shown on the last line of the description (before UOC).

(7) Usable on code, when applicable (para 5).

f. *Qty (Column (6))*. Indicates the quantity of the item used in the breakout shown on the illustration figure, which is prepared for a functional group, subfunctional group, or an assembly. A "V" appearing in this column in lieu of a quantity indicates that the quantity is variable and the quantity may vary from application to application.

4. EXPLANATION OF COLUMNS (Section IV)

a. *National Stock Number (NSN) Index.*

(1) *Stock number column*. This column lists the NSN by National item identification number (NIIN) sequence. The NIIN consists of the last nine digits of the NSN. When using this column to locate an item, ignore the first four digits of the NSN. When requisitioning items use the complete NSN (13 digits) sequence.

(2) *Fig. column*. This column lists the number of the figure where the item is identified/located. The illustrations are in numerical sequence in sections II and III.

(3) *Item column*. The item number identifies the item associated with the figure listed in the adjacent Fig. column. This item is also identified by the NSN listed on the same line.

b. *Part Number Index*. Part numbers in this index are listed by part number in ascending alphameric sequence.

(1) *CAGEC column*. This column lists the Commercial and Government Entity Code (CAGEC).

(2) *Part number column*. This column indicates the part number assigned to the item.

(3) *Stock number column*. This column lists the National stock number for the associated part number and manufacturer identified in the part number and CAGEC columns to the left.

(4) *Fig. column*. This column lists the number of the figure where the item is identified/located in sections II and III.

(5) *Item column*. The item number is that number assigned to the item as it appears in the figure referenced in the adjacent figure number column.

c. *Figure and Item Number Index.*

(1) *Fig. column*. This column lists the number of the figure where the item is identified/located in sections II and III.

(2) *Item column*. The item number is that number assigned to the item as it appears in the figure referenced in the adjacent figure number column.

(3) *Stock number column*. This column lists the National stock number for the item.

(4) *CAGEC column*. The Commercial and Government Entity Code (CAGEC) is a 5-digit numeric code used to identify the manufacturer, distributor, or Government agency, etc., that supplies the item.

(5) *Part number column*. Indicates the primary number used by the manufacturer (individual, firm, corporation, or Government activity), which controls and the design and characteristics of the item by means of its engineering drawings, specifications, standards, and inspection requirements to identify

an item or range of items.

5. SPECIAL INFORMATION

a. *Fabrication Instructions.* Not applicable.

b. *Associated Publications.* The publications listed below pertain to the AN/PRC-132 and its components:

TM 11-5820-1102-12 Operator

TM 11-5820-1102-30 Direct Support Maintenance

c. *National Stock Numbers.* National stock numbers (NSN's) that are missing from P source coded items have been applied for and will be added to this TM by future change/revision when they are entered in the Army Master Data File (AMDF). Until the NSN's are established and published, submit exception requisitions to: Commander, US Army Communications-Electronics Command and Fort Monmouth, ATTN: AMSEL-LC-MM, Fort Monmouth, NJ 07703-5007 for the part required to support your equipment.

6. HOW TO LOCATE REPAIR PARTS

a. *When National stock number or part number is not known.*

(1) *First.* Using the table of contents, determine the assembly group or subassembly group to which the item belongs. This is necessary since figures are prepared for assembly groups and subassembly groups, and listings are divided into the same groups.

(2) *Second.* Find the figure covering the assembly group or subassembly group to which the item belongs.

(3) *Third.* Identify the item on the figure and note the item number.

(4) *Fourth.* Refer to the Repair Parts Lists for the figure to find the part number for the item number noted on the figure.

(5) *Fifth.* Refer to the Part Number Index to find the NSN, if assigned.

b. *When National stock number or part number is known.*

(1) *First.* Using the index of National stock numbers and part numbers, find the pertinent National stock number or part number. The NSN index is in National item identification number (NIIN) sequence (para 4a(1)). The part numbers in the part number index are listed in ascending alphameric sequence (para 4b). Both indexes cross-reference you to the illustration figure and item number of the item you are looking for.

(2) *Second.* After finding the figure and item number, verify that the item is the one you're looking for, then locate the item number in the repair parts list for the figure.

7. ABBREVIATIONS

Not applicable.

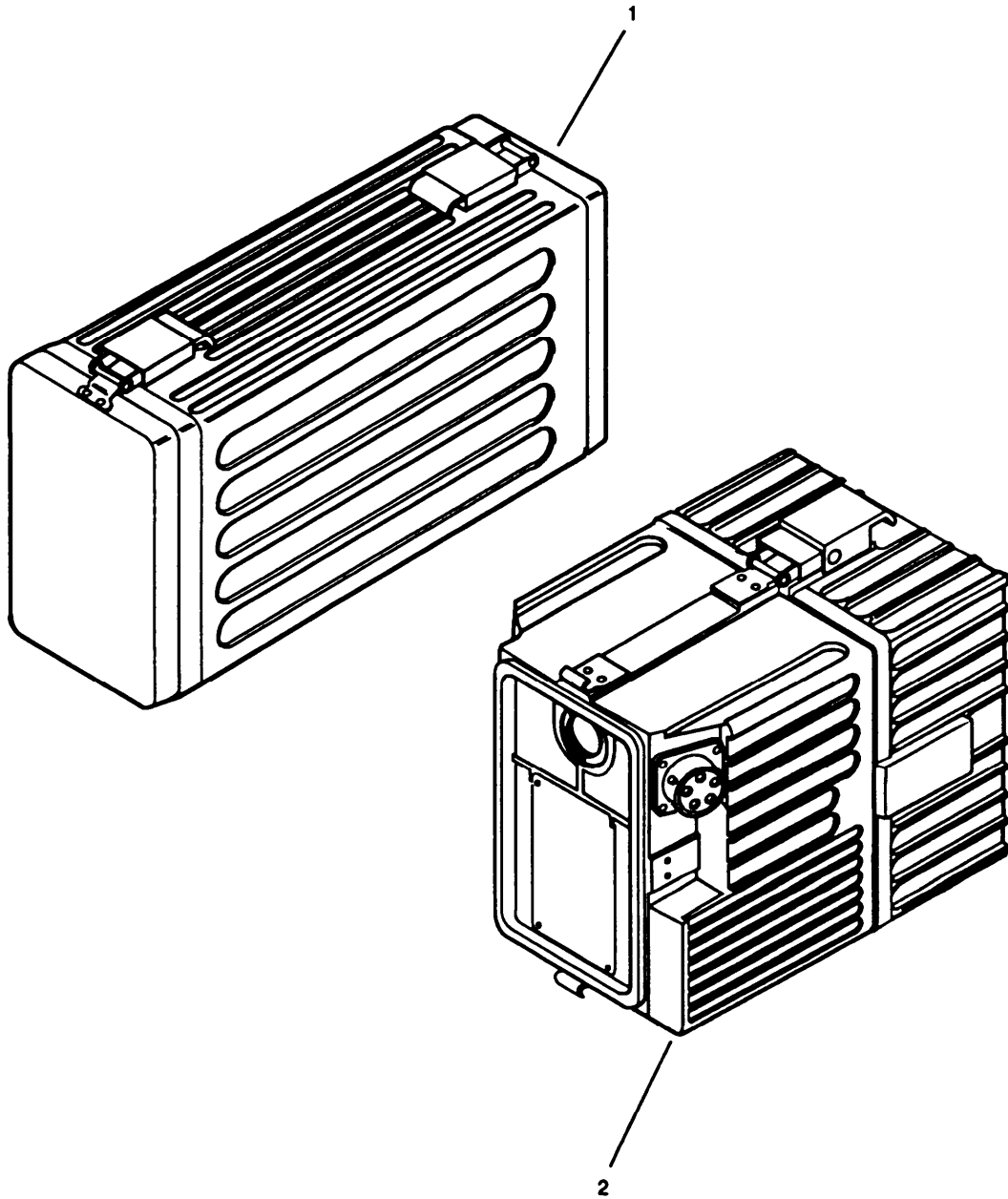

Figure 1. SOHFRAD Radio Set

(1) ITEM NO	(2) SMR CODE	(3) CAGEC	(4) PART NUMBER	(5) DESCRIPTION AND USABLE ON CODE (UOC)	(6) QTY
GROUP 00 AN/PRC-132 RADIO SET					
FIGURE 1					
1	PAODD	80058	RT-1648/PRC-132	RECEIVER-TRANSMITTE (SEE FIGURE 2 FOR BREAKDOWN)	1
2	PAODD	80058	CY-8629/PRC-132	BATTERY BOX (SEE FIGURE 8 FOR BREAKDOWN)	1
END OF FIGURE					

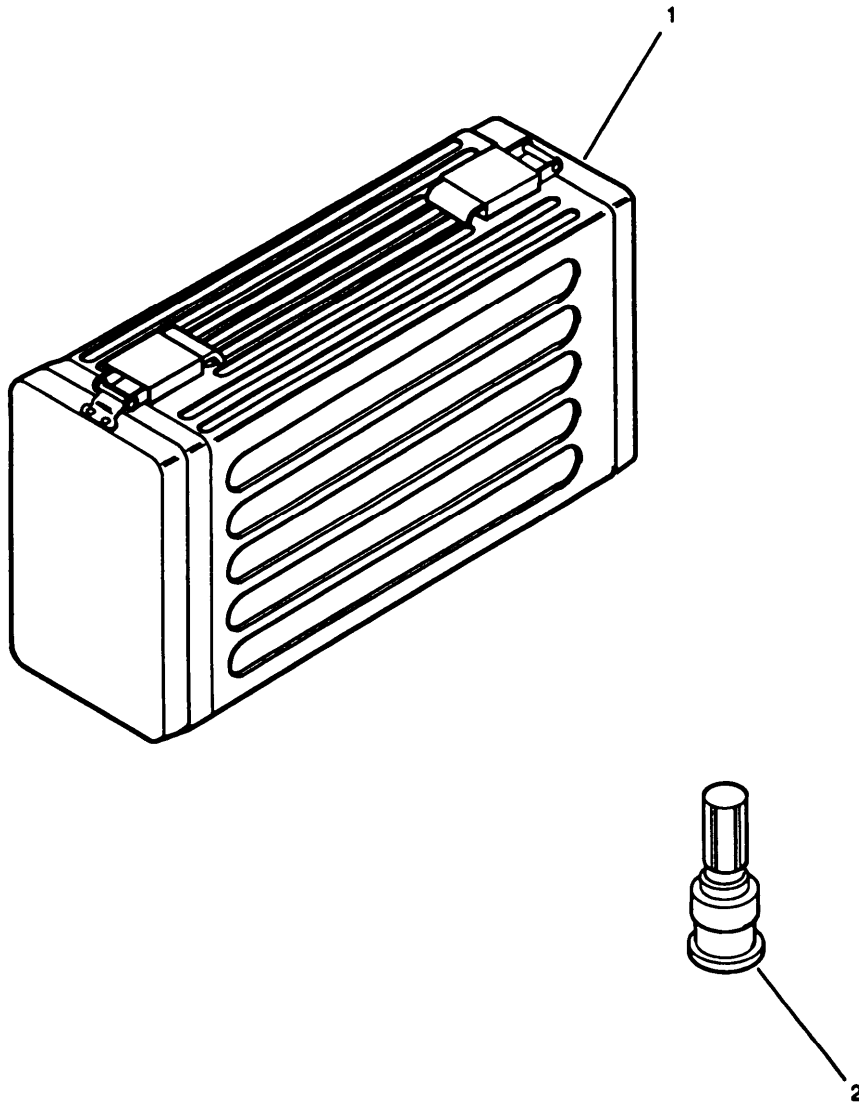

Figure 2. RT-1648/132 Receiver Transmitter

(1) ITEM NO	(2) SMR CODE	(3) CAGEC	(4) PART NUMBER	(5) DESCRIPTION AND USABLE ON CODE (UOC)	(6) QTY
				GROUP 01 RT-1648/PRC-132 RECEIVER TRANSMITTER	
				FIGURE 2	
1	XBODD	54296	994500-10	RECEIVER-TRANSMITTE (SEE FIGURE 3 FOR BREAKDOWN)	1
2	PAOZZ	54296	119-1007-001	POST, BINDING, ELECTR	1
				END OF FIGURE	

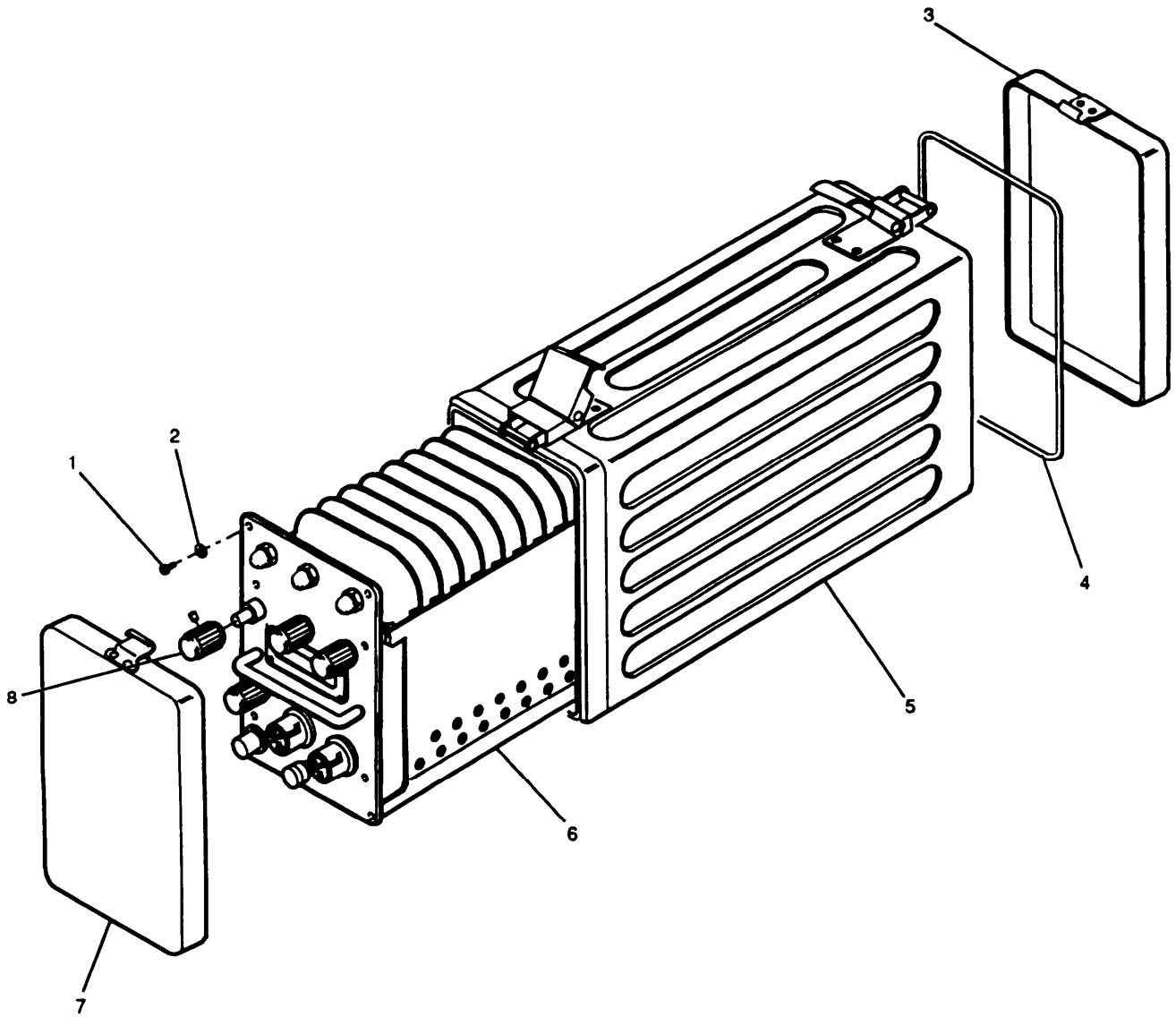

Figure 3. SOHFRAD Radio Final Assembly

(1) ITEM NO	(2) SMR CODE	(3) CAGEC	(4) PART NUMBER	(5) DESCRIPTION AND USABLE ON CODE (UOC)	(6) QTY
GROUP 0101 RADIO FINAL ASSEMBLY					
FIGURE 3					
1	PAOZZ	26136	HC440-6-SS-B	SCREW, CAP, SOCKET HE	4
2	PAOZA	02310	AB130E	PACKING, PREFORMED	4
3	XBFFF	54296	994529-10	PANEL ASSEMBLY REAR (SEE FIGURE 5 FOR BREAKDOWN)	1
4	PAOZZ	02697	H86009	SEAL, NONMETALLIC RO	1
5	XBFFD	54296	994517-10	CASE, ELECTRONIC COM (SEE FIGURE 6 FOR BREAKDOWN)	1
6	XBFFD	54296	994518-10	CHASSIS, ELECTRONIC- (SEE FIGURE 7 FOR BREAKDOWN)	1
7	XBFFF	54296	994519-10	COVER, ELECTRONIC CO (SEE FIGURE 4 FOR BREAKDOWN)	1
8	PAOZZ	95146	KN-500B-1/8	KNOB	4
END OF FIGURE					

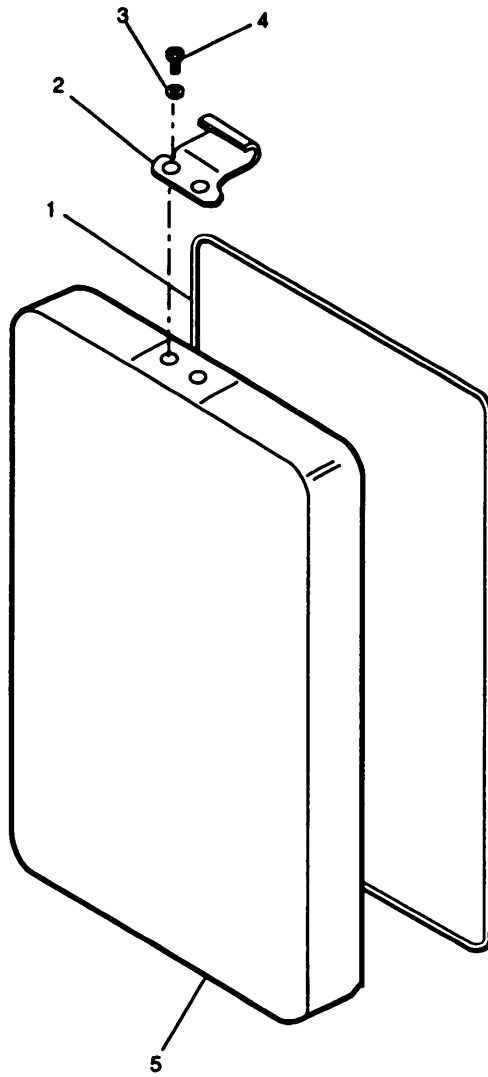

Figure 4. Control Panel Cover Assembly

(1) ITEM NO	(2) SMR CODE	(3) CAGEC	(4) PART NUMBER	(5) DESCRIPTION AND USABLE ON CODE (UOC)	(6) QTY
GROUP 010101 CONTROL PANEL COVER ASSEMBLY					
FIGURE 4					
1	PAOZZ	02697	H86009	SEAL, NONMETALLIC RO	1
2	PAFZA	98003	SB83314	STRIKE, CATCH	2
3	PAFZZ	54296	812038-01	WASHER, LOCK	4
4	PAFZZ	54296	810546-01	SCREW, MACHINE	4
5	PAFZZ	54296	823960-10	COVER, ACCESS	1

END OF FIGURE

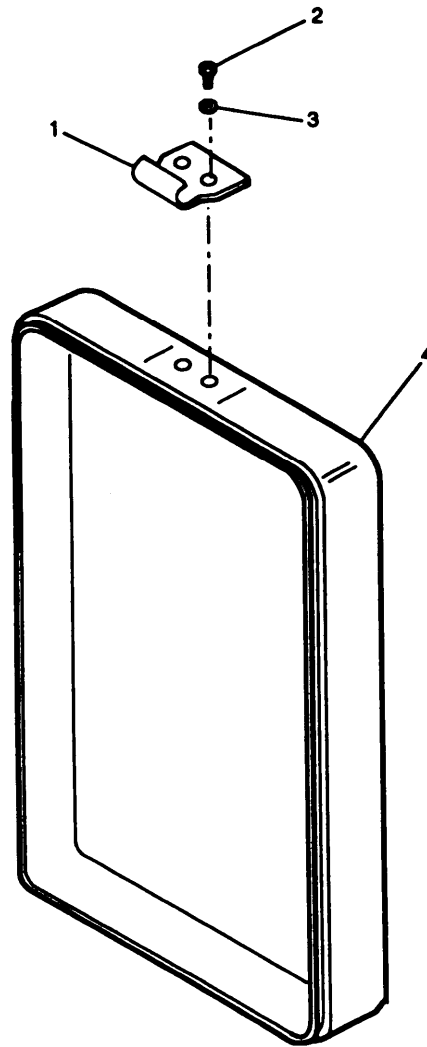

Figure 5. Rear Panel Cover Assembly

(1) ITEM NO	(2) SMR CODE	(3) CAGEC	(4) PART NUMBER	(5) DESCRIPTION AND USABLE ON CODE (UOC)	(6) QTY
-------------------	--------------------	--------------	-----------------------	---	------------

GROUP 010102 READ PANEL COVER
ASSEMBLY

FIGURE 5

1	PAFZA	98003	SB83314	STRIKE, CATCH	2
2	PAFZZ	54296	810546-01	SCREW, MACHINE	4
3	PAFZZ	54296	812038-01	WASHER, LOCK	4
4	PAFZZ	54296	823964-10	COVER, ACCESS	1

END OF FIGURE

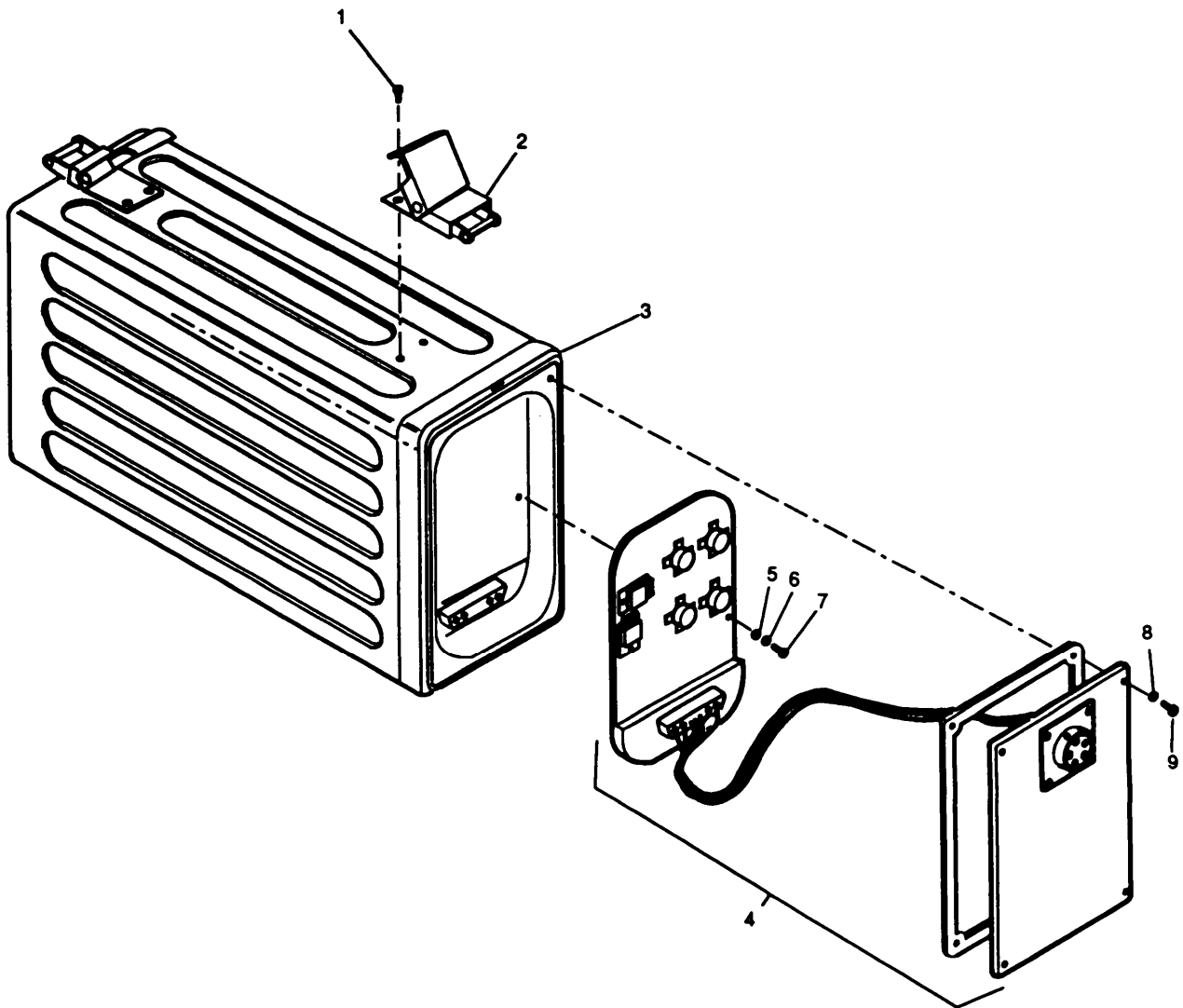

Precede all reference designators with A1

Figure 6. Housing Assembly

(1) ITEM NO	(2) SMR CODE	(3) CAGEC	(4) PART NUMBER	(5) DESCRIPTION AND USABLE ON CODE (UOC)	(6) QTY
-------------------	--------------------	--------------	-----------------------	---	------------

GROUP 010103 HOUSING ASSEMBLY

FIGURE 6

1	PAFZZ	96906	MS51957-14B	SCREW, MACHINE	8
2	PAFZZ	54296	821997-00	LATCH, RIM	4
3	XBFZZ	54296	434-0010-001	HOUSING, ELECTRICAL	1
4	PAFDD	54296	994513-10	CIRCUIT CARD ASSEMB	1
5	PAOZZ	80205	NAS620C4LP	WASHER, FLAT	4
6	PAOZZ	96906	MS35338-135B	WASHER, LOCK	12
7	PAFZZ	06540	6-32 X 3/8	SCREW, CAP SOCKET HE	3
8	PAFZA	02310	AB130E	PACKING, PREFORMED	4
9	PAOZZ	54296	810550-01	SCREW, CAP SOCKET HE	4

END OF FIGURE

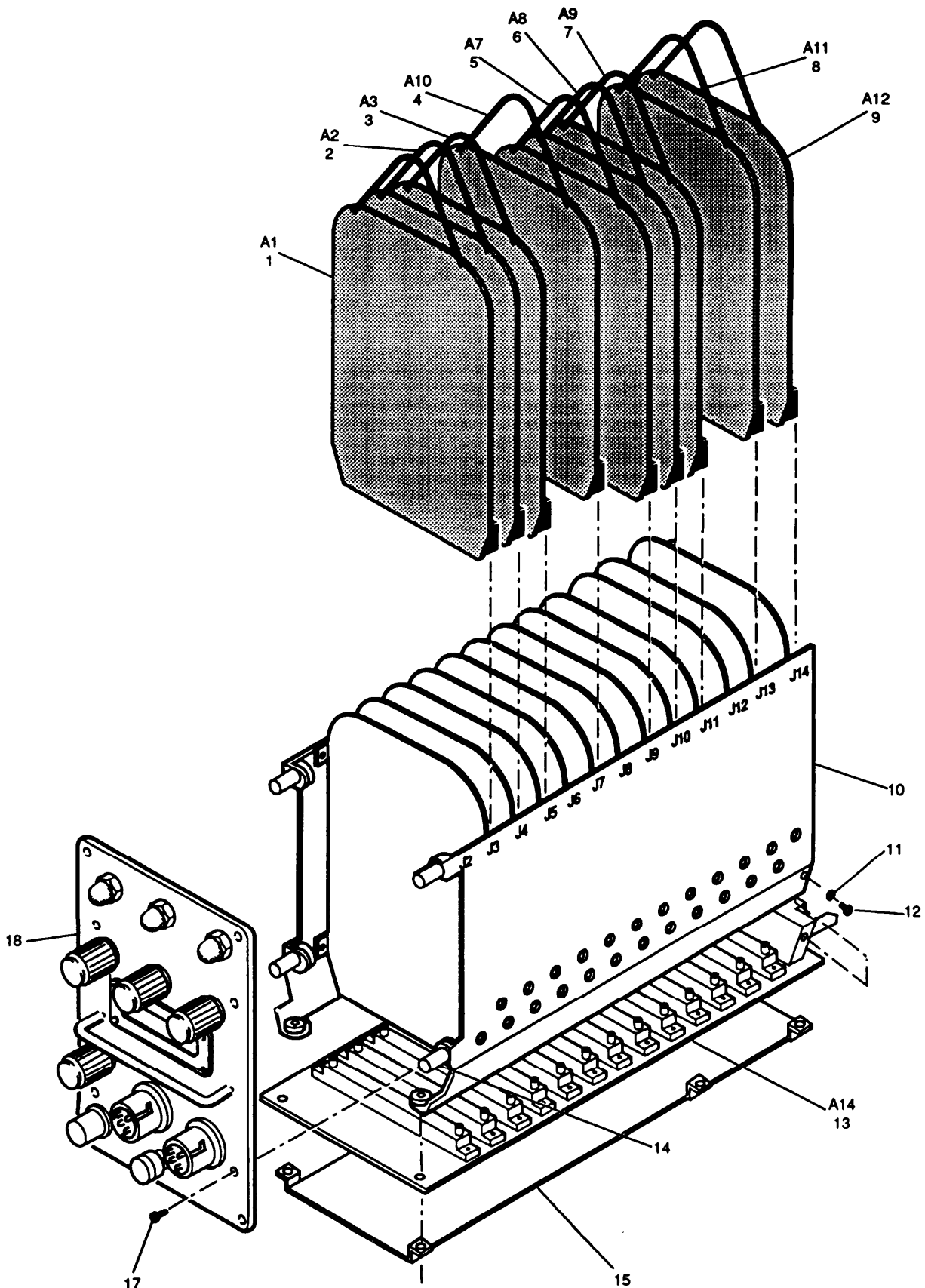

Precede all reference designators with A1

Figure 7. Radio Chassis Assembly

(1) ITEM NO	(2) SMR CODE	(3) CAGEC	(4) PART NUMBER	(5) DESCRIPTION AND USABLE ON CODE (UOC)	(6) QTY
GROUP 010104 RADIO CHASSIS ASSEMBLY					
FIGURE 7					
1	PAFDD	54296	994501-10	CIRCUIT CARD ASSEMB	1
2	PAFDD	54296	994502-10	CIRCUIT CARD ASSEMB	1
3	PAFDD	54296	994503-10	CIRCUIT CARD ASSEMB	1
4	PAFDD	54296	994510-10	CIRCUIT CARD ASSEMB	1
5	PAFDD	54296	994507-10	CIRCUIT CARD ASSEMB	1
6	PAFDD	54296	994508-10	CIRCUIT CARD ASSEMB	1
7	PAFDD	54296	994509-10	CIRCUIT CARD ASSEMB	1
8	PAFDD	54296	994511-10	CIRCUIT CARD ASSEMB	1
9	PAFDD	54296	994512-10	CIRCUIT CARD ASSEMB	1
10	XBFDD	54296	994521-10	HOLDER, PRINTED CIRC	1
11	PAFZZ	96906	MS35333-69	WASHER, LOCK	2
12	PAFZZ	96906	MS51957-2	SCREW, MACHINE	2
13	PAFDD	54296	994514-10	BACKPLANE ASSEMBLY	1
14	PAFZZ	51506	2020-H-SS-.547-1 2-HT	CAP, PROTECTIVE, DUST	4
15	PAFZZ	54296	823969-00	COVER, ACCESS	1
16	PAFZZ	54296	810551-01	SCREW, CAP, SOCKET HE	6
17	PAFZZ	02310	SNT50171C04E14	SCREW, MACHINE	4
18	PAFDD	54296	994522-10	PANEL, CONTROL, ELECT	1

END OF FIGURE

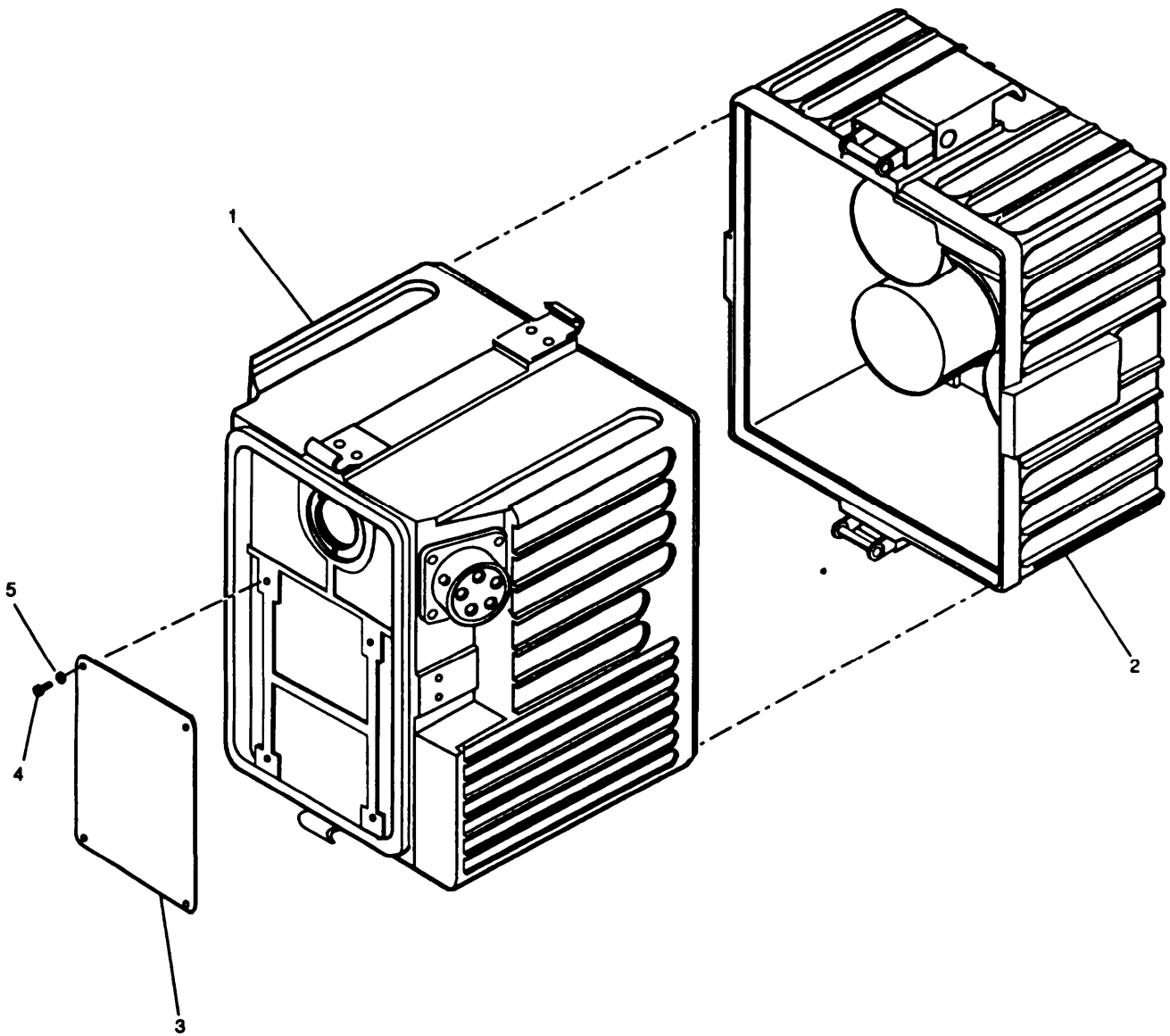

Figure 8. CY-8629/PRC-132 Battery Box

(1) ITEM NO	(2) SMR CODE	(3) CAGEC	(4) PART NUMBER	(5) DESCRIPTION AND USABLE ON CODE (UOC)	(6) QTY
GROUP 02 CY-8629/PRC-132					
BATTERY BOX					
FIGURE 8					
1	PAFFF	80063	A3155275	BATTERY POWER SUPPL (SEE FIGURE 10 FOR BREAKDOWN)	1
2	XBFFF	80063	A3155282	COVER ASSEMBLY (SEE FIGURE 9 FOR BREAKDOWN)	1
3	PAFZZ	54296	A3155292	PLATE, IDENTIFICATIO	1
4	PAFZZ	96906	MS21318-20	SCREW, DRIVE	4
5	PAFZZ	80205	NAS620C4	WASHER, FLAT	4
END OF FIGURE					

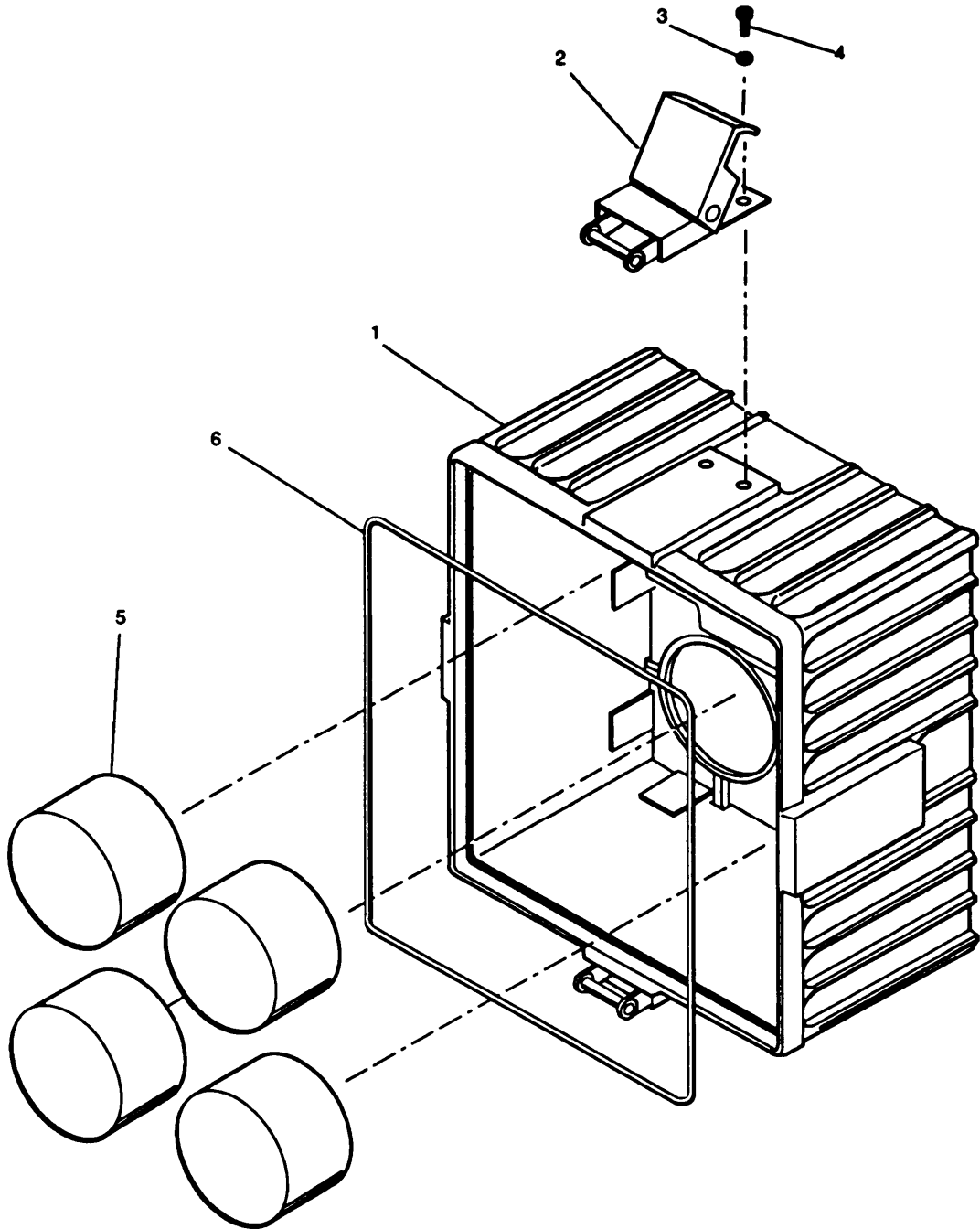

Figure 9. Battery Box Cover Assembly

(1) ITEM NO	(2) SMR CODE	(3) CAGEC	(4) PART NUMBER	(5) DESCRIPTION AND USABLE ON CODE (UOC)	(6) QTY
				GROUP 0201 BATTERY BOX COVER ASSEMBLY	
				FIGURE 9	
1	PAFZZ	54296	A3155283	COVER, ACCESS	1
2	PAFZZ	54296	A3155293	CATCH, CLAMPING	2
3	PAFZZ	96906	MS35338-135B	WASHER, LOCK	4
4	PAFZZ	96906	MS51957-14B	SCREW, MACHINE	4
5	PAFZZ	54296	A3155286	PAD, CUSHIONING	4
6	PAFZZ	96906	MS29513-163	PACKING, PREFORMED	1
				END OF FIGURE	

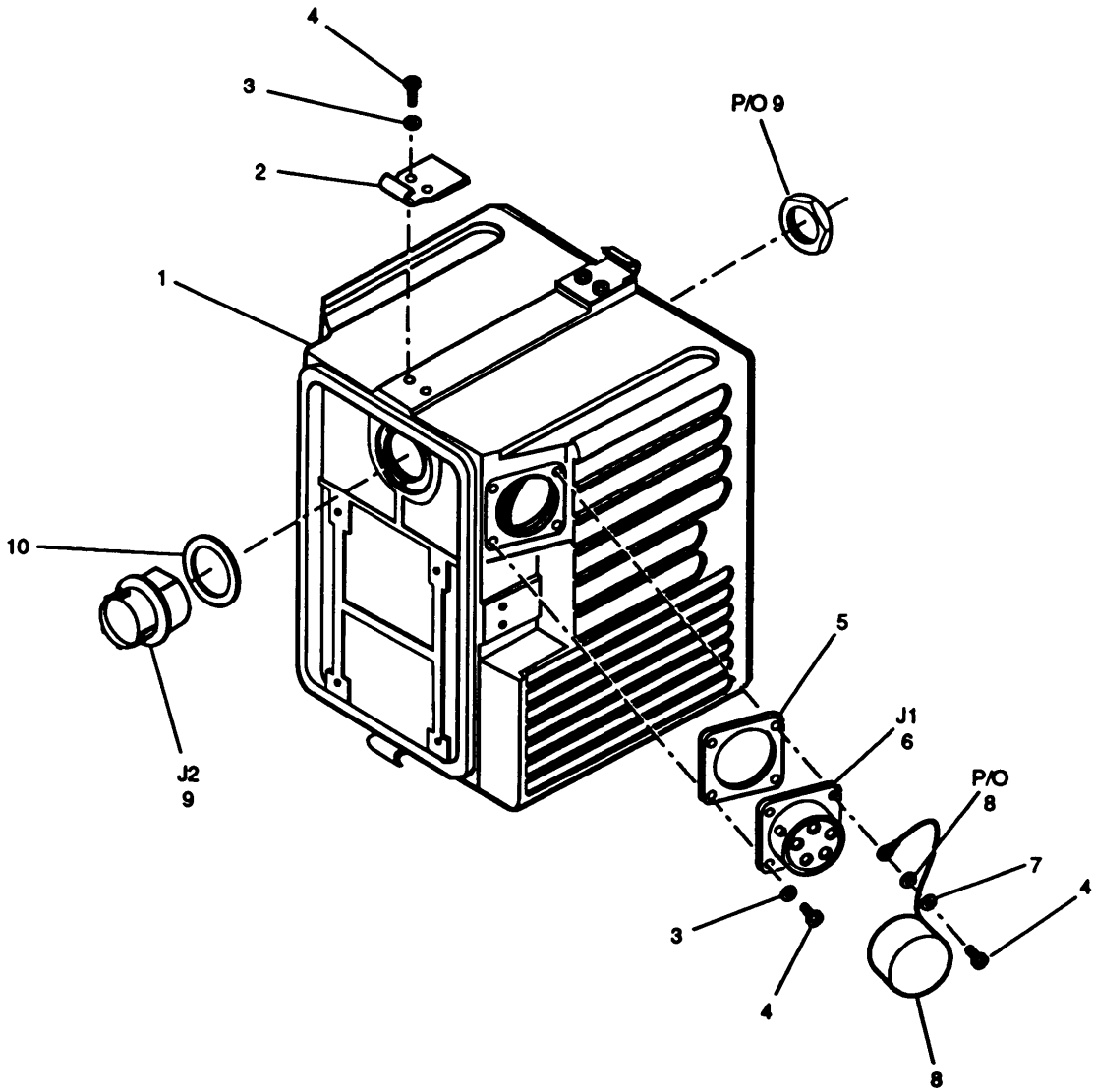

Figure 10. Battery Box Housing Assembly (Sheet 1 of 2)

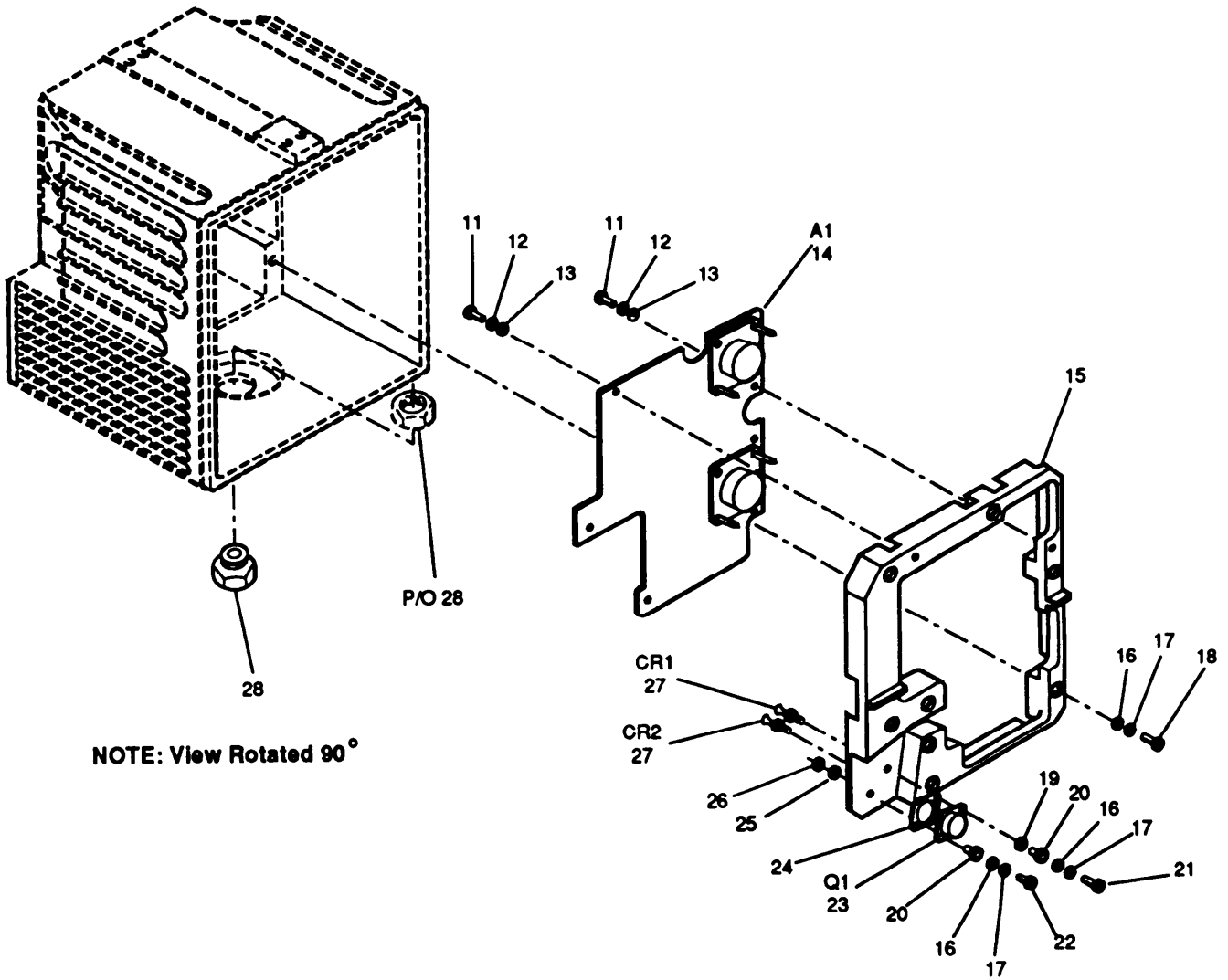

Figure 10. Battery Box Housing Assembly (Sheet 2 of 2)

(1) ITEM NO	(2) SMR CODE	(3) CAGEC	(4) PART NUMBER	(5) DESCRIPTION AND USABLE ON CODE (UOC)	(6) QTY
GROUP 0202 BATTERY BOX HOUSING ASSEMBLY					
FIGURE 10					
1	PAFZZ	54296	A3155280	BATTERY BOX	1
2	PAFZZ	96906	MS18015-3	STRIKE, CATCH	4
3	PAFZZ	96906	MS35338-135B	WASHER, LOCK	16
4	PAFZZ	96906	MS51957-14B	SCREW, MACHINE	16
5	PAFZZ	54296	A3155295	GASKET	1
6	PAFZZ	96906	MS3112E14-5S	CONNECTOR, RECEPACL	1
7	PAFZZ	80205	NAS620C4LP	WASHER, FLAT	5
8	PAFZZ	96906	MS3181-14RA	COVER, ELECTRICAL CO	1
9	PAFZZ	54296	A3155285	CONNECTOR, PLUG, ELEC	1
10	XBFZZ	96906	MS29513-019	PACKING, PREFORMED	1
11	PAFZZ	96906	MS51957-3	SCREW, MACHINE	7
12	PAFZZ	96906	MS35338-134	WASHER, LOCK	7
13	PAFZZ	80205	NAS620C2L	WASHER, FLAT	7
14	PAFDD	80063	A3155276	CIRCUIT CARD ASSEMB	7
15	PAFZZ	54296	A3155279	PRINTED WIRING BOAR	1
16	PAFZZ	80205	NAS620C4L	WASHER, FLAT	8
17	PAFZZ	96906	MS35338-135	WASHER, LOCK	8
18	PAFZZ	96906	MS51957-18	SCREW, MACHINE	6
19	PAFZZ	96906	MS35431-5	TERMINAL, LUG	1
20	PAFZZ	81349	M45595/1-02	SPACER, SLEEVE	2
21	PAFZZ	96906	MS51957-16	SCREW, MACHINE	1
22	PAFZZ	96906	MS51957-14	SCREW, MACHINE	1
23	PAFZZ	81349	JAN2N6052	TRANSISTOR	1
24	PAFZZ	81349	M38527/08-099R	INSULATOR, PLATE	1
25	PAFZZ	96906	MS77068-1	TERMINAL, LUG	1
26	PAFZZ	78189	NAS671C4	NUT, PLAIN, HEXAGON	1
27	PAFZA	81349	JAN1N6304R	SEMICONDUCTOR DEVIC	2
28	PAFZZ	81349	MIL-V-55341 (EL)	VALVE, PRESSURE EQUA	1

END OF FIGURE

CROSS-REFERENCE INDEXES

NATIONAL STOCK NUMBER INDEX

STOCK NUMBER	FIG.	ITEM	STOCK NUMBER	FIG.	ITEM
5305-00-054-5636	7	12	5998-01-356-9179	7	4
5305-00-054-5637	10	11	6130-01-358-2615	8	1
5305-00-054-5648	10	22	5340-01-366-7608	5	4
5305-00-054-5650	10	21	5340-01-366-7609	7	15
5305-00-054-5652	10	18	5340-01-366-7772	7	14
5310-00-057-0573	8	5	5961-01-366-7939	10	27
5310-00-162-9918	10	13	5310-01-366-8143	4	3
5310-00-208-3786	10	26		5	3
5310-00-224-0746	6	6	5340-01-367-1809	9	2
	9	3	5330-01-367-1811	10	5
	10	3	5340-01-367-1861	4	5
5340-00-237-6254	10	2	5340-01-367-2159	9	5
5305-00-253-5614	8	4	5330-01-367-6387	3	4
5940-00-271-7258	10	19		4	1
5330-00-381-8661	3	2	5305-01-367-6468	7	17
	6	8	5305-01-367-9268	7	16
5305-00-459-4687	6	1	5340-01-367-9349	9	1
	9	4	5998-01-367-9442	10	15
	10	4	4820-01-368-1183	10	28
5330-00-469-3556	9	6	5935-01-368-3078	10	9
5310-00-543-4652	7	11	5340-01-368-5579	6	2
5940-00-682-2477	10	25	5940-01-369-7511	2	2
5310-00-723-9676	10	16			
5340-00-839-1630	4	2			
	5	1			
5935-00-893-7952	10	6			
5310-00-928-2690	10	12			
5310-00-933-8118	10	17			
5305-01-025-4831	3	1			
5961-01-156-8492	10	23			
5355-01-172-2620	3	8			
5935-01-255-3997	10	8			
5970-01-280-3299	10	24			
5365-01-305-5914	10	20			
5820-01-320-3686	1	1			
6160-01-322-9366	1	2			
5310-01-353-4941	6	5			
	10	7			
5998-01-356-7005	7	13			
5998-01-356-7008	6	4			
5998-01-356-7009	7	1			
5998-01-356-7010	7	2			
5998-01-356-7011	7	3			
5998-01-356-7012	7	5			
5998-01-356-7013	7	6			
5998-01-356-7014	7	7			
5998-01-356-7015	7	8			
5998-01-356-7016	7	9			
5998-01-356-7018	10	14			
5895-01-356-7039	7	18			

CROSS-REFERENCE INDEXES

CAGEC	PART NUMBER	PART NUMBER INDEX		FIG.	ITEM
		STOCK NUMBER			
02310	AB130E	5330-00-381-8661		3	2
				6	8
80063	A3155275	6130-01-358-2615		8	1
80063	A3155276	5998-01-356-7018		10	14
54296	A3155279	5998-01-367-9442		10	15
54296	A3155280			10	1
80063	A3155282			8	2
54296	A3155283	5340-01-367-9349		9	1
54296	A3155285	5935-01-368-3078		10	9
54296	A3155286	5340-01-367-2159		9	5
54296	A3155292			8	3
54296	A3155293	5340-01-367-1809		9	2
54296	A3155295	5330-01-367-1811		10	5
80058	CY-8629/PRC-132	6160-01-322-9366		1	2
26136	HC440-6-SS-B	5305-01-025-4831		3	1
02697	H86009	5330-01-367-6387		3	4
				4	1
81349	JAN1N6304R	5961-01-366-7939		10	27
81349	JAN2N6052	5961-01-156-8492		10	23
95146	KN-500B-1/8	5355-01-172-2620		3	8
81349	MIL-V-55341 (EL)	4820-01-368-1183		10	28
96906	MS18015-3	5340-00-237-6254		10	2
96906	MS21318-20	5305-00-253-5614		8	4
96906	MS29513-019			10	10
96906	MS29513-163	5330-00-469-3556		9	6
96906	MS3112E14-5S	5935-00-893-7952		10	6
96906	MS3181-14RA	5935-01-255-3997		10	8
96906	MS35333-69	5310-00-543-4652		7	11
96906	MS35338-134	5310-00-928-2690		10	12
96906	MS35338-135	5310-00-933-8118		10	17
96906	MS35338-135B	5310-00-224-0746		6	6
				9	3
				10	3
96906	MS35431-5	5940-00-271-7258		10	19
96906	MS51957-14	5305-00-054-5648		10	22
96906	MS51957-14B	5305-00-459-4687		6	1
				9	4
				10	4
96906	MS51957-16	5305-00-054-5650		10	21
96906	MS51957-18	5305-00-054-5652		10	18
96906	MS51957-2	5305-00-054-5636		7	12
96906	MS51957-3	5305-00-054-5637		10	11
96906	MS77068-1	5940-00-682-2477		10	25
81349	M38527/08-099R	5970-01-280-3299		10	24
81349	M45595/1-02	5365-01-305-5914		10	20
80205	NAS620C2L	5310-00-162-9918		10	13
80205	NAS620C4	5310-00-057-0573		8	5
80205	NAS620C4L	5310-00-723-9676		10	16
80205	NAS620C4LP	5310-01-353-4941		6	5
				10	7
78189	NAS671C4	5310-00-208-3786		10	26

CROSS-REFERENCE INDEXES

CAGEC	PART NUMBER	PART NUMBER INDEX		FIG.	ITEM
		STOCK NUMBER			
80058	RT-1648/PRC-132	5820-01-320-3686		1	1
98003	SB83314	5340-00-839-1630		4	2
				5	1
02310	SNT50171C04E14	5305-01-367-6468		7	17
54296	119-1007-001	5940-01-369-7511		2	2
51506	2020-H-SS-.547-1 2-HT	5340-01-366-7772		7	14
54296	434-0010-001			6	3
06540	6-32 X 3/8			6	7
54296	810546-01			4	4
				5	2
54296	810550-01			6	9
54296	810551-01	5305-01-367-9268		7	16
54296	812038-01	5310-01-366-8143		4	3
				5	3
54296	821997-00	5340-01-368-5579		6	2
54296	823960-10	5340-01-367-1861		4	5
54296	823964-10	5340-01-366-7608		5	4
54296	823969-00	5340-01-366-7609		7	15
54296	994500-10			2	1
54296	994501-10	5998-01-356-7009		7	1
54296	994502-10	5998-01-356-7010		7	2
54296	994503-10	5998-01-356-7011		7	3
54296	994507-10	5998-01-356-7012		7	5
54296	994508-10	5998-01-356-7013		7	6
54296	994509-10	5998-01-356-7014		7	7
54296	994510-10	5998-01-356-9179		7	4
54296	994511-10	5998-01-356-7015		7	8
54296	994512-10	5998-01-356-7016		7	9
54296	994513-10	5998-01-356-7008		6	4
54296	994514-10	5998-01-356-7005		7	13
54296	994517-10			3	5
54296	994518-10			3	6
54296	994519-10			3	7
54296	994521-10			7	10
54296	994522-10	5895-01-356-7039		7	18
54296	994529-10			3	3

CROSS-REFERENCE INDEXES

FIGURE AND ITEM NUMBER INDEX				
FIG.	ITEM	STOCK NUMBER	FSCM	PART NUMBER
1	1	5820-01-320-3686	80058	RT-1648/PRC-132
1	2	6160-01-322-9366	80058	CY-8629/PRC-132
2	1		54296	994500-10
2	2	5940-01-369-7511	54296	119-1007-001
3	1	5305-01-025-4831	26136	HC440-6-SS-B
3	2	5330-00-381-8661	02310	AB130E
3	3		54296	994529-10
3	4	5330-01-367-6387	02697	H86009
3	5		54296	994517-10
3	6		54296	994518-10
3	7		54296	994519-10
3	8	5355-01-172-2620	95146	KN-500B-1/8
4	1	5330-01-367-6387	02697	H86009
4	2	5340-00-839-1630	98003	SB83314
4	3	5310-01-366-8143	54296	812038-01
4	4		54296	810546-01
4	5	5340-01-367-1861	54296	823960-10
5	1	5340-00-839-1630	98003	SB83314
5	2		54296	810546-01
5	3	5310-01-366-8143	54296	812038-01
5	4	5340-01-366-7608	54296	823964-10
6	1	5305-00-459-4687	96906	MS51957-14B
6	2	5340-01-368-5579	54296	821997-00
6	3		54296	434-0010-001
6	4	5998-01-356-7008	54296	994513-10
6	5	5310-01-353-4941	80205	NAS620C4LP
6	6	5310-00-224-0746	96906	MS35338-135B
6	7		06540	6-32 X 3/8
6	8	5330-00-381-8661	02310	AB130E
6	9		54296	810550-01
7	1	5998-01-356-7009	54296	994501-10
7	2	5998-01-356-7010	54296	994502-10
7	3	5998-01-356-7011	54296	994503-10
7	4	5998-01-356-9179	54296	994510-10
7	5	5998-01-356-7012	54296	994507-10
7	6	5998-01-356-7013	54296	994508-10
7	7	5998-01-356-7014	54296	994509-10
7	8	5998-01-356-7015	54296	994511-10
7	9	5998-01-356-7016	54296	994512-10
7	10		54296	994521-10
7	11	5310-00-543-4652	96906	MS35333-69
7	12	5305-00-054-5636	96906	MS51957-2
7	13	5998-01-356-7005	54296	994514-10
7	14	5340-01-366-7772	51506	2020-H-SS-.547-1 2-HT
7	15	5340-01-366-7609	54296	823969-00
7	16	5305-01-367-9268	54296	810551-01
7	17	5305-01-367-6468	02310	SNT50171C04E14
7	18	5895-01-356-7039	54296	994522-10
8	1	6130-01-358-2615	80063	A3155275
8	2		80063	A3155282

CROSS-REFERENCE INDEXES

FIG.	ITEM	FIGURE AND ITEM NUMBER INDEX		
		STOCK NUMBER	FSCM	PART NUMBER
8	3		54296	A3155292
8	4	5305-00-253-5614	96906	MS21318-20
8	5	5310-00-057-0573	80205	NAS620C4
9	1	5340-01-367-9349	54296	A3155283
9	2	5340-01-367-1809	54296	A3155293
9	3	5310-00-224-0746	96906	MS35338-135B
9	4	5305-00-459-4687	96906	MS51957-14B
9	5	5340-01-367-2159	54296	A3155286
9	6	5330-00-469-3556	96906	MS29513-163
10	1		54296	A3155280
10	2	5340-00-237-6254	96906	MS18015-3
10	3	5310-00-224-0746	96906	MS35338-135B
10	4	5305-00-459-4687	96906	MS51957-14B
10	5	5330-01-367-1811	54296	A3155295
10	6	5935-00-893-7952	96906	MS3112E14-5S
10	7	5310-01-353-4941	80205	NAS620C4LP
10	8	5935-01-255-3997	96906	MS3181-14RA
10	9	5935-01-368-3078	54296	A3155285
10	10		96906	MS29513-019
10	11	5305-00-054-5637	96906	MS51957-3
10	12	5310-00-928-2690	96906	MS35338-134
10	13	5310-00-162-9918	80205	NAS620C2L
10	14	5998-01-356-7018	80063	A3155276
10	15	5998-01-367-9442	54296	A3155279
10	16	5310-00-723-9676	80205	NAS620C4L
10	17	5310-00-933-8118	96906	MS35338-135
10	18	5305-00-054-5652	96906	MS51957-18
10	19	5940-00-271-7258	96906	MS35431-5
10	20	5365-01-305-5914	81349	M45595/1-02
10	21	5305-00-054-5650	96906	MS51957-16
10	22	5305-00-054-5648	96906	MS51957-14
10	23	5961-01-156-8492	81349	JAN2N6052
10	24	5970-01-280-3299	81349	M38527/08-099R
10	25	5940-00-682-2477	96906	MS77068-1
10	26	5310-00-208-3786	78189	NAS671C4
10	27	5961-01-366-7939	81349	JAN1N6304R
10	28	4820-01-368-1183	81349	MIL-V-55341 (EL)

RECOMMENDED CHANGES TO EQUIPMENT TECHNICAL PUBLICATIONS



THEN... JOT DOWN THE DOPE ABOUT IT ON THIS FORM. CAREFULLY TEAR IT OUT, FOLD IT AND DROP IT IN THE MAIL!

SOMETHING WRONG WITH THIS PUBLICATION?

FROM (PRINT YOUR UNIT'S COMPLETE ADDRESS)
 Commander
 Stateside Army Depot
 ATTN: AMSTA-US
 Stateside, N.J. 07703-5007

DATE SENT
 10 July 1975

PUBLICATION NUMBER

TM 11-5840-340-20P

PUBLICATION DATE

23 Jan 78

PUBLICATION TITLE

Radar Set AN/PRC-76

BE EXACT PIN-POINT WHERE IT IS

PAGE NO	PARA-GRAPH	FIGURE NO	TABLE NO
33			
44		19	
45			

IN THIS SPACE TELL WHAT IS WRONG AND WHAT SHOULD BE DONE ABOUT IT:

For item 2, change the NSN to read: 5835-00-134-9186.
Reason: Accuracy.

Identify the cover on the junction box (item no. 5).
Reason: It is a separate item and is not called out on figure 19.

Add the cover of the junction box as an item in the listing for figure 19.
Reason: Same as above

SAMPLE

PRINTED NAME, GRADE OR TITLE, AND TELEPHONE NUMBER
 SSG I. M. DeSpirit of 999-1776

SIGN HERE

TEAR ALONG PERFORATED LINE

FILL IN YOUR
UNIT'S ADDRESS

FOLD BACK

DEPARTMENT OF THE ARMY

OFFICIAL BUSINESS

PLEASE
AFFIX
STAMP
POSTAGE
REQUIRED

SAMPLE

Commander
U.S. Army Communications-Electronics Command
and Fort Monmouth
ATTN: MSEL-LC-LM-LT
Fort Monmouth, New Jersey 07703-5007

TEAR ALONG DOTTED LINE

RECOMMENDED CHANGES TO EQUIPMENT TECHNICAL PUBLICATIONS



THEN...JOT DOWN THE DOPE ABOUT IT ON THIS FORM. CAREFULLY TEAR IT OUT. FOLD IT AND DROP IT IN THE MAIL.

SOMETHING WRONG WITH THIS PUBLICATION?

FROM: (PRINT YOUR UNIT'S COMPLETE ADDRESS)

DATE SENT

PUBLICATION NUMBER

PUBLICATION DATE

PUBLICATION TITLE

BE EXACT PIN-POINT WHERE IT IS

PAGE NO.	PARA-GRAPH	FIGURE NO.	TABLE NO.
----------	------------	------------	-----------

IN THIS SPACE TELL WHAT IS WRONG AND WHAT SHOULD BE DONE ABOUT IT:

TEAR ALONG PERFORATED LINE

PRINTED NAME GRADE OR TITLE AND TELEPHONE NUMBER

SIGN HERE

FILL IN YOUR
UNIT'S ADDRESS

FOLD BACK

DEPARTMENT OF THE ARMY

OFFICIAL BUSINESS

PLEASE
AFFIX
STAMP
POSTAGE
REQUIRED

TEAR ALONG DOTTED LINE

Commander
U.S. Army Communications-Electronics Command
and Fort Monmouth
ATTN: AMSEL-LC-LM-LT
Fort Monmouth, New Jersey 07703-5007

RECOMMENDED CHANGES TO EQUIPMENT TECHNICAL PUBLICATIONS



THEN...JOT DOWN THE DOPE ABOUT IT ON THIS FORM. CAREFULLY TEAR IT OUT. FOLD IT AND DROP IT IN THE MAIL.

SOMETHING WRONG WITH THIS PUBLICATION?

FROM: (PRINT YOUR UNIT'S COMPLETE ADDRESS)

DATE SENT

PUBLICATION NUMBER

PUBLICATION DATE

PUBLICATION TITLE

BE EXACT PIN-POINT WHERE IT IS

PAGE NO.	PARA-GRAPH	FIGURE NO.	TABLE NO.
----------	------------	------------	-----------

IN THIS SPACE TELL WHAT IS WRONG AND WHAT SHOULD BE DONE ABOUT IT:

TEAR ALONG PERFORATED LINE

PRINTED NAME GRADE OR TITLE AND TELEPHONE NUMBER

SIGN HERE

FILL IN YOUR
UNIT'S ADDRESS

FOLD BACK

DEPARTMENT OF THE ARMY

OFFICIAL BUSINESS

PLEASE
AFFIX
STAMP
POSTAGE
REQUIRED

TEAR ALONG DOTTED LINE

Commander
U.S. Army Communications-Electronics Command
and Fort Monmouth
ATTN: AMSEL-LC-LM-LT
Fort Monmouth, New Jersey 07703-5007

RECOMMENDED CHANGES TO EQUIPMENT TECHNICAL PUBLICATIONS



THEN...JOT DOWN THE DOPE ABOUT IT ON THIS FORM. CAREFULLY TEAR IT OUT. FOLD IT AND DROP IT IN THE MAIL.

SOMETHING WRONG WITH THIS PUBLICATION?

FROM: (PRINT YOUR UNIT'S COMPLETE ADDRESS)

DATE SENT

PUBLICATION NUMBER

PUBLICATION DATE

PUBLICATION TITLE

BE EXACT PIN-POINT WHERE IT IS

IN THIS SPACE TELL WHAT IS WRONG AND WHAT SHOULD BE DONE ABOUT IT:

PAGE NO. PARA. GRAPH FIGURE NO. TABLE NO.

TEAR ALONG PERFORATED LINE

PRINTED NAME GRADE OR TITLE AND TELEPHONE NUMBER

SIGN HERE

FILL IN YOUR
UNIT'S ADDRESS

FOLD BACK

DEPARTMENT OF THE ARMY

OFFICIAL BUSINESS

PLEASE
AFFIX
STAMP
POSTAGE
REQUIRED

TEAR ALONG DOTTED LINE

Commander
U.S. Army Communications-Electronics Command
and Fort Monmouth
ATTN: AMSEL-LC-LM-LT
Fort Monmouth, New Jersey 07703-5007

By Order of the Secretary of the Army:

GORDON R. SULLIVAN
General, United States Army
Chief of Staff

Official:

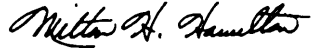

MILTON H. HAMILTON
Administrative Assistant to the
Secretary of the Army

04405

DISTRIBUTION:

To be distributed in accordance with DA Form 12-36-E, block 9476,
requirements for TM 11-5820-1102-23P.

