

DEPARTMENT OF THE ARMY TECHNICAL MANUAL

---

**ORGANIZATIONAL MAINTENANCE REPAIR PARTS  
AND SPECIAL TOOLS LISTS**

**GENERATOR SET, GAS TURBINE ENGINE:  
45 KW, AC, 120/208 V, 240/416 V, 3 PHASE, 4 WIRE:  
SKID MOUNTED: WINTERIZED (AIRESEARCH  
MODEL GTGE 70 C 1)  
FSN 6115-075-1639**

---

This reprint includes all changes in effect the time  
of publication; change 2.

**HEADQUARTERS, DEPARTMENT OF THE ARMY  
OCTOBER 1968**

Change

No. 2

HEADQUARTFRS  
DEPARTMENT OF THE ARMY  
Washington, D.C. 14 August 1972

**Organizational Maintenance Repair Parts  
and Special Tools List  
GENERATOR SET, GAS TURBINE ENGINE: 45 KW,  
AC, 120/208 V, 240/416 V, 3 PHASE, 4 WIRE; SKID  
MOUNTED: WINTERIZED (AIRESEARCH MODEL GTGE 70-6-1)  
FSN 6115-075-1639**

Current as of 20 June 1972

TM 5-6115-320-20P, 24 October 1968, is changed as follows:

*Page vi*, Paragraph 8, is superseded as follows:

**8. Recommendations for Maintenance  
Publications Improvements**

You can improve this manual by calling attention to errors and by recommending improvements, using DA Form 2028 (Recommended Changes to Publications) or by a letter, and mailing directly to Commanding General, U. S. Army Mobility Equipment Command, ATTN: AMSMEMPP, 4300 Goodfellow Boulevard, St. Louis, MO. 63120. A reply will be furnished directly to you.

*Page, 34*, Figure 8, Index to Parts, delete Reference Number 3.

*Page, 35*, Figure 9, Index to Parts, delete Reference Number 10.

*Page, 45*, Figure 19, Index to Parts, delete Reference Number 3.

All changes, additions, or deletions of Federal stock numbers or manufacturer's code and part numbers within this change should be appropriately reflected in the index.

This change supersedes C 1, 1 September 1970

PG	LINE	ACTION	(1) SMR CODE INDEX NO.	(2) FEDERAL STOCK NUMBER	(3) DESCRIPTION REFERENCE NO. & MFR CODE USABLE ON CODE	(4) UNIT OF ISSUE	(5) QTY INC IN UNIT PACK	(6) QTY INC IN UNIT	(7) 15 DAY ORGANIZATIONAL MAINTENANCE ALW				(8) ILLUS- TRATION		
									(a)	(b)	(c)	(d)	(a)	(b)	
									1-5	6-20	21-50	51-100	FIG NO.	ITEM NO.	
2	00028	Ch col 1	POT		SECTION IV. REPAIR PARTS FOR ORGANIZATIONAL MAINTENANCE GROUP 01 - ENGINE										
3	00040A	Add	X20	4730-278-0375	0126 - FUEL OR STEAM CONTROL ATOMIZER ** BOLT, FLUID PASSAGE: fuel control to lines AN775-4 (88044)	ea	3								
	00042A	Add	X20	4730-698-4030	CAP, ORIFICED TEE AN929-4 (88044)	ea	1								
	00048A	Add	O	4730-555-2588	ELBOW, TUBE: fuel in AN833-C (88044)	ea	1	*	*	*	*				
	00048B	Add	O	4730-277-6223	ELBOW, FLUID: control air to fuel control AN7784 (88044)	ea	1	*	*	*	*				
4	00049	Ch col 2 Ch Mfg code and P/N col 3		2910-541-3486	FILTER ELEMENT 56951 (81321)										
	00057A	Add	X20	4720-771-6874	HOSE ASSEMBLY: fuel control drain line 6010024-074 (00624)	ea	1								
	00057B	Add	X20	4720-771-6875	HOSE ASSEMBLY: control air line 6010024-0122 (00624)	ea	2								
	00057C	Add	X20	4720-771-6876	HOSE ASSEMBLY, fuel output line 6010024-0142 (00624)	ea	1								
5	00066	Ch col 2 and 3		5330-250-0231	PACKING: fuel pump filter cap										
	00067A	Add	PO	5330-263-8030	PACKING, PREFORMED: elbow MS295126 (96906)	ea	1	*	*	*	*				
	00067B	Add	PO	5330-551-0553	PACKING, PREFORMED: bolt fluid 620-42-4 (83259)	ea	1	*	*	*	*				
	00068	Ch col 1	POT		PUMP **										
	00072	Ch col 2		5310-596-0664	SPRING **										
	00075	Delete													
	00078	Delete													
	00079	Delete													
7	00108	Ch col 1	POT		0127 - LUBRICATING SYSTEM COOLER * GROUP 06 - ELECTRICAL SYSTEM (ENGINE AND VEHICULAR, ETC.)										
12	00188	Ch col 1	POT:		0603 - STARTING MOTOR MOTOR, ** 0607 - INSTRUMENT OR ENGINE CONTROL PANEL										
14	00221	Delete													

**By the Order of the Secretary of the Army:**

BRUCE PALMER, JR.  
General, U. S. Army  
Acting Chief of Staff

Official:

VERNE L. BOWERS  
Major General, United States Army.  
The Adjutant General

Distribution:

To be distributed in accordance with DA Form 12-25D, (qty rqr block No. 742) Organizational maintenance requirements for Generator Sets. Engine Driven: 45 KW. 400 HZ.

**ORGANIZATIONAL MAINTENANCE REPAIR PARTS  
AND SPECIAL TOOLS LIST  
GENERATOR SET, GAS TURBINE ENGINE: 45 KW, AC.,  
120/208 V, 240/416 V, 3 PHASE, 4 WIRE: SKID MOUNTED:  
WINTERIZED (AIRESEARCH MODEL GTGE 701)  
FSN 6115-075-1639  
Current as of 26 April 1968**

	Paragraph	Page
SECTION I. INTRODUCTION		
Scope .....	1	iii
General.....	2	iii
Explanation of columns.....	3	iii
Special information .....	4	v
How to locate repair parts .....	5	v
Abbreviations.....	6	v
Recommendations for maintenance manual improvements.....	7	v
Federal supply codes for manufacturers.....	8	vi
II. PRESCRIBED LOAD ALLOWANCE.....		vii
III. SPECIAL TOOLS, TEST AND SUPPORT EQUIPMENT FOR ORGANIZATIONAL MAINTENANCE (Not Applicable)		
IV. REPAIR PARTS FOR ORGANIZATIONAL MAINTENANCE		
Group 01. Engine		
0121 Compressor assembly (includes compressor and housing) .....		1
0122 Combustion assembly.....		1
0126 Fuel or steam control.....		2
0127 Lubricating system.....		6
06. Electrical System (Engine and Vehicular, etc.)		
0608 Starting motor .....		12
0605 Ignition components .....		12
0607 Instrument or engine control panel .....		13
0608 Miscellaneous items .....		14
0612 Batteries, storage (wet or dry) .....		14
0613 Hull or chassis wiring harness.....		16
18. Body, Cab, Hood and Hull		
1801 Body, cab, hood, hull assemblies .....		16
22. Body Chassis or Hull, and Accessory Items		
2201 Canvas, rubber, or plastic items .....		18
2207 Winterization equipment .....		18
2210 Data plates and instruction holders .....		20
40. Electric Motors and Generators		
4004 Ventilating system .....		22
4009 Control panels, housing, cubicles.....		22

\*This manual superseded TM 5-6115-320-20P, 24 June 1966.

Group 40.	Electric Motors and Generators - Continued	
	4014 Resistors (fixed, variable or tapped) .....	24
	4018 Terminal blocks, junction boxes.....	24
42	Electrical Equipment	
	4213 Non rotating rectifiers, converters, inverters.....	25
47	Gages, (Non-Electrical Weighing and Measuring Devices	
	4702 Gages, mountings, lines, and fittings.....	26
Section V.	FEDERAL STOCK NUMBER AND REFERENCE NUMBER INDEX .....	57

SECTION I

INTRODUCTION

**1. Scope**

This manual lists repair parts and special tools required for the performance of organizational maintenance of the generator set.

**2. General**

a. The Repair Parts List is arranged as follows:

(1) Individual parts and major assemblies are listed alphabetically by item name within the numbered functional groups.

(2) Assembly components and subassemblies are indented and listed alphabetically by item name under major assemblies.

b. This Repair Parts and Special Tools List is divided into the following sections:

(1) *Prescribed Load Allowance (PLA) Section II.* A consolidated listing of repair parts quantitatively allocated for initial stockage at the organizational level. This is a mandatory stockage allowance.

(2) *Special Tools, Test and Support Equipment-Section III.* A list of special tools, test and support equipment authorized for the performance of maintenance at the organizational level (Not Applicable).

(3) *Repair Parts-Section IV.* A list of repair parts authorized for the performance of maintenance at the organizational level.

(4) *Federal Stock Number and Reference Number Index Section V.* A list of Federal stock numbers followed by reference numbers in ascending alpha-numeric sequence, cross-referenced to index number.

**3. Explanation of Columns**

The following provides an explanation of columns in the tabular lists in Sections II, III, and IV:

a. *Source, Maintenance and Recoverability Codes (SMR):*

(1) Source Code, indicates the selection status and source for the listed item. Source codes are:

Code	Explanation
P	Applied to repair parts which are stocked in or supplied from DSA/GSA or Army supply system, and authorized for use at indicated maintenance categories.
M	Applied to repair parts which are not procured or stocked but are to be manufactured at indicated maintenance categories.
A	Applied to assemblies which are not procured or stocked as such but are made up two or more units, each of which carry individual stock numbers and descriptions and are procured and stocked and can be assembled by units at indicated maintenance categories.
X	Applied to parts and assemblies which are not procured or stocked, the mortality of which is normally below that of the applicable end item, and the failure of which should result in retirement of the end item from the, supply system.
X1	Applied to repair parts which are not procured or stocked, the requirement for which will be supplied by use of the next higher assembly or components.
X2	Applied to repair parts which are not stocked. The indicated maintenance category requiring such repair parts will attempt to obtain them through cannibalization; if not obtainable through cannibalization, such repair parts will be requisitioned with supporting justification through normal supply channels.
C	Applied to repair parts authorized for local procurements. If not obtainable from local procurement, such repair parts will be requisitioned through normal supply channels with a supporting statement of non-availability from local procurement.
G	Applied to major assemblies that are .procured with PEMA (Procurement Equipment Missile Army) funds for initial is sue only to be used as

Code	Explanation
	sue only to be used as exchange assemblies at DSU and GSU maintenance level. These assemblies will not be stocked above DSU and GSU or returned to depot supply level.

**Note.**

**Source code is not shown on common hardware items known to be readily available in Army supply channels and through local procurement.**

(2) Maintenance Code, indicates the lowest category of maintenance authorized to install the listed item. The maintenance level code is:

Code.	Explanation
O	Organizational maintenance

(3) Recoverability Code, indicates whether unserviceable items should be returned for recovery or salvage. Items not coded are expendable. Recoverability codes are:

Code	Explanation
R	Applied to repair parts and assemblies which are economically repairable at DSU and GSU activities and normally are furnished by supply on an exchange basis.
T	Applied to high dollar value recoverable repair parts which are subject to special handling and are issued on an exchange basis. Such repair parts normally are repaired or overhauled at depot maintenance activities.
U	Applied to repair parts specifically selected for salvage by reclamation units because of precious metal content, critical materials, high dollar value reusable casings or castings.

(4) This column also lists, below the SMR code, an index number for each item in ascending numerical sequence, which is used to locate items in the publication when the Federal stock number and/or reference number is known.

*b. Federal Stock Number:* This column indicates the Federal stock number for the item.

*c. Description:* This column indicates the Federal item name and any additional description of the item required. A part number or other reference number is followed by the applicable five-digit Federal supply code for manufacturers in parentheses. Material required for manufacture or fabrication is identified.

*d. Unit of Issue:* This column indicates the unit used as a basis for issue, e.g., ea, pr, ft, yd, etc.

*e. Quantity Incorporated in Unit Pack:* This column indicates the actual quantity contained in the unit pack.

*f. Quantity Incorporated in Unit:* This column indicates the quantity of the item used in the functional group.

*g. Fifteen-Day Organizational Maintenance Allowance, Column (4) of Section II and Column (7) of Section III and IV.*

(1) The allowance columns are divided into four subcolumns. Indicated in each subcolumn is the quantity of items authorized for the number of equipment supported. Items authorized for use as required but not for initial stockage are identified with an asterisk in the allowance column.

(2) The quantitative allowances for organizational level of maintenance represents one initial prescribed load for a 15-day period for the number of equipments supported. Units and organizations authorized additional prescribed loads will multiply the number of prescribed loads authorized by the quantity of repair parts reflected in the appropriate density column applicable to the number of items supported to obtain the total quantity of repair parts authorized.

(3) Organizational units providing maintenance for more than 100 of these equipments shall determine the total quantity of parts required by converting the equipment quantity to a decimal factor by placing a decimal point before the next to last digit of the number to indicate hundredths, and multiplying the decimal factor by the parts quantity authorized in the 51-100 allowance column. Example, authorized allowance for 51-100 equipments is 40; for 150 equipments multiply 40 by 1.50 or 60 parts required.

(4) Subsequent changes to allowances will be limited as follows: No change in the range of items is authorized. If additional items are considered necessary, recommendation should be forwarded to U.S. Army Mobility Equipment Command for exception or



revision to the allowance list. Revisions to the range of items authorized will be made by this Command based upon engineering experience, demand data, or TAERS information.

h. Illustration, Column (8). This column is divided as follows:

(1) Figure Number Column (8a). Indicates the figure number of the illustration in which the item is shown.

(2) Item Number, Column (8b). Indicates the callout number used to reference the item in the illustration.

**4. Special Information**

a. Repair parts mortality has been based on 1,000 hours of operation per year.

b. Parts which require manufacture or assembly at a category higher than that authorized for installation will indicate in the source column the higher category.

c. The following publications pertain to the generator set and its components:

TM 5-6115-320-12	Organizational maintenance manual.
TM 5-6115-32034	DS and GS maintenance manual.
TM 5-6116-32034P	DS and GS maintenance repair parts and special tool lists.

**5. How to Locate Repair Parts**

a. When Federal stock number or reference number is unknown: (1) First. Using the table of contents, determine the

functional group within which the repair part belongs.

(2) Second. Find the illustration covering the functional group to which the repair part belongs.

(3) Third. Identify the repair part on the illustration, and note the illustration figure and item number of the repair part.

(4) Fourth. Using the Repair Parts Listing, find the functional group to which the repair part belongs and locate the illustration figure and item number noted on the illustration.

b. When Federal stock number or reference number is known:

(1) First. Using the Index of Federal Stock Numbers and Reference Numbers, find the pertinent

Federal Stock Number or Reference Number. This index is in ascending alphanumeric sequence cross-referenced to an index number.

(2) Second. Using the Repair Part Listing, find the index number referenced in the Index of Federal Stock Numbers and Reference Numbers.

**6. Abbreviations**

ac.....	alternating current
dc.....	direct current
ea .....	each
grp .....	group
lh .....	left hand
mtg .....	mounting
rh .....	right hand
rpm .....	revolution per minute
w/ .....	with

**7. Federal Supply Codes for Manufacturers**

Code	Manufacturer'
00779.....	AMP Inc.
03608.....	AC Spark Plug Div of General Motors Corp.
08484.....	Breeze Corporations Inc.
09922.....	Burndy Corp
24455.....	General Electric Co. Lamp, Division of Consumer Products Group
70040.....	AC Spark Plug, Div. of General Motors Corp.
70128.....	Aeroquip Corp. Aircraft Div Western Plant
70210.....	Airesearch Mfg. Division of Garrett Corp.
70763.....	Barnes, John S Corp.
71400.....	Bussmann Mfg Division of McGraw-Edison Co.
72433.....	Flexitallic Gasket Co.
72619.....	Dialight Corp.
72850.....	Bendix Corp., The
72962.....	Elastic Stop Nut Corp. of America
75361.....	Koehler-Dayton Inc.
75915.....	Littlefuse Inc.
76630.....	Cinch-Monadnock, Div. of United-Carr Fastener Corp.
77820.....	Bendix Corp., The Scintilla Division
80684.....	Clark Cable Corp.
81780.....	Benmar Mfg. Co. Inc.
83259.....	Parker Seal Co.
84971.....	TA Mfg. Corp.
88044.....	Aeronautical Standards Group Dept. of Navy and Air Force

Code	Manufacturer
90005.....	Bendix Corp., The Filter Division
91637.....	Dale Electronics Inc.
91929.....	Honeywell Inc. Micro Switch Division
92532.....	Georgia Duck and Cordage Mill
96906.....	Military Standards Promulgated by Standardization Division Directorate of Logistic Services DSA
97403.....	Army Engineer Research and Development Laboratories
98625.....	Aeroquip Corp. Marman Division
99193.....	Airsearch Mfg Division of Garrett Corp.

### **8. Recommendations for Maintenance Manual Improvements**

Report of errors, omissions, and recommendations for improving this publication by the individual user is encouraged. Reports should be submitted on DA Form 2028 (Recommended Changes to DA Publications) and forwarded direct to Commanding General, U. S. Army Mobility Equipment Command, ATTN: AMSME-MPP, 4300 Goodfellow Boulevard, St. Louis, Mo. 63120.

**SECTION II  
PRESCRIBED LOAD ALLOWANCE**

(1) <b>FEDERAL STOCK NUMBER</b>	(2) <b>DESCRIPTION  USABLE ON CODE</b>	(3) <b>Qty inc in unit pack</b>	(4) <b>15-DAY ORGANIZATIONAL MAINTENANCE ALLOWANCE</b>			
			(a) <b>1-5</b>	(b) <b>6-20</b>	(c) <b>21-50</b>	(d) <b>51-100</b>
	GROUP 01-ENGINE					
	0121-COMPRESSOR ASSEMBLY					
2835-585-4938	GASKET					2
6115-633-3404	GASKET					2
	0122-COMBUSTION ASSEMBLY					
2835-015-0220	FLANGE ASSEMBLY					2
2835-015-0222	CHAMBER ASSEMBLY			2		2
5310-059-9265	NUT	2	3	5		10
5330-014-8447	GASKET					2
5330-928-0487	PACKING	2	5	10		21
	0126-FUEL OR STEAM CONTROL					
2910-045-9430	PUMP					2
2910-065-6615	ATOMIZER ASSEMBLY					2
2910-069-4500	ELEMENT	2	6	10		21
2910-689-9920	VALVE, SOLENOID					2
2910-719-7651	VALVE, SOLENOID					2
2915-097-0325	VALVE					2
4730-231-3026	ELBOW ASSEMBLY			2		2
5310-637-2977	SPRING, FILTER					2
5330-171-8002	PACKING	2	5	10		21
5330-248-3836	PACKING	2	5	10		21
5330-641-1824	GASKET			2		2
5330-757-6867	PACKING	2	5	10		21
5330-845-0915	PACKING, PREFORMED					2
5330-861-1396	GASKET			2		2
5330-861-1396	GASKET			2		2
6116-014-5532	FILTER ELEMENT					2
	0127-LUBRICATING SYSTEM					
1650-530-3146	GASKET			2		2
2910-897-9150	PACKING, w/RETAINER					2
2940-849-8358	ELEMENT ASSEMBLY	8	11	21		42
4730-618-8644	CLAMP					2
5330-171-5464	GASKET			2		2
5330-171-5659	PACKING					2
5330-194-3713	PACKING, PREFORMED	3	11	21		42
5330-514-3285	PACKING, w/RETAINER					2
5330-514-3285	PACKING, w/RETAINER		2	8		5
5330-531-2071	GASKET			2		2
5330-883-4215	GASKET		2	2		4
5930-017-9274	SWITCH, PRESSURE					2
5930-615-6831	SWITCH, PRESSURE					2
6115-641-3773	GASKET					2

(1) FEDERAL STOCK NUMBER	(2) DESCRIPTION  USABLE ON CODE	(3) Qty inc in unit pack	(4) 15-DAY ORGANIZATIONAL MAINTENANCE ALLOWANCE			
			(a) 1-5	(b) 6-20	(c) 21-50	(d) 51-100
	GROUP 06--ELECTRICAL SYSTEM (ENGINE AND VEHICULAR, ETC) 0603-STARTING MOTOR					
5330-726-4153	PACKING					2
5945-754-6611	RELAY				2	2
	0605-IGNITION COMPONENTS I					
2835-608-6146	GASKET		2	2	4	8
2920-067-6735	IGNITER				2	2
	0607-INSTRUMENT OR ENGINE CONTROL PANEL					
5920-078-8659	FUSE			2	2	2
	0612-BATTERIES, STORAGE (WET OR DRY)					
6140-057-2553	BATTERY					
	GROUP 18-BODY, CAB, HOOD AND HULL					
	1801-BODY, CAB, HOOD, HULL ASSEMBLIES					
6115-014-5513	HOIST ASSEMBLY					2
	GROUP 22-BODY CHASSIS OR HULL, AND ACCESSORY ITEM					
	2207-WINTERIZATION EQUIPMENT					
2910-203-3322	ELEMENT ASSEMBLY				2	2
2920-902-7063	IGNITER ASSEMBLY				2	2
4730-852-8931	CLAMP					2
4730-877-9822	CLAMP					2
5330-265-1089	PACKING					2
	2					
6115-691-5493	GASKET, IGNITER			2	2	4
	2210-DATA PLATES AND INSTRUC- TION HOLDERS					
2835-515-7334	PLATE					2
2835-886-1153	PLATE					2
6115-015-0371	PLATE			2	2	2
6115-015-Ov72	PLATE			2	2	2
6115-015-0373	PLATE			2	2	2
6115-015-0375	PLATE			2	2	2
8135-567-1862	TAG				2	2
8135-567-1863	TAG				2	2
9905-633-9140	PLATE			2	2	2
	GROUP 40--ELECTRIC MOTORS AND GENERATORS					
	4009-CONTROL PANELS, HOUSING CUBICLES					
6115-014-5521	LIGHT			2	2	2
2610-669-6474	LIGHT			2	2	3
6240-143-3060	LAMP			2	2	4

(1) FEDERAL STOCK NUMBER	(2) DESCRIPTION  USABLE ON CODE	(3) Qty inc in unit pack	(4) 15-DAY ORGANIZATIONAL MAINTENANCE ALLOWANCE			
			(a) 1-5	(b) 6-20	(c) 21-50	(d) 51-100
5905-015-0053	4014-RESISTORS (FIXED, VARIABLE OR TAPPED) RESISTOR					2
5905-015-0054	RESISTOR					2
6115-014-5654	4018-TERMINAL BLOCKS, JUNCTION BOXES SPACER					2
5920-539-6920	GROUP 42-ELECTRICAL EQUIPMENT 4213--NON-ROTATING RECTIFIERS, CONVERTERS, INVERTERS FUSE				2	2

(1) SMR CODE INDEX NO.	(2) FEDERAL STOCK NUMBER	(3) DESCRIPTION REFERENCE NO. & MFR CODE USABLE ON CODE		(4) UNIT OF ISSUE	(5) QTY INC IN UNIT PACK	(6) QTY INC IN UNIT	(7) 15 DAY ORGANIZATIONAL MAINTENANCE ALW				(8) ILLUS- TRATION	
							(a)	(b)	(c)	(d)	(a)	(b)
							1-5	6-20	21-50	51-100	FIG NO.	ITEM NO.
00001		SECTION IV - REPAIR PARTS FOR ORGANIZATIONAL MAINTENANCE										
00002		GROUP 01 - ENGINE										
		0121 - COMPRESSOR ASSEMBLY (INCLUDES COMPRESSOR AND HOUSING)										
P 0 00003	6115-633-3404	GASKET, PLENUM: align, screen (As required) 75555 (99193)		EA		*	*	*	*	2	1	4
P 0 00004	2835-585-4938	GASKET, PLENUM: align, screen (As required) 75556 (99193)		EA		*	*	*	*	2	1	5
P 0 00005	2835-630-3965	SCREEN ASSEMBLY, AIR: inlet 372593 (99193)		EA	1	*	*	*	*		1	1
0 00006	5305-957-7086	SCREW: air inlet screen mtg		EA	23	*	*	*	*		1	2
0 00007 00008	5305-337-3090	SCREW, MACHINE: screen mtg		EA	2	*	*	*	*		1	3
		0122 - COMBUSTION ASSEMBLY										
0 00009	5306-151-1427	BOLT: muffler mtg		EA	6	*	*	*	*		3	6
P 0 00010	2835-772-2937	CAP ASSEMBLY: combustion chamber 373824-2 (99193)		EA	1	*	*	*	*		2	13
P 0 00011	2835-015-0222	CHAMBER ASSEMBLY, COMBUSTION 694004 (99193)		EA	1	*	*	2	2		2	16
P 0 00012	2835-017-9266	CLAMP: ejector 18849-600 (98625)		EA	1	*	*	*	*		3	2
P 0 00013	5340-932-4645	COUPLING: combustion chamber 370081 (99193)		EA	1	*	*	*	*		2	15
P O R 00014	6115-014-7173 3	EJECTOR ASSEMBLY 13207E3781-1 (99193)		EA	1	*	*	*	*		3	3
P 0 00015	2835-015-0220	FLANGE ASSEMBLY: turbine exhaust 376092-1 (99193)		EA	1	*	*	*	2		4	2

(1) SMR CODE INDEX NO.	(2) FEDERAL STOCK NUMBER	(3) DESCRIPTION REFERENCE NO. & MFR CODE USABLE ON CODE		(4) UNIT OF ISSUE	(5) QTY INC IN UNIT PACK	(6) QTY INC IN UNIT	(7) 15 DAY ORGANIZATIONAL MAINTENANCE ALW				(8) ILLUS- TRATION	
							(a)	(b)	(c)	(d)	(a) FIG NO.	(b) ITEM NO.
							1-5	6-20	21-50	51-100		
P 0 00016	5330-014-8447	GASKET: ejector A1500-6 (72433)		EA		1	*	*	*	2	3	1
P 0 00017	2835-836-8961	GASKET: turbine to flange (As required) 371959-2 (99193)		EA					*	*	4	1
P 0 00018	2835-580-2299	GASKET: turbine to flange (As required) 371959-1 (99193)		EA			*	*	*	*	4	1
P 0 00019	2835-015-0221	MUFFLER ASSEMBLY 13207E3782 (99193)		EA		1	*	*	*	*	3	4
P 0 00020	5310059-9265	NUT: flange assembly mtg 525004-9008 (99193)		EA		24	2	3	5	10	4	3
P 0 00021	5330-928-0487	PACKING PREFORMED: cap 2-258S469-4 (83259)		EA		1	2	5	10	21	2	14
P 0 00022	2835-015-0274	PIPE ASSEMBLY, EXCHANGER: exhaust 13207E3776-1 (99193)		EA		1	*	*	*	*	3	9
0 00023	5305-059-3659	SCREW, MACHINE: pipe mtg		EA		12	*	*	*	*	3	7
0 00024	5310-515-7449	WASHER, FLAT: flange mtg		EA		24	*	*	*	*	4	4
0 00025	5310-167-0835	WASHER FLAT: muffler mtg		EA		6	*	*	*	*	3	5
0 00026	5310-167-0812	WASHER, FLAT: pipe mtg		EA		12	*	*	*	*	3	8
00027		0126 - FUEL OR STEAM CONTROL										
P 0 00028	2910-065-6615	ATOMIZER ASSEMBLY, FUEL 75076-30 (99193)		EA		1	*	*	*	2	2	11
P 0 00029	530-861-1396	GASKET: valve S8316A.6U (99193)		EA		1	*	*	2	2	5	5
P 0 00030	2910-787-7142	HOUSING ATOMIZER 74807-1 (99193)		EA		1	*	*	*	*	5	2
P 0 00031	2910-592-7379	NUT, FLARED TUBE: tee to atomizer 73909 (99193)		EA		1	*	*	*	*	2	7

(1) SMR CODE INDEX NO.	(2) FEDERAL STOCK NUMBER	(3) DESCRIPTION  REFERENCE NO. & MFR CODE  USABLE ON CODE		(4) UNIT OF ISSUE	(5) QTY INC IN UNIT PACK	(6) QTY INC IN UNIT	(7) 15 DAY ORGANIZATIONAL MAINTENANCE ALW				(8) ILLUS- TRATION	
							(a)	(b)	(c)	(d)	(a)	(b)
							1-5	6-20	21-50	51-100	FIG NO.	ITEM NO.
P 0 00032	5330-845-0915	PACKING, PREFORMED: valve S8057AP5 (99193)		EA		1	*	*	*	2	5	3
P 0 00033	2910-315-8305	SCREEB, FUEL 75404 (99193)		EA		1	*	*	*	*	5	1
P 0 00034	2910-757-6859	VALVE: atomizer 376094-40 (99193)		EA		1	*	*	*	*	5	4
O 00037	5306-754-1791	BOLT: atomizer mtg OOQ35		EA		3	*	*	*	*	2	9
X2 0 00036	4730-278-0375	BOLT: elbow AN775-4 (88044)		EA		2						
O 00037	5306-151-1426	BOLT: fuel filter mtg		EA		2	*	*	*	*	6	2
O 00033	5306-274-2119	BOLT, HEXAGON HEAD: pump mtg		EA		4	*	*	*	*	7	6
O 00039	5306-151-0778	BOLT, MACHINE: valve mtg		EA		1	*	*	*	*	9	4
O 00040	5306-151-0780	BOLT: valve mtg		EA		2	*	*	*	*	9	18
P 0 00041	2910-049-3573	CAP, FILTER 73000 (99193)		EA		1	*	*	*	*	6	8
X2 0 00042	4730-585-8770	CAP, FUEL PRESSURE AN929A4 (88044)		EA		2					2	6
X2 0 00043	5340-290-0783	CLAMP: hose, heater pump MS19190F8 (96906)		EA		2						
P 0 00044	4730-231-3026	ELBOW ASSEMBLY: tube to valve AN833-4 (88644)		EA		3	*	*	2	2	9	9
O 00045	4730-186-9961	ELBOW: filter to hose, heater		EA		2	*	*	*	*	24	1
O 00046	4730-230-8710	ELBOW, FLARED TUBE: hose to valve		EA		1	*	*	*	*	9	2
O 00047	4730-186-9977	ELBOW: fuel line		EA		1	*	*	*	*		
O 00048	4730-186-9996	ELBOW: fuel line		EA		1	*	*	*	*		



(1) SMR CODE INDEX NO.	(2) FEDERAL STOCK NUMBER	(3) DESCRIPTION REFERENCE NO. & MFR CODE USABLE ON CODE		(4) UNIT OF ISSUE	(5) QTY INC IN UNIT PACK	(6) QTY INC IN UNIT	(7) 15 DAY ORGANIZATIONAL MAINTENANCE ALW				(8) ILLUS- TRATION	
							(a)	(b)	(c)	(d)	(a)	(b)
							1-5	6-20	21-50	51-100	FIG NO.	ITEM NO.
P 0 00049	6115-014-5532	FILTER ELEMENT: fuel control 111790-7 (99193)		EA		1	*	*	*	2	6	10
P 0 00050	2910-757-6857	FILTER, FUEL: main 337-501-9001 (99193)		EA		1	*	*	*	*	6	3
P 0 00051	2910-069-4500	ELEMENT, FILTER GF157 (70040)		EA		1	2	5	10	21	6	5
X1 00052		PACKING, PREFORMED: element 854616 (03608)		EA		1					6	4
P 0 00053	5330-641-1824	GASKET: elbow S8316A4 (99193)		EA		3	*	*	2	2	9	7
X2 0 00054	5330-805-2966	GASKET: nut to atomizer NS28778-4 (96906)		EA		1					2	8
P 0 00055	5330-861-1396	GASKET: valve S8316AD4 (99193)		EA		1	*	*	2	2	9	13
X2 0 00056	4720-289-4870	HOSE ASSEMBLY: heater fuel pump MS28741-4-0530 (96906)		EA		1					9	3
X2 0 00057		HOSE ASSEMBLY: valve.- to fuel filter MS28741-6-0016 (96906)		EA		1					8	1
X2 0 00058	4730-014-8285	NIPPLE: filter, heater 13207E3759 (99193)		EA		1					25	1
O 00059	5310-208-5769	NUT: elbow		EA		2	*	*	*	*	9	8
O 00060	5310-208-5775	NUT: elbow		EA		*	*	*	*	*	9	1
O 00061	5310-061-7326	NUT, SELF-LOCKING: valve mtg		EA		1	*	*	*	*	9	11
O 00062	5310-061-7326	NUT: valve mtg		EA		2	*	*	*	*	9	19
O 00063	5310-282-7897	NUT: valve to elbow		EA		1	*	*	*	*	9	16
O 00064	5310-282-7837	NUT: valve to hose		EA		1	*	*	*	*	8	2

(1) SMR CODE INDEX NO.	(2) FEDERAL STOCK NUMBER	(3) DESCRIPTION  REFERENCE NO. & MFR CODE  USABLE ON CODE		(4) UNIT OF ISSUE	(5) QTY INC IN UNIT PACK	(6) QTY INC IN UNIT	(7) 15 DAY ORGANIZATIONAL MAINTENANCE ALW				(8) ILLUS- TRATION	
							(a)	(b)	(c)	(d)	(a)	(b)
							1-5	6-20	21-50	51-100	FIG NO.	ITEM NO.
P 0 00065	5330-171-8002	PACKING: atomizer S8057A20 (99193)		EA		1	2	5	10	21	2	12
P 0 00066	5330-757-6367	PACKING: filter element S8057AP114 (99193)		EA		1	2	5	10	21	6	9
P 0 00067	5330-248-3836	PACKING: filter element MS29513-12 (96906)		EA		1	2	5	10	21	6	6
P OR 00068	2910-045-9430	PUMP: fuel 694569-1 (99193)		EA		1	*	*	*	2	7	1
X2 0 00069		BRUSH, MOTOR: fuel tank., fuel pump 7024268002B (70763)		ER		2					7	2
X2 0 00070		CAP, BRUSH HOILDER: fuel tank, fuel pump 7024159001 (70763)		EA		2					7	4
X2 0 00071		SPRING, BRUSH HOLDER 7024268002B (70763)		EA		2					7	3
P 0 00072	5310-637-2977	SPRING, FILTER 73001 (99193)		EA		1	*	*	*	2	6	7
0 00073	4730-277-5060	TEE, FLARED TUBE: car to atomizer assembly		EA		2	*	*	*	*	2	4
0 00074	4730-279-0862	TEE: hoses to hoses		EA		1	*	*	*			
P 0 00075	2835-907-0625	TUBE ASSBLY 13213E4473-1 (99193)		EA		1	*	*	*	*		
P 0 00076	2835-017-9270	TUBE ASSEMBLY, FUEL: filter inlet, outlet 13207E3758-1 (99193)		EA		2	*	*	*	*		
P 0 00077	2835-757-6815	TUBE ASSEMBLY FUEL: thermostat valve to pneumatic thermostat valve 694675 (99193)		EA		1	*	*	*	*	9	14
P 0 00078	2835-757-6805	TUBE ASSEMBLY, FUEL: tube to fuel controlunit 694528 (99193)		EA		1	*	"	*	*	* 8	3
P 0 00079	2835-928-3495	TUBE ASSEMBLY VALVE 694527 (99193)		EA		1	*	*	*	*	9	10

(1) SMR CODE INDEX NO.	(2) FEDERAL STOCK NUMBER	(3) DESCRIPTION  REFERENCE NO. & MFR CODE  USABLE ON CODE		(4) UNIT OF ISSUE	(5) QTY INC IN UNIT PACK	(6) QTY INC IN UNIT	(7) 15 DAY ORGANIZATIONAL MAINTENANCE ALW				(8) ILLUS- TRATION	
							(a)	(b)	(c)	(d)	(a) FIG NO.	(b) ITEM NO.
							1-5	6-20	21-50	51-100		
P 0 00080	2835-757-6808	TUBE ASSEMBLY: valve to tee 694788-1 (99193)		EA		1	*	*	*	*	9	15
0 00081	4730-186-9826	UNION: fuel line		EA		4	*	*	*	*		
0 00082	4730-277-6438	UNION: hose to hose		EA		1	*	*	*	*		
P 0 00083	2915-097-0325	VALVE: fuel shut-off 8151-2 (75361)		EA		1	*	*	*	2	8	4
P 0 00084	2910-719-7651	VALVE, SOLENOID 373206 (99193)		EA		1	*	*	*	2	9	6
P 0 00085	2910-689-9920	VALVE, SOLENOID: fuel shut-off 692545-2 (99193)		EA		1	*	*	*	2	9	17
0 00086	5310-167-0834	WASHER, FLAT: atomizer mtg		EA		1	*	*	*	*	2	10
0 00087	5310-167-0765	WASHER FLAT: valve mtg		EA		2	*	*	*	*	9	5
0 00088	5310-167-0834	WASHER, FLAT: valve mtg		EA		6	*	*	*	*	9	12
0 00089	5310-515-7449	WASHER: fuel filter mtg		FA		2	*	*	*	*	6	1
0 00090	5310-167-0878	WASHER, LOCK: pump mtg		EA		4	*	*	*	*	7	5
00091		0127 - LUBRICATING SYSTEM										
P 0 00092	6115-773-1884	BODY, OIL FILTER 376854 (99193)		EA		1	*	*	*	*	10	6
X2 0 00093	4730-278-0381	BOLT: elbow AN775-6 (88044)		EA		1						
0 00094	5306-156-2337	BOLT: elbow		EA		4	*	*	*	*		
0 00095	5306-150-9872	BOLT: filter body mug		EA		2	*	*	*	*	10	8
X2 0 00096	473027380	BOLT, FLUID PRESSURE: elbow AN775-8 (88044)		EA		3					14	7
X2 0 00097	473278-0380	BOLT, FLUID PRESSURE: elbow AN775-8 (88044)		EA		1					11	11

(1) SMR CODE INDEX NO.	(2) FEDERAL STOCK NUMBER	(3) DESCRIPTION  REFERENCE NO. & MFR CODE  USABLE ON CODE		(4) UNIT OF ISSUE	(5) QTY INC IN UNIT PACK	(6) QTY INC IN UNIT	(7) 15 DAY ORGANIZATIONAL MAINTENANCE ALW				(8) ILLUS- TRATION	
							(a)	(b)	(c)	(d)	(a) FIG NO.	(b) ITEM NO.
							1-5	6-20	21-50	51-100		
0 00098	5306-722-0393	BOLT, HEXAGON HEAD: clamp mtg		EA		1	*	*	*	*		
0 00099	5306-150-9221	BOLT, HEXAGON HEAD: switch mtg		EA		2	*	*	*	*	13	2
0 00100	5306-150-9221	BOLT: switch mtg		EA		2	*	*	*	*	15	3
X2 0 00101	4730-231-1332	BUSHING: filter body AN893-13D (88044)		EA		2					10	4
X2 0 00102	4730-203-7458	BUSHING: valve to tank AN893-12 (88044)		EA		1					12	7
0 00103	4730-585-8769	CAP		EA		2	*	*	*	*		
X2 0 00104	5340-014-8459	CLAMP, LOOP: oil line TA1718SS1OT (84971)		EA		2						
X2 0 00105		CLAMP, LOOP: oil line TA1718SS8T (84971)		EA		1						
X2 0 00106	5340-849-8206	CLAMP, LOOP: oil line TA1718SS4T (84971)		EA		1						
P 0 00107	4730-618-8644	CLAMP: oil cooler duct 365-63-473S (98625)		EA		2	*	*	*	2	11	5
P 0 00108	2835-337-4818	COOLER, OIL 152050 (70210)		EA		1	*	*	*	*	11	7
X2 0 00109	2835-773-1877	DIPSTICK ASSEMBLY 59633-7 (99193)		EA		1					12	1
P 0 00110	1650-530-3146	GASKET: dipstick 59687 (99193)		EA		1	*	*	2	2		
P 0 00111	6115-772-9934	DUCT ASSEMBLY, AIR: engine 75725-2 (99193)		EA		1	*	*	*	*	11	16
0 00112	4730-197-2916	ELBOW: hose to filter		EA		2	*	*	*	*	10	1
0 00113	4730-186-9997	ELBOW: oil line		EA		2	*	*	*	*		
0 00114	4730-203-8136	ELBOW: oil line		EA		2	*	*	*	*		

(1) SMR CODE INDEX NO.	(2) FEDERAL STOCK NUMBER	(3) DESCRIPTION  REFERENCE NO. & MFR CODE  USABLE ON CODE		(4) UNIT OF ISSUE	(5) QTY INC IN UNIT PACK	(6) QTY INC IN UNIT	(7) 15 DAY ORGANIZATIONAL MAINTENANCE ALW				(8) ILLUS- TRATION	
							(a)	(b)	(c)	(d)	(a) FIG NO.	(b) ITEM NO.
							1-5	6-20	21-50	51-100		
0 00115	4730-279-0119	ELBOW: oil line		EA		3	*	*	*	*		
0 00116	4730-278-5826	ELBOW, UNIVERSAL		EA		1	*	*	*	*	14	5
0 00117	4730-278-5826	ELBOW, UNIVERSAL		EA		1	*	*	*	*	11	14
0 00118	4730-277-9757	ELBOW, UNIVEBSAL: oil line		EA		2	*	*	*	*		
0 00119	4730-278-5816	ELBOW, UNIVERSAL: oil line		EA		1	*	*	*	*		
0 00120	4730-277-9762	ELBOW, UNIVERSAL: oil tank		EA		2	*	*	*	*	14	9
P 0 00121	2940-849-8358	ELEMENT ASSEMBLY 76149-1 (99193)		EA		1	3	11	21	42	10	
X1 00122		ELEMENT 74896 (99193)		EA		1					10	11
X1 00123	5330-879-8739	PACKING S8057AP19 (99193)		EA		1					10	12
X2 0 00124	5330-814-2307	GASKET: bushing to filter MS28778-12 (96906)		EA		3					10	5
12 0 00125		GASKET: hose to oil cooler AN901-8 (88044)		EA		1					11	8
P 0 00126	5330-531-2071	GASKET: hose to tank S8316K12 (99193)		EA		3	*	*	2	2	14	11
P 0 00127	5330-171-5654	GASKET: hose to switch S8316K4 (99193)		EA		1	*	*	*	*	13	4
P 0 00128	5330-171-5454	GASKET: union to breather S8316K8 (99193)		EA		3	*	*	2	2		
P 0 00129	5330-171-5654	GASKET: union to breather S8316K4 (99193)		EA		1	*	*	*	*		
P 0 00130	5330-883-4215	GASKET: valve to tank S8316AD6 (99193)		EA		1	*	2	2	4	14	3
P 0 00131	6115-641-3773	GASKET: valve to tank S8316K6 (99193)		EA		2	*	*	*	2	12	5

(1) SMR CODE INDEX NO.	(2) FEDERAL STOCK NUMBER	(3) DESCRIPTION  REFERENCE NO. & MFR CODE  USABLE ON CODE		(4) UNIT OF ISSUE	(5) QTY INC IN UNIT PACK	(6) QTY INC IN UNIT	(7) 15 DAY ORGANIZATIONAL MAINTENANCE ALW				(8) ILLUS- TRATION	
							(a)	(b)	(c)	(d)	(a) FIG NO.	(b) ITEM NO.
							1-5	6-20	21-50	51-100		
X2 0 00132		HOSE ASSMBLY: low oil pressure switch (As required) M666000-4-0216 (92532)		EA								
X2 0 00133		HOSE ASSEMBLY: oil drain fitting MS28921060060 (96906)		EA	1							
P 0 00134	4720-912-3586	HOSE ASSEMBLY, RUBBER: oil cooler-to oil pump assembly 000-601003J0194 (70128)		EA		*	*	*	*	11	10	
P 0 00135	4720-O14-8272	HOSE ASSEMBLY, RUBBER: oil tank 601000-12D0140 (70128)		EA	1	*	*	*	*	14	13	
P 0 00136	4720-757-6817	HOSE ASSEMBLY, RUBBER: oil tank elbow 601000-8D0150 (70128)		EA	1	*	*	*	*	14	8	
P 0 00137	4720-683-8899	HOSE, OIL COOLER: air duct 370899 (99193)		EA	1	*	*	*	*	11	6	
P 0 00138	2835-017-9271	MANIFOLD: oil lines 13208E8945 (99193)		EA	1	*	*	*	*			
0 00139	4730-187-0489	NIPPLE, TUBE: hose assembly to oil tank		EA	1	*	*	*	*	14	12	
0 00140	4730-187-0487	NIPPLE, TUBE: hose to breather		EA	1	*	*	*				
0 00141	4730-187-0487	NIPPLE, TUBE: hose to oil cooler		EA	1	*	*	*	*	11	9	
0 00142	4730-187-0486	NIPPLE, TUBE: hose to oil tank assembly		EA	1	*	*	*	*	14	2	
0 00143	4730-278-3242	NIPPLE, TUBE: low oil pressure switch		EA	1	*	*	*	*	13	5	
0 0014	4730-812-0882	NIPPLE, TUBE: oil line		EA	3	*	*	*	*			
0 00145	4730-277-6458	NIPPLE, TUBE: tube to tube		EA	1	*	*	*	*			
0 00146	5310-061-7326	NUT: duct mtg		EA	4	*	*	*	*	11	1	
0 00147	5310-734-5759	NUT: elbows		EA	4	*	*	*	*			
0 00148	5310-638-2605	NUT: elbow to filter		EA	2	*	*	*	*	10	2	
0 00149	5310-061-7326	NUT, PLAIN, HEXAGON: clamp mtg		EA	1	*	*	*	*			
0 00150	5310-208-5769	NUT: tee, tube		EA	1	*	*	*	*	15	2	



(1) SMR CODE INDEX NO.	(2) FEDERAL STOCK NUMBER	(3) DESCRIPTION REFERENCE NO. & MFR CODE USABLE ON CODE		(4) UNIT OF ISSUE	(5) QTY INC IN UNIT PACK	(6) QTY INC IN UNIT	(7) 15 DAY ORGANIZATIONAL MAINTENANCE ALW				(8) ILLUS- TRATION	
							(a)	(b)	(c)	(d)	(a) FIG NO.	(b) ITEM NO.
							1-5	6-20	21-50	51-100		
P 0 00168 0	5930-615-6831	SWITCH, PRESSURE: low oil 375033-1 (99193)		EA		1	*	*	*	2	13	1
00169 0	4730-278-9384	TEE, FLARED TUBE: hose assembly to valve		EA		1	*	*	*	*	12	3
00170 0	4730-278-9376	TEE: switch		EA		1	*	*	*	*	15	1
00171 P 0	4730-277-5136	TEE: tube to switch		EA		1	*	*	*	*		
00172 P 0	2835-772-9952	TUBE ASSEMBLY: accessory case to oil pressure switch 370512-6 (99193)		EA		1	*	*	*	*		
00173 P 0	2835-757-6804	TUBE ASSEMBLY: fuel 694785 (99193)		EA		1	*	*	*	*	14	10
00174 P 0	2835-015-0212	TUBE ASSEMBLY: oil cooler tube 378125 (99193)		EA		1	*	*	*	*	11	13
00175 P 0	2835-772-9951	TUBE ASSEMBLY: oil pressure line 370512-5 (99193)		EA		1	*	*	*	*		
00176 P 0	2835-015-0211	TUBE ASSEMBLY: oil pressure switch to switch M666000-4-0262 (70128)		EA		1	*	*	*	*		
00177 P 0	2835-729-5825	TUBE ASSEMBLY: oil tank filler neck drain 373223 (99193)		EA		1	*	*	*	*	14	1
00178 P 0	2835-757-6816	TUBE ASSEMBLY: thermostat 694524 (99193)		EA		1	*	*	*	*	14	6
00179 0	2835-773-1887	VALVE, DRAIN OIL 376788 (99193)		EA		1	*	*	*	*	12	6
00180 0	5310-141-1795	WASHER: body mtg		EA		2	*	*	*	*	10	7
00181 0	5310-167-0834	WASHER, FLAT: clamp mtg		EA		1	*	*	*	*		
00182 0	5310-167-0753	WASHER, FLAT: duct mtg		EA		2	*	*	*	*	11	3
00183 0	5310-167-0753	WASHER, FLAT: switch mtg		EA		2	*	*	*	*	15	4
00184	5310-167-0753	WASHER, FLAT: switch mtg		EA		2	*	*	*	*	13	3



(1) SMR CODE INDEX NO.	(2) FEDERAL STOCK NUMBER	(3) DESCRIPTION REFERENCE NO. & MFR CODE USABLE ON CODE		(4) UNIT OF ISSUE	(5) QTY INC IN UNIT PACK	(6) QTY INC IN UNIT	(7) 15 DAY ORGANIZATIONAL MAINTENANCE ALW				(8) ILLUS- TRATION	
							(a)	(b)	(c)	(d)	(a) FIG NO.	(b) ITEM NO.
							1-5	6-20	21-50	51-100		
0 00185 00186	5310-187-2401	WASHER: union, tubeto tube		EA		2	*	*	*	*		
00187 P O R	2920-792-2569	MOTOR ASSEMB.Y 76483-2 (99193)	GROUP 06 - ELECTRICAL SYSTEM (ENGINE AND VEHICULAR, ETC.) 0603 - STARTING MOTOR	EA		1	*	*	*	*	16	1
00188 0	5310-061-7325	NUT, SELF-LOCKING, HEXAGON: starter mtg		EA		4	*	*	*	*	16	3
00189 P 0	5330-726-4153	PACKING: starter mtg S8171K15 (99193)		EA		1	*	*	*	2	16	4
00190 P 0	5945-754-6611	RELAY, STARTER K1 MS24142D2 (96906)		EA		1	*	*	2	2	17	1
00191 0	5305-993-1848	SCREW, MACHINE: start relay		EA		1	*	*	*	*	17	3
00192 0	5305-995-3444	SCREW, MACHINE: start relay		EA		1	*	*	*	*	17	3
00193 0	5310-167-0835	WASHER, FLAT: starter mtg		EA		4	*	*	*	*	16	2
00194 0	5310-167-0834	WASHER, FLAT: start relay mtg		EA		2	*	*	*	*	17	2
00195 X2 0	6115-014-5040	WIRE ASSEMBLY: starter 13207E3820-5 (99193)		EA		1						
00196 X2 0	5940-557-4339	TERMINAL YAEV12CLI (09922)		EA		1						
00197 X2 0	5940-812-5186	TERMINAL YAEV2CL (09922)		EA		1						
00198 00199 0	5306-722-0393	BOLT: bracket mtg	0605 - IGNITION COMPONENTS	EA		5	*	*	*	*	18	3
00200 0	5306-180-2779	BOLT: ignition plug mtg		EA		2	*	*	*	*	2	1
00201 P 0 00202	2835-014-4545	BRACKET ASSEMBLY: ignition unit 377409 (99193)		EA		1	*	*	*	*	18	1

(1) SMR CODE INDEX NO.	(2) FEDERAL STOCK NUMBER	(3) DESCRIPTION REFERENCE NO. & MFR CODE USABLE ON CODE		(4) UNIT OF ISSUE	(5) QTY INC IN UNIT PACK	(6) QTY INC IN UNIT	(7) 15 DAY ORGANIZATIONAL MAINTENANCE ALW				(8) ILLUS- TRATION	
							(a)	(b)	(c)	(d)	(a) FIG NO.	(b) ITEM NO.
							1-5	6-20	21-50	51-100		
P 0 00203	2835-608-6146	GASKET: igniter 75099 (99193)		EA		1	2	2	4	8	2	3
P 0 00204	2920-067-6735	IGNITER: fuel 75153 (99193)		EA		1	*	*	2	2	2	2
P 0 00205	2920-888-0591	IGNITION: high 377869 (99193)		EA		1	*	*	*	*	18	5
P 0 00206	2835-650-6171	LEAD: igniter plug 76078-3 (99193)		EA		1	*	*	*	*	18	6
0 00207	5310-982-4988	NUT: igniter plug mtg		EA		2	*	*	*	*	2	5
0 00208	5310-877-5797	NUT: ignition mtg		EA		5	*	*	*	*		
0 00209	5305-989-7435	SCREW, MACHINE: ignition mtg		EA		1	*	*	*	*		
0 00210	5305-989-7434	SCREW, MACHINE: ignition mtg		EA		3	*	*	*	*		
0 00211	5310-167-0765	WASHER, FLAT: bracket mtg		EA		2	*	*	*	*	18	2
0 00212	5310-167-0753	WASHER: ignition mtg		EA		8	*	*	*	*	18	4
00213		0607 - INSTRUMENT OR ENGINE CONTROL PANEL										
P 0 00214	5920-078-8659	FUSE MS90084-15 (96906)		EA		2	*	2	2	2	20	6
P 0 00215	5920-015-0088	FUSEHOLDER J571004 (75915)		EA		1	*	*	*	*	20	3
0 00216	5310-081-8087	NUT, SELF-LOCKING: holder mtg		EA		2	*	*	*	*	20	4
P 0 00217	6115-014-5533	PANEL ASSEMBLY, INSTRUMENT 13207E3768-1 (99193)		EA		1	*	*	*	*		
P 0 00218	6625-015-0193	AMMETER, DC 13206E4593-1 (97403)		EA		1	*	*	*	*	19	8
P 0 00219	6695-855-8564	BEZEL: rpm indicator mtg MS28055-11 (96906)		EA		1	*	*	*	*	19	2
P 0 00220	6115-014-7903	BRACKET ASSEMBLY: switch 13207E3837-9 (99193)		EA		1	*	*	*	*	19	12

(1) SMR CODE INDEX NO.	(2) FEDERAL STOCK NUMBER	(3) DESCRIPTION REFERENCE NO. & MFR CODE USABLE ON CODE		(4) UNIT OF ISSUE	(5) QTY INC IN UNIT PACK	(6) QTY INC IN UNIT	(7) 15 DAY ORGANIZATIONAL MAINTENANCE ALW				(8) ILLUS- TRATION	
							(a)	(b)	(c)	(d)	(a) FIG NO.	(b) ITEM NO.
							1-5	6-20	21-50	51-100		
X2 0 00221	6680-706-8653	COUNTER ASSEMBLY: start 75341 (99193)		EA		1					19	3
P 0 00222	6620-015-0369	GAGE, OIL PRESSURE 13207E3850-1 (99193)		EA		1		SEE	GRP	4702		
P 0 00223	6680-611-0748	INDICATOR: rpm MS28000-1 (96906)		EA		1	*	*	*	*	19	1
P 0 00224	6645-580-9605	METER, TIME 357018-3 (99193)		EA		1	*	*	*	*	19	5
0 00225	5310-088-0551	NUT, SELF-LOCKING: ammeter mtg		EA		4	*	*	*	*	19	7
0 00226	5305-206-1288	SCREW, MACHINE: counter mtg		EA		4	*	*	*	*	19	9
0 00227	5305-151-0983	SCREW, ROUND HEAD: meter mtg		EA		4	*	*	*	*	19	10
P 0 00228	5930-717-1020	SWITCH: on-off start 2TL11-56 (91929)		EA		1	*	*	*	*	19	4
X2 00229		WASHER, FLAT: ammeter mtg NAS620C4 (88044)		EA		4					19	6
0 00230	5305-151-0684	SCREW, MACHINE: holder mtg		EA		2	*	*	*	*	20	9
0 00231	5310-622-9531	WASHER, FLAT: holder mtg		EA		2	*	*	*	*	20	5
00232		0608 - MISCELLANEOUS ITEMS										
0 00233	5310-877-5796	NUT, SELF-LOCKING: :lug mtg		EA		4	*	*	*	*	20	2
X2 0 00234	5935-930-3209	PLUG: receptacle 60-40735-24 (77820)		EA		1					20	8
0 00235	5305-993-2460	SCREW, MACHINE: plug mtg		EA		4	*	*	*	*	20	7
X2 0 00236	5310-167-0835	WASHER, FLAT: plug mtg AN96-416L (88044)		EA		4					20	1
00237		0612 - BATTERIES, STORAGE (WET OR DRY)										
P 0 00238	6140-057-2553	BATTERY, STORAGE MS35000-1 (96906)		EA		2	*	*	*	2		

(1) SMR CODE INDEX NO.	(2) FEDERAL STOCK NUMBER	(3) DESCRIPTION  REFERENCE NO. & MFR CODE  USABLE ON CODE		(4) UNIT OF ISSUE	(5) QTY INC IN UNIT PACK	(6) QTY INC IN UNIT	(7) 15 DAY ORGANIZATIONAL MAINTENANCE ALW				(8) ILLUS- TRATION	
							(a)	(b)	(c)	(d)	(a)	(b)
							1-5	6-20	21-50	51-100	FIG NO.	ITEM NO.
P 0 00239	6140-014-4504	BOX ASSEMBLY, BATTERY 13208E8947-1 (97403)		EA		1	*	*	*	*	21	6
P 0 00240	2835-014-4552	BRACKET ASSEMBLY 13208E8947-9 (99193)		EA		1	*	*	*	*		
P 0 00241	2835-014-4547	COVER ASSEMBLY 13208E8947-3 (99193)		EA		1	*	*	*	*	21	5
X2 0 00242	6115-014-5409	FRAME 13208E8947-67 (99193)		EA		1						
0 00243	5320-270-2953	RIVET		EA		8	*	*	*	*		
P 0 00244	6115-014-5538	SEAL 13208E8947-29 (99193)		EA		2	*	*	*	*		
X2 0 00245	5325-174-9038	GROMET MS35489-20 (96906)		EA		3						
X2 0 00246	5305-063-6717	NUT, WING, PLAIN: cover mtg AN350-5 (88044)		EA		4					21	1
X2 0 00247	5940-823-1662	TERMINAL, CLAMP, BATTERY MS91164-1N (96906)		EA		2					21	2
X2 0 00248	5940-823-1663	TERMINAL, CLAMP, BATTERY S1164-1P (96906)		EA		2					21	7
X2 0 00249	6115-014-7715	WIRE ASSEMBLY: jumper 13207E3820-16 (99193)		EA		1					21	3
X2 0 00250	5940-549-7252	TERMINAL YAEY2CL2 (09922)		EA		2						
X2 0 00251	6115-014-7710	WIRE ASSEMBLY: starter relay, negative 13207E3820-2 (99193)		EA		1					21	8
0 00252	5940-549-7252	TERMINAL		EA		1	*	*	*	*		
0 00253	5940-812-5186	TERMINAL		EA		1	*	*	*	*		
X2 0 00254	6115-014-7711	WIRE ASSEMBLY: starter relay, positive 13207E3820-1 (99193)		EA		1					21	9

(1) SMR CODE INDEX NO.	(2) FEDERAL STOCK NUMBER	(3) DESCRIPTION REFERENCE NO. & MFR CODE USABLE ON CODE		(4) UNIT OF ISSUE	(5) QTY INC IN UNIT PACK	(6) QTY INC IN UNIT	(7) 15 DAY ORGANIZATIONAL MAINTENANCE ALW				(8) ILLUS- TRATION	
							(a)	(b)	(c)	(d)	(a) FIG NO.	(b) ITEM NO.
							1-5	6-20	21-50	51-100		
X2 0 00255	5940-812-5186	TERMINAL YAEV2CL (09922)		EA		1						
X2 0 00256 00257	5940-840-5436	TERMINAL YAV2CL2 (09922)		EA		1						
P 0 00258	2835-015-0252	BRACKET, MOUNTING: wiring harness 379392-1 (99193)	0613 - HULL OR CHASSIS WIRING HARNESS	EA		1	*	*	*	*	11	18
0 00259	5305-855-0987	SCREW: bracket mtg		EA		2	*	*	*	*	11	17
P 0 00260	5340-014-8453	SPACER: bracket mtg S8168-7C0750F (99193)		EA		2	*	*	*	*	11	19
0 00261 00262	5310-167-0753	WASHER: bracket mtg		EA		2	*	*	*	*	11	3
00263			GROUP 18 - BODY, CAB, HOOD AND HULL 1801 - BODY, CAB, HOOD, HULL ASSEMBLIES									
X2 0 00264	6115-017-9191	ENCLOSURE ASSBL 13207E3780-1 (99193)		EA		1						
P 0 00265	6115-014-7650	DOOR ASSEMBLY: access, ac power panel 13208E8970-1 (99193)		EA		1	*	*	*	*	22	3
P 0 00266	6115-014-5610	DOOR ASSEMBLY, LH 13208E8946-1 (99193)		EA		1	*	*	*	*	23	1
0 00267	5310-807-1467	NUT: support mtg		EA		1	*	*	*	*	23	12
0 00268	5305-282-8470	SCREW: support mtg		EA		1	*	*	*	*	23	9
P 0 00269	6115-014-5544	SUPPORT ASSEMBLY, DOOR 13208E8974-1 (99193)		EA		1	*	*	*	*	23	8
0 00270	5310-167-0801	WASHER support mtg		EA		3	*	*	*	*	23	11
0 00271	5310-167-0812	WASHER: support mtg		EA		4	*	*	*	*	23	10

(1) SMR CODE INDEX NO.	(2) FEDERAL STOCK NUMBER	(3) DESCRIPTION  REFERENCE NO. & MFR CODE  USABLE ON CODE		(4) UNIT OF ISSUE	(5) QTY INC IN UNIT PACK	(6) QTY INC IN UNIT	(7) 15 DAY ORGANIZATIONAL MAINTENANCE ALW				(8) ILLUS- TRATION	
							(a)	(b)	(c)	(d)	(a)	(b)
							1-5	6-20	21-50	51-100	FIG NO.	ITEM NO.
P 0 00272	6115-014-5550	DOOR ASSEMBLY: panel 13208E8978-5 (99193)		EA		1	*	*	*	*		
P 0 00273	6115-014-7638	DOOR ASSEMBLY, PANEL: protective door 13208E8951-1 (99193)		EA		1	*	*	*	*	23	
X1 00274	6115-014-8063	FRAME: door panel mtg 13208E8951-5 (99193)		EA		1					23	15
X2 0 00275		HINGE: door frame MS2057C4-2950 (96906)		EA		1					23	20
X2 0 00276	5310-274-8321	NUT: frame mtg 22NKM62 (72962)		EA		28					23	17
X1 00277	6115-014-7700	PANEL: door 13208E8951-3 (99193)		EA		1					23	18
X1 00278	5620-014-8064	PLATE GLASS: door 132088951-7 (99193)		EA		1					23	14
0 00279	5305-282-9908	SCREW: frame mtg		EA		28	*	*	*	*	23	19
X2 0 00280	6115-014-8065	SEAL: panel 13208E8951-7 (99193)		EA		1					23	13
0 00281	5310-531-9514	WASHER: frame mtg		EA		28	*	*	*	*	23	16
P 0 00282	6115-014-5541	DOOR ASSEMBLY: rh, side enclosure 13207E3753-1 (99193)		EA		1	*	*	*	*	23	7
0 00283	5310-807-1467	NUT: support mtg		EA		1	*	*	*	*	23	12
0 00284	5305-282-8470	SCREW: support mtg		EA		1	*	*	*	*	23	9
P 0 00285	6115-014-5544	SUPPORT ASSEMBLY DOOR 13208E8974-1 (99193)		EA		1	*	*	*	*	23	8
0 00286	5310-167-0801	WASHER: support mtg		EA		2	*	*	*	*	23	11
0 00287	5310-167-0812	WASHER: support mtg		EA		3	*	*	*	*	23	10
P 0 00288	6115-014-5513	HOIST ASSEMBLY 13207E3738-1 (99193)		EA		4	*	*	*	*	22	1

(1) SMR CODE INDEX NO.	(2) FEDERAL STOCK NUMBER	(3) DESCRIPTION  REFERENCE NO. & MFR CODE  USABLE ON CODE		(4) UNIT OF ISSUE	(5) QTY INC IN UNIT PACK	(6) QTY INC IN UNIT	(7) 15 DAY ORGANIZATIONAL MAINTENANCE ALW				(8) ILLUS- TRATION	
							(a)	(b)	(c)	(d)	(a)	(b)
							1-5	6-20	21-50	51-100	FIG NO.	ITEM NO.
X2 0 00289	6115-014-8149	PANEL ASSEMBLY, CENTER 13207E3771-1 (99193)		EA		1					23	4
X2 0 00290	6115-014-8157	PANEL ASSEMBLY, TOP 13207E3756-1 (99193)		EA		1					23	6
X2 0 00291	6115-014-8158	PANEL, ASSMBLEY: access 13207Z3756-3 (99193)		EA		1					23	5
0 00292	5315-815-1405	PIN, COTTER: hoist		EA		4	*	*	*	*	22	4
0 00293	5315-014-8431	PIN: hoist		EA		4	*	*	*	*	22	5
0 00294	5320-117-6881	RIVET: door mtg		EA		8	*	*	*	*	22	2
0 00295	5305-151-0828	SCREW door mtg		EA		55	*	*	*	*	23	2
0 00296	5310-167-0812	WASHER: door mtg		EA		30	*	*	*	*	23	3
00297 00298		GROUP 22 - BODY CHASSIS OR HULL, AND ACCESSORY ITEMS 2201 - CANVAS, RUBBER, OR PLASTIC ITM€S										
P 0 00299	8340-015-0279	TARPAULIN 13208S950-1 (99193)		EA		1	*	*	*	*		
X1 00300	6115-014-7696	CANVAS 13208E8950-7 (99193)		EA		1						
X1 00301	6115-014-7695	CANVAS 1320SE8950-5 (99193)		EA		1						
X1 00302	6115-014-7692	COVER ASSEMBLY 13208E8950-3 (99193)		EA		1						
X2 0 00303	5325-785-8143	FASTENER MS27977-1B (96906)		EA		23						
X2 0 00304	5325-276-4283	PLATE K57977-3B (96906)		EA		23						
00305 0		2207 - WINTERIZATION EQUIPMENT										
0 00306	5306-150-9527	BOLT: heater fuel pump mtg		EA		2	*	*	*	*	26	3

(1) SMR CODE INDEX NO.	(2) FEDERAL STOCK NUMBER	(3) DESCRIPTION  REFERENCE NO. & MFR CODE  USABLE ON CODE		(4) UNIT OF ISSUE	(5) QTY INC IN UNIT PACK	(6) QTY INC IN UNIT	(7) 15 DAY ORGANIZATIONAL MAINTENANCE ALW				(8) ILLUS- TRATION	
							(a)	(b)	(c)	(d)	(a) FIG NO.	(b) ITEM NO.
							1-5	6-20	21-50	51-100		
0 00307 P 0	5306-274-2119	BOLT, MACHINE: bracket to plate, plate mtg		EA		10	*	*	*	*	25	7
00308 P 0	4730-852-8931	CLAMP: exhaust duct QS200M28S (08484)		EA		1	*	*	*	2	25	4
00309 P 0	4730-877-9822	CLAMP: hot air duct QS200M88S (08484)		EA		1	*	*	*	2	25	3
00310 X2 0	2915-025-3493	FILTER ASSEMBLY, FUEL 450-0 (90005)		EA		1	*	*	*	*	24	
00311 P 0	2910-031-9083	BOWL, FILTER 26413 (90005)		EA		1					24	6
00312 X2 0	2910-203-3322	ELEMENT ASSEMBLY 569807 (90005)		EA		1	*	*	2	2	24	4
00313 P 0	2910-335-9343	HEAD, FILTER 451-0 (90005)		EA		1					24	2
00314 X2 0	5330-265-1089	PACKING 26405A (90005)		EA		1	*	*	2	2	24	3
00315 P 0 R	2915-201-0259	SPRING 26417A (90005)		EA		1					24	5
00316 X2 0	2990-014-7484	HEATER, INTERNAL COMBUSTION 13208E896-1 (97403)		EA		1	*	*	*	^	25	9
00317 X2 0		BRACKET: cover A2145 (80684)		EA		1					29	4
00318 X2 0	6115-873-1778	CONNECTOR: tube A2087 (80684)		EA		1					29	5
00319 P 0		COVER, PROTECTIVE: heater B2489 (80684)		EA		1					29	3
00320 P 0	6115-691-5493	GASKET, IGNITER A2096 (80684)		EA		1	*	2	2	4	29	9
00321	2920-902-7063	IGNITER ASSEMBLY: burner heater A2053-1 (80684)		EA		1	*	*	2	2	29	8



(1) SMR CODE INDEX NO.	(2) FEDERAL STOCK NUMBER	(3) DESCRIPTION  REFERENCE NO. & MFR CODE  USABLE ON CODE		(4) UNIT OF ISSUE	(5) QTY INC IN UNIT PACK	(6) QTY INC IN UNIT	(7) 15 DAY ORGANIZATIONAL MAINTENANCE ALW				(8) ILLUS- TRATION	
							(a)	(b)	(c)	(d)	(a)	(b)
							1-5	6-20	21-50	51-100	FIG NO.	ITEM NO.
P 0 00322	2910-874-3241	ORIFACE ASSEMBLY A2084 (80684)		EA		1	*	*	*	*	29	7
X2 0 00323		SCREW, MACHINE switch mtg A2170 (80684)		EA		2					29	1
P 0 00324	5930-788-2825	SWITCH LIMIT: heater A2075 (80684)		EA		1	*	*	*	*	29	2
P 0 00325	6115-014-5620	TUBE ASSEMBLY: orifice A2157 (80684)		EA		1	*	*	*	*	29	6
0 00326	5310-061-7326	NUT, PLAIN, HEXAGON plate mtg		EA		4	*	*	*	*		
P 0 00327	6115-014-5631	PIPE ASSEMBLY, HEATER 1320-8E871-1 (99193)		EA		1	*	*	*	*	25	6
X2 0 00328		PLATE: heater mtg 132077/95 (99193)		EA		1						
P 0 R 00329	2910-854-3664	PUMP ASSEMBLY. HEATER 476491 (72850)		EA		1	*	*	*	*	26	1
0 00330	5305-151-0827	SCREW, MACHINE		EA		2	*	*	*	*		
0 00331	5305-059-3659	SCREW, MACHINE		EA		3	*	*	*	*		
P 0 00332	5330-014-5632	SEAL: heater 13208397-3 (99193)		EA		1	*	*	*	*	25	5
P 0 00333	5330-014-5633	SEAL, HEATER 13208BM3-5 (99193)		EA		1	*	*	*	*	25	2
P 0 00334	5930-015-0061	SENSOR, TEMPERATURE 3051641 (99193)4		EA		1	*	*	*	*	21	4
0 00335	5310-167-0878	WASHER FLAT fuel pump mtg		EA		2	*	*	*	*	26	2
0 00336	5310-167-0812	WASHER FLAT fuel pump mtg, bracket mtg		EA		15	*	*	*	*	25	8
00337 X2 0 00338	7690-779-8816	2210 - DATA PLATES AND INSTRUCTION HLDERS DECAL, DATE S8265 (99193)		EA		1						



(1) SMR CODE INDEX NO.	(2) FEDERAL STOCK NUMBER	(3) DESCRIPTION  REFERENCE NO. & MFR CODE  USABLE ON CODE		(4) UNIT OF ISSUE	(5) QTY INC IN UNIT PACK	(6) QTY INC IN UNIT	(7) 15 DAY ORGANIZATIONAL MAINTENANCE ALW				(8) ILLUS- TRATION	
							(a)	(b)	(c)	(d)	(a) FIG NO.	(b) ITEM NO.
							1-5	6-20	21-50	51-100		
P 0 00354	6115-015-0381	PLATE, INSTRUCTION: voltage charge 13208E8956 (99193)		EA		1	*	*	*	*		
P 0 00355	6115-015-0383	PLATE, INSTRUCTION: wiring 13208E8958 (99193)		EA		1	*	*	*	*		
P 0 00356	9905-633-9140	PLATE, MODEL S8266-1 (99193)		EA		1	*	2	2	2		
0 00357	5320-117-6938	RIVET: plate mtg		EA		10	*	*	*	*		
0 00358	5305-282-9153	SCREW: instruction plate mtg		EA		4	*	*	*	*		
0 00359	5305-282-9154	SCREW: labels, plates		EA		10	*	*	*	*		
P 0 00360	8135-567-1863	TAG, WARNING S8145-15 (99193)		EA		1	*	*	2	2		
P 0 00361	8135-567-1862	TAG, WARNING S8145-17 (99193)		EA		1	*	*	2	2		
X2 0 00362	5310-723-9676	WASHER: labels, plate NAS620C4L (80205)		EA		28						
00363 00364		GROUP 40 - ELECTRIC MOTORS AND GENERATORS 4004 - VENTILATING SYSTEM										
X2 0 00365	4730-720-1249	CLAMP: hoses QS100M48S (08484)		EA		1					27	3
X2 0 00366	4730-277-7136	CLAMP: hoses QS100M64S (08484)		EA		3					27	2
P 0 00367	4720-014-7679	HOSE, AIR DUCT: inlet 13207E3749 (99193)		EA		1	*	*	*	*	27	1
P 0 00368	4720-014-7680	HOSE, AIR DUCT: outlet 13207E3750-1 (99193)		EA		1	*	*	*	*	27	4
00369 P 0 00370	6625-015-0191	4009 - CONTROL PANELS, HOUSING, CUBICLES AMMETER, AC 1320614599-1 (99193)		EA		1	*	*	*	*	30	8

(1) SMR CODE INDEX NO.	(2) FEDERAL STOCK NUMBER	(3) DESCRIPTION  REFERENCE NO. & MFR CODE  USABLE ON CODE		(4) UNIT OF ISSUE	(5) QTY INC IN UNIT PACK	(6) QTY INC IN UNIT	(7) 15 DAY ORGANIZATIONAL MAINTENANCE ALW				(8) ILLUS- TRATION	
							(a)	(b)	(c)	(d)	(a)	(b)
							1-5	6-20	21-50	51-100	FIG NO.	ITEM NO.
X2 0 00371	6210-635-4410	COVER, LIGHT 80-537 (72619)		EA		2					28	1
X2 0 00372	6240-019-0878	LAMP, INCANDESCENT: panel lights MS15569-7 (96906)		EA		3					28	4
P 0 00373	6240-143-3060	LAMP: synchronizing light 6S6DC120V (24455)		EA		2	*	2	2	4	28	2
X2 0 00374	6210-660-8462	LIGHT ASSEMBLY: main circuit breaker enclosure MS25331-3 (96906)		EA		1					28	6
X2 0 00375		LAMP, INCANDESCENT MS25213 (96906)		EA		1					28	5
P 0 00376	6210-669-6474	LIGHT: panel 473504 (72619)		EA		3	*	2	2	3	28	3
P 0 00377	6115-014-5521	LIGHT: synchronizing 803202-1235 (72619)		EA		2	*	2	2	2	28	9
X2 0 00378	6210-722-6455	LIGHT: winterization heater and over voltage MS25331-8-313 (96906)		EA		2					28	8
X2 0 00379		LAMP, INCANDESCENT MS25231 (96906)		EA		2					28	7
0 00380	5310-905-8451	NUT, PLAIN, HEXAGON: meter mtg		EA		6	*	*	*	*	30	9
0 00381	5310-811-3494	NUT, SELF-LOCKING, HEXAGON: resistor mtg		EA		6		SEE	GRP	4014		
P 0 00382	5905-015-0053	RESISTOR: synchronizing light, 2500 ohms RH10-2-5K (91637)		EA		2		SEE	GRP	4014		
P 0 00383	5905-015-0054	RESISTOR: synchronizing light, 5000 ohms RH10-5X (91637)		EA		2		SEE	GRP	4014		
0 00384	5305-637-1125	SCREW, MACHINE: meter mtg		EA		6	*	*	*	*	30	7
0 00385	5305-984-6193	SCREW, MACHINE: resistor mtg		EA		6		SEE	GRP	4014		
X2 0 00386	6250-014-7901	RETAINER, PANEL LIGHT 13207E3816 (99193)		EA		3						

(1) SMR CODE INDEX NO.	(2) FEDERAL STOCK NUMBER	(3) DESCRIPTION REFERENCE NO. & MFR CODE USABLE ON CODE		(4) UNIT OF ISSUE	(5) QTY INC IN UNIT PACK	(6) QTY INC IN UNIT	(7) 15 DAY ORGANIZATIONAL MAINTENANCE ALW				(8) ILLUS- TRATION	
							(a)	(b)	(c)	(d)	(a) FIG NO.	(b) ITEM NO.
							1-5	6-20	21-50	51-100		
0 00387	5305-989-7434	SCREW, MACHINE: panel light mtg		EA		6	*	*	*	*		
P 0 00388	6625-015-0192	VOLTMETER 13206E4590-1 (99193)		EA		1	*	*	*	*	30	5
X2 0 00389	5310-638-9857	WASHER, FLAT: meter mtg AN960C6L (88044)		EA		6					30	6
0 00390	5310-167-0834	WASHER, FLAT: panel light assembly		EA		6	*	*	*	*		
00391		4014 - RESISTORS (FIXED VARIABLE OR TAPPED)										
0 00392	5310-811-3494	NUT, SELF-LOCKING, HEXAGON: resistor mtg		EA		6	*	*	*	*	30	4
P 0 00393	5905-015-0053	RESISTOR: synchronizing lights, 2500 ohms RH10-2-5K (91637)		EA		2	*	*	*	2	30	2
P 0 00394	5905-015-0054	RESISTOR: synchronizing lights, 5000 ohms RH10-5K (91637)		EA		2	*	*	*	2	30	10
0 00395	5310-984-6193	SCREW, MACHINE: resistor mtg		EA		6	*	*	*	*	30	1
0 00396	5310-274-8669	WASHER, LOCK: resistor mtg		EA		6	*	*	*	*	30	3
00397		4018 - TERMINAL BLOCKS, JUNCTION BOXES										
X2 0 00398		CHAIN ASSEMBY: ground NAS1201C13A13B (99193)		EA		1						
P 0 00399	6115-014-5659	PANEL ASSEMBLY: voltage change 13208E8976-3 (99193)		EA		1	*	*	*	*		
P 0 00400	6115-014-5656	PANEL: voltage distribution 13208E8975 (99193)		EA		1	*	*	*	*		
P 0 00401	6115-014-5654	SPACER 13208E8964-5 (99193)		EA		4	*	*	*	2		
X2 0 00402	5940-577-3711	TERMINAL 31889 (00779)		EA		4						
X2 0 00403	5940-204-8990	TERMINAL 32542 (00779)		EA		7						

(1) SMR CODE INDEX NO.	(2) FEDERAL STOCK NUMBER	(3) DESCRIPTION REFERENCE NO. & MFR CODE USABLE ON CODE		(4) UNIT OF ISSUE	(5) QTY INC IN UNIT PACK	(6) QTY INC IN UNIT	(7) 15 DAY ORGANIZATIONAL MAINTENANCE ALW				(8) ILLUS- TRATION	
							(a)	(b)	(c)	(d)	(a)	(b)
							1-5	6-20	21-50	51-100	FIG NO.	ITEM NO.
X2 0 00404	5940-204-8966	TERMINAL 31882 (00779)		EA		3						
X2 0 00405	5940-577-3711	TERMINAL 31889 (00779)		EA		6						
X2 0 00406	5940-204-8990	TERMINAL 32542 (00779)		EA		1						
X2 0 00407	5940-557-1629	TERMINAL 31888 (00779)		EA		60						
X2 0 00408	5940-204-8966	TERMINAL 31882 (00779)		EA		45						
X2 0 00409	5940-557-4398	TERMINAL 31878 (00779)		E		11						
0 00410	5310-167-0834	WASHER, FLAT: voltage change panel mtg		EA		6	*	*	*	*		
0 00411	5310-184-8969	WASHER, LOCK: ac power panel		E8		8	*	*	*	*		
00412 00413		GROUP 42 - ELECTRICAL EQUIPMENT 4213 - NON ROTATING RECTIFIERS, CONVERTERS INVERTERS										
P 0 00414	5920-240-4066	BLOCK, FUSE 4515 (71400)		EA		1	*	*	*	*		
P 0 00415	5920-284-7039	BLOCK, FUSE 4512 (71400)		EA		1	*	*	*	*		
X2 0 00416		CAP, FUSE HOLDER: battery charger fuse F8N20G (75915)		EA		1						
P 0 00417	5920-539-6920	FUSE MS90079-9 (96906)		EA		1	*	*	2	2		
0 00418	5310-081-8087	NUT, SELF-LOCKING: fuse block mtg		EA		4	*	*	*	*		
0 00419	5305-282-9458	SCREW, MACHINE: fuse block mtg		EA		4	*	*	*	*		
0 00420	5310-167-0816	WASHER, PLAT: fuse block mtg		EA		4	*	*	*	*		



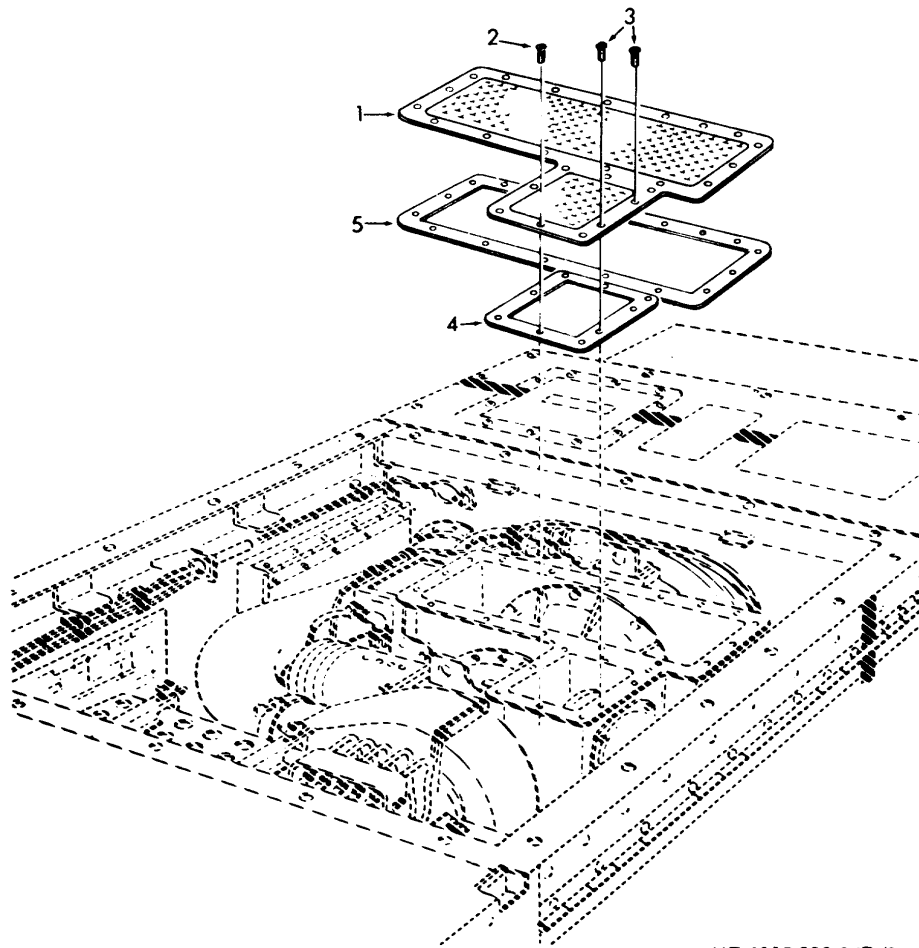

ME 6115-320-34P/2

**Figure 1. Screen and Mounting Gaskets.**

INDEX TO PARTS, FIGURE 1

Reference Number	Functional Group	Item Name
1	0121	SCREEN AY
2	0121	SCREW
3	0121	SCREW
4	0121	GASKET
0121	GASKET	

5



INDEX TO PARTS, FIGURE 2

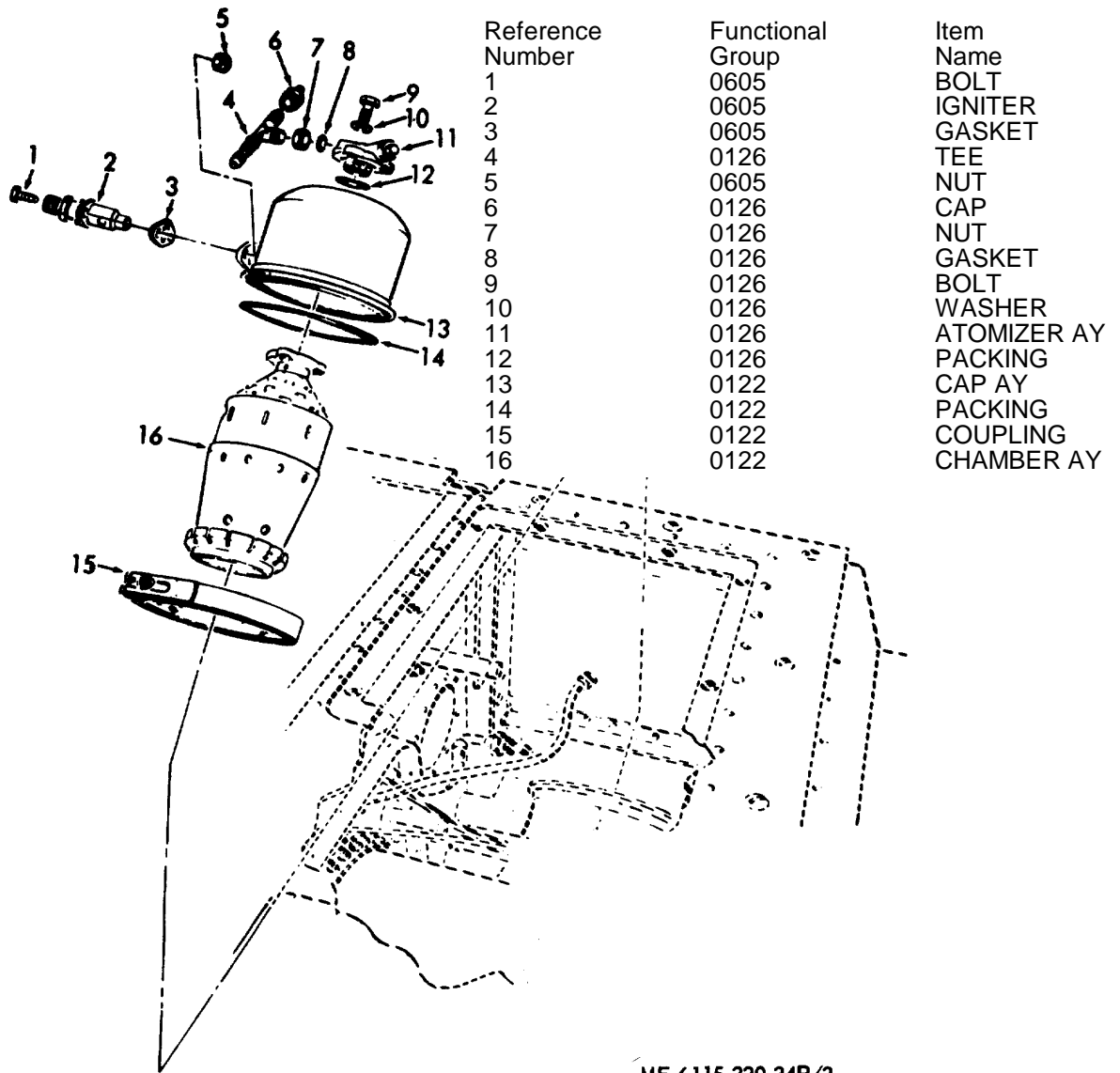

Reference Number	Functional Group	Item Name
1	0605	BOLT
2	0605	IGNITER
3	0605	GASKET
4	0126	TEE
5	0605	NUT
6	0126	CAP
7	0126	NUT
8	0126	GASKET
9	0126	BOLT
10	0126	WASHER
11	0126	ATOMIZER AY
12	0126	PACKING
13	0122	CAP AY
14	0122	PACKING
15	0122	COUPLING
16	0122	CHAMBER AY

ME 6115-320-34P/3

Figure 2. Combustor Cap and Combustion Chamber.

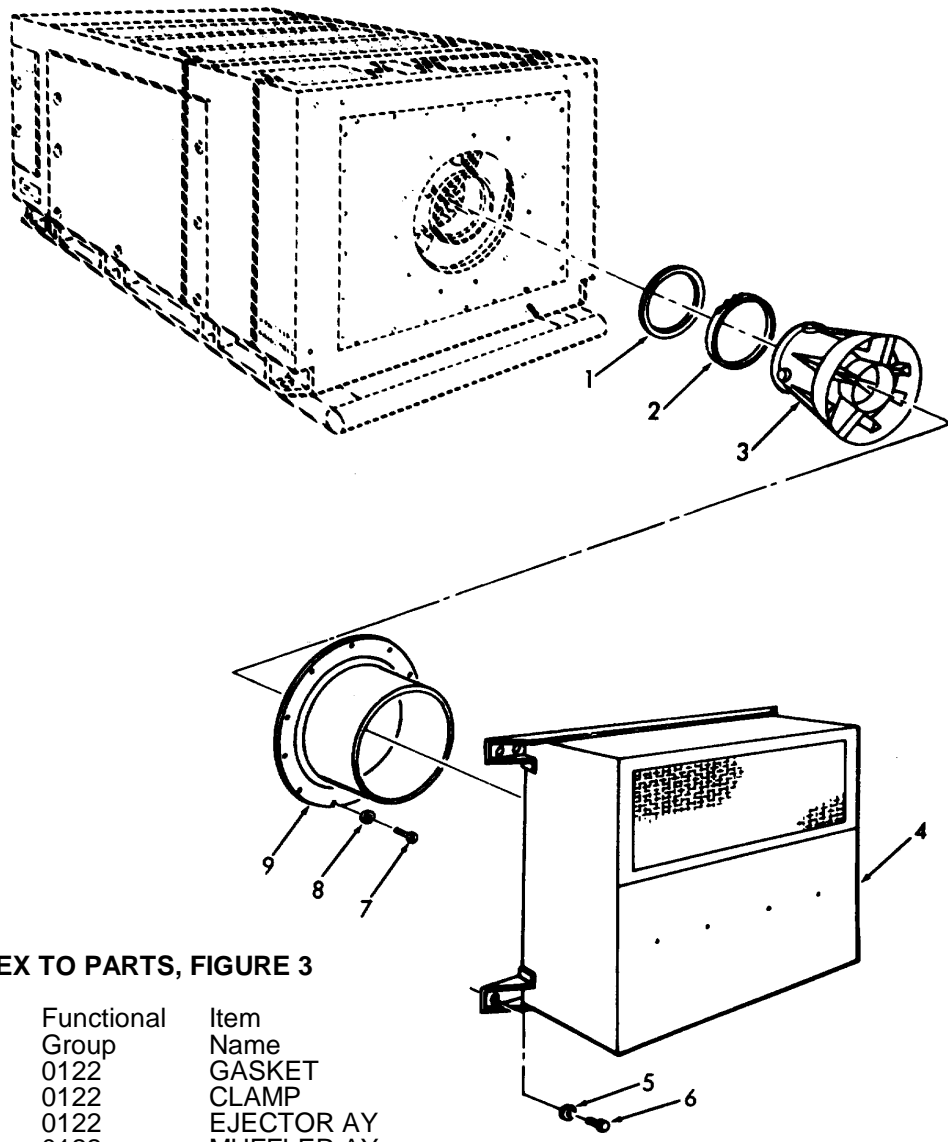

**INDEX TO PARTS, FIGURE 3**

Reference Number	Functional Group	Item Name
1	0122	GASKET
2	0122	CLAMP
3	0122	EJECTOR AY
4	0122	MUFFLER AY
5	0122	WASHER
6	0122	BOLT
7	0122	SCREW
8	0122	WASHER
9	0122	PIPE AY

ME 6115-320-34P/4

**Figure 3. Muffler, Ejector and Pipe.**

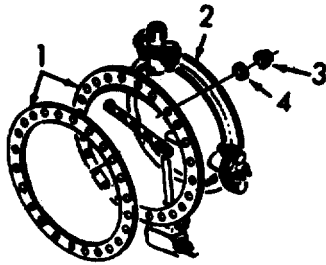

**ME 6115-320-20P/4**

**Figure 4. Exhaust Flange.**

INDEX TO PARTS, FIGURE 4

	Reference Number	Functional Group	Item Name
1	0122	GASKET	
2	0122	FLANGE AY	
3	0122	NUT	
4	0122	WASHER	

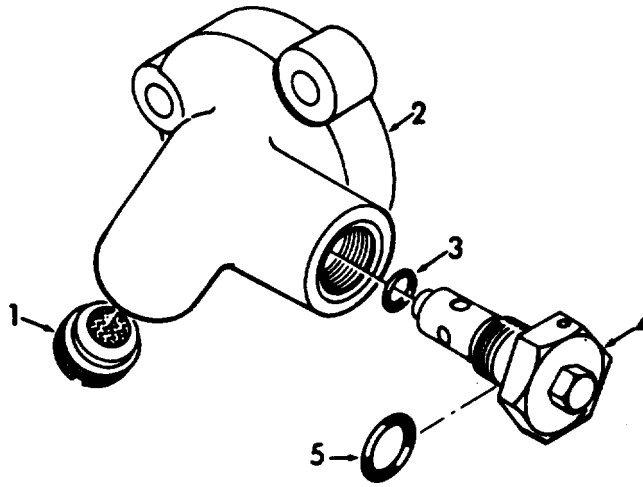

ME 6115-320-34P/8

Figure 5. Atomizer Explode.

INDEX TO PARTS, FIGURE 5

	Reference Number	Functional Group	Item Name
1	0126	SCREEN	
2	0126	HOUSING	
3	0126	PACKING	
4	0126	VALVE	
5	0126	GASKET	

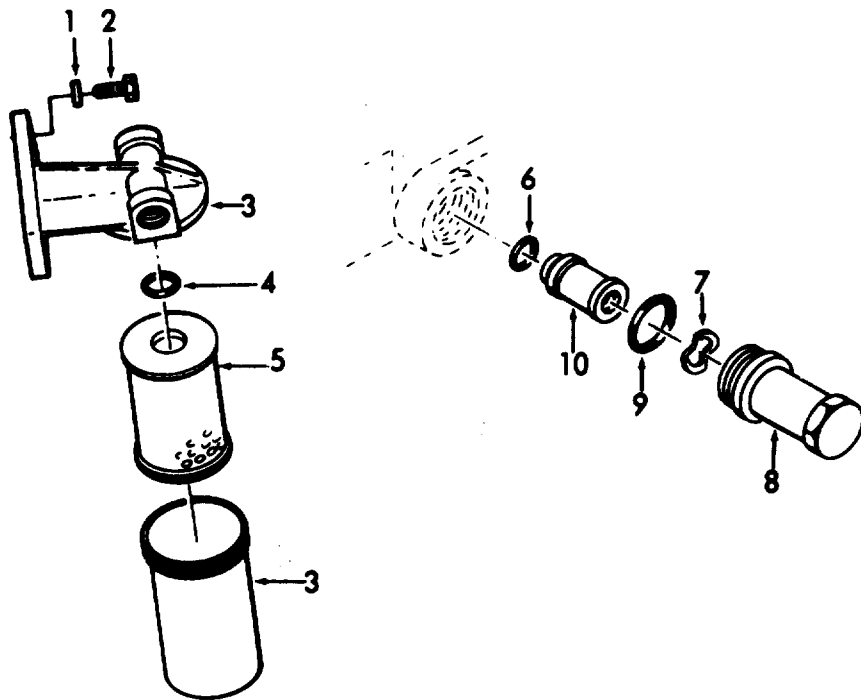

ME 6115-320-34P/9

Figure 6. Fuel Filter and Fuel Control.

INDEX TO PARTS, FIGURE 6

Reference Number	Functional Group	Item Name
1	0126	WASHER
2	0126	BOLT
3	0126	FILTER
4	0126	PACKING
5	0126	ELEMENT
6	0126	PACKING
7	0126	SPRING
8	0126	CAP
9	0126	PACKING
10	0126	FILTER ELEMENT

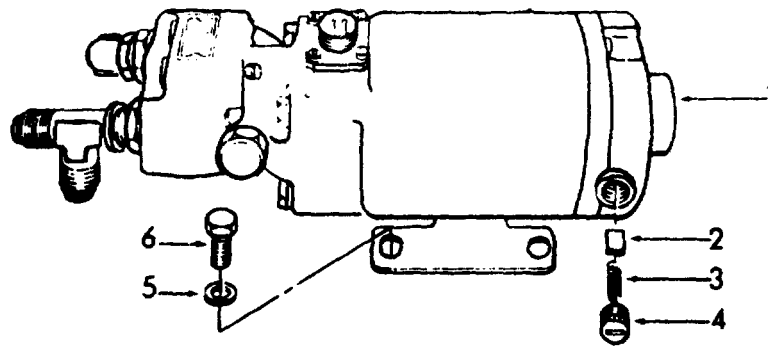

ME 6115-320-20P/7

Figure 7. Fuel Pump.

INDEX TO PARTS, FIGURE 7

	Reference Number	Functional Group	Item Name
1	0126	PUMP	
2	0126	BRUSH	
3	0126	SPRING	
4	0126	CAP	
5	0126	WASHER	
6	0126	BOLT	

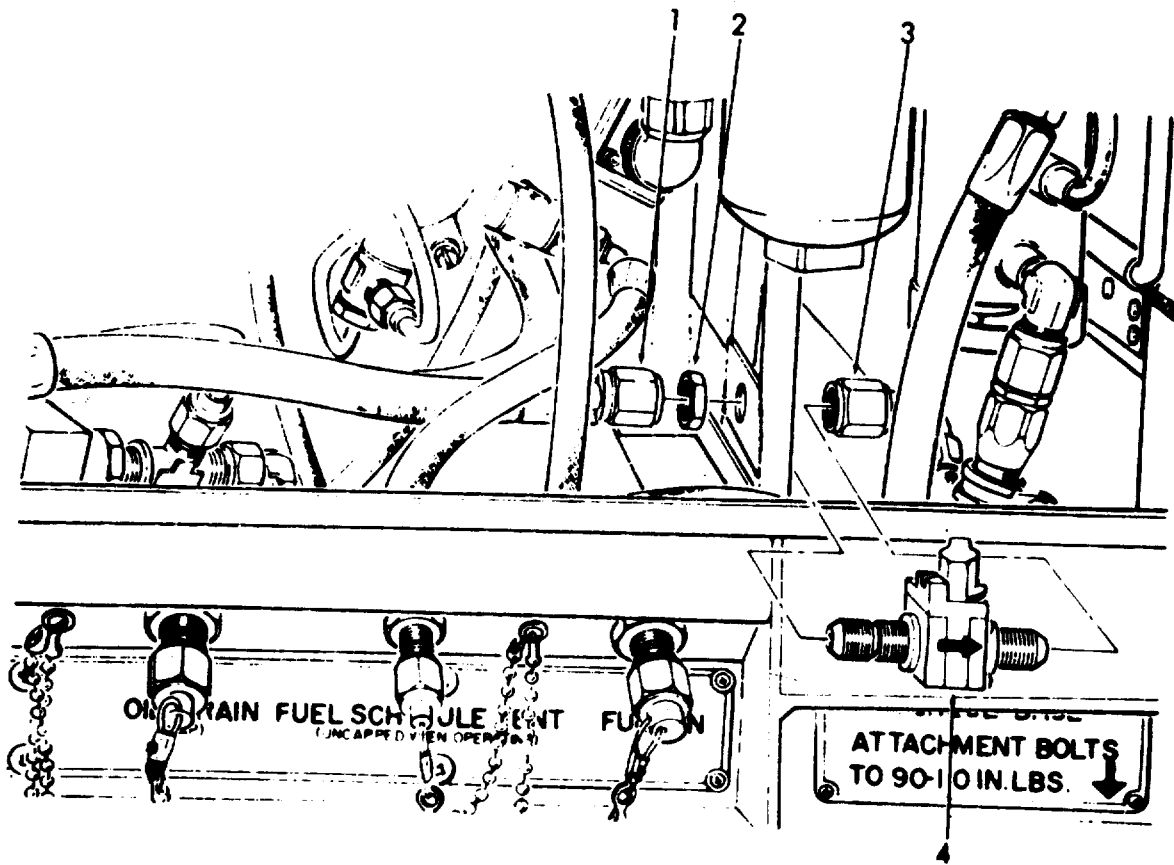

ME 6115-320-34P/12

Figure 8. Heater Fuel Shut Off Valve.

INDEX TO PARTS, FIGURE 8

	Reference Number	Functional Group	Item Name
1	0126	HOSE	AY
2	0126	NUT	
3	0126	TUBE	AY
4	0126	VALVE	

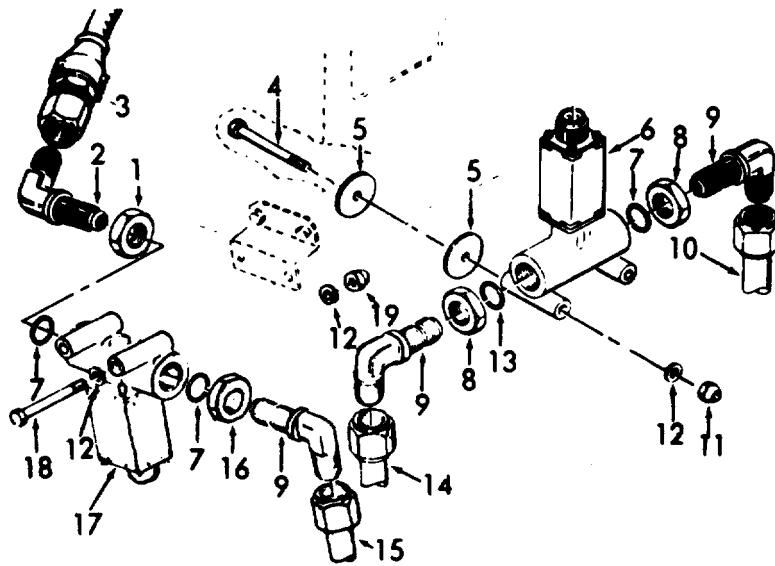

ME 6115-320-34P/13

Figure 9. Fuel Shut Off and Thermostat By-Pass Valves.

INDEX TO PARTS, FIGURE 9

Reference Number	Functional Group	Item Name
1	0126	NUT
2	0126	ELBOW
3	0126	HOSE AY
4	0126	BOLT
5	0126	WASHER
6	0126	VALVE
7	0126	GASKET
8	0126	NUT
9	0126	ELBOW AY
10	0126	TUBE AY
11	0126	NUT
12	0126	WASHER
13	0126	GASKET
14	0126	TUBE AY
15	0126	TUBE AY
16	0126	NUT
17	0126	VALVE
18	0126	BOLT
19	0126	NUT



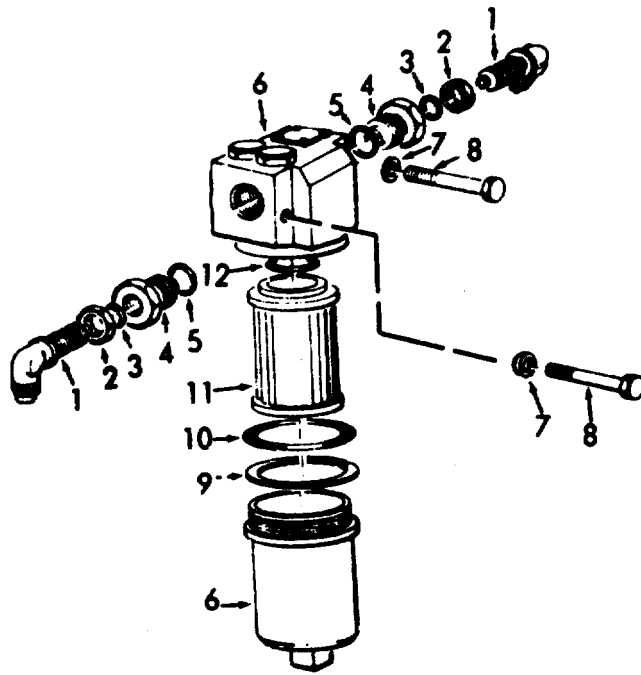

ME 6115-320-34P/14

Figure 10. Oil Filter Explode.

INDEX TO PARTS, FIGURE 10

Reference Number	Functional Group	Name Name
1	0127	ELBOW
2	0127	NUT
3	0127	PACKING
4	0127	BUSHING
5	0127	GASKET
6	0127	BODY
7	0127	WASHER
8	0127	BOLT
9	0127	RETAINER
10	0127	PACKING
11	0127	ELEMENT
12	0127	PACKING

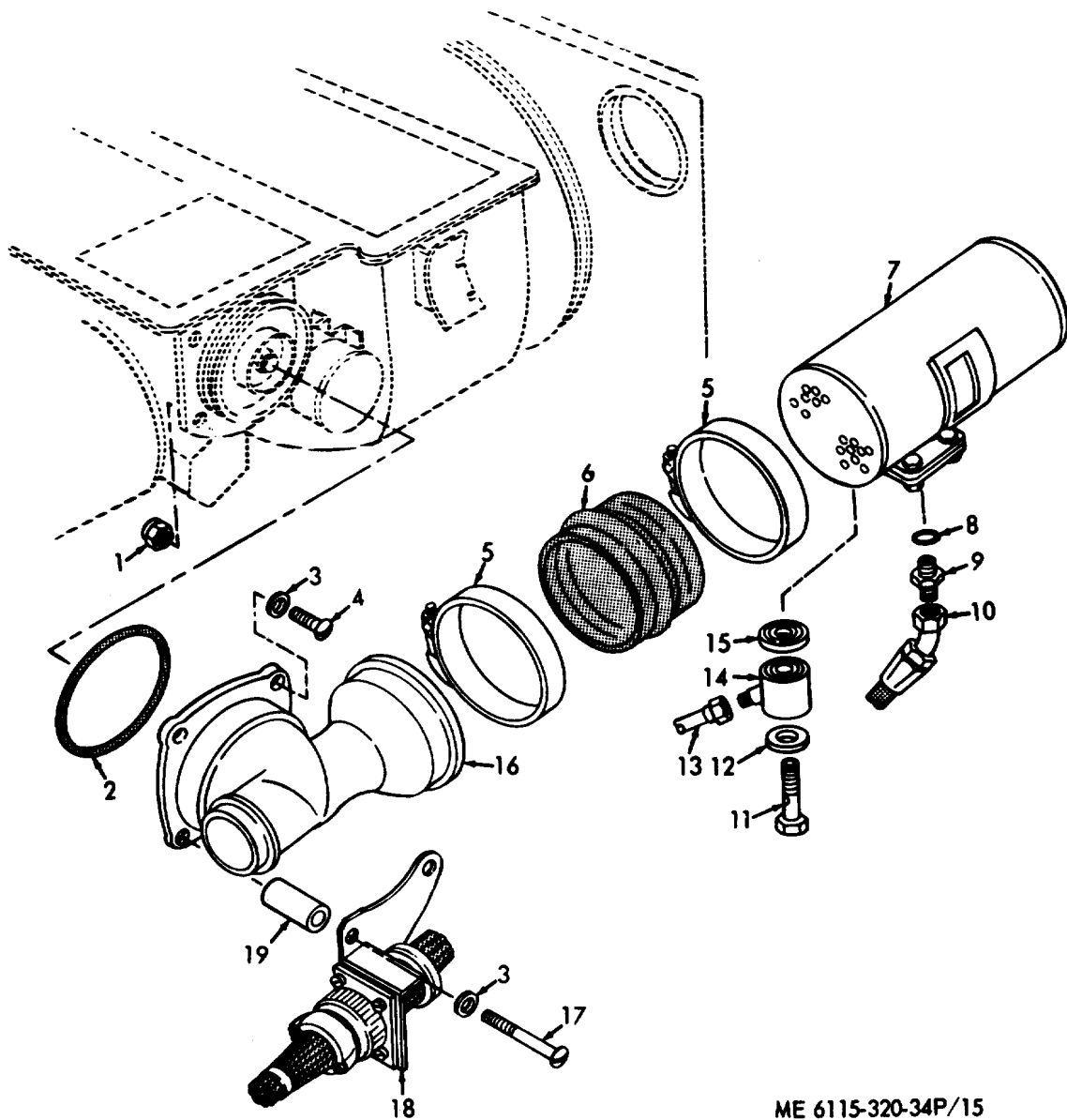

ME 6115-320-34P/15

Figure 11. Oil Cooler and Duct.

INDEX TO PARTS, FIGURE 11

Reference Number	Functional Group	Item Name	Reference Number	Functional Group	Item Name
1	0127	NUT	10	0127	HOSE AY
2	0127	PACKING	11	0127	BOLT
3	0127	WASHER	12	0127	PACKING
3	0613	WASHER	13	0127	TUBE AY
4	0127	SCREW	14	0127	ELBOW
5	0127	CLAMP	15	0127	PACKING
6	0127	HOSE	16	0127	DUCT AY
7	0127	COOLER	17	0127	SCREW
8	012-	GASKET	18	0613	BRACKET
9	0127	NIPPLE	19	0613	SPACER

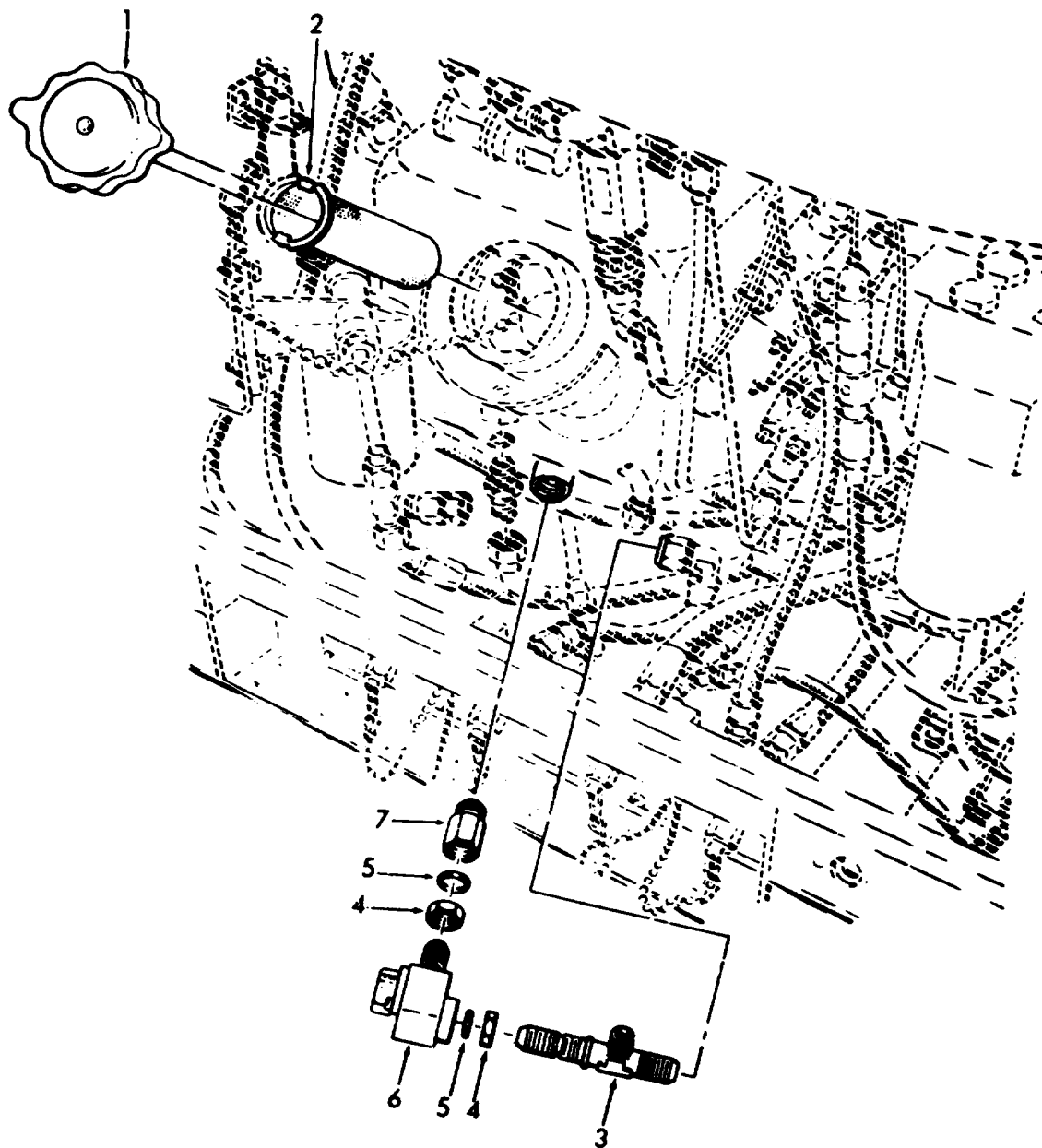

ME 6115-320-34P/16

INDEX TO PARTS, FIGURE 12

Reference Number	Functional Group	Item Name
1	0127	DIPSTICK AY
2	0127	SCREEN AY
3	0127	TEE
4	0127	NUT
5	0127	GASKET
6	0127	VALVE
7	0127	BUSHING

Figure 12. Dipstick, Screen and Drain Valve.

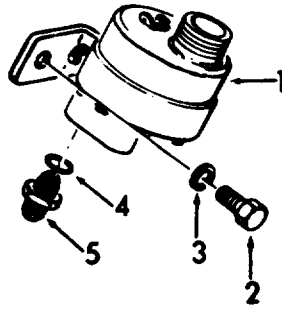

**ME 6115-320-34P/19**

**Figure 13. Low Oil Pressure Switch.**

INDEX TO PARTS, FIGURE 13

Reference Number	Functional Group	Item Name
1	0127	SWITCH
2	0127	BOLT
3	0127	WASHER
4	0127	GASKET
5	0127	NIPPLE

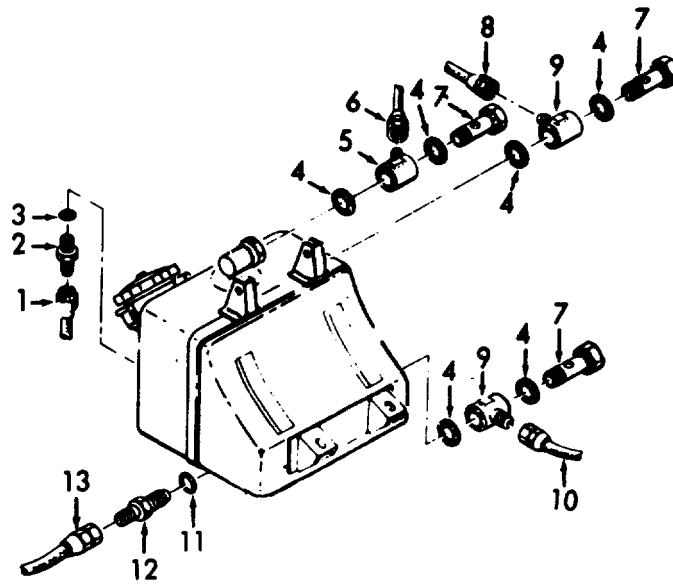

ME 6115-320-20P/14

Figure 14. Oil Tank.

INDEX TO PARTS, FIGURE 14

Reference Number	Functional Group	Item Name
1	0127	TUBE AY
2	0127	NIPPLE
3	0127	GASKET
4	0127	PACKING
5	0127	ELBOW
6	0127	TUBE AY
7	0127	BOLT
8	0i27	HOSE AY
9	0127	ELBOW
10	0127	TUBE AY
11	0127	GASKET
12	0127	NIPPLE
13	0127	HOSE AY

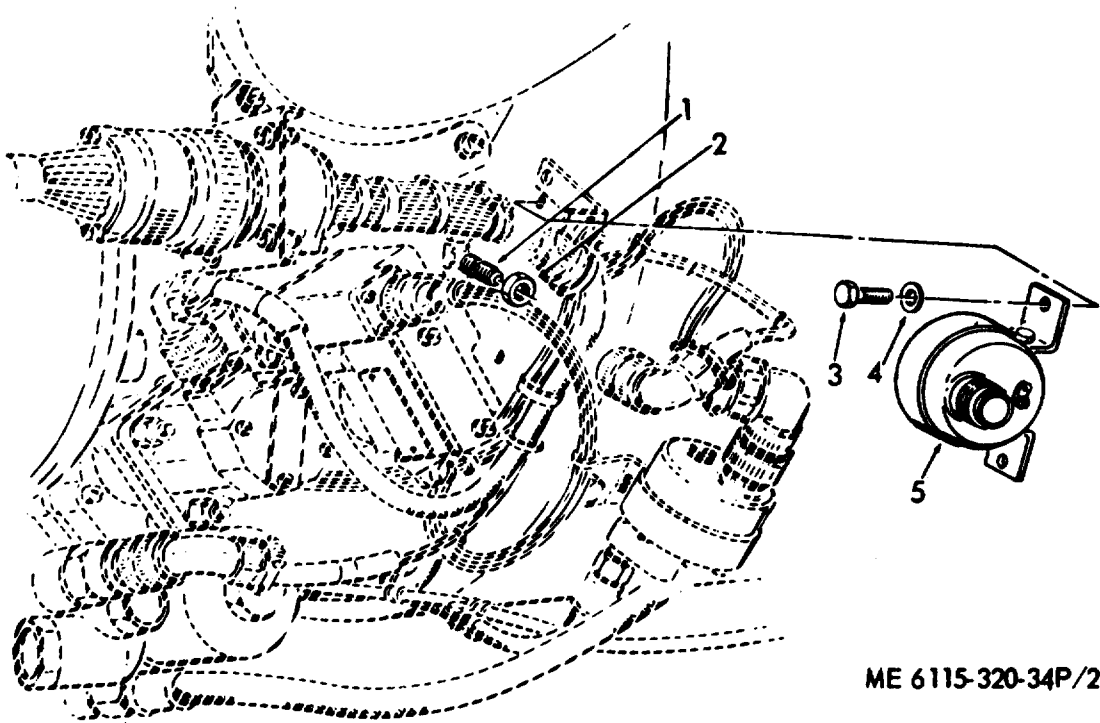

ME 6115-320-34P/22

Figure 15. Oil Pressure Sequencing Switch.

INDEX TO PARTS, FIGURE 15

Reference Number	Functional Group	Item Name
1	0127	TEE
2	0127	NUT
3	0127	BOLT
4	0127	WASHER
5	0127	SWITCH

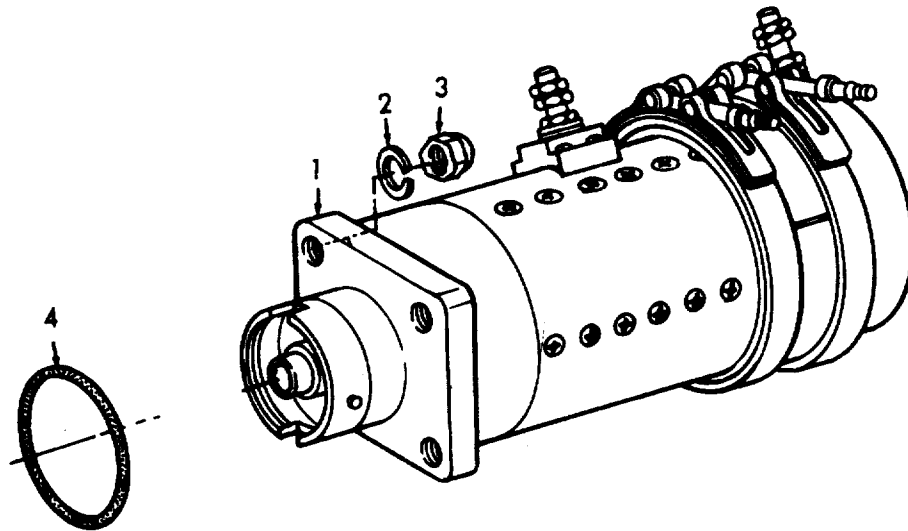

ME 6115-320-20P/16

Figure 16. Starter.

INDEX TO PARTS, FIGURE 16

Reference Number	Functional Group	Item Name
1	0603	MOTOR AY
2	0603	WASHER
3	0603	NUT
4	0603	PACKING

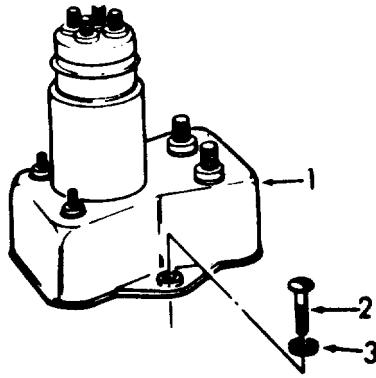

ME 6115-320-34P/25

Figure 17. Start Relay.

INDEX TO PARTS, FIGURE 17

Reference Number	Functional Group	Item Name
1	0603	RELAY
2	0603	SCREW
3	0603	WASHER



INDEX TO PARTS, FIGURE 18

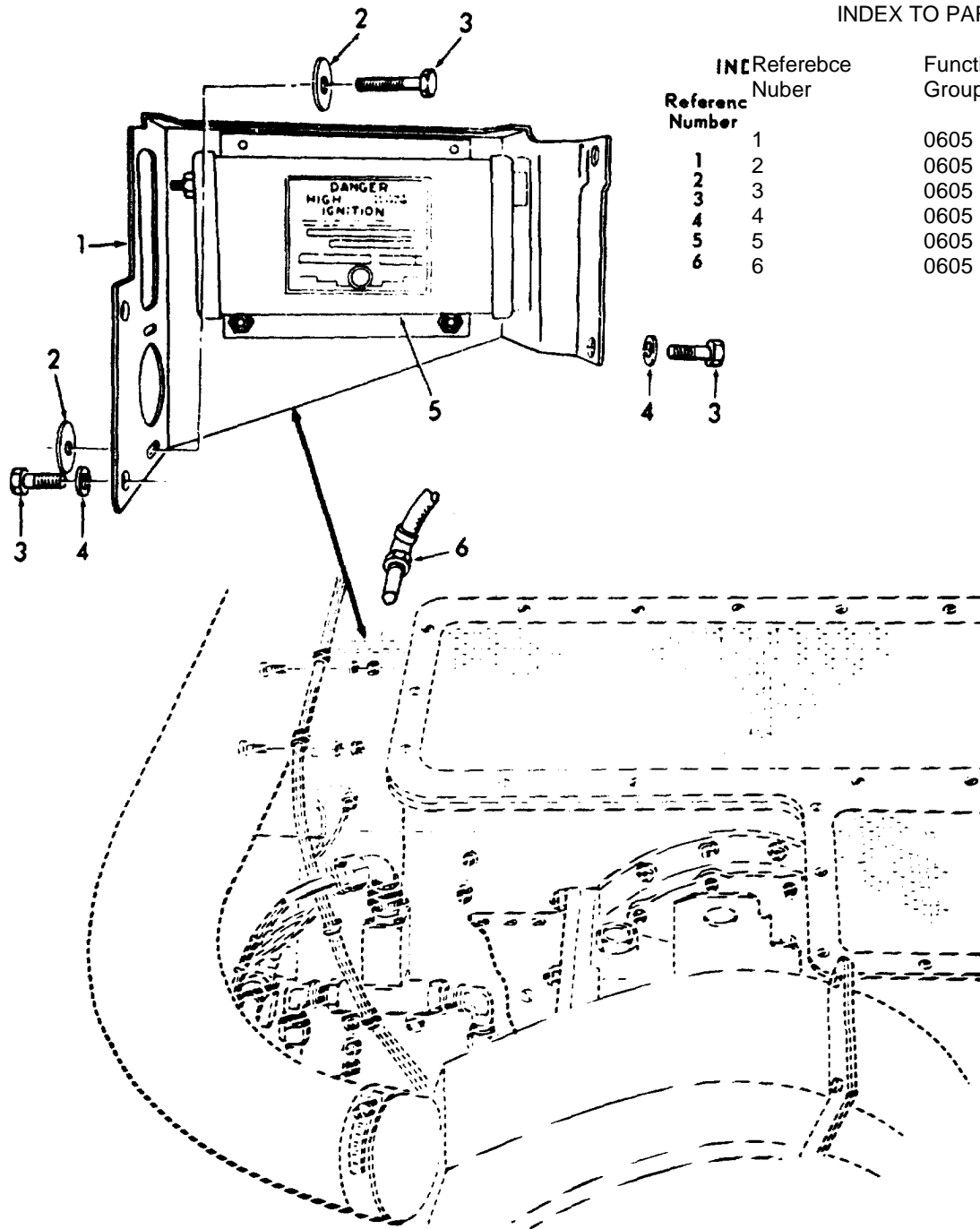

Reference Number	Reference Nuber	Functional Group	Item Name
1	1	0605	BRACKET
2	2	0605	WASHER
3	3	0605	BOLT
4	4	0605	WASHER
5	5	0605	IGNITION
6	6	0605	LEAD

ME 6115-320-34P/26

Figure 18. Ignition Unit.

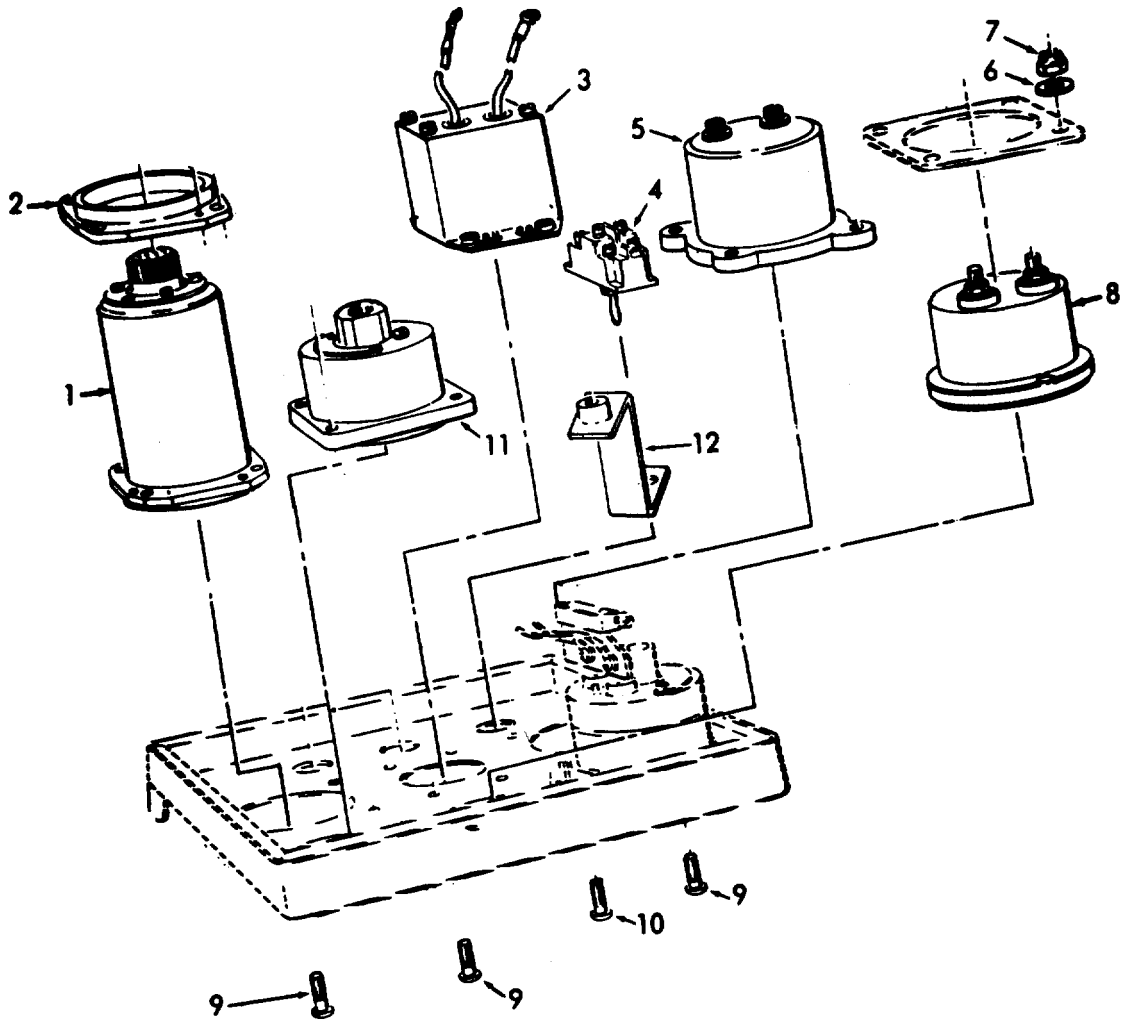

ME 6115-320-20P/19

Figure 19. Instrument Panel Explode.

INDEX TO PARTS, FIGURE 19

Reference Number	Functional Group	Item Name	Reference Number	Functional Group	Item Name
1	0607	INDICATOR	7	0607	NUT
2	0607	BEZEL	8	0607	AMMETER
3	0607	COUNTER AY	9	0607	SCREW
4	0607	SWITCH	10	0607	SCREW
5	0607	METER	11	4702	GAGE
6	0607	WASHER	12	0607	BRACKET AY

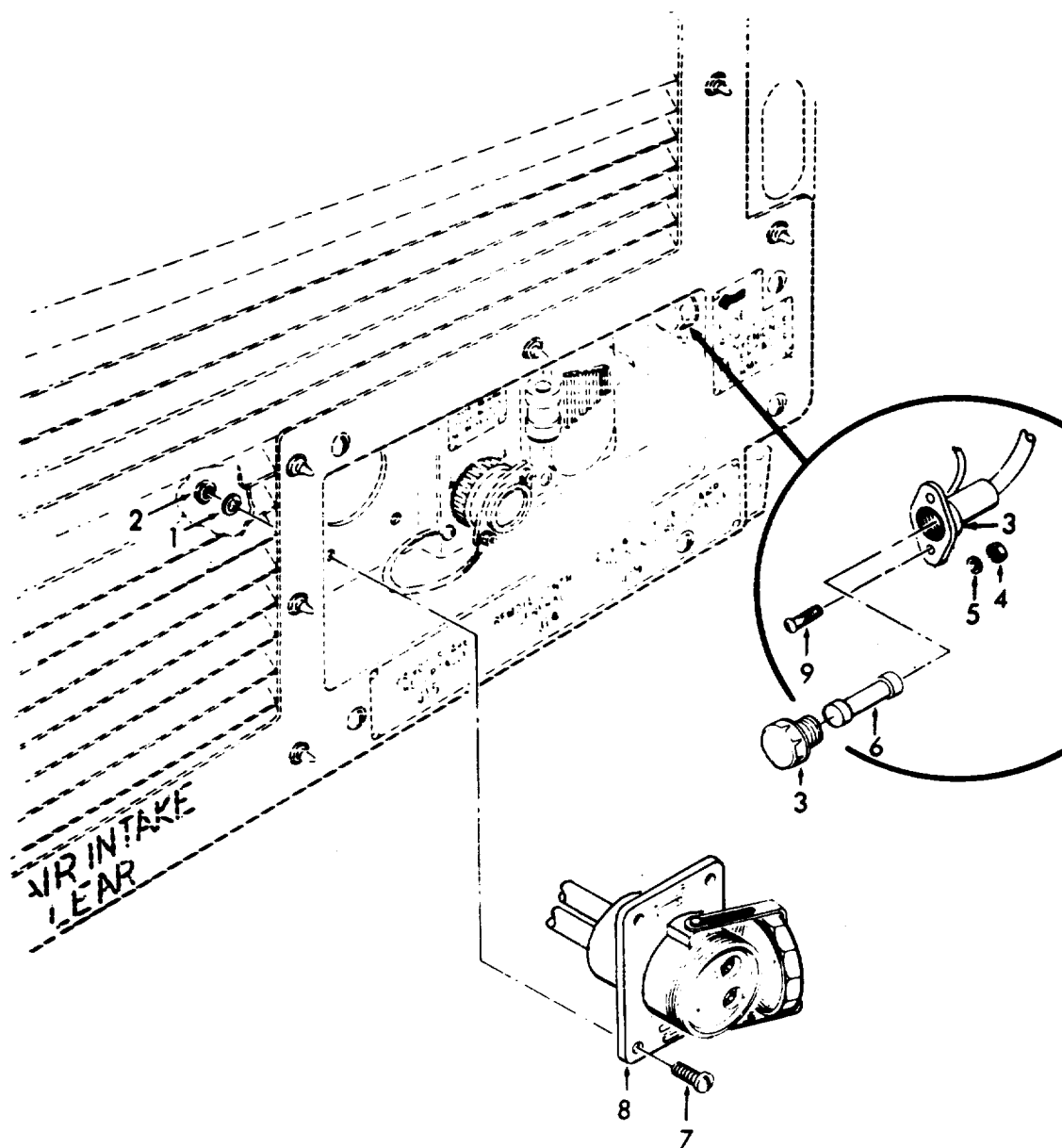

ME 6115-320-34P/37

Figure 20. Fuse, Fuseholder and Power Plug.

INDEX TO PARTS, FIGURE 20

Reference Number	Functional Group	Item Name
1	0608	WASHER
2	0608	NUT
3	0607	FUSEHOLDER
4	0607	NUT
5	0607	WASHER
6	0607	FUSE
7	0608	SCREW
8	0608	PLUG
9	0607	SCREW

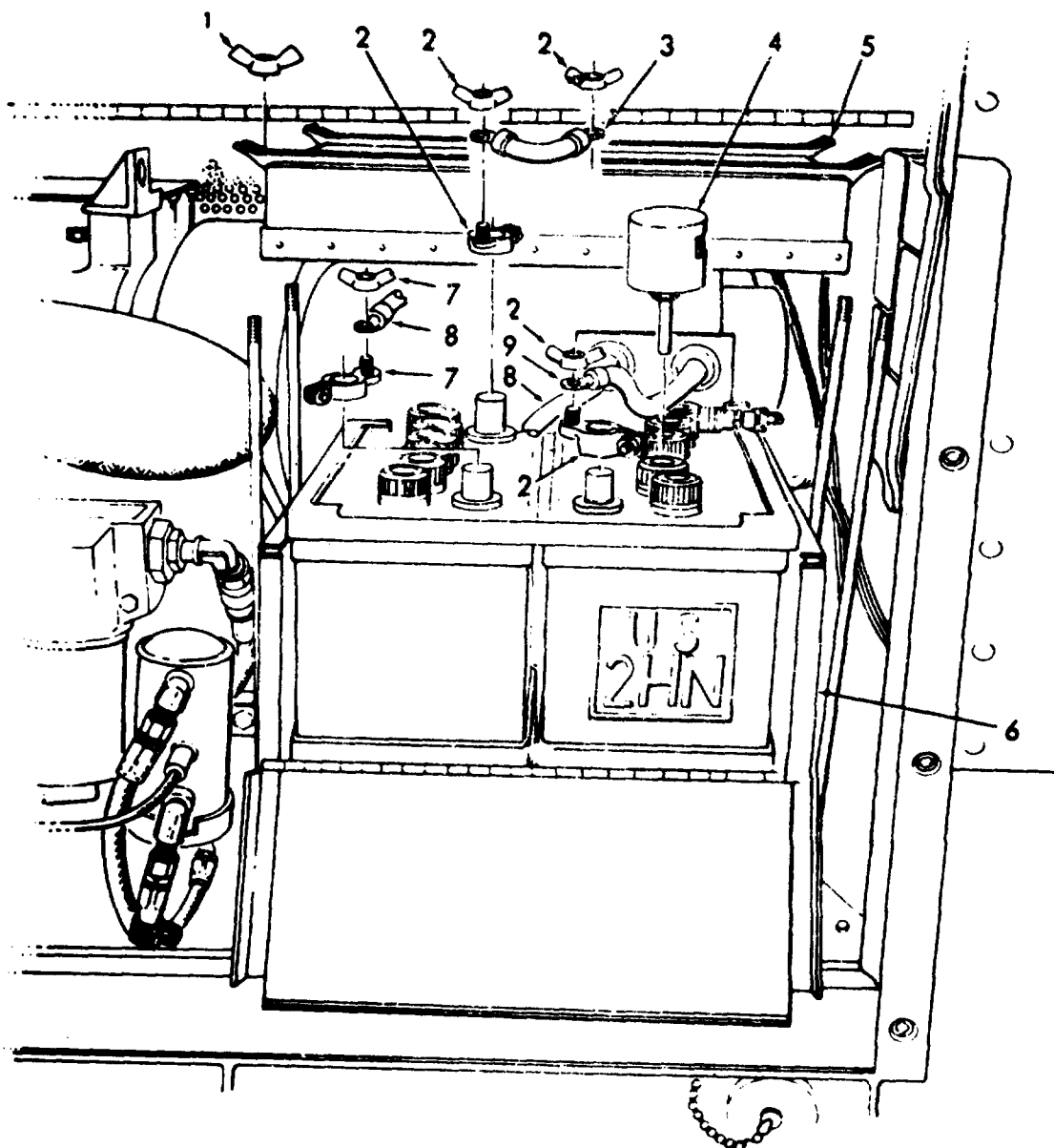

ME 6115-320-34P/38

Figure 21. Battery Box and Temperature Sensor.

INDEX TO PARTS, FIGURE 21

Reference Number	Functional Group	Item Name	Reference Number	Functional Group	Item Name
1	0612	NUT	6	0612	BOX AY
2	0612	TERMINAL	7	0612	TERMINAL
3	0612	WIRE AY	8	0612	WIRE AY
4	2207	SENSOR	9	0612	WIRE AY
5	0612	COVER AY			

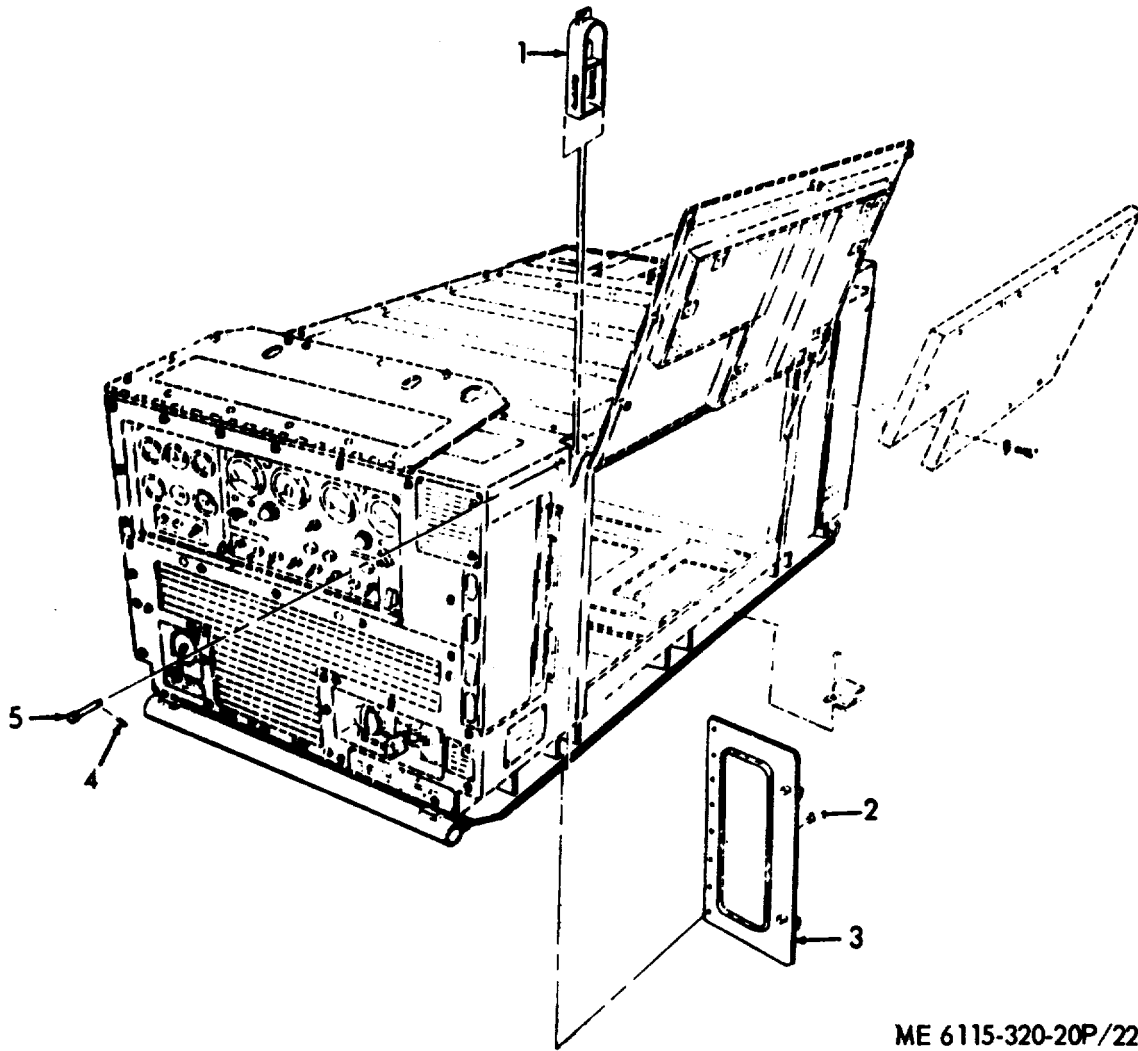

ME 6115-320-20P/22

Figure 22. Base Frame, Door and Hoist.

INDEX TO PARTS, FIGURE 22

Reference Number	Functional Group	Item Name
1	1801	HOIST AY
2	1801	RIVET
3	1801	DOOR AY
4	1801	PIN
5	1801	PIN

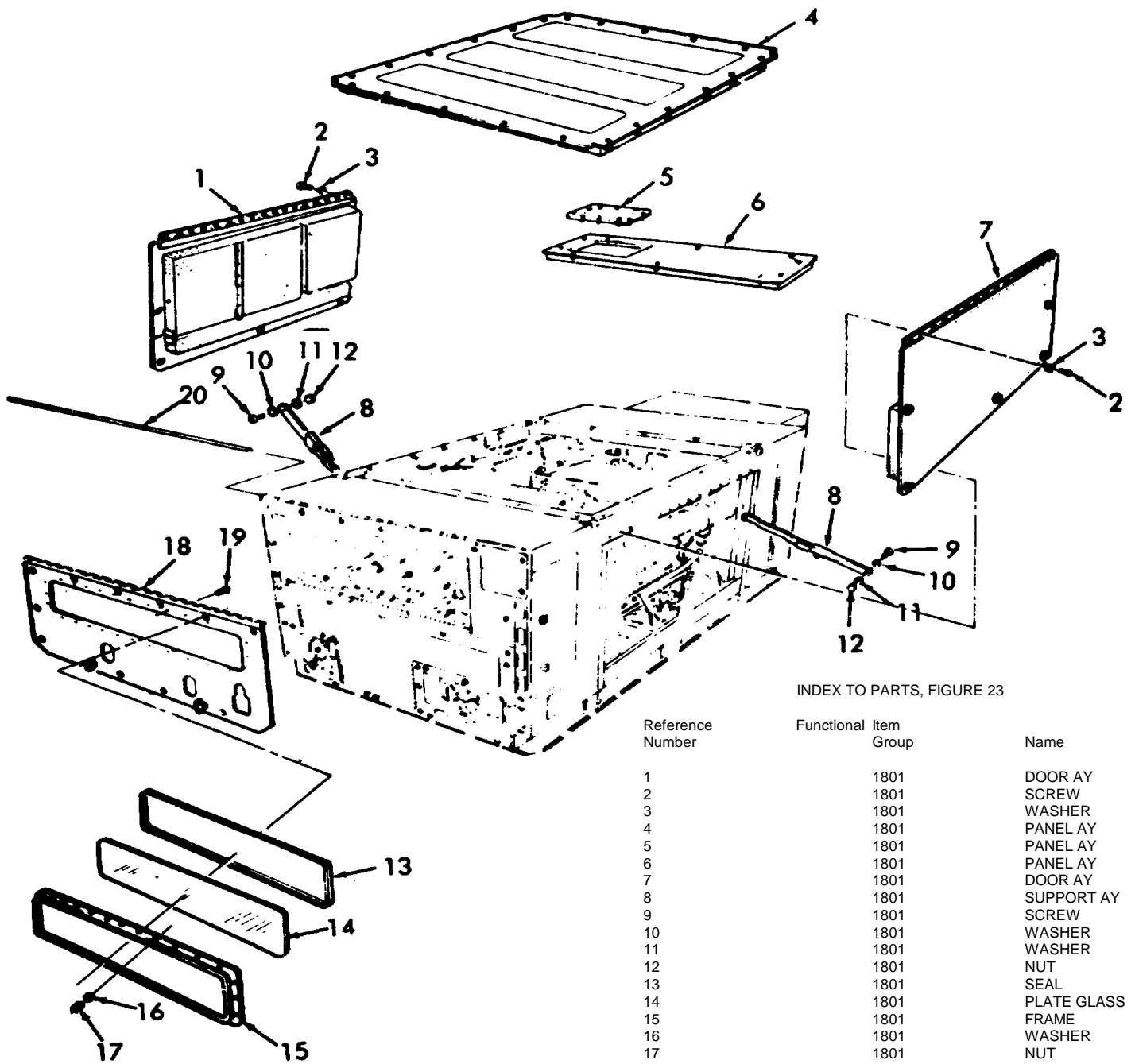

INDEX TO PARTS, FIGURE 23

Reference Number	Functional Item Group	Name
1	1801	DOOR AY
2	1801	SCREW
3	1801	WASHER
4	1801	PANEL AY
5	1801	PANEL AY
6	1801	PANEL AY
7	1801	DOOR AY
8	1801	SUPPORT AY
9	1801	SCREW
10	1801	WASHER
11	1801	WASHER
12	1801	NUT
13	1801	SEAL
14	1801	PLATE GLASS
15	1801	FRAME
16	1801	WASHER
17	1801	NUT
18	1801	PANEL
19	1801	SCREW
20	1801	HINGE

ME 6 115-320-34P/40

Figure 23. Door and Panel.

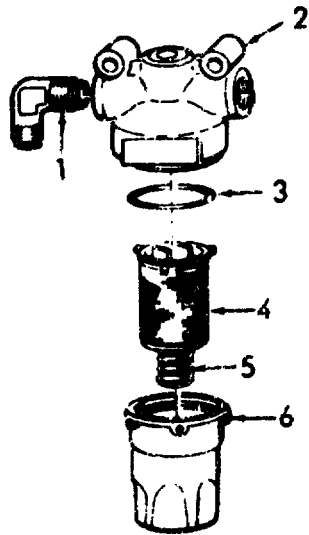

ME 6115-320-34P/41

Figure 24. Heater Fuel Filter.

INDEX TO PARTS, FIGURE 24

Reference Number	Functional Group	Item Name*
1	0126	ELBOW
2	2207	HEAD
3	2207	PACKING
4	2207	ELEMENT AY
5	2207	SPRING
6	2207	BOWL

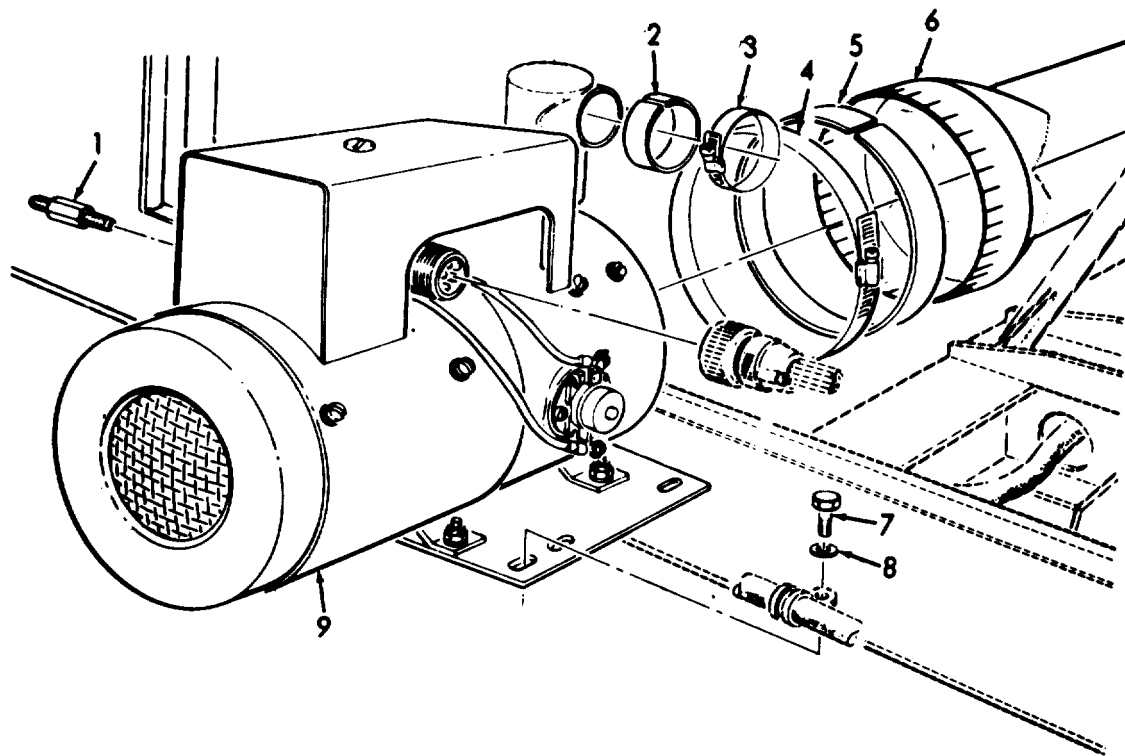

ME 6115-320-20P/25

Figure 25. Heater.

INDEX TO PARTS, FIGURE 25

Reference Number	Functional Group	Item Nome
1	0126	NIPPLE
2	2207	SEAL
3	2207	CLAMP
4	2207	CLAMP
5	2207	SEAL
6	2207	PIPE AY
7	2207	BOLT
8	2207	WASHER
9	2207	HEATER



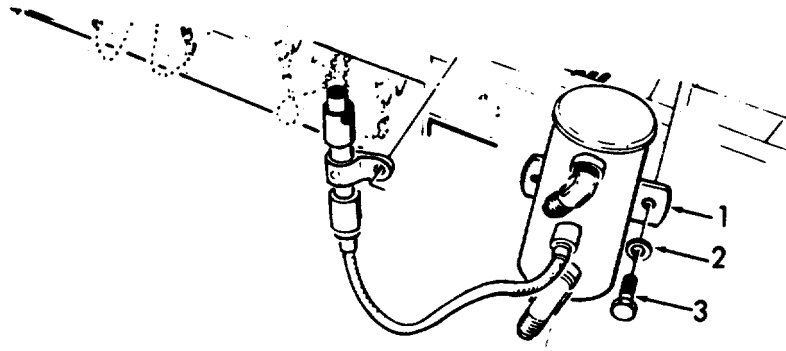

ME 6115-320-20P/26

Figure 26. Heater Fuel Pump.

INDEX TO PARTS, FIGURE 26

Reference Number	Functional Group	Item Name
1	2207	PUMP AY
2	2207	WASHER
3	2207	BOLT

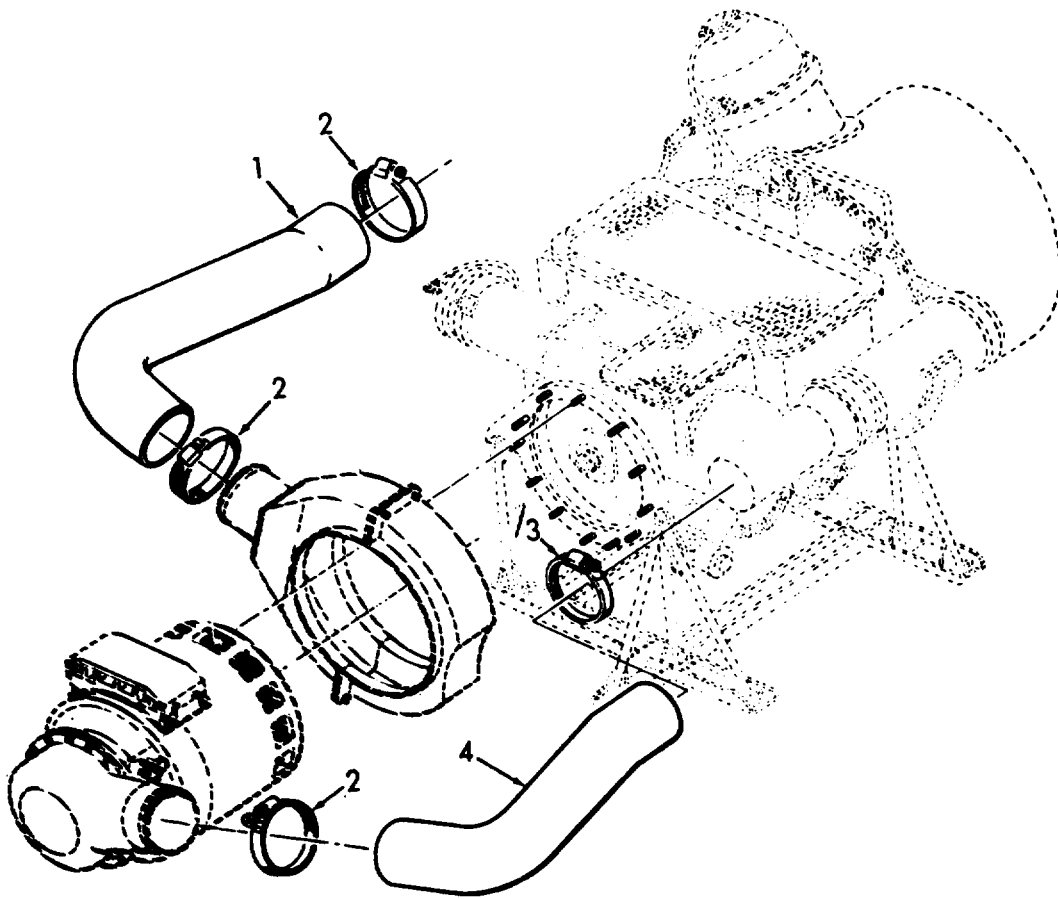

ME 6115-320-20P/27

Figure 27. Hoses and Clamps.

INDEX TO PARTS, FIGURE 27

Reference Number	Functional Group	Item Name
1	4004	HOSE
2	4004	CLAMP
3	4004	CLAMP
4	4004	HOSE

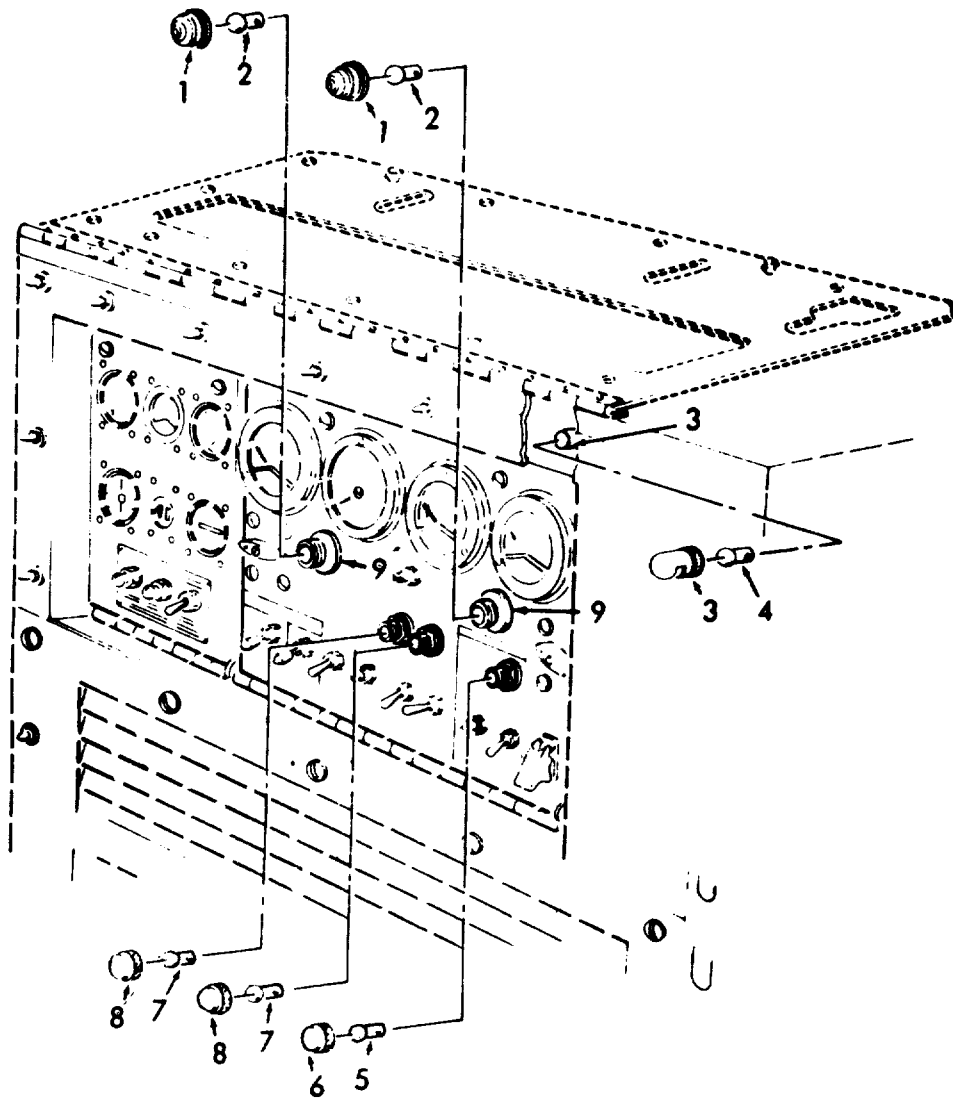

ME 6115-320-34P/47

Figure 28 Panel Lights.

INDEX TO PARTS, FIGURE 28

Reference Number	Functional Group	Item Name
1	4009	COVER
2	4009	LAMP
3	4009	LIGHT
4	4009	LAMP
5	4009	LAMP
6	4009	LIGHT AY
7	4009	LAMP
8	4009	LIGHT
9	4009	LIGHT

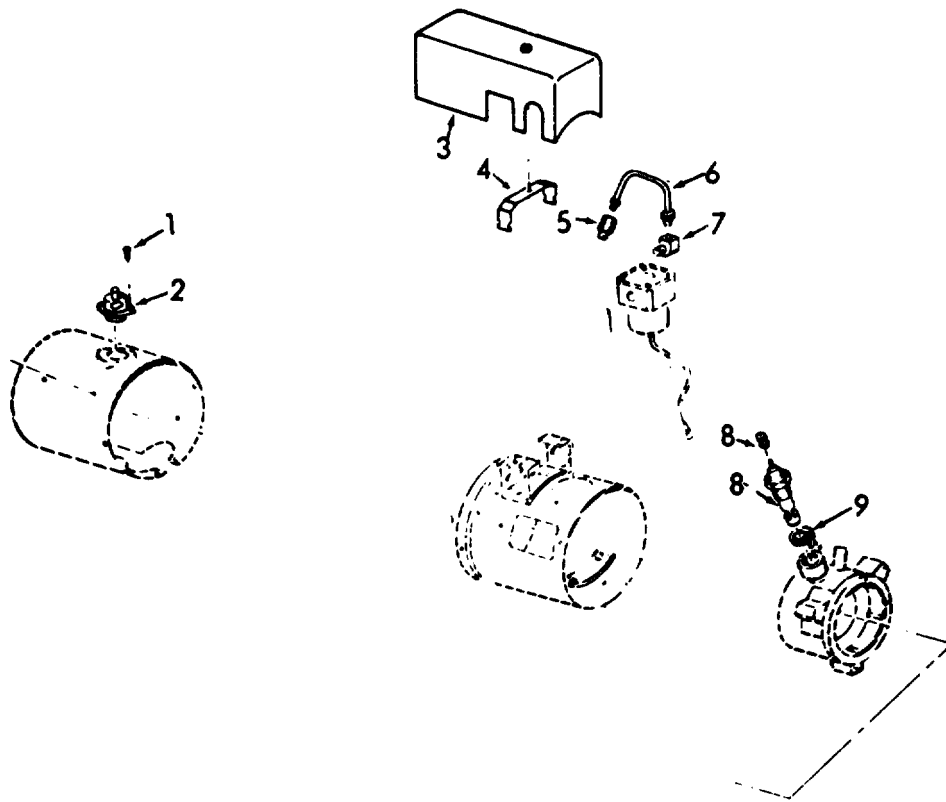

ME 6115-320-20P/29

Figure 29. Heater Switch, Igniter and Cover.

INDEX TO PARTS, FIGURE 29

Reference Number	Functional Group	Item Name
1	2207	SCREW
2	2207	SWITCH
3	2207	COVER
4	2207	BRACKET
5	2207	CONNECTOR
6	2207	TUBE AY
7	2207	ORFICE AY
8	2207	IGNITER AY
9	2207	GASKET

INDEX TO PARTS, FIGURE 30

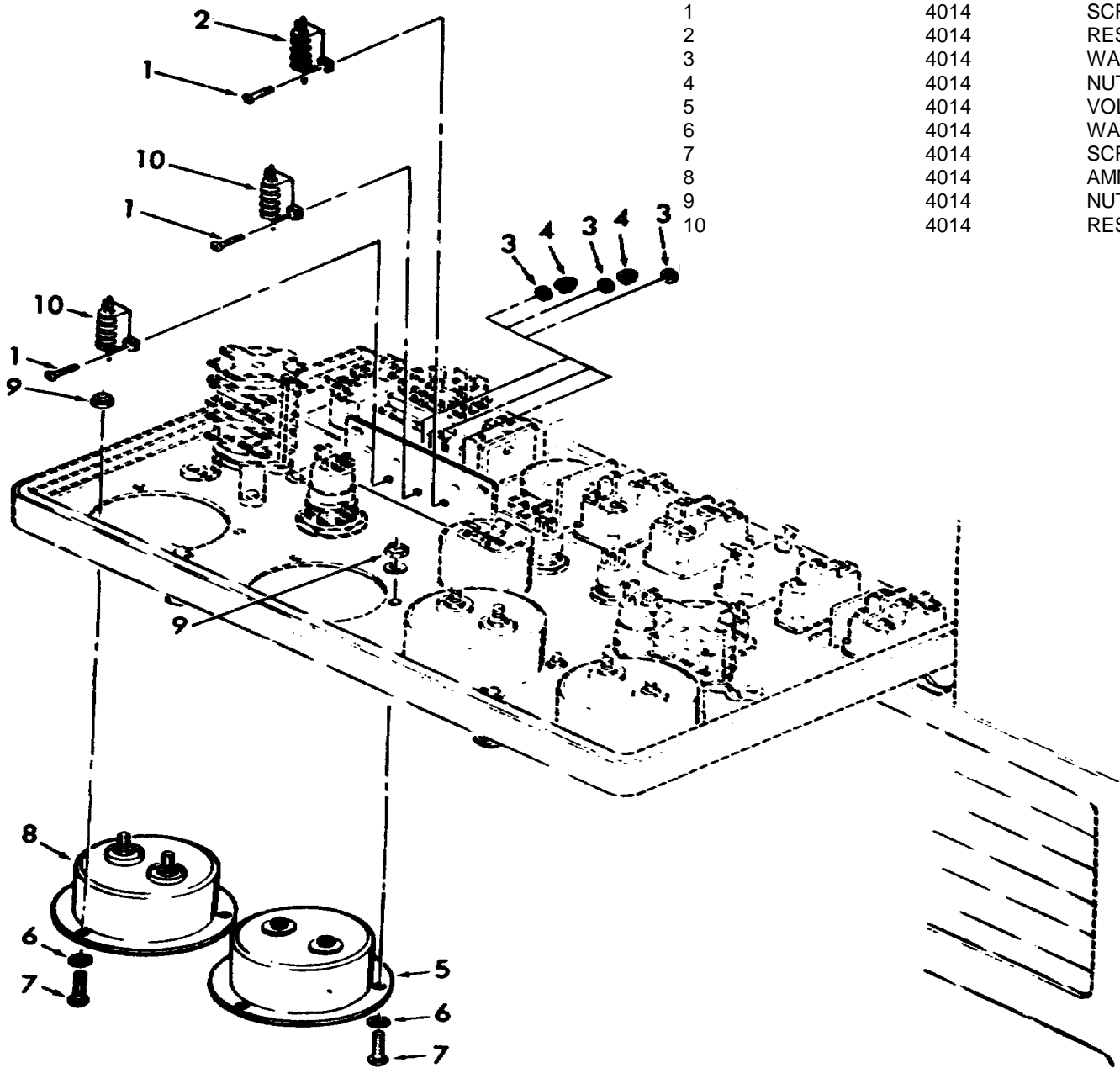

Reference Number	Functional Group	Item Name
1	4014	SCREW
2	4014	RESISTOR
3	4014	WASHER
4	4014	NUT
5	4014	VOLTMETER
6	4014	WASHER
7	4014	SCREW
8	4014	AMMETER
9	4014	NUT
10	4014	RESISTOR

ME 6115-320-20P/30

Figure 30. Ammeter, Voltmeter and Resistors.

SECTION V. INDEX-FEDERAL STOCK NUMBER AND REFERENCE NUMBER  
CROSS-REFERENCE TO INDEX NUMBER

<u>STOCK NUMBER</u>	<u>INDEX NUMBER</u>	<u>STOCK NUMBER</u>	<u>INDEX NUMBER</u>
1650-530-3146	00110	2920-902-7063	00321
2835-014-4545	00202	2940-849-8358	00121
2835-014-4547	00241	2990-014-7484	00316
2835-014-4552	00240	4720-014-8272	00135
2835-015-0211	00176	4720-289-4870	00056
2835-015-0212	00174	4720-683-8899	00137
2835-015-0220	00015	4720-757-6817	00136
2835-015-0221	00019	4720-912-3586	00134
2835-015-0222	00011	4730-014-8285	00058
2835-015-0252	00258	4730-186-9826	00081
2835-015-0274	00022	4730-186-9961	00045
2835-017-9266	00012	4730-186-9977	00047
2835-017-9270	00076	4730-186-9996	00048
2835-017-9271	00138	4730-186-9997	00113
2835-337-4818	00108	4730-187-0486	00142
2835-515-7334	00350	4730-187-0487	00140
2835-580-2299	00018	4730-187-0487	00141
2835-585-4938	00004	4730-187-0489	00139
2835-608-6146	00203	4730-187-3600	00162
28354-60-6306	00164	4730-197-2916	00112
2835-630-3965	00005	4730-203-7458	00102
2835-650-6171	00206	4730-203-8136	00114
2835-729-5825	00177	4730-230-8710	00046
2835-757-6804	00173	470-231-1332	00101
2835-757-6805	00078	4730-231-3026	00044
2835-757-6808	00000	4730-277-5060	00078
2835-757-6815	00077	4730-277-5136	00171
2835-757-6816	00178	4730-277-6438	00082
2835-772-2937	00010	4730-277-6458	00145
2835-772-9951	00175	4730-277-9757	00118
2835-772-9952	00172	4730277-9762	00120
2835-773-1877	00109	730-278-0375	00036
2835-773-1887	00179	4730-278-0380	00096
2835-836-8961	00017	4730-278-0380	00097
2835-886-1153	00346	4730-278-0381	00093
2835-907-0625	00075	4730-278-3242	00143
2835-928-3495	00079	4730-278-5816	00119
2910-031-9083	00311	4730-278-5826	00116
2910-045-9430	00068	4730-278-5826	00117
2910-049-3573	00041	4730-278-8794	00158
2910-065-6615	00028	4730-278-8805	00161
2910-069-4500	00051	4730-278-8805	00159
2910-203-3322	00312	4730-278-9376	00170
2910-315-8305	00033	4730-278-9384	00169
2910-335-9343	00313	4730-279-0119	00115
2910-592-7379	00031	4730-279-0862	00074
2910-689-9920	00085	4730-287-0093	00160
2910-719-7651	00084	4730-585-8769	00103
2910-757-6857	00050	4730-585-8770	00002
2910-757-6859	00034	4730-618-8644	00107
2910-787-7142	00030	4730-812-0882	00144
2910-854-3664	00329	4730-852-8931	00308
2910-874-3241	00322	4730-877-9822	00309
2910-897-9150	00155	5305-059-3659	00023
2915-025-3493	00310	5305-059-3659	00331
2915-097-0325	00083	5305-063-6717	00246
2915-201-0259	00315	5305-151-0684	00230
2920-067-6735	00204	4305-151-0827	00330
2920-792-2569	00188	5305-151-0828	00295
2920-888-0591	00205	5305-151-0983	00227

SECTION V. INDEX-FEDERAL STOCK NUMBER AND REFERENCE NUMBER  
CROSS-REFERENCE TO INDEX NUMBER (Continued)

<u>STOCK NUMBER</u>	<u>INDEX NUMBER</u>	<u>STOCK NUMBER</u>	<u>INDEX NUMBER</u>
5305-206-1288	00226	5310-167-0834	00181
5305-282-8470	00268	5310-167-0834	00195
5305-282-8470	00284	5310-167-0834	00390
5305-282-9458	00419	5310-167-0834	00410
5305-282-9908	00279	5310-167-0835	00025
5305-616-4831	00165	5310-167-0835	00194
5305-637-1125	00384	5310-167-0835	00236
5305-855-0987	00259	5310-167-0878	00090
5305-957-7086	00006	5310-167-0878	00335
5305-984-6193	00385	5310-184-8969	00411
5305-989-7434	00210	5310-187-2401	00185
5305-989-7434	00387	5310-208-5769	00058
5305-989-7435	00209	5310-208-5769	00150
5305-993-1848	00192	5310-208-5775	00060
5305-993-2460	00235	5310-274-8321	00276
5305-995-3444	00193	5310-274-8669	00396
5306-150-9221	00099	5310-282-7817	00063
5306-150-9221	00100	5310-282-7817	00064
5306-150-9527	00306	5310-282-7817	00151
5306-150-9872	00095	5310-515-7449	00024
5306-151-0778	00039	5310-515-7449	00089
5306-151-0780	00040	5310-531-9514	00281
5306-151-1426	00037	5310-622-9531	00231
5306-151-1427	00009	5310-637-2977	00072
5306-156-2337	00094	5310-638-2605	00148
5306-180-2779	00201	5310-638-9857	00389
5306-274-2119	00038	5310-734-5759	00147
5306-274-2119	00307	5310-807-1467	00267
5306-722-0393	00098	5310-807-1467	00283
5306-722-0393	00200	5310-811-3494	00381
5306-754-1791	00035	5310-811-3494	00392
5307-337-3090	00007	5310-877-5796	00233
5310-059-9265	00020	5310-877-5797	00208
5310-061-7325	00189	5310-905-8451	00380
5310-061-7326	00061	5310-982-4988	00207
5310-061-7326	00062	5310-982-5000	00343
5310-061-7326	00146	5310-984-6193	00395
5310-061-7326	00149	5315-014-8431	00293
5310-061-7326	00326	5315-815-1405	00292
5310-081-8087	00216	5320-117-6881	00294
5310-081-8087	00418	5320-270-2953	00243
5310-088-0551	00225	5325-174-9038	00245
5310-141-1795	00180	5325-276-4283	00304
5310-167-0753	00182	5325-785-8153	00303
5310-167-0753	00183	5330-014-5632	00332
5310-167-0753	00184	5330-014-5633	00333
5310-167-0753	00212	5330-014-8447	00016
5310-167-0753	00261	5330-171-5454	00128
5310-167-0765	00087	5330-171-5654	00127
5310-167-0765	00211	5330-171-5654	00129
5310-167-0801	00270	5330-171-5659	00153
5310-167-0801	00286	5330-171-8002	00065
5310-167-0812	00026	5330-186-4939	00163
5310-167-0812	00271	5330-194-3713	00154
5310-167-0812	00287	5330-248-3836	00067
5310-167-0812	00296	5330-265-1089	00314
5310-167-0812	00336	5330-514-3285	00156
5310-167-0816	00420	5330-514-3285	00157
5310-167-0834	00086	5330-531-2071	00126
5310-167-0834	00088	5330-641-1824	00053

SECTION V. INDEX-FEDERAL STOCK NUMBER AND REFERENCE NUMBER  
CROSS-REFERENCE TO INDEX NUMBER (Continued)

<u>STOCK NUMBER</u>	<u>INDEX NUMBER</u>	<u>STOCK NUMBER</u>	<u>INDEX NUMBER</u>
5330-726-4153	00190	6115-014-5610	00266
5330-757-6167	00066	6115-014-5620	00325
5330-804-5695	00152	6115-014-5624	00347
5330-805-2966	00054	6115-014-5631	00327
5330-814-2307	00124	6115-014-5646	00400
5330-845-0915	00032	6115-014-5652	00344
5330-861-1396	00029	6115-014-5654	00401
5330-861-1396	00055	6115-014-5659	00399
5330-879-8739	00123	6115-014-7173	00014
5330-883-4215	00130	6115-014-7605	00166
5330-928-0487	00021	6115-014-7638	00273
5340-014-8453	00260	6115-014-7650	00265
5340-014-8459	01014	6115-014-7692	00302
5340-290-7083	00043	6115-014-7695	00301
5340-849-8206	00106	6115-014-7696	00300
5340-932-4645	00013	6115-014-7700	00277
5620-014-8064	00278	6115-014-7710	00251
5905-015-0053	00382	6115-014-7711	00254
5905-015-0053	00393	6115-014-7715	00249
5905-015-0054	00383	6115-014-7903	00220
5905-015-0054	00394	6115-014-8063	00274
5920-015-0088	00215	6115-014-8065	00280
5920-078-8659	00214	6115-014-8149	00289
5920-240-4066	00414	6115-014-8157	00290
5920-284-7039	00415	6115-014-8158	00291
5920-539-6920	00417	6115-015-0371	00345
5930-015-0061	00334	6115-015-0372	00349
5930-017-9274	00167	6115-015-0373	00348
5930-615-6831	00168	6115-015-0375	00351
5930-717-1020	00228	6115-015-0380	00352
5930-788-2825	00324	6115-015-0382	00353
5935-930-3209	00234	6115-017-9191	00264
5940-204-8966	00404	6115-633-3404	00003
5940-204-8966	00408	6115-641-3773	00131
5940-204-8990	00403	6115-691-5493	00320
5940-204-8990	00406	6115-772-9934	00111
5940-549-7250	00250	6115-773-1884	00092
5994-549-7252	00252	6115-873-1778	00318
5940-557-1629	00407	6140-014-4504	00239
5940-557-4339	00197	6140-057-2553	00238
5940-557-4398	00409	6210-635-4410	00371
5940-577-3711	00402	6210-660-8462	00374
5940-577-3711	00405	6210-669-6474	00376
5940-812-5186	00198	6210-722-6455	00378
5940-812-5186	00253	6240-019-0878	00372
5940-812-5186	00255	6240-143-3060	00373
5940-823-1662	00247	6250-143-7901	00386
5940-823-1663	00248	6620-015-0369	00222
5940-840-5436	00256	6620-015-0369	00423
5945-754-6611	00191	6625-015-0192	00388
6115-014-5040	00196	6625-015-0193	00218
6115-014-5409	00242	6645-580-9605	00224
6115-014-5513	00288	6680-611-0748	00223
6115-014-5521	00377	6680-706-8653	00221
6115-014-5532	00049	6695-855-8564	00219
6115-014-5533	00217	7690-779-8816	00338
6115-014-5538	00244	8340-015-0279	00299
6115-014-5541	00282	9905-017-9201	00341
6115-014-5544	00269	9905-017-9255	00340
6115-014-5544	00285	9905-017-9257	00342
6115-014-5550	00272	9905-757-6874	00339



SECTION V. INDEX-FEDERAL STOCK NUMBER AND REFERENCE NUMBER  
CROSS-REFERENCE TO INDEX NUMBER (Continued)

<u>REFERENCE NO.</u>	<u>MFG CODE</u>	<u>INDEX NO.</u>	<u>REFERENCE NO.</u>	<u>MFG CODE</u>	<u>INDEX NO.</u>
AN350-5	88044	00246	RH10-2-5K	91637	00393
AN6230-6	88044	00154	RH10-5K	91637	00394
AN6244-6	88044	00163	RH10-5K	91637	00383
AN775-4	88044	00036	S8057AP114	99193	00066
AN775-6	88044	00093	S8057AP19	99193	00123
AN775-8	88044	00096	S8057AP5	99193	00032
AN775-8	88044	00097	S8057A20	99193	00065
AN833-4	88044	00044	S8168-7C0750F	99193	00260
AN893-12	88044	00102	S8171K15	99193	00190
AN893-13D	88044	00101	S8171K27	99193	00153
AN901-8	88044	00125	S8199-3	99193	00350
AN929A4	88044	00042	S82265	99193	00338
AN960-416L	88044	00236	S8265	99193	00338
AN960C6L	88044	00389	S8316AD4	99193	00029
A1500-6	72433	00016	S8316AD4	99193	00055
A2053-1	80684	00321	S8316AD6	99193	00130
A2075	80684	00324	S8316A4	99193	00053
A2084	80684	00322	S8316K12	99193	00126
A2087	80684	00318	S8316K4	99193	00127
A2096	80684	00320	S8316K4	99193	00129
A2145	80684	00317	s831616	99193	00131
A2157	80684	00325	S8316K8	99193	00128
A2170	80684	00323	S885481P1	99193	00346
B2057	81780	00347	TA1718SS10T	84971	00104
B2489	80684	00319	TA1718SS4T	84971	00106
F8N20G	75915	00416	TA1718SS8T	84971	00105
GF157	70040	00051	YAEV2CL	09922	00198
J571004	75915	00215	YAEV2CL	09922	00255
MS15569-7	96906	00372	YAEV2CL1	09922	00197
MS19190F8	96906	00043	YAEV2CL2	09922	00250
MS20257C4-2950	96906	00275	YAV2CL2	09922	00256
MS24142D2	96906	00191	000-601003J0194	70128	00134
MS25213	96906	00375	111790-7	99193	00049
MS25231	96906	00379	13206E4590-1	99193	00388
MS25331-3	96906	00374	13206E4593-1	97403	00218
NS25331-8-313	96906	00378	13207E3738-1	99193	00288
MS27977-1B	96906	00303	13207E3745-1	99193	00348
MS27977-3B	96906	00304	13207E3753-1	99193	00282
MS28000-1	96906	00223	13207E3756-1	99193	00290
MS28055-11	96906	00219	13207E3756-3	99193	00291
MS28741-4-0530	96906	00056	13207E3758-1	99193	00076
MS28741-6-0016	96906	00057	13207E3759	99193	00058
MS28778-12	96906	00124	13207E3766-1	99193	00351
MS28778-4	96906	00054	13207E3768-1	99193	00217
MS28778-6	96906	00152	13207E3771-1	99193	00289
MS28921G60060	96906	00133	13207E3776-1	99193	00022
MS29513-12	96906	00067	13207E3780-1	99193	00264
MS35000-1	96906	00238	13207E3781-1	99193	00014
MS35489-20	96906	00245	13207E3782	99193	00019
MS90079-9	96906	00417	13207E3795	99193	00328
MS90084-15	96906	00214	13207E3816	99193	00386
MS91164-1N	96906	00247	13207E3820-1	99193	00254
MS91164-1P	96906	00248	13207E3820-16	99193	00249
M666000-4-0216	92532	00132	13207E3820-2	99193	00251
M666000-4-0262	70128	00176	13207E3820-5	99193	00196
NAS1201C13A13B	99193	00398	13207E3832-1	99193	00344
NAS620C4	88044	00229	13207E3837-1	99193	00339
QS200M28S	08484	00308	13207E3837-9	99193	00220
QS200M88S	08484	00309	13207E3850-1	99193	00222
RH10-2-5K	91637	00382	13207E3850-1	99193	00423

SECTION V. INDEX-FEDERAL STOCK NUMBER AND REFERENCE NUMBER  
 CROSS-REFERENCE TO INDEX NUMBER (Continued)

<u>REFERENCE NO.</u>	<u>MFG CODE</u>	<u>INDEX NO.</u>	<u>REFERENCE NO.</u>	<u>MFG CODE</u>	<u>INDEX NO.</u>
13208E8943-1	99193	00166	373206	99193	00084
13208E8945	99193	00138	373223	99193	00177
13208E8946-1	99193	00266	373824-2	99193	00010
13208E8947-1	97403	00239	375033-1	99193	00168
13208E8947-29	99193	00244	376092-1	99193	00015
13208E8947-3	99193	00241	376094-40	9993	00034
13208E8947-67	99193	00242	376788	99193	00179
13208E8947-9	99193	00240	37684	99193	00X92
13208E1950-1	99193	00299	377409	99193	00202
13208E8950-3	99193	00302	377869	99193	00205
13208E8950-5	99193	00301	378125	99193	00174
13208E8950-7	99193	00300	379353	99193	00167
13208E8951-1	99193	00273	379392-1	99193	00258
13208E8951-3	99193	00277	450-0	90005	00310
13208E8951-5	99193	00274	451-0	90005	00313
13208E8951-7	99193	00278	4512	71400	00415
13208E8951-9	99193	00280	4515	71400	00414
13208E8953	99193	00352	473504	72619	00376
13208E8957	99193	00353	476491	72850	00329
13208E8960-1	97403	00316	525-004-9008	99193	00020
13208E8964-5	99193	00401	569807	90005	00312
13208E8970-1	99193	00265	59633-7	99193	00109
13208E8971-1	99193	00327	59687	99193	00110
13208E8973-3	99193	00332	6S6DC120V	24455	00373
13208E8973-5	99193	00333	60-40735-24	77820	00234
13208E8974-1	99193	00269	601000-12D0140	70128	00135
13208E8974-1	99193	00285	601000-8D0150	70128	00136
13208E8975	99193	00400	620-742-4	83259	00155
13208E8976-3	99193	00399	620-742-8	83259	00156
13208E8978-5	99193	00272	620-742-8	83259	00157
13208E8984-1	99193	00345	692545-2	99193	00085
13208E8991	99193	00341	694004	99193	00011
13208E8994-1	99193	00349	694524	99193	00178
13208E8995	99193	00340	694527	99193	00078
13208E8996	99193	00342	694528	99193	00079
13213E4473-1	99193	00075	694569-1	99193	00068
152050	70210	00108	694675	99193	00077
18849-600	98625	00012	694785	99193	00173
2-2588469-4	83259	00021	694788-1	99193	00080
2TL11-56	91929	00228	7024159001	70763	00070
22NKM62	72962	00276	7024268002B	70763	00069
26405A	90005	00314	7024268002B	70763	00071
26413	90005	00311	73000	99193	00041
26417A	90005	00315	73001	99193	00072
305164-1	99193	00334	73909	99193	00031
31878	00779	00409	74567-60	99193	00164
31882	00779	00404	74807-1	99193	00030
31882	00779	00408	74896	99193	00122
31888	00779	00407	75076-30	99193	00028
31889	00779	00402	75099	99193	00203
31889	00779	00405	75153	99193	00204
32542	00779	00403	75341	99193	00221
32542	00779	00406	75404	99193	00033
337-501-9001	99193	00050	75555	99193	00003
357018-3	99193	00224	75556	99193	00004
365-63-473S	98625	00107	75725	99193	00111
370081	99193	00013	76078-3	99193	00206
370512-5	99193	00175	76149-1	99193	00121
370512-6	99193	00172	76483-2	99193	00188
370899	99193	00137	80-537	72619	00371
371959-1	99193	00018	803202-1235	72619	00377
371959-2	99193	00017	8151-2	75361	00083
372593	99193	00005	854616	03608	00052

By Order of the Secretary of the Army:

Official:

KENNETH G. WICKHAM,  
*Major General, United States Army,  
The Adjutant General.*

W. C. WESTMORELAND,  
*General, United State Army,  
Chief of Staff.*

Distribution:

To be distributed in accordance with DA Form 12-25, Section I, (qty rqr block no. 766) Organizational Maintenance requirements for Motor Generators 45 KW.

RECOMMENDED CHANGES TO EQUIPMENT TECHNICAL PUBLICATIONS

 <p style="font-size: small; margin: 0;"><i>THEN...JOT DOWN THE DOPE ABOUT IT ON THIS FORM. CAREFULLY TEAR IT OUT, FOLD IT AND DROP IT IN THE MAIL.</i></p>		SOMETHING WRONG WITH PUBLICATION	
		FROM: (PRINT YOUR UNIT'S COMPLETE ADDRESS)	
		DATE SENT	
PUBLICATION NUMBER		PUBLICATION DATE	PUBLICATION TITLE
IN THIS SPACE, TELL WHAT IS WRONG AND WHAT SHOULD BE DONE ABOUT IT.			
BE EXACT PIN-POINT WHERE IT IS			
PAGE NO.	PARA-GRAPH	FIGURE NO.	TABLE NO.
PRINTED NAME, GRADE OR TITLE AND TELEPHONE NUMBER		SIGN HERE	

## The Metric System and Equivalents

### Linear Measure

1 centimeter = 10 millimeters = .39 inch  
 1 decimeter = 10 centimeters = 3.94 inches  
 1 meter = 10 decimeters = 39.37 inches  
 1 dekameter = 10 meters = 32.8 feet  
 1 hectometer = 10 dekameters = 328.08 feet  
 1 kilometer = 10 hectometers = 3,280.8 feet

### Weights

1 centigram = 10 milligrams = .15 grain  
 1 decigram = 10 centigrams = 1.54 grains  
 1 gram = 10 decigrams = .035 ounce  
 1 decagram = 10 grams = .35 ounce  
 1 hectogram = 10 decagrams = 3.52 ounces  
 1 kilogram = 10 hectograms = 2.2 pounds  
 1 quintal = 100 kilograms = 220.46 pounds  
 1 metric ton = 10 quintals = 1.1 short tons

### Liquid Measure

1 centiliter = 10 milliliters = .34 fl. ounce  
 1 deciliter = 10 centiliters = 3.38 fl. ounces  
 1 liter = 10 deciliters = 33.81 fl. ounces  
 1 dekaliter = 10 liters = 2.64 gallons  
 1 hectoliter = 10 dekaliters = 26.42 gallons  
 1 kiloliter = 10 hectoliters = 264.18 gallons

### Square Measure

1 sq. centimeter = 100 sq. millimeters = .155 sq. inch  
 1 sq. decimeter = 100 sq. centimeters = 15.5 sq. inches  
 1 sq. meter (centare) = 100 sq. decimeters = 10.76 sq. feet  
 1 sq. dekameter (are) = 100 sq. meters = 1,076.4 sq. feet  
 1 sq. hectometer (hectare) = 100 sq. dekameters = 2.47 acres  
 1 sq. kilometer = 100 sq. hectometers = .386 sq. mile

### Cubic Measure

1 cu. centimeter = 1000 cu. millimeters = .06 cu. inch  
 1 cu. decimeter = 1000 cu. centimeters = 61.02 cu. inches  
 1 cu. meter = 1000 cu. decimeters = 35.31 cu. feet

## Approximate Conversion Factors

<i>To change</i>	<i>To</i>	<i>Multiply by</i>	<i>To change</i>	<i>To</i>	<i>Multiply by</i>
inches	centimeters	2.540	ounce-inches	Newton-meters	.007062
feet	meters	.305	centimeters	inches	.394
yards	meters	.914	meters	feet	3.280
miles	kilometers	1.609	meters	yards	1.094
square inches	square centimeters	6.451	kilometers	miles	.621
square feet	square meters	.093	square centimeters	square inches	.155
square yards	square meters	.836	square meters	square feet	10.764
square miles	square kilometers	2.590	square meters	square yards	1.196
acres	square hectometers	.405	square kilometers	square miles	.386
cubic feet	cubic meters	.028	square hectometers	acres	2.471
cubic yards	cubic meters	.765	cubic meters	cubic feet	35.315
fluid ounces	milliliters	29.573	cubic meters	cubic yards	1.308
pints	liters	.473	milliliters	fluid ounces	.034
quarts	liters	.946	liters	pints	2.113
gallons	liters	3.785	liters	quarts	1.057
ounces	grams	28.349	liters	gallons	.264
pounds	kilograms	.454	grams	ounces	.035
short tons	metric tons	.907	kilograms	pounds	2.205
pound-feet	Newton-meters	1.356	metric tons	short tons	1.102
pound-inches	Newton-meters	.11296			

## Temperature (Exact)

°F	Fahrenheit temperature	5/9 (after subtracting 32)	Celsius temperature	°C
----	------------------------	----------------------------	---------------------	----

PIN: 013505-000