

TM 11-6625-3198-24P

TECHNICAL MANUAL

**ORGANIZATIONAL, DIRECT SUPPORT, AND GENERAL
SUPPORT MAINTENANCE REPAIR PARTS AND SPECIAL
TOOLS LIST**

FOR

SIGNAL GENERATOR SG-1288/G

(NSN 6625-01-276-9421)

Distribution authorized to the Department of Defense and DOD contractors only for official use or for administration or operational purposes. This determination was made on 2 December 1988. Other requests for this document will be referred to Commander, US Army Communications-Electronics Command and Fort Monmouth, ATTN: AMSEL-LC-ME-P, Fort Monmouth, NJ 07703-5000.

DESTRUCTION NOTICE—Destroy by any method that will prevent disclosure of contents or reconstruction of the document.

HEADQUARTERS, DEPARTMENT OF THE ARMY

15 MAY 1989

**ORGANIZATIONAL, DIRECT SUPPORT, AND
GENERAL SUPPORT MAINTENANCE
REPAIR PARTS AND SPECIAL TOOLS LIST**

FOR

**SIGNAL GENERATOR SG-1288/G
(NSN 6625-01-276-9421)**

Current as of 23 March 1989

REPORTING ERRORS AND RECOMMENDING IMPROVEMENTS

You can help improve this manual. If you find any mistakes or if you know of a way to improve the procedures, please let us know. Mail your letter, DA form 2028 (Recommended Changes to Publications and Blank Forms), or DA Form 2028-2 located in the back of this manual direct to: Commander, US Army Communications-Electronics Command and Fort Monmouth, ATTN: AMSEL-LC-ME-PS, Ft. Monmouth, NJ 07703-5000. A reply will be furnished direct to you.

TABLE OF CONTENTS

			Page	Illus/ Fig
Section	I	INTRODUCTION	1	
Section	II	REPAIR PARTS LIST		
Group	00	Signal Generator SG-1288/G	1-1	1
	01	Front Panel/Display/Keyboard (No Parts Authorized)		
	02	Phase Lock Loop CCA (No Parts Authorized)		
	03	Function Generator CCA (No Parts Authorized).		
	04	Output CCA	2-1	2
	05	Motherboard CCA	3-1	3
	06	Rear Panel Assembly (No Parts Authorized)		
Section	III	SPECIAL TOOLS LIST		
Group	99	Special Tools	4-1	4
Section	IV	CROSS-REFERENCE INDEXES		
		National Stock Number Index	I-1	
		Part Number Index	I-2	
		Figure/Item Number Index	I-4	

SECTION I INTRODUCTION

1. Scope

This manual lists and authorizes spares and repair parts; special tools; special test, measurement, and diagnostic equipment (TMDE); and other special support equipment required for performance of organizational, direct support, and general support maintenance of the SG-1288/G. It authorizes the requisitioning, issue, and disposition of spares, repair parts, and special tools as indicated by the source, maintenance and recoverability (SMR) codes.

2. General

This Repair Parts and Special Tools List is divided into the following sections:

a. Section II. Repair Parts List. A list of spares and repair parts authorized by this RPSTL for use in the performance of maintenance. The list also includes parts which must be removed for replacement of the authorized parts. Parts list are composed of functional groups in ascending numeric sequence, with the parts in each group listed in ascending item number sequence. Figure numbers are listed directly beneath the group header. Items listed are shown on the associated illustration.

b. Section III. Special Tools List. A list of special tools, special TMDE, and other special support equipment authorized by this RPSTL (as indicated by Basis of Issue (BOI) information in (column (5)) for the performance of maintenance.

c. Section IV. Cross-Reference Indexes. A list, in National item identification number (NIIN) sequence, of all National stock numbered items appearing in the listing, followed by a list in alphanumeric sequence of all part numbers appearing in the listings. National stock numbers and part numbers are cross-referenced to each illustration figure and item number appearance. The figure number and item number index lists figure and item numbers in numeric sequence and cross-references National stock number, Federal Supply Code for Manufacturer and part numbers.

3. Explanation of Columns (Section II and III)

a. Item No. (Column (1)). Indicates the number used to identify items called out in the illustration.

b. SMR Code (Column (2)). The source, maintenance, and recoverability (SMR) code is a five-position code containing supply/requisitioning information, maintenance category authorization criteria, and disposition instructions, as shown in the following breakout:

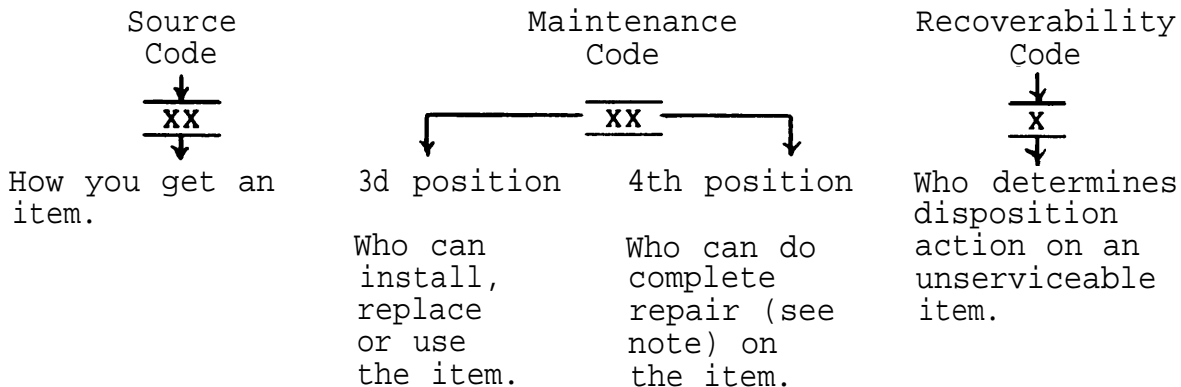

NOTE

Complete repair: Maintenance capacity, capability, and authority to perform all corrective maintenance tasks of the "repair" function in a use/user environment in order to restore serviceability to a failed item.

(1) Source code. The source code tells you how to get an item needed for maintenance, repair, or overhaul of an end item/equipment. Explanations of source codes follows:

Code	Explanation
<div style="border: 1px solid black; padding: 2px; display: inline-block;"> PA PB PC PD PE PF PG </div>	<p>Stocked items: use the applicable NSN to request/requisition items with these source codes. They are authorized to the category indicated by the code entered in the third position of the SMR code.</p>

NOTE

Items coded PC are subject to deterioration.

<div style="border: 1px solid black; padding: 2px; display: inline-block;"> KD KF KB </div>	<p>Items with these codes are not to be requested/requisitioned individually. They are part of a kit which is authorized to the maintenance category indicated in the third position of the SMR code. The complete kit must be requested and applied.</p>
---	---

Code

Explanation

MO - Made at org/AVUM category
MF - Made at DS/AVIM category
MH - Made at GS category
ML - Made at Specialized Repair Activity (SRA)
MD - Made at Depot

Items with these codes are not to be requested/requisitioned individually. They must be made from bulk material which is identified by the part number in the description and usable on code (UOC) column and listed in the Bulk Material group of the repair parts list. If the item is authorized to you by the third position code of the SMR code, but the source code indicates it is made at a higher category, order the item from the higher category of maintenance.

AO - Assembled by org/AVUM category
AF - Assembled by DS/AVIM category
AH - Assembled by GS category
AL - Assembled by SRA
AD - Assembled by Depot

Items with these codes are not to be requested/requisitioned individually. The parts that make up the assembled item must be requisitioned or fabricated and assembled at the category of maintenance indicated by the source code. If the third position code of the SMR code authorizes you to replace the item, but the source code indicates the item is assembled at a higher category, order the item from the higher category of maintenance.

Code

Explanation

- XA - Do not requisition an "XA" coded item. Order its next higher assembly.
- XB - If an "XB" item is not available from salvage, order it using the FCSM and part number given.
- XC - Installation drawing, diagram, instruction sheet, field service drawing, that is identified by manufacturer's part number.
- XD - Item is not stocked. Order an "XD" coded item through normal supply channels using the FSCM and part number given, if not available.

NOTE

Cannibalization or controlled exchange, when authorized, may be used as a source of supply for items with the above source codes, except for those source coded "XA" or those aircraft support items restricted by requirements of AR 750-1.

(2) Maintenance code. Maintenance codes tell you the category of maintenance authorized to USE and REPAIR support items. The maintenance codes are entered in the third and fourth positions of the SMR code as follows:

(a) The maintenance code entered in the third position tells you the lowest maintenance category authorized to remove, replace, and use an item. The maintenance code entered in the third position will indicate authorization to one of the following categories of maintenance.

<u>Code</u>	<u>Application/Explanation</u>
C -	Crew or operator maintenance done within organizational or aviation maintenance.
O -	Organizational or aviation unit category can remove, replace, and use the item.
F -	Direct support or aviation intermediate category can remove, replace, and use the item.
H -	General support category can remove, replace, and use the item.
L -	Specialized repair activity can remove, replace, and use the item.
D -	Depot category can remove, replace, and use the item.

(b) The maintenance code entered in the fourth position tells whether or not the item is to be repaired and identifies the lowest maintenance category with the capability to do complete repair (i.e., perform all authorized repair functions). This position will contain one of the following maintenance codes.

NOTE

Some limited repair may be done on the item at a lower category of maintenance, if authorized by the Maintenance Allocation Chart (MAC) and SMR codes.

<u>Code</u>	<u>Application/Explanation</u>
O -	Organizational or aviation unit is the lowest category that can do complete repair of the item.
F -	Direct support or aviation intermediate is the lowest category that can do complete repair of the item.
H -	General support is the lowest category that can do complete repair of the item.
L -	Specialized repair activity (designate the specialized repair activity) is the lowest category that can do complete repair of the item.
D -	Depot is the lowest category that can do complete repair of the item.

Code Application/Explanation

- Z - Nonreparable. No repair is authorized.
- B - No repair is authorized. (No parts or special tools are authorized for the maintenance of a "B" coded item.) However, the item may be reconditioned by adjusting, lubricating, etc., at the user category.

(3) Recoverability code. Recoverability codes are assigned to items to indicate the disposition action on unserviceable items. The recoverability code is entered in the fifth position of the SMR Code as follows:

Recoverability codes Application/Explanation

- Z - Nonreparable item. When unserviceable, condemn and dispose of the item at the category of maintenance shown in the third position of SMR code.
- O - Repairable item. When uneconomically repairable, condemn and dispose of the item at organizational or aviation unit category.
- F - Repairable item. When uneconomically repairable, condemn and dispose of the item at direct support or aviation intermediate category.
- H - Repairable item. When uneconomically repairable, condemn and dispose of the item at general support category.
- D - Repairable item. When beyond lower category repair capability, return to depot. Condemnation and disposal of item not authorized below depot category.
- L - Repairable item. Condemnation and disposal not authorized below specialized repair activity (SRA).
- A - Item requires special handling or condemnation procedures because of specific reasons (e.g., precious metal content, high dollar value, critical material, or hazardous material) . Refer to appropriate manuals/directives for specific instructions.

c. FSCM (Column (3)). The Federal Supply Code for Manufacturer (FSCM) is a 5-digit numeric code which is used to identify the manufacturer, distributor, or Government agency, etc. , that supplies the item.

d. Part Number (Column (4)). Indicates the primary number used by the manufacturer (individual, company, firm, corporation, or Government activity) , which controls the design and characteristics of the item by means of its engineering drawings, specifications? standards, and inspection requirements to identify an item or range of items.

NOTE

When you use an NSN to requisition an item, the item you receive may have a different part number from the part ordered.

e. Description and Usable on Code (UOC) (Column (5)). This column includes the following information.

(1) The Federal item name and, when required, a minimum description to identify the item.

(2) In the Special Tools section, the basis of issue (BOI) appears as the last line in the entry for each special tool, special TMDE, and other special support equipment. When density of equipments supported exceeds density spread indicated in the basis of issue, the total authorization is increased proportionately.

(3) The statement "END OF FIGURE" appears just below the last item description in Column (5) for a given figure in both section II and section III.

f. Qty (Column (6)). Indicates the quantity of the item used in the breakout shown on the illustration figure, which is prepared for a functional group, subfunctional group, or an assembly. A "V" appearing in this column in lieu of a quantity indicates that the quantity is variable and the quantity may vary from application to application.

4. Explanation of Columns (Section IV)

a. National Stock Number (NSN) Index.

(1) Stock number column. This column lists the NSN by National item identification number (NIIN) sequence. The NIIN consists of the last nine digits of the NSN. When using this column to locate an item, ignore the first four digits of the NSN. When requisitioning items use the complete NSN (13 digits).

(2) Fig. column. This column lists the number of the figure where the item is identified/located. The illustrations are in numerical sequence in sections II and III.

(3) Item column. The item number identifies the item associated with the figure listed in the adjacent Fig. column. This item is also identified by the NSN listed on the same line.

b. Part Number Index. Part numbers in this index are listed by part-number in ascending alphanumeric sequence.

(1) FSCM column. This column lists the Federal supply code for manufacturer.

(2) Part number column. This column indicates the part number assigned to the item.

(3) Stock number column. This column lists the National stock number for the associated part number and manufacturer identified in the part number and FSCM columns to the left.

(4) Fig. column. This column lists the number of the figure where the item is identified/located in sections II and III.

(5) Item column. The item number is that number assigned to the item as it appears in the figure referenced in the adjacent figure number column.

c. Figure and Item Number Index.

(1) Fig. column. This column lists the number of the figure where the item is identified/located in sections II and III.

(2) Item column. The item number is that number assigned to the item as it appears in the figure referenced in the adjacent figure number column.

(3) Stock number column. This column lists the National stock number for the item.

(4) FSCM column. The Federal supply code for manufacturer (FSCM) is a 5-digit numeric code used to identify the manufacturer, distributor, or Government agency, etc. that supplies the item.

(5) Part number column. Indicates the primary number used by the manufacturer (individual, firm, corporation, or Government activity), which controls the design and characteristics of the item by means of its engineering drawings, specifications, standards, and inspection requirements to identify an item or range of item.

5. Special Information

a. Associated Publications. The publications listed below pertain to the CP-1516/ASQ and its components:
 TM 11-6625-3198-12, Signal Generator SG-1288/G
 TM 11-6625-3198-40, Signal Generator SG-1288/G

b. National Stock Numbers. National stock numbers (NSN's) that are missing from P source coded items have been applied for and will be added to this TM by future change/revision when they are entered in the Army Master Data File (AMDF). Until the NSN's are established

and published, submit exception requisitions to: Commander, US Army Communications-Electronics Command and Fort Monmouth, ATTN : AMSEL-LC-MM, Fort Monmouth, NJ 07703-5000 for the part required to support your equipment.

6. How to Locate Repair Parts

a. When National stock number or part number is not known

(1) First. Using the table of contents, determine the assembly group or subassembly group to which the item belongs. This is necessary since figures are prepared for assembly groups and subassembly groups, and listings are divided into the same groups.

(2) Second. Find the figure covering the assembly group or subassembly group to which the item belongs.

(3) Third. Identify the item on the figure and note the item number.

(4) Fourth. Refer to the Repair Parts List for the figure to find the part number for the item number noted on the figure.

(5) Fifth. Refer to the Part Number Index to find the NSN, if assigned.

b. When National stock number or part number is known.

(1) First. Using the index of National stock numbers and part numbers, find the pertinent National stock number or part number. The NSN index is in National item identification number (NIIN) sequence (para 4a(1)). The part numbers in the part number index are listed in ascending alphanumeric sequence (para 4b). Both indexes cross-reference you to the illustration figure and item number of the item you are looking for.

(2) Second. After finding the figure and item number, verify that the item is the one you're looking for, then locate the item number in the repair parts list for the figure.

7. Abbreviations

Not applicable.

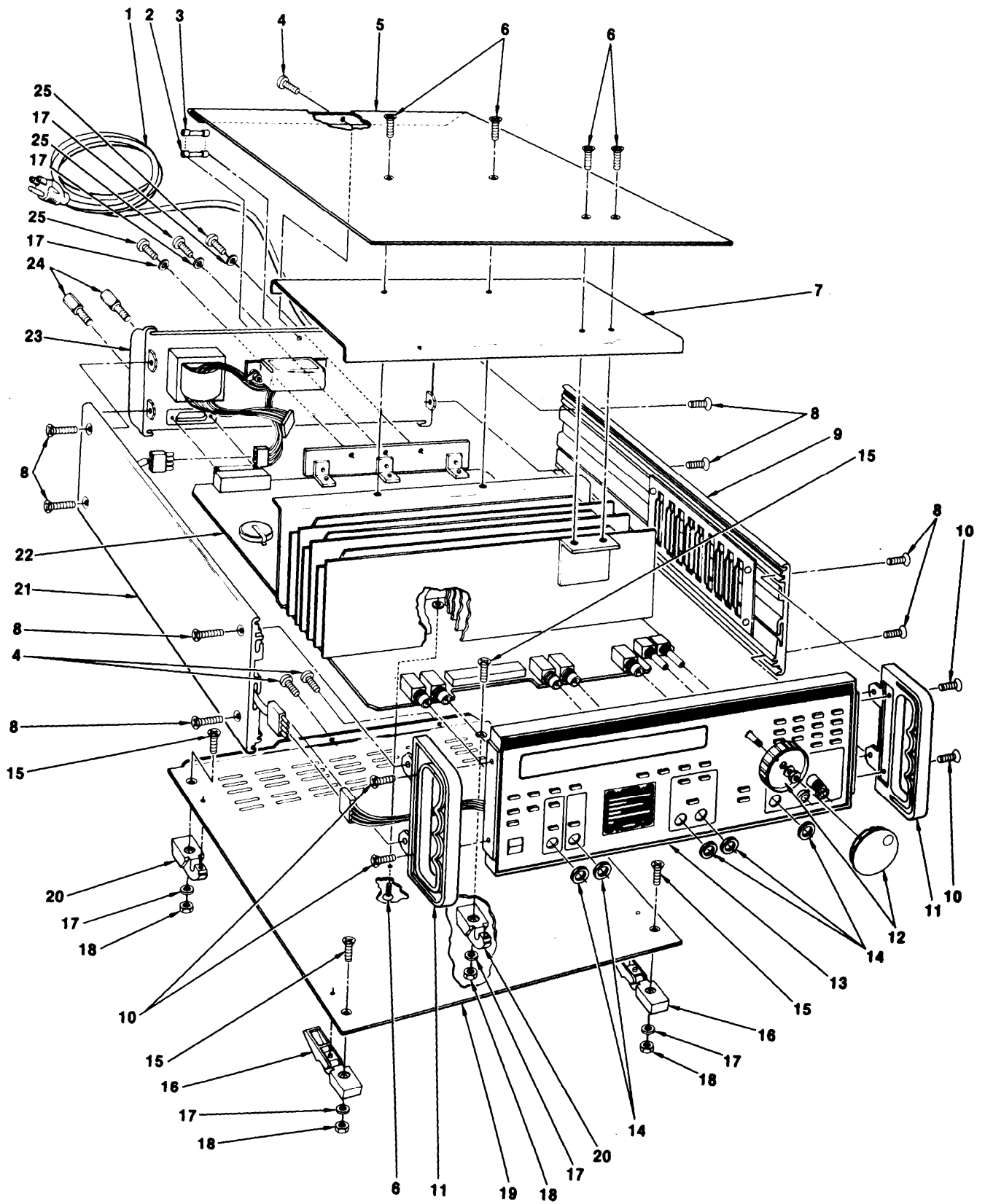
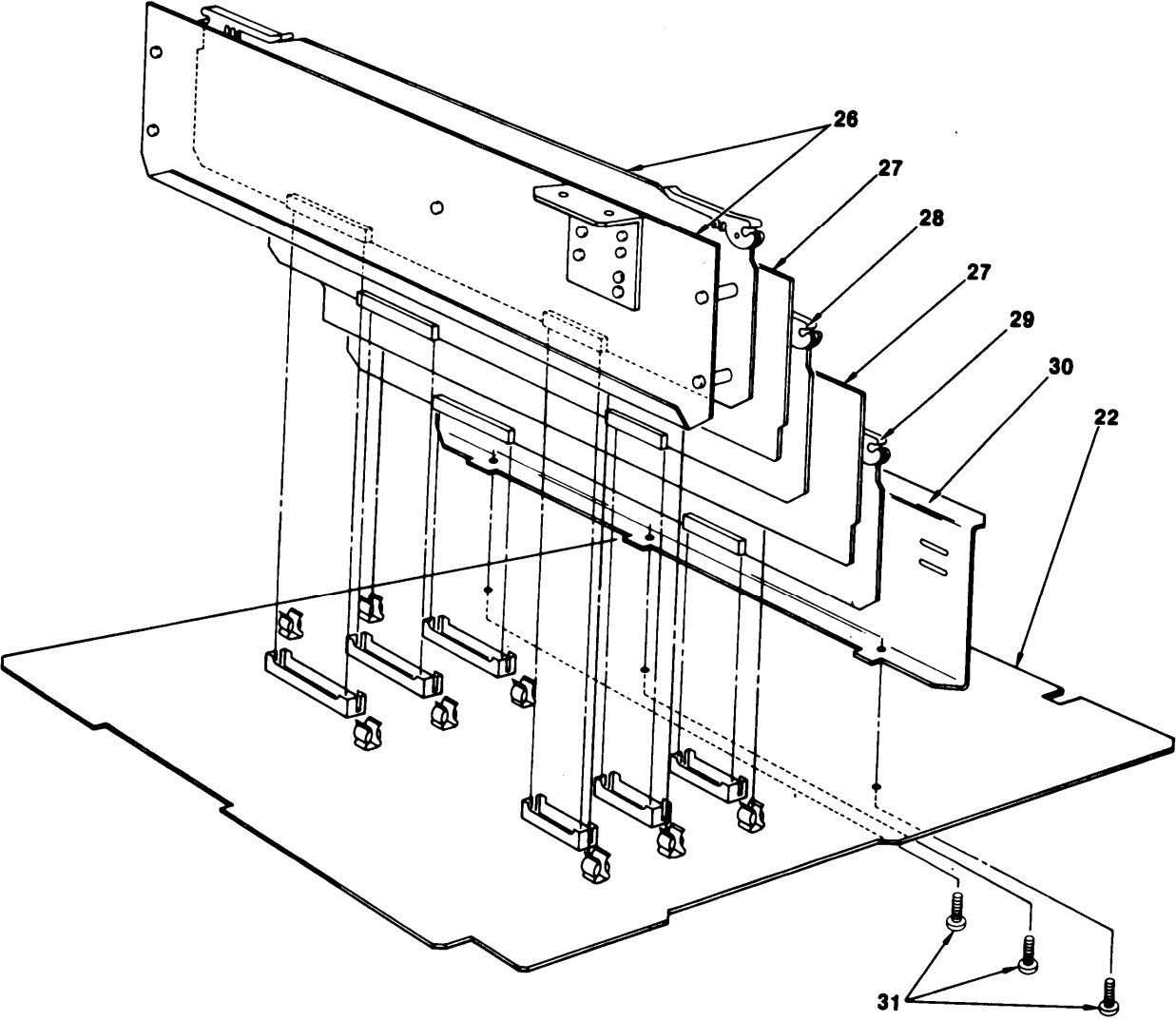

Figure 1. Signal Generator SG-1288/G (Sheet 1 of 2)



CE10F003

Figure 1. Signal Generator SG-1288/G (Sheet 2 of 2)

SECTION II			TM11-6625-3198-24P		(5)	(6)
(1)	(2)	(3)	(4)			
ITEM	SMR		PART			
NO	CODE	FSCM	NUMBER	DESCRIPTION AND USABLE ON CODES(UOC) QTY		

GROUP 00 SIGNAL GENERATOR
SG-1288/G

FIGURE 1

1	PAHZZ	23338	6001-80-0009	POWER CORD	1
2	PAOZZ	79915	313.750	FUSE	1
3	PAOZZ	75915	313.375	FUSE	1
4	PAHZZ	96906	MS51957-28	SCREW,MACHINE	3
5	XBHZZ	23338	1400-02-3532	COVER, TOP	1
6	PAHZZ	23338	2800-60-6106	SCREW	5
7	XBHZZ	23338	1400-02-3353	SHIELD, TOP	1
8	PAHZZ	23338	2800-54-8107	SCREW	8
9	XBHZZ	23338	1201-00-3013	PLATE ASSY, LEFT	1
10	PAOZZ	23338	2800-60-8107	SCREW	4
11	XBOZZ	23338	1400-02-3252	HANDLE	2
12	PAOZZ	23338	2400-01-0036	KNOB,COLLET	1
13	PAHZZ	23338	1101-00-3006	FRONT PANEL ASSY	1
14	PAHZZ	00779	1-329631-2	NUT, JAM	5
15	PAHZZ	23338	2800-54-8108	SCREW	4
16	PAHZZ	62559	10603-025	FOOT	2
17	PAHZZ	23338	2800-42-8000	WASHER, LOCK	7
18	PAHZZ	23338	2800-16-8106	NUT	4
19	XBHZZ	23338	1400-02-4522	COVER, BOTTOM	1
20	PAHZZ	62559	10603-026	FOOT	2
21	XBHZZ	23338	1201-00-3012	PLATE ASSY, RT	1
22	PAHHH	23338	1100-00-3000	MOTHER BOARD ASSY	1
23	XBHZZ	23338	1101-00-3007	REAR PANEL ASSY	1
24	XBHZZ	00779	554808-1	STANDOFF, STUD	2
25	PAHZZ	23338	2800-48-8108	SCREW	3
26	PAHHH	23338	1100-00-3002	OUTPUT BOARD ASSY	1
27	XBHZZ	23338	1400-02-3323	SHIELD, INNER	2
28	PAHZZ	23338	1100-00-3003	PHASE LOCK ASSY	1
29	PAHZZ	23338	1100-00-3004	FUNCTION GENERATOR	1
30	XBHZZ	23338	1400-02-4183	SHIELD, REAR	1
31	PAHZZ	23338	2800-59-6105	SCREW	3

END OF FIGURE

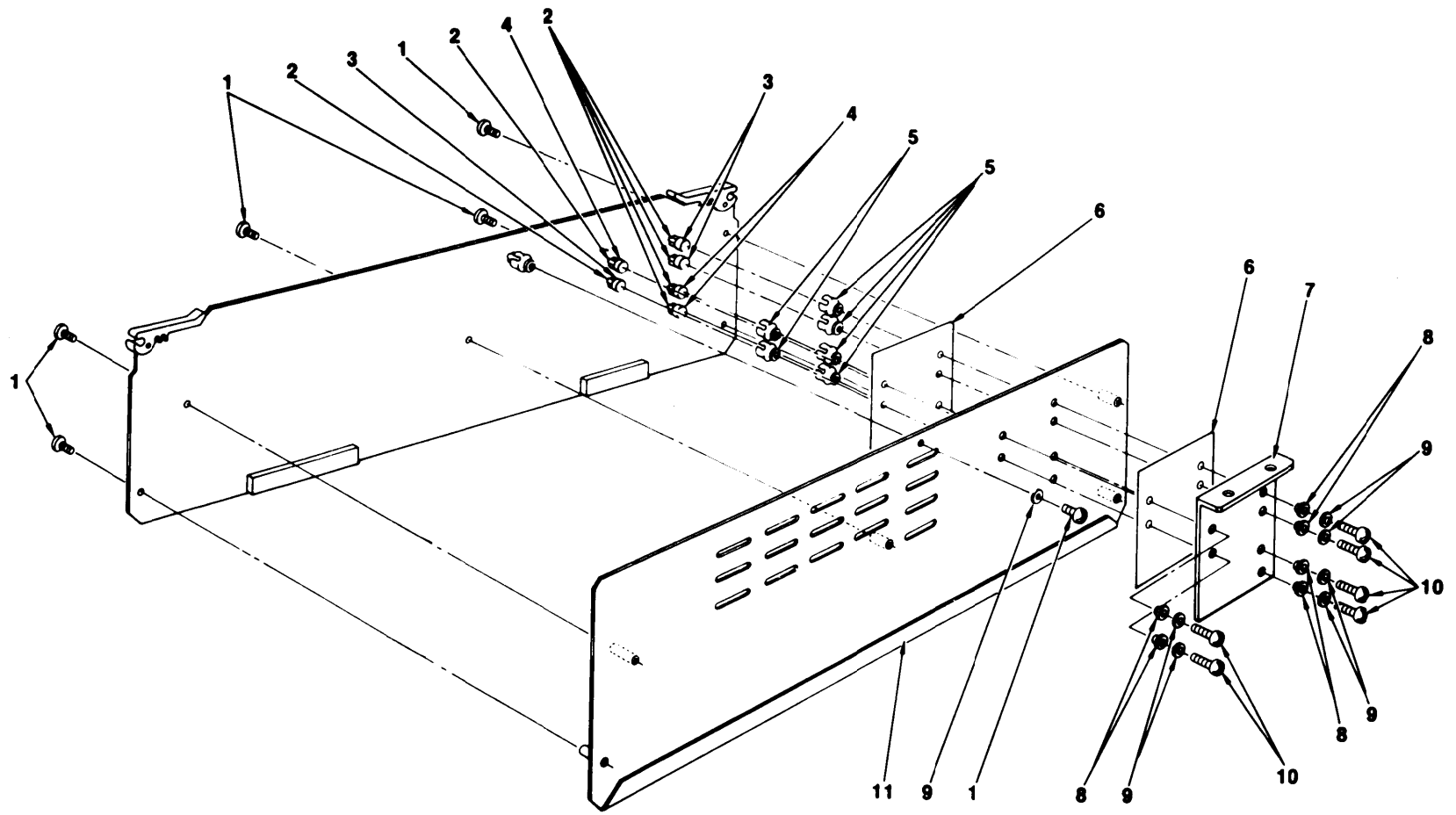

TM11-6625-3198-24P

CE10F004

Figure 2. Output Board Assembly

SECTION II			TM11-6625-3198-24P		(5)	(6)
(1)	(2)	(3)	(4)			
ITEM	SMR		PART	DESCRIPTION AND USABLE ON CODES(UOC)		QTY
NO	CODE	FSCM	NUMBER	GROUP 04	OUTPUT CCA	
FIGURE 2						
1	PAHZZ	23338	2800-23-4103		SCREW	6
2	PAHZZ	07047	10160		TRANSIPAD	6
3	PAHZZ	07263	2N3725		TRANSISTOR	3
4	PAHZZ	04713	2N5160-18		TRANSISTOR	3
5	PAHZZ	92218	260-4T5E		HEAT SINK,ELECTRICA	6
6	XBHZZ	23338	1400-02-4420		THERMAL GASKET	2
7	XBHZZ	23338	1400-02-3413		HEATSINK	1
8	PAHZZ	86928	5607-45		WASHER,SHOULDER	6
9	PAHZZ	96906	MS35338-135		WASHER,LOCK	7
10	PAHZZ	23338	2800-56-9106		SCREW	6
11	XBHZZ	23338	1400-02-3403		SHIELD	1

END OF FIGURE

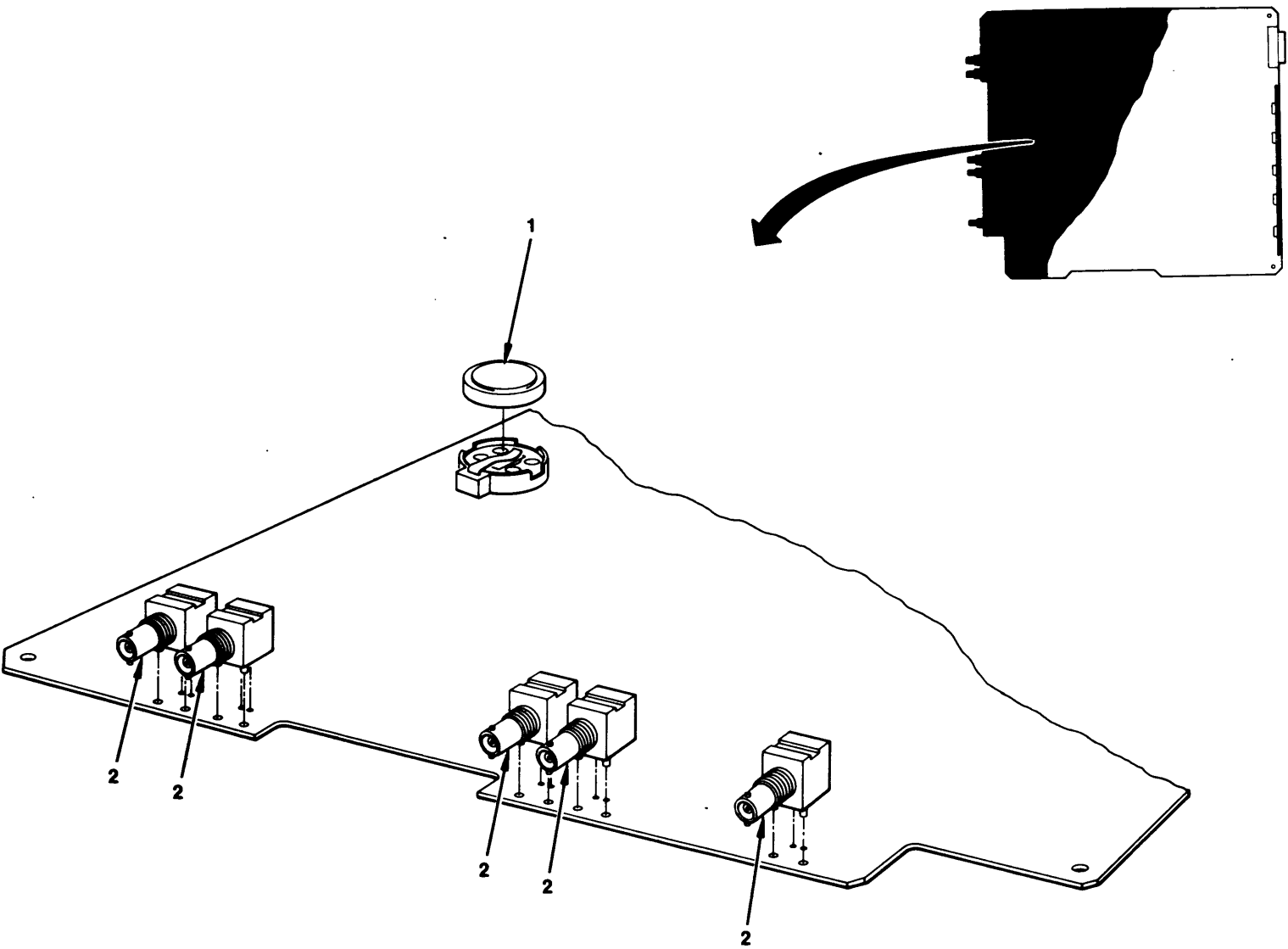
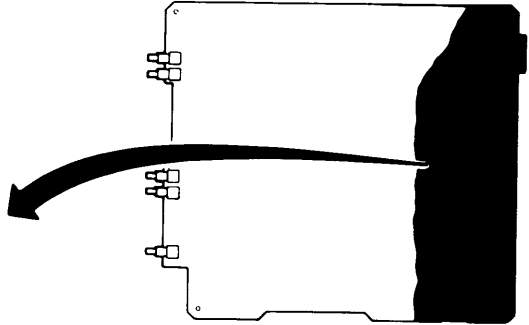
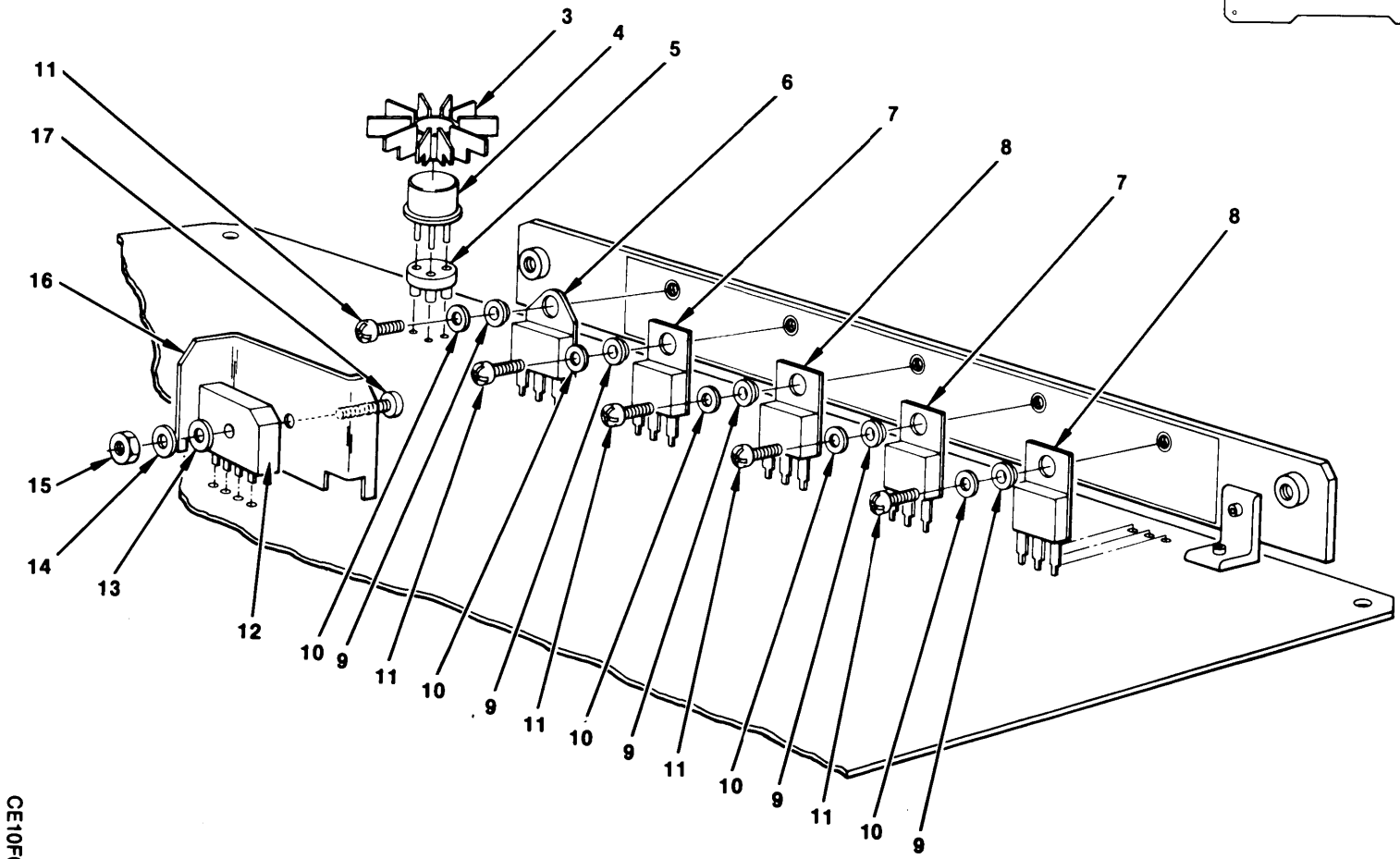

Figure 3. Mother Board Assembly (Sheet 1 of 2)

Figure 3. Mother Board Assembly (Sheet 2 of 2)



CE10F007

SECTION II			TM11-6625-3198-24P		(5)	(6)
(1)	(2)	(3)	(4)			
ITEM	SMR		PART			
NO	CODE	FSCM	NUMBER	DESCRIPTION AND USABLE ON CODES(UOC)	QTY	
				GROUP 05	MOTHERBOARD CCA	

FIGURE 3

1	PCHZZ	90903	DL2430	BATTERY	1
2	PAHZZ	00779	227161-1	CONNECTOR, BCN.	5
3	PAHZZ	05820	207	HEAT SINK, ELECTRICA	1
4	PAHZZ	27014	2N2905A	TRANSISTOR	1
5	PAHZZ	32559	531-218	TRANSIPAD	1
6	PAHZZ	01295	TIP-36	TRANSISTOR	1
7	PAHZZ	27014	LM317T	MICROCIRCUIT	2
8	PAHZZ	27014	LM337T	MICROCIRCUIT	2
9	PAHZZ	86928	5607-45	WASHER, SHOULDER	1
10	PAHZZ	96906	MS35338-135	WASHER, LOCK	1
11	PAHZZ	96906	MS51957-13	SCREW, MACHINE	1
12	PAHZZ	12060	RS602	DIODE	1
13	PAHZZ	23338	2800-26-6000	WASHER, FLAT	1
14	PAHZZ	23338	2800-42-6000	WASHER, LOCK	1
15	PAHZZ	96906	MS35649-264	NUT, PLAIN, HEXAGON	1
16	PAHZZ	23338	1400-02-4463	HEATSINK BRIDGE	1
17	PAHZZ	23338	2800-61-6109	SCREW	1

END OF FIGURE

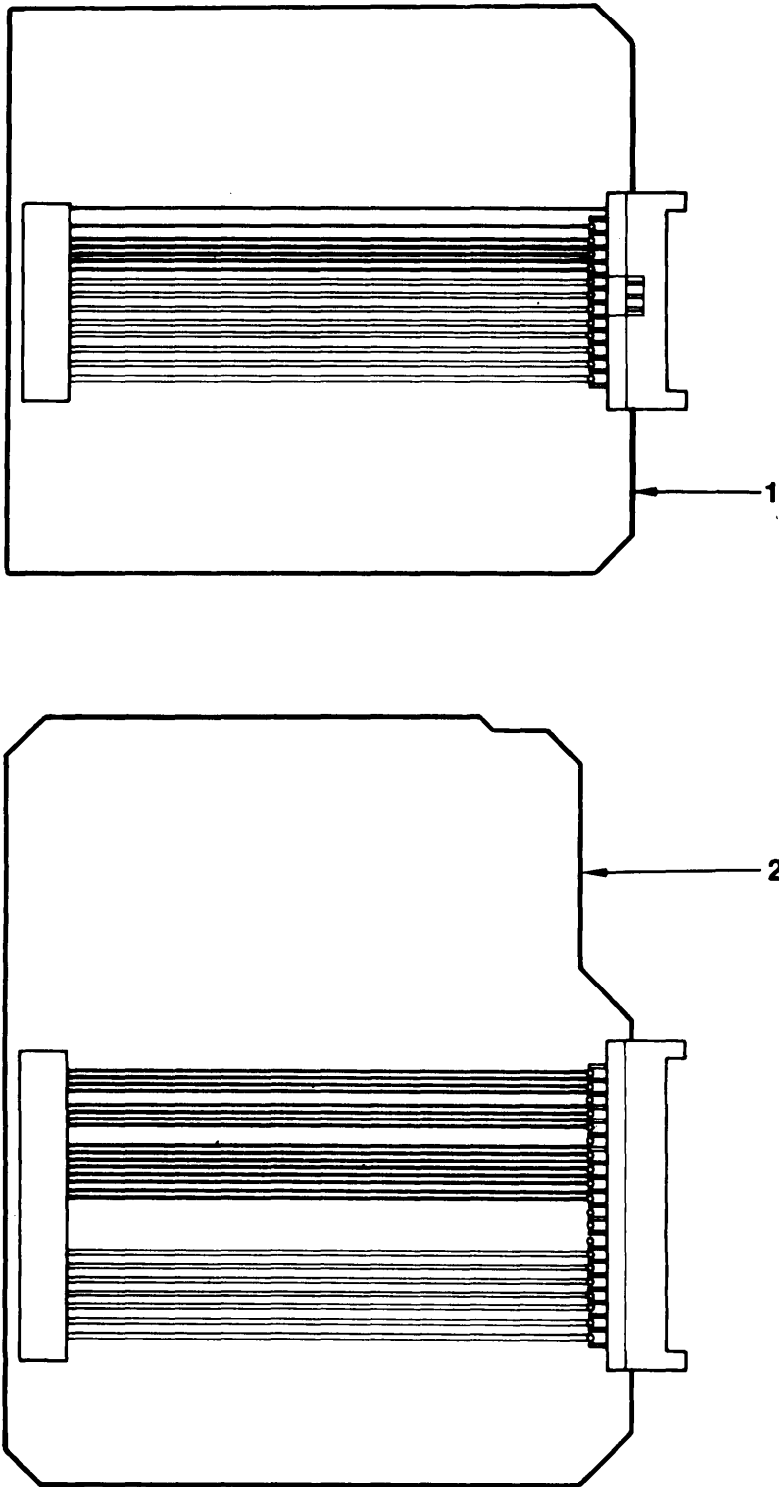

CE10F001

Figure 4. Special Tools

SECTION III			TM11-6625-3198-24P			
(1)	(2)	(3)	(4)		(5)	(6)
ITEM	SMR		PART			
NO	CODE	FSCM	NUMBER	DESCRIPTION AND USABLE ON CODES(UOC)	GROUP 99	QTY
				SPECIAL TOOLS		
				FIGURE 4 SPECIAL TOOLS		
				BOI: 1 PER GENERAL SUPPORT LEVEL		
1	PAHZZ	23338	1100-00-3015	EXTENDER CARD		1
2	PAHZZ	23338	1100-00-3016	EXTENDER CARD		1

END OF FIGURE

SECTION IV

TM11-6625-3198-24P

CROSS-REFERENCE INDEXES

STOCK NUMBER	NATIONAL STOCK NUMBER INDEX	FIG.	ITEM	FIG.	ITEM
5305-00-054-5647		3	11		
5305-00-054-6652		1	4		
5999-00-069-1027		2	2		
5999-00-126-7160		3	3		
5961-00-574-3850		2	3		
5310-00-933-8118		2	9		
		3	10		
5310-00-934-9761		3	15		
5962-01-129-2391		3	8		
5999-01-265-0346		2	5		

SECTION IV

TM11-6625-3198-24P

CROSS-REFERENCE INDEXES

FSCM	PART NUMBER	PART NUMBER INDEX STOCK NUMBER	FIG.	ITEM
90903	DL2430		3	1
27014	LM317T		3	7
27014	LM337T	5962-01-129-2391	3	8
96906	MS35338-135	5310-00-933-8118	2	9
			3	10
96906	MS35649-264	5310-00-934-9761	3	15
96906	MS51957-13	5305-00-054-5647	3	11
96906	MS51957-28	5305-00-054-6652	1	4
12060	RS602		3	12
01295	TIP-36		3	6
00779	1-329631-2		1	14
07047	10160	5999-00-069-1027	2	2
62559	10603-025		1	16
62559	10603-026		1	20
23338	1100-00-3000		1	22
23338	1100-00-3002		1	26
23338	1100-00-3003		1	28
23338	1100-00-3004		1	29
23338	1100-00-3015		4	1
23338	1100-00-3016		4	2
23338	1101-00-3006		1	13
23338	1101-00-3007		1	23
23338	1201-00-3012		1	21
23338	1201-00-3013		1	9
23338	1400-02-3252		1	11
23338	1400-02-3323		1	27
23338	1400-02-3353		1	7
23338	1400-02-3403		2	11
23338	1400-02-3413		2	7
23338	1400-02-3532		1	5
23338	1400-02-4183		1	30
23338	1400-02-4420		2	6
23338	1400-02-4463		3	16
23338	1400-02-4522		1	19
27014	2N2905A		3	4
07263	2N3725	5961-00-576-3850	2	3
04713	2N5160-18		2	4
05820	207	5999-00-126-7160	3	3
00779	227161-1		3	2
23338	2400-01-0036		1	12
92218	260-4T5E	5999-01-265-0346	2	5
23338	2800-16-8106		1	18
23338	2800-23-4103		2	1
23338	2800-26-6000		3	13
23338	2800-42-6000		3	14
23338	2800-42-8000		1	17
23338	2800-48-8108		1	25
23338	2800-54-8107		1	8
23338	2800-54-8108		1	15
23338	2800-56-9106		2	10
23338	2800-59-6105		1	31

SECTION IV

TM11-6625-3198-24P

CROSS-REFERENCE INDEXES

FSCM	PART NUMBER	PART NUMBER INDEX STOCK NUMBER	FIG.	ITEM
23338	2800-60-6106		1	6
23338	2800-60-8107		1	10
23338	2800-61-6109		3	17
75915	313.375		1	3
79915	313.750		1	2
32559	531-218		3	5
00779	554808-1		1	24
86928	5607-45		2	8
			3	9
23338	6001-80-0009		1	1

SECTION IV

TM11-6625-3198-24P

CROSS-REFERENCE INDEXES

FIG.	ITEM	FIGURE AND ITEM NUMBER INDEX STOCK NUMBER	FSCM	PART NUMBER
1	1		23338	6001-80-0009
1	2		79915	313.750
1	3		75915	313.375
1	4	5305-00-054-6652	96906	MS51957-28
1	5		23338	1400-02-3532
1	6		23338	2800-60-6106
1	7		23338	1400-02-3353
1	8		23338	2800-54-8107
1	9		23338	1201-00-3013
1	10		23338	2800-60-8107
1	11		23338	1400-02-3252
1	12		23338	2400-01-0036
1	13		23338	1101-00-3006
1	14		00779	1-329631-2
1	15		23338	2800-54-8108
1	16		62559	10603-025
1	17		23338	2800-42-8000
1	18		23338	2800-16-8106
1	19		23338	1400-02-4522
1	20		62559	10603-026
1	21		23338	1201-00-3012
1	22		23338	1100-00-3000
1	23		23338	1101-00-3007
1	24		00779	554808-1
1	25		23338	2800-48-8108
1	26		23338	1100-00-3002
1	27		23338	1400-02-3323
1	28		23338	1100-00-3003
1	29		23338	1100-00-3004
1	30		23338	1400-02-4183
1	31		23338	2800-59-6105
2	1		23338	2800-23-4103
2	2	5999-00-069-1027	07047	10160
2	3	5961-00-574-3850	07263	2N3725
2	4		04713	2N5160-18
2	5	5999-01-265-0346	92218	260-4T5E
2	6		23338	1400-02-4420
2	7		23338	1400-02-3413
2	8		86928	5607-45
2	9	5310-00-933-8118	96906	MS35338-135
2	10		23338	2800-56-9106
2	11		23338	1400-02-3403
3	1		90903	DL2430
3	2		00779	227161-1
3	3	5999-00-126-7160	05820	207
3	4		27014	2N2905A
3	5		32559	531-218
3	6		01295	TIP-36
3	7		27014	LM317T
3	8	5962-01-129-2391	27014	LM337T
3	9		86928	5607-45

SECTION IV

TM11-6625-3198-24P

CROSS-REFERENCE INDEXES

FIG.	ITEM	FIGURE AND ITEM STOCK NUMBER	NUMBER INDEX FSCM	PART NUMBER
3	10	5310-00-933-8118	96906	MS35338-135
3	11	5305-00-054-5647	96906	MS51957-13
3	12		12060	RS602
3	13		23338	2800-26-6000
3	14		23338	2800-42-6000
3	15	5310-00-934-9761	96906	MS35649-264
3	16		23338	1400-02-4463
3	17		23338	2800-61-6109
4	1		23338	1100-00-3015
4	2		23338	1100-00-3016

RECOMMENDED CHANGES TO EQUIPMENT TECHNICAL PUBLICATIONS



THEN JOT DOWN THE DOPE ABOUT IT ON THIS FORM. CAREFULLY TEAR IT OUT. FOLD IT AND DROP IT IN THE MAIL.

SOMETHING WRONG WITH THIS PUBLICATION?

FROM (PRINT YOUR UNIT'S COMPLETE ADDRESS)
 Commander
 Stateside Army Depot
 ATTN: AMSTA-US
 Stateside, N.J. 07703-5007

DATE SENT
 10 July 1975

PUBLICATION NUMBER TM 11-5840-340-20P	PUBLICATION DATE 23 Jan 78	PUBLICATION TITLE Radar Set AN/PRC-76
--	-------------------------------	--

BE EXACT PIN-POINT WHERE IT IS				IN THIS SPACE TELL WHAT IS WRONG AND WHAT SHOULD BE DONE ABOUT IT:
PAGE NO	PARA. GRAPH	FIGURE NO	TABLE NO	
33				For item 2, change the NSN to read: 5835-00-134-9186. Reason: Accuracy.
44		19		Identify the cover on the junction box (item no. 5). Reason: It is a separate item and is not called out on figure 19.
45				Add the cover of the junction box as an item in the listing for figure 19. Reason: Same as above

SAMPLE

114R MON. PRIORITY (M)

PRINTED NAME GRADE OR TITLE AND TELEPHONE NUMBER SSG I. M. DeSpirit of 999-1776	SIGN HERE
--	---------------

FILL IN YOUR
UNIT'S ADDRESS

FOLD BACK

DEPARTMENT OF THE ARMY

POSTAGE AND FEES PAID
DEPARTMENT OF THE ARMY
DOD 314



OFFICIAL BUSINESS
PENALTY FOR PRIVATE USE \$300

SAMPLE

Commander
US Army Communications-Electronics Command
and Fort Monmouth
ATTN: AMSEL-LC-ME-PS
Fort Monmouth, New Jersey 07703-5000

TEAR ALONG PERFORATED LINE

RECOMMENDED CHANGES TO EQUIPMENT TECHNICAL PUBLICATIONS



THEN...JOT DOWN THE DOPE ABOUT IT ON THIS FORM. CAREFULLY TEAR IT OUT, FOLD IT AND DROP IT IN THE MAIL.

SOMETHING WRONG WITH THIS PUBLICATION?

FROM: (PRINT YOUR UNIT'S COMPLETE ADDRESS)

DATE SENT

PUBLICATION NUMBER

TM 11-6625-3198-24P

PUBLICATION DATE

15 May 1989

PUBLICATION TITLE

Signal Generator SG-1288/G

BE EXACT PIN-POINT WHERE IT IS

PAGE NO.

PARA-GRAPH

FIGURE NO.

TABLE NO.

IN THIS SPACE TELL WHAT IS WRONG AND WHAT SHOULD BE DONE ABOUT IT:

TEAR ALONG PERFORATED LINE

PRINTED NAME GRADE OR TITLE AND TELEPHONE NUMBER

SIGN HERE

FILL IN YOUR
UNIT'S ADDRESS

FOLD BACK

DEPARTMENT OF THE ARMY

OFFICIAL BUSINESS
PENALTY FOR PRIVATE USE \$300

POSTAGE AND FEES PAID
DEPARTMENT OF THE ARMY
DOD 314



TEAR ALONG PERFORATED LINE

Commander
US Army Communications-Electronics Command
and Fort Monmouth
ATTN: AMSEL-LC-ME-PS
Fort Monmouth, New Jersey 07703-5000

RECOMMENDED CHANGES TO EQUIPMENT TECHNICAL PUBLICATIONS



THEN...JOT DOWN THE DOPE ABOUT IT ON THIS FORM. CAREFULLY TEAR IT OUT, FOLD IT AND DROP IT IN THE MAIL.

SOMETHING WRONG WITH THIS PUBLICATION?

FROM: (PRINT YOUR UNIT'S COMPLETE ADDRESS)

DATE SENT

PUBLICATION NUMBER

TM 11-6625-3198-24P

PUBLICATION DATE

15 May 1989

PUBLICATION TITLE

Signal Generator SG-1288/G

BE EXACT PIN-POINT WHERE IT IS

PAGE NO.

PARA-GRAPH

FIGURE NO.

TABLE NO.

IN THIS SPACE TELL WHAT IS WRONG AND WHAT SHOULD BE DONE ABOUT IT:

TEAR ALONG PERFORATED LINE

PRINTED NAME GRADE OR TITLE AND TELEPHONE NUMBER

SIGN HERE

DA FORM 2028-2
1 JUL 79

PREVIOUS EDITIONS ARE OBSOLETE

P.S.--IF YOUR OUTFIT WANTS TO KNOW ABOUT YOUR RECOMMENDATION MAKE A CARBON COPE OF THIS AND GIVE IT TO YOUR HEADQUARTERS.

FILL IN YOUR
UNIT'S ADDRESS

FOLD BACK

DEPARTMENT OF THE ARMY

OFFICIAL BUSINESS
PENALTY FOR PRIVATE USE \$300

POSTAGE AND FEES PAID
DEPARTMENT OF THE ARMY
DOD 314



TEAR ALONG PERFORATED LINE

Commander
US Army Communications-Electronics Command
and Fort Monmouth
ATTN: AMSEL-LC-ME-PS
Fort Monmouth, New Jersey 07703-5000

RECOMMENDED CHANGES TO EQUIPMENT TECHNICAL PUBLICATIONS



THEN...JOT DOWN THE DOPE ABOUT IT ON THIS FORM. CAREFULLY TEAR IT OUT, FOLD IT AND DROP IT IN THE MAIL.

SOMETHING WRONG WITH THIS PUBLICATION?

FROM: (PRINT YOUR UNIT'S COMPLETE ADDRESS)

DATE SENT

PUBLICATION NUMBER TM 11-6625-3198-24P	PUBLICATION DATE 15 May 1989	PUBLICATION TITLE Signal Generator SG-1288/G
---	---------------------------------	---

BE EXACT PIN-POINT WHERE IT IS				IN THIS SPACE TELL WHAT IS WRONG AND WHAT SHOULD BE DONE ABOUT IT:
PAGE NO.	PARA-GRAPH	FIGURE NO.	TABLE NO.	

TEAR ALONG PERFORATED LINE

PRINTED NAME GRADE OR TITLE AND TELEPHONE NUMBER	SIGN HERE
--	-----------

DA FORM 1 JUL 79 2028-2

PREVIOUS EDITIONS ARE OBSOLETE

P.S...IF YOUR OUTFIT WANTS TO KNOW ABOUT YOUR RECOMMENDATION MAKE A CARBON COPE OF THIS AND GIVE IT TO YOUR HEADQUARTERS.

FILL IN YOUR
UNIT'S ADDRESS

FOLD BACK

DEPARTMENT OF THE ARMY

OFFICIAL BUSINESS
PENALTY FOR PRIVATE USE \$300

POSTAGE AND FEES PAID
DEPARTMENT OF THE ARMY
DOD 314



TEAR ALONG PERFORATED LINE

Commander
US Army Communications-Electronics Command
and Fort Monmouth
ATTN: AMSEL-LC-ME-PS
Fort Monmouth, New Jersey 07703-5000

By Order of the Secretary of the Army:

Official:

CARL E. VUONO
General, United States Army
Chief of Staff

WILLIAM J. MEEHAN II
Brigadier General, United States Army
The Adjutant General

Distribution:

To be distributed in accordance with special list.

