

TECHNICAL MANUAL

UNIT, DIRECT SUPPORT AND GENERAL SUPPORT MAINTENANCE
REPAIR PARTS AND SPECIAL TOOLS LIST
(INCLUDING REPAIR PARTS AND SPECIAL TOOLS)

FOR

TEST SET, INSULATION
AN/GSM-6B

(NSN 662541-288-9883) (EIC: N/A)

Distribution authorized to US Government agencies and their contractors **for official use or for administrative or operational purposes only**. This determination was made on 1 June 1992. Other requests for this document will be referred to Commander, US Army Communications-Electronics Command and Fort Monmouth, ATTN: AMSEL-LC-LM-LT, Fort Monmouth, New Jersey 07703-5007.

DESTRUCTION NOTICE - Destroy by any method that will prevent disclosure of contents or reconstruction of the document.

HEADQUARTERS, DEPARTMENT OF THE ARMY

15 MARCH 1994

TECHNICAL MANUAL

No. 11-6625-3265-24P

HEADQUARTERS
DEPARTMENT OF THE ARMY
Washington, DC, 15 March 1994

**TECHNICAL MANUAL
UNIT, DIRECT SUPPORT AND
GENERAL SUPPORT MAINTENANCE
REPAIR PARTS AND SPECIAL TOOLS LIST
(INCLUDING DEPOT MAINTENANCE
REPAIR PARTS AND SPECIAL TOOLS)
FOR**

**TEST SET, INSULATION
AN/GSM-6B
(NSN 6625-01-288-9883) (EIC: N/A)**

Current as of 15 December 1993

REPORTING ERRORS AND RECOMMENDING IMPROVEMENTS

You can help improve this manual. If you find any mistakes, or if you know of a way to improve the procedures, please let us know. Mail your letter, DA Form 2028 (Recommended Changes to Publications and Blank Forms) or DA Form 2028-2 located in back of this manual direct to: Commander, US Army Communications-Electronics Command and Fort Monmouth, ATTN: AMSEL-LC-LM-LT, Fort Monmouth, New Jersey 07703-5007.

In either case a reply will be furnished direct to you.

Table of Contents

			Page	Illus Figure
Section	I.	Introduction.....	1	
	II.	Repair Parts List.....	1-1	
Group	00	Test Set, Insulation AN/GSM-6B.....	1-1	1
	01	Control Unit.....	2-1	2
		0101 Panel Assembly.....	3-1	3
		010101 Circuit Cd.....	4-1	4
	02	High Voltage Unit.....	5-1	5
	03	HV Cable Assembly.....	6-1	6
	04	Interconnection Cable.....	7-1	7
	05	Ground Cable.....	8-1	8
Section	III.	Special Tools List (Not applicable)		
	Iv.	Cross-Reference Index.....	I-1	
		National stock number.....	I-1	
		Part number Index.....	I-3	
		Figure and item number Index.....	I-7	

SECTION 1 INTRODUCTION

1. SCOPE

This manual lists and authorizes spares and repair parts; special tools; special test, measurement, and diagnostic equipment (TMDE); and other special support equipment required for the performance of unit, direct support and general support maintenance of Test Set, Insulation AN/GSM-6B. It authorizes the requisitioning, issue, and disposition of spares, repair parts and special tools as indicated by the source, maintenance, and recoverability (SMR) codes.

2. GENERAL

In addition to Section I, Introduction, this Repair Parts and Special Tools List is divided into the following sections:

a. *Section II. Repair Parts List* A list of spares and repair parts authorized by this RPSTL for use in the performance of maintenance. This list also includes parts which must be removed for replacement of the authorized parts. Parts lists are composed of functional groups in ascending alphanumeric sequence, with the parts in each group listed in ascending item number sequence. Figure numbers are listed directly beneath the group header. Bulk materials are listed in item name sequence. Repair part kits are listed separately in their own functional group within Section II. Repair parts for reparable special tools are also listed in this section. Items listed are shown on the associated illustration.

b. *Section III. Special Tools List*. Not applicable. A list of special tools, special TMDE, and other special support equipment authorized by this RPSTL as indicated by Basis of Issue (BOI) information in (column (5)) for the performance of maintenance.

c. *Section IV Cross-Reference Indexes*. A list, in National item identification number (NIIN) sequence, of all National stock numbered items appearing in the listing, followed by a list in alphabetic sequence of all part numbers appearing in the listings. National stock numbers and part numbers are cross-referenced to each illustration figure and item number appearance. The figure number and item number index lists figure and item numbers in numeric sequence and cross-references National stock number, Commercial and Government Entity Code, and part numbers.

3. EXPLANATION OF COLUMNS (Section II and III)

a. *Hem No. (Column (1))*. Indicates the number used to identify items called out in the illustration.

b. *SMR Code (Column (2))*. The source, maintenance, and recoverability (SMR) code is a five-position code containing supply/requisitioning information, maintenance category authorization criteria and disposition instruction, as shown in the following breakout:

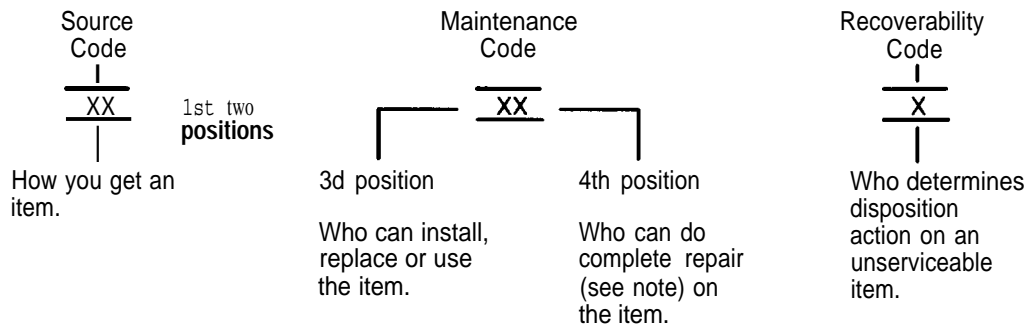

NOTE

Complete repair Maintenance capacity, capability, and authority to perform all corrective maintenance tasks of the "repair" function in a use/user environment in order to restore serviceability to a failed item.

(1) Source code. The source code tells you how to get an item needed for maintenance, repair, or overhaul of an end item/equipment. Explanations of source codes follows:

Code

Explanation

PA
PB
PC
PD
PE
PF
PG

Stocked items: use the applicable NSN to request/requisition items with these source codes. They are authorized to the level indicated by the code entered in the third position of the SMR code.

NOTE

Items coded PC are subject to deterioration.

KD
KF
KB

Items with these codes are not to be requested/requisitioned individually. They are part of a kit which is authorized to the maintenance category indicated in the third position of the SMR code. The complete kit must be requisitioned and applied.

MO – Made at org/AVUM category
MF – Made at DS/AVIM category
MH – Made at GS category
ML – Made at Specialized Repair Activity (SRA)
MD – Made at Depot

Items with these codes are not to be requested/requisitioned individually. They must be made from bulk material which is identified by the part number in the description and usable on code (UOC) column and listed in the Bulk Material group of the repair parts list. If the item is authorized to you by the third position code of the SMR code, but the source code indicates it is made at a higher category, order the item from the higher category of maintenance.

AO – Assembled by org/AVUM category
AF – Assembled by DS/AVIM category
AH – Assembled by GS category

Items with these codes are not to be requested/requisitioned individually. The parts that make up the assembled item must be requisitioned or fabricated and assembled at the category of maintenance indicated by the source code. If the third position code of the SMR code authorizes you to replace the item, but the source code indicates the item is assembled at a higher category, order the item from the higher category of maintenance.

Code	<i>Explanation</i>
XA	Do not requisition an "XA" coded item. Order its next higher assembly. (Also, refer to NOTE below.)
X6	If an "XB" item is not available from salvage, order it using the CAGEC and part number given.
XC	Installation drawing, diagram, instruction sheet, field service drawing, that is identified by manufacturer's part number.
XD	Item is not stocked. Order an "XD" coded item through normal supply channels using the CAGEC and part number given, if no NSN is available.

NOTE

Cannibalization or controlled exchange, when authorized, may be used as a source of supply for items with the above source codes, except for those source coded "XA" or those aircraft support items restricted by requirements of AR 750-1.

(2) *Maintenance code.* Maintenance codes tell you the category of maintenance authorized to USE and REPAIR support items. The maintenance codes are entered in the third and fourth positions of the SMR code as follows:

(a) The maintenance code entered in the third position tells you the lowest maintenance category authorized to remove, replace, and use an item. The maintenance code entered in the third position will indicate authorization to one of the following categories of maintenance.

<i>Code</i>	Application/Explanation
C	Crew or operator maintenance done within organizational or aviation maintenance.
O	Organizational or aviation unit category can remove, replace, and use the item.
F	Direct support or aviation intermediate category can remove, replace, and use the item.
H	General support category can remove, replace, and use the item.
L	Specialized repair activity can remove, replace, and use the item.
D	Depot category can remove, replace, and use the item.

(b) The maintenance code entered in the fourth position tells whether or not the item is to be repaired and identifies the lowest maintenance category with the capability to do complete repair (i.e., perform all authorized repair functions). This position will contain one of the following maintenance codes.

NOTE

Some limited repair may be done on the item at a lower category of maintenance, if authorized by the Maintenance Allocation Chart (MAC) and SMR codes.

<i>Code</i>	<i>Explanation</i>
O	Organizational or aviation unit is the lowest category that can do complete repair of the item.
F	Direct support or aviation intermediate is the lowest category that can do complete repair of the item.
H	General support is the lowest category that can do complete repair of the item.
L	Specialized repair activity (designate the specialized repair activity) is the lowest category that can do complete repair of the item.
D	Depot is the lowest category that can do complete repair of the item.
Z	Nonreparable. No repair is authorized.
B	No repair is authorized. (No parts or special tools are assigned for the maintenance of "B" coded item.) However, the item may be reconditioned by adjusting, lubricating, etc., at the user category.

(3) *Recoverability code.* Recoverability codes are assigned to items to indicate the disposition action on unserviceable items. The recoverability code is entered in the fifth position of the SMR code as follows:

Recoverability

Code	<i>Application/Explanation</i>
Z	Nonreparable item. When unserviceable, condemn and dispose of the item at the category of maintenance shown in the third position of SMR code.
O	Reparable item. When uneconomically repairable, condemn and dispose of the item at organizational or aviation unit category.

Recoverability

Code

Application/Explanation

- F – Reparable item. When uneconomically repairable, condemn and dispose of the item at direct support or aviation intermediate category.
- H – Reparable item. When uneconomically repairable, condemn and dispose of the item at general support category.
- D – Reparable item. When beyond lower category repair capability, return to depot. Condemnation and disposal of item not authorized below depot category.
- L – Reparable item. Condemnation and disposal not authorized below specialized repair activity (SRA).
- A – Item requires special handling or condemnation procedures because of specific reasons (e.g., precious metal content, high dollar value, critical material, or hazardous material. Refer to appropriate manuals/directives for specific instructions.

c. *CAGEC (Column (3))*. The Commercial and Government Entity Code (CAGEC) is a 5-digit numeric code which is used to identify the manufacturer, distributor, or Government agency, etc., that supplies the item.

d. *Part Number (Column (4))*. Indicates the primary number used by the manufacturer (individual, company, firm, corporation, or Government activity), which controls the design and characteristics of the item by means of its engineering drawings, specifications, standards, and inspection requirements to identify an item or range of items.

NOTE

When you use an NSN to requisition an item, the item you receive may have a different part number from the part ordered.

e. Description and Usable on Code (UOC) (Column (5)). This column includes the following information.

(1) The Federal item name and, when required, a minimum description to identify the item.

(2) The physical security classification of the item is indicated by the parenthetical entry (insert applicable physical security classification abbreviation, e.g., Phy Sec C 1 (C) – Confidential, Phy Sec CI (S) - Secret, Phy Sec CI (T) - Top Secret).

(3) Items that are included in kits and sets are listed below the name of the kit or set.

(4) Spare/repair parts that make up an assembled item are listed immediately following the assembled item line entry.

(5) Part numbers for bulk materials are referenced in this column in the line entry for the item to be manufactured/fabricated.

(6) When the item is not used with all serial numbers of the same model, the effective serial numbers are shown on the last line of the description (before UOC).

(7) Usable on code, when applicable (para 5).

(8) In the Special Tools section, the basis of issue (BOI) appears as the last line in the entry for each special tool, special TMDE, and other special support equipment. When density of equipments supported exceeds density spread indicated in the basis of issue, the total authorization is increased proportionately.

(9) The statement "END OF FIGURE" appears just below the last item description in Column (5) for a given figure in both section II and section III.

f. Qty (Column (6)). Indicates the quantity of the item used in the breakout shown on the illustration figure, which is prepared for a functional group, subfunctional group, or an assembly. A "V" appearing in this column in lieu of a quantity indicates that the quantity is variable and the quantity may vary from application to application.

4. EXPLANATION OF COLUMNS (Section IV)

a. National Stock Number (NSN) Index.

(1) Stock number column. This column lists the NSN by National item identification number (NIIN) sequence. The NIIN consists of the last nine digits of the NSN. When using this column to locate an item, ignore the first four digits of the NSN. When requisitioning items use the complete NSN (13 digits) sequence.

(2) Fig. column. This column lists the number of the figure where the item is identified/located. The illustrations are in numerical sequence in sections II and III.

(3) Item column. The item number identifies the item associated with the figure listed in the adjacent Fig. column. This item is also identified by the NSN listed on the same line.

b. Part Number Index. Part numbers in this index are listed by part number in ascending alphmeric sequence.

(1) CAGEC column. This column lists the Commercial and Government Entity Code (CAGEC).

(2) Part number column. This column indicates the part number assigned to the item.

(3) Stock number column. This column lists the National stock number for the associated part number and manufacturer identified in the part number and CAGEC columns to the left.

(4) Fig. column. This column lists the number of the figure where the item is identified/located in sections II and III.

(5) Item column. The item number is that number assigned to the item as it appears in the figure referenced in the adjacent figure number column.

c. Figure add Item Number Index.

(1) Fig. column. This column lists the number of the figure where the item is identified/located in sections II and III.

(2) Item column. The item number is that number assigned to the item as it appears in the figure referenced in the adjacent figure number column

(3) Stock number column. This column lists the National stock number for the item.

(4) CAGEC column. The Commercial and Government Entity Code (CAGEC) is a 5-digit numeric code used to identify the manufacturer, distributor, or Government agency, etc., that supplies the item.

(5) Part number column. Indicates the primary number used by the manufacturer (individual, firm, corporation, or Government activity), which controls the design and characteristics of the item by means of its engineering drawings, specifications, standards, and inspection requirements to identify an item or range of items.

5. SPECIAL INFORMATION

a. Associated Publications. The publications listed below pertain to the Test Set, Insulation AN/GSM-6B and its components:

TM 11-6625-3265-12 Operator's and Unit Maintenance Manual for Test Set, Generator AN/GSM-6B

TM 11-6625-3265-40 Intermediate and General Support Maintenance Manual for Test Set, Generator AN/GSM-6B

b. National Stock Numbers. National stock numbers (NSN'S) that are missing from P source coded items have been applied for and will be added to this TM by future change/revision when they are entered in the Army Master Data File (AMDF). Until the NSN'S are established and published, submit exception requisitions to: Commander, US Army Communications–Electronics Command and Fort Monmouth, ATTN: AMSEL–LC–MM, Fort Monmouth, NJ 07703-5007 for the part required to supporti your equipment.

6. HOW TO LOCATE REPAIR PARTS

a. When National stock number or part number is not known.

(1) First. Using the table of contents, determine the assembly group or subassembly group to which the item belongs. This is necessary since figures are prepared for assembly groups and subassembly groups, and listings are divided into the same groups.

(2) Second. Find the figure covering the assembly group or subassembly group to which the item belongs.

(3) Third. Identify the item on the figure and note the item number.

(4) Fourth. Refer to the Repair Parts Lists for the figure to find the part number for the item number noted on the figure.

(5) Fifth. Refer to the Part Number Index to find the NSN, if assigned.

b. When National stock number or part number is known.

(1) First. Using the index of National stock numbers and part numbers, find the pertinent National stock number or part number. The NSN index is in National item identification number (NIIN) sequence (para 4a(1)). The part numbers in the part number index are listed in ascending alphanumeric sequence (para 4b). Both indexes cross-reference you to the illustration figure and item number of the item you are looking for.

(2) Second. After finding the figure and item number, verify that the item is the one you're looking for, then locate the item number in the repair parts list for the figure.

7. ABBREVIATIONS

Not applicable.

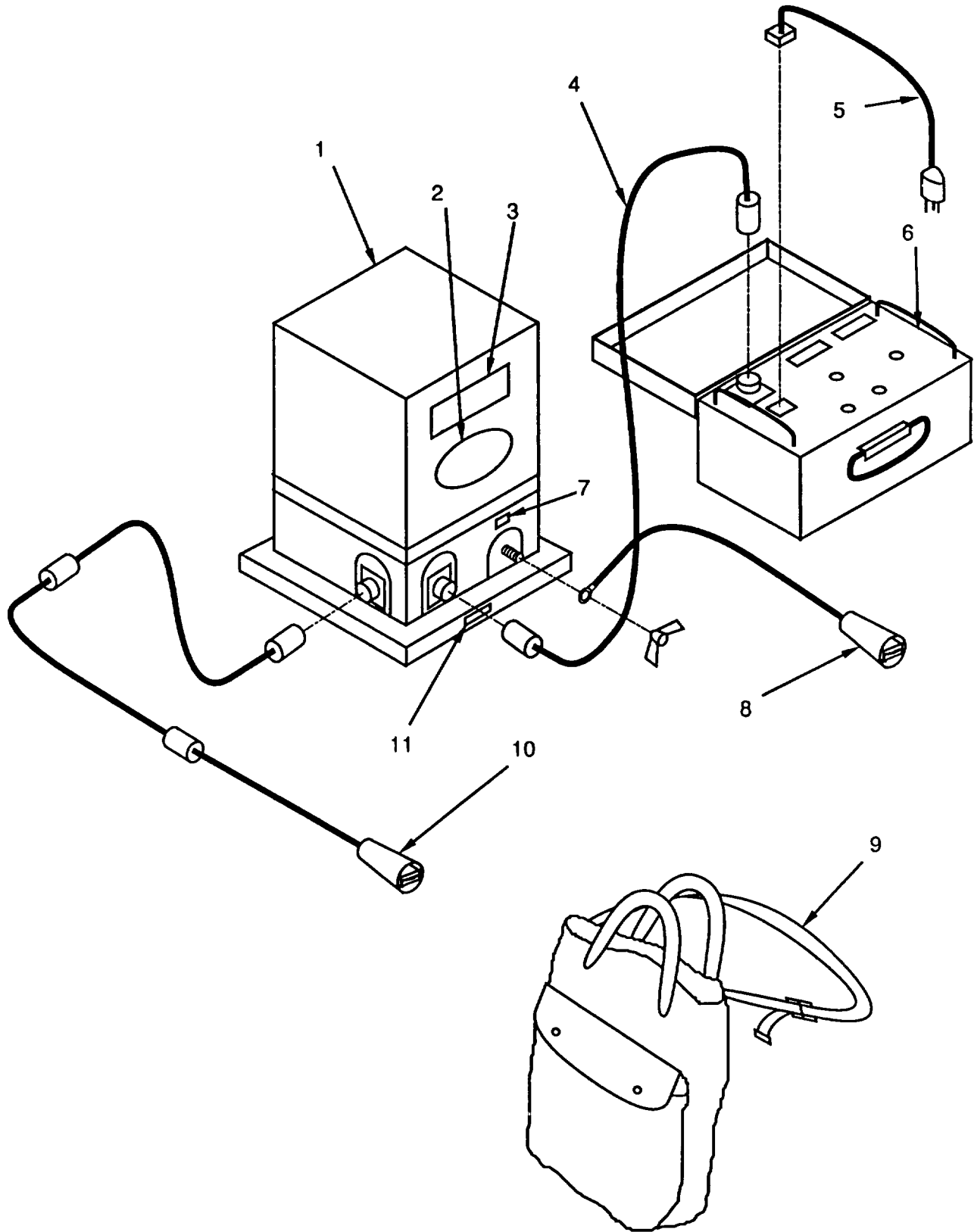

CE2MG001

Figure 1, Test Set, Insulation AN/GSM-6B.

SECTION II

TM11-6625-3265-24P

(1) ITEM NO	(2) SMR CODE	(3) CAGEC	(4) PART NUMBER	(5) DESCRIPTION AND USABLE ON CODES (UOC)	(6) QTY
				GROUP 00 TEST SET, INSULATION AN/GSM-6B	
				FIGURE 1	
1	PBODD	07239	18350	POWER SUPPLY SEE FIGURE 5 FOR PARTS BREAKDOWN	1
2	XBHZZ	07239	1462-6	MARKER, IDENTIFICATI	3
3	XBHZZ	1AA96	46125	PLATE, INSTRUCTION	2
4	XBOHH	07239	18320	CABLE ASSEMBLY, SP, E SEE FIGURE 7 FOR PARTS BREAKDOWN	1
5	PAOZZ	16428	17743	CABLE ASSEMBLY, POWE	1
6	PBOHH	07239	25746-1	CONTROL, INDICATOR SEE FIGURE 2 FOR PARTS BREAKDOWN	1
7	XBHZZ	07239	18024	PLATE, INTRUCTION	1
8	XBOHH	07239	4702-5	CABLE ASSEMBLY, SP, E SEE FIGURE 8 FOR PARTS BREAKDOWN	2
9	PAOZZ	07239	18313	BAG, TEXTILE	1
10	XBOHH	07239	18328	CABLE ASSEMBLY, RADI SEE FIGURE 6 FOR PARTS BREAKDOWN	1
11	XBHZZ	07239	26764	MARKER, IDENTIFICATI	1
				END OF FIGURE	

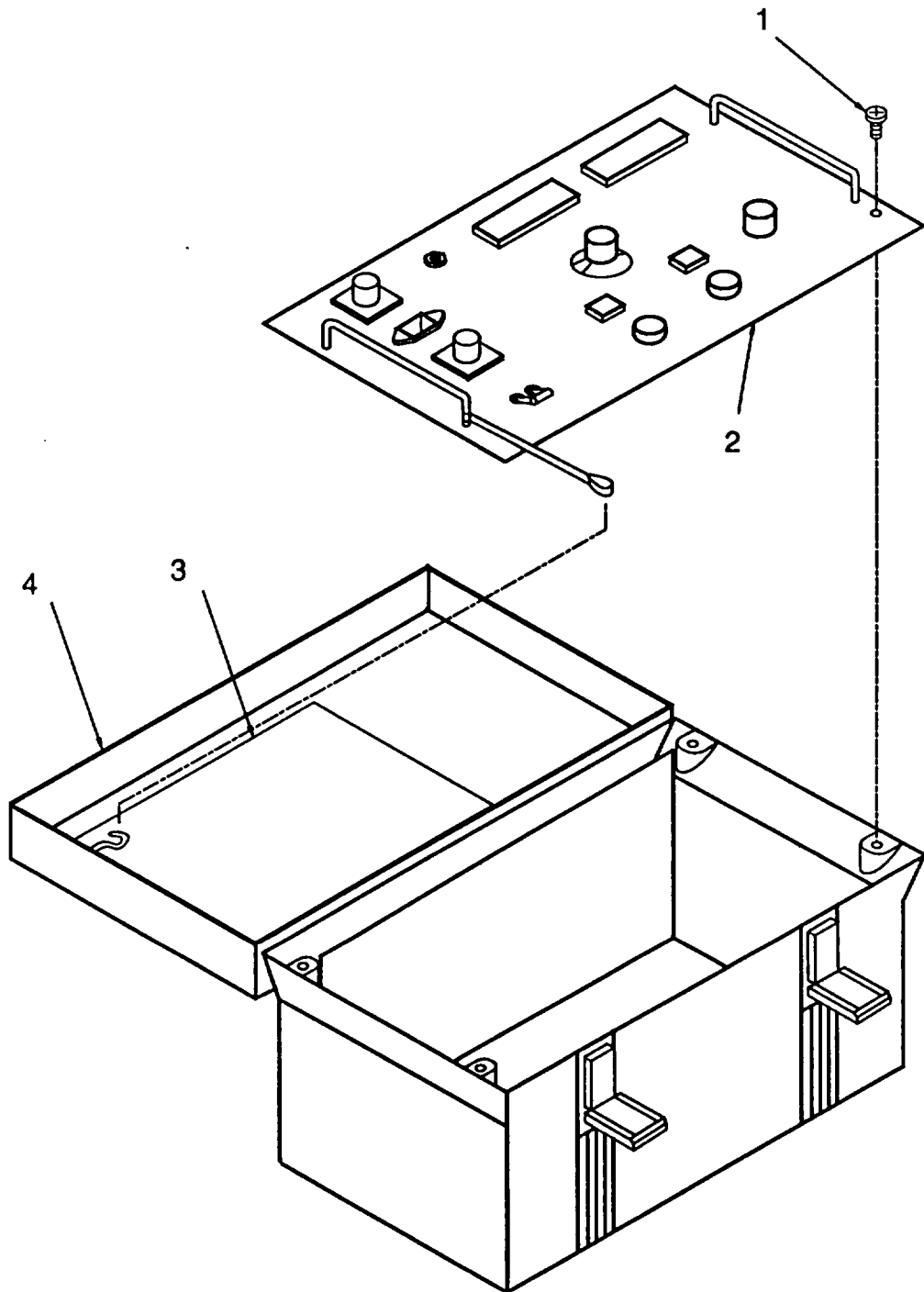

CE2MG002

Figure 2. Control Unit.

SECTION II TM11-6625-3265-24P

(1) ITEM NO	(2) SMR CODE	(3) CAGEC	(4) PART NUMBER	(5) DESCRIPTION AND USABLE ON CODES (UOC)	(6) QTY
				GROUP 01 CONTROL UNIT	
				FIGURE 2	
1	PAHZZ	07239	23303-15	SCREW,MACHINE	4
2	XBHHH	07239	25745-1	CONTROL-INDICATOR SEE FIGURE 3 FOR	1
3	XBHZZ	07239	19253	PARTS BREAKDOWN	1
4	PAHZZ	07239	25743-1	PLATE, INFORMATION CASE, TEST SET	1
				END OF FIGURE	

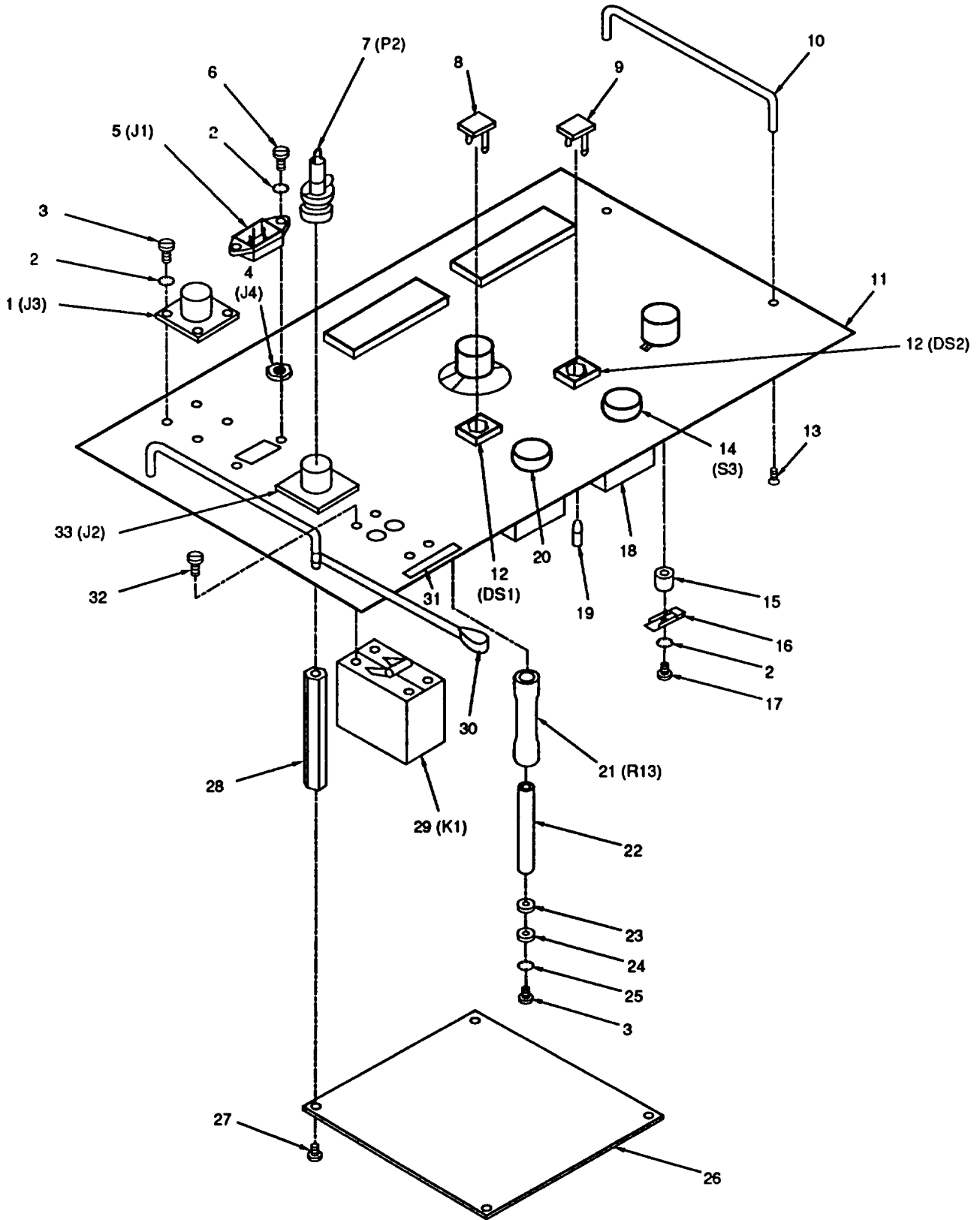

CE2MG003

Figure 3. Panel Assembly (Sheet 1 of 2).

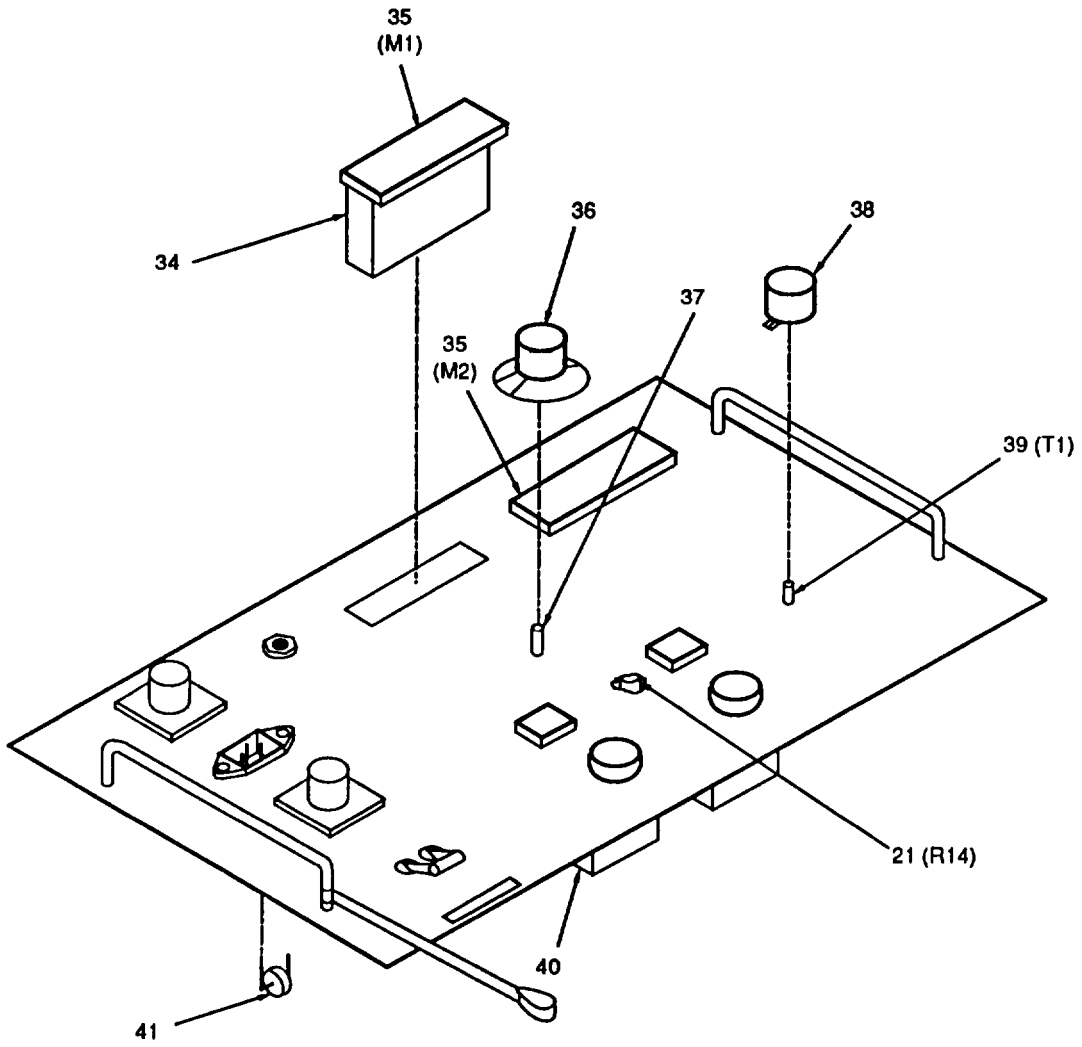

CE2MG010

Figure 3. Panel Assembly (Sheet 2 of 2).

(1) ITEM NO	(2) SMR CODE	(3) CAGEC	(4) PART NUMBER	(5) DESCRIPTION AND USABLE ON CODES (UOC)	(6) QTY
GROUP 0101 PANEL ASSEMBLY					
FIGURE 3					
1	PAHZA	96906	MS3452W18-8S	CONNECTOR, RECEPTACL	1
2	PAHZZ	96906	MS35333-71	WASHER, LOCK	11
3	PAHZZ	96906	MS51957-15	SCREW, MACHINE	10
4	PAHZZ	82389	112A	JACK, TELEPHONE	1
5	PAHZZ	82389	EAC-310	CONNECTOR, RECEPTACL	1
6	PAHZZ	96906	MS51957-30	SCREW, MACHINE	2
7	PAOZZ	07239	10226	DUMMY CONNECTOR, PLY	1
8	PAOZZ	07239	6867-36	LENS, LIGHT	1
9	PAOZZ	07239	6867-19	LENS, LIGHT	1
10	XBHZZ	88245	B-1013-12	HANDLE, BOW	2
11	XBHZZ	07239	25789	PANEL, TEXT, ELECTRIC	1
12	PAHZZ	04009	83501	PUSH BUTTON	2
13	PAHZZ	96906	MS51959-63	SCREW, MACHINE	4
14	PAHZZ	60969	CR2940UA200C	PUSH BUTTON	1
15	PAHZZ	58474	C210492-G2	ADAPTER, STRAIGHT	1
16	PAHZZ	07239	23202	CONTACT, ELECTRICAL	1
17	PAHZZ	96906	MS51957-17	SCREW, MACHINE	1
18	XBHZZ	24446	CR2940U301A	BLOCK, CONTACT, PUSH	1
19	PAOZZ	08806	334	LAMP, INCANDESCENT	2
20	PAHZZ	08805	CR2940UA200F	PUSH BUTTON	1
21	PAHZZ	07239	4500-91	RESISTOR, FIXED, WIRE	2
22	PAHZZ	04729	P2928-M04-F16-44 0	POST, ELECTRICAL-MEC	2
23	PAHZZ	07239	6023-2	WASHER, FLAT	2
24	PAHZZ	96906	MS15795-808	WASHER, FLAT	2
25	PAHZZ	96906	MS35333-73	WASHER, LOCK	2
26	PAHHH	07239	18348	CIRCUIT CARD ASSEMB DOR PARTS BREAKDOWN	1
27	PAHZZ	96906	MS51957-63	SCREW, MACHINE	4
28	PAHZZ	91967	8472	POST, ELECTRICAL-MEC	4
29	PAHZZ	77342	W68X2Q1-0-5	CIRCUIT BREAKER	1
30	XBHZZ	07239	26125	STRAP, WEBBING	1
31	XBHZZ	07239	26764	MARKER, IDENTIFICATI	1
32	PAHZZ	96906	MS51957-27	SCREW, MACHINE	5
33	PAHZA	96906	MS3452W16-10S	CONNECTOR, RECEPTACL	1
34	PAHZZ	81349	M21097/21-091	CONNECTOR, RECEPTACL	2
35	PAHZZ	32873	215-3-JB06	INDICATOR, DIGITAL D	2
36	PAOZZ	21604	PS-95-TS-2	DIAL, CONTROL	1
37	PAHZZ	95542	146-030-0006	SWITCH, ROTARY	1
38	PAOZZ	07239	4690-25	KNOB	1
39	PAHZZ	79500	331C239H01	TRANSFORMER, POWER A	A
40	XBHZZ	02295	CR2940U301A	BLOCK CONTACT	1
41	PAHZZ	71482	CG-90L	ARRESTER, LIGHTNING	1

END OF FIGURE

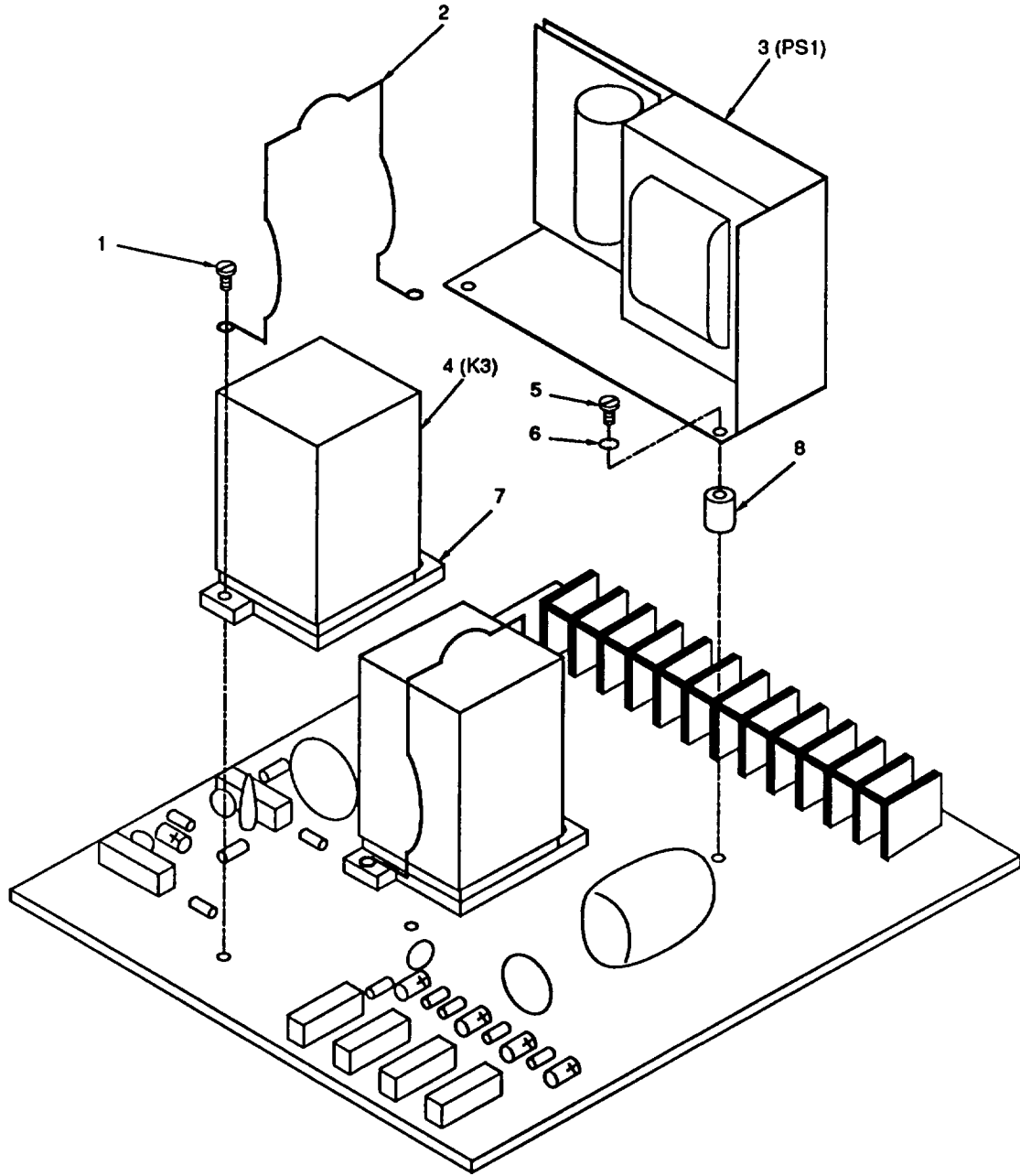

CE2MG004

Figure 4. Circuit Card (Sheet 1 of 2).

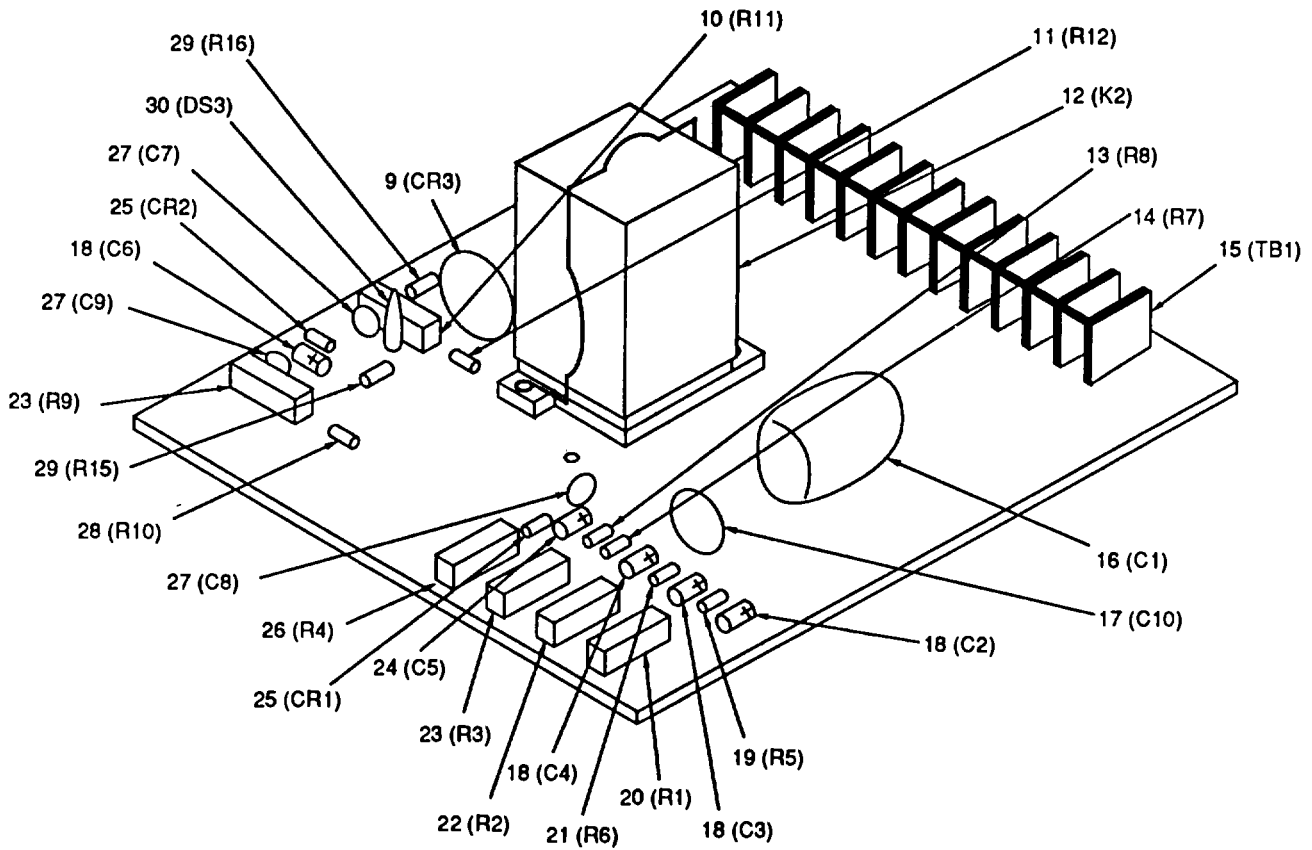

CE2MG011

Figure 4. Circuit Card (Sheet 2 of 2).

(1) ITEM NO	(2) SMR CODE	(3) CAGEC	(4) PART NUMBER	(5) DESCRIPTION AND USABLE ON CODES (UOC)	(6) QTY
GROUP 010101 CIRCUIT CARD					
FIGURE 4					
1	PAHZZ	96906	MS51957-28	SCREW, MACHINE	4
2	PAHZZ	07239	18303-4	RETAINER, SOCKET, PLU	2
3	PAHZZ	53279	XIX7-5	POWER SUPPLY	1
4	PAHZZ	07239	18302	RELAY, ELECTROMAGNET	1
5	PAHZZ	96906	MS51957-47	SCREW, MACHINE	2
6	PAHZZ	96906	MS35333-72	WASHER, LOCK	2
7	PAHZZ	78290	36579	SOCKET, PLUG-IN, ELEC	2
8	PAHZZ	07239	18521-1	SPACER, SLEEVE	2
9	PAHZZ	03508	VP150A20	RESISTOR, VOLTAGE SE	1
10	PAHZZ	80294	3006P-1-104	RESISTOR, VARIABLE, N	1
11	PAHZZ	81349	RNC60K4991FS	RESISTOR, FIXED, FILM	1
12	PAHZZ	55840	D5PR3A	RELAY, ELECTROMAGNET	1
13	PAHZZ	81349	RNC60K9532FS	RESISTOR, FIXED, FILM	1
14	PAHZZ	81349	RNC60K1052FS	RESISTOR, FIXED, FILM	1
15	PAHZZ	53337	6PCV-12	TERMINAL BOARD	1
16	PAHZZ	00724	11-00593-111	CAPACITOR, FIXED, MET	1
17	PAHZZ	60705	36C218	CAPACITOR, FIXED, CER	1
18	PAHZZ	81349	M39003/01-2991	CAPACITOR, FIXED, ELE	4
19	PAHZZ	81349	RNC60K90R9FS	RESISTOR, FIXED, FILM	1
20	PAHZZ	80294	3006P-1-200	RESISTOR, VARIABLE, N	1
21	PAHZZ	81349	RNC60K9530FS	RESISTOR, FIXED, FILM	1
22	PAHZZ	80294	3006P-1-101	RESISTOR, VARIABLE, N	1
23	PAHZZ	28480	2100-3154	RESISTOR, VARIABLE, N	2
24	PAHZZ	81349	M39003/01-8204	CAPACITOR, FIXED, ELE	1
25	PAHZZ	24444	P6KE12C	SEMICONDUCTOR DEVIC	2
26	PAHZZ	80294	3006P-1-103	RESISTOR, VARIABLE, N	1
27	PAHZZ	07239	9865-1	CAPACITOR, FIXED, FILM	1
28	PAHZZ	81349	RNC60K5491FS	RESISTOR, FIXED, FILM	1
29	PAHZZ	81349	RCR20G201JS	RESISTOR, FIXED, COMP	2
30	PAHZZ	80204	A9A	LAMP, GLOW	1

END OF FIGURE

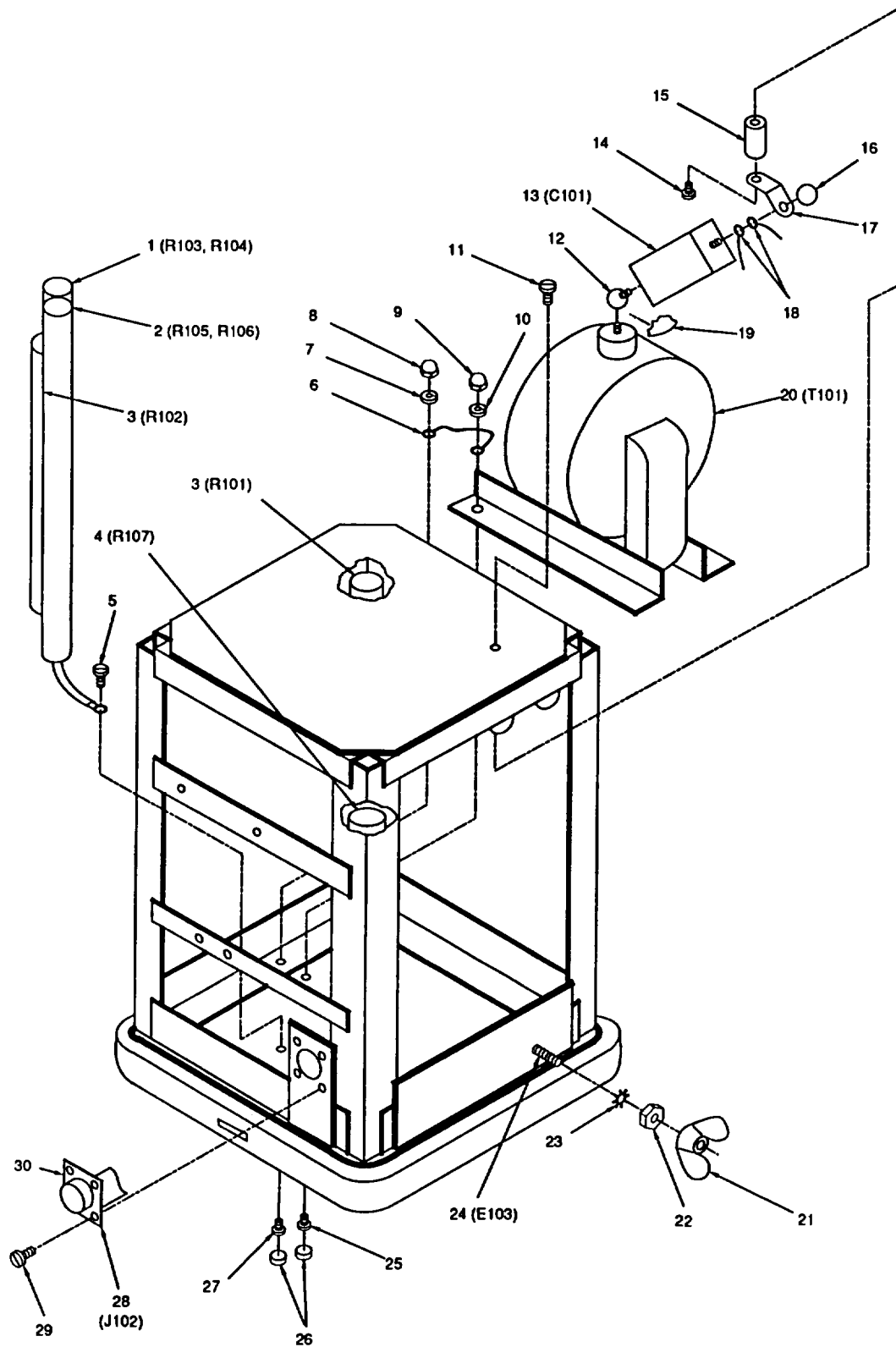

CE2MG005

Figure 5. High Voltage Unit (Sheet 1 of 4).

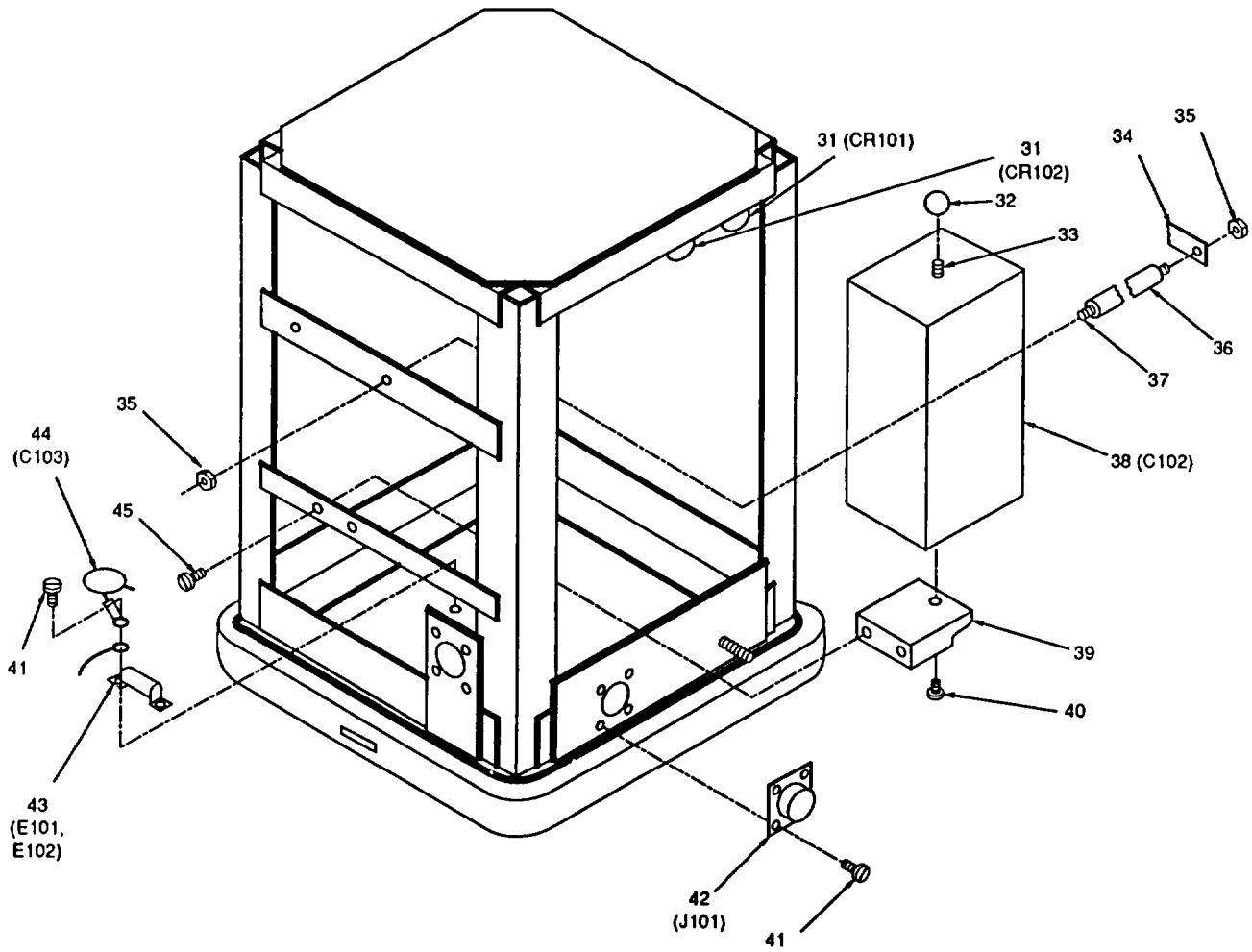

CE2MG006

Figure 5. High Voltage Unit (Sheet 2 of 4).

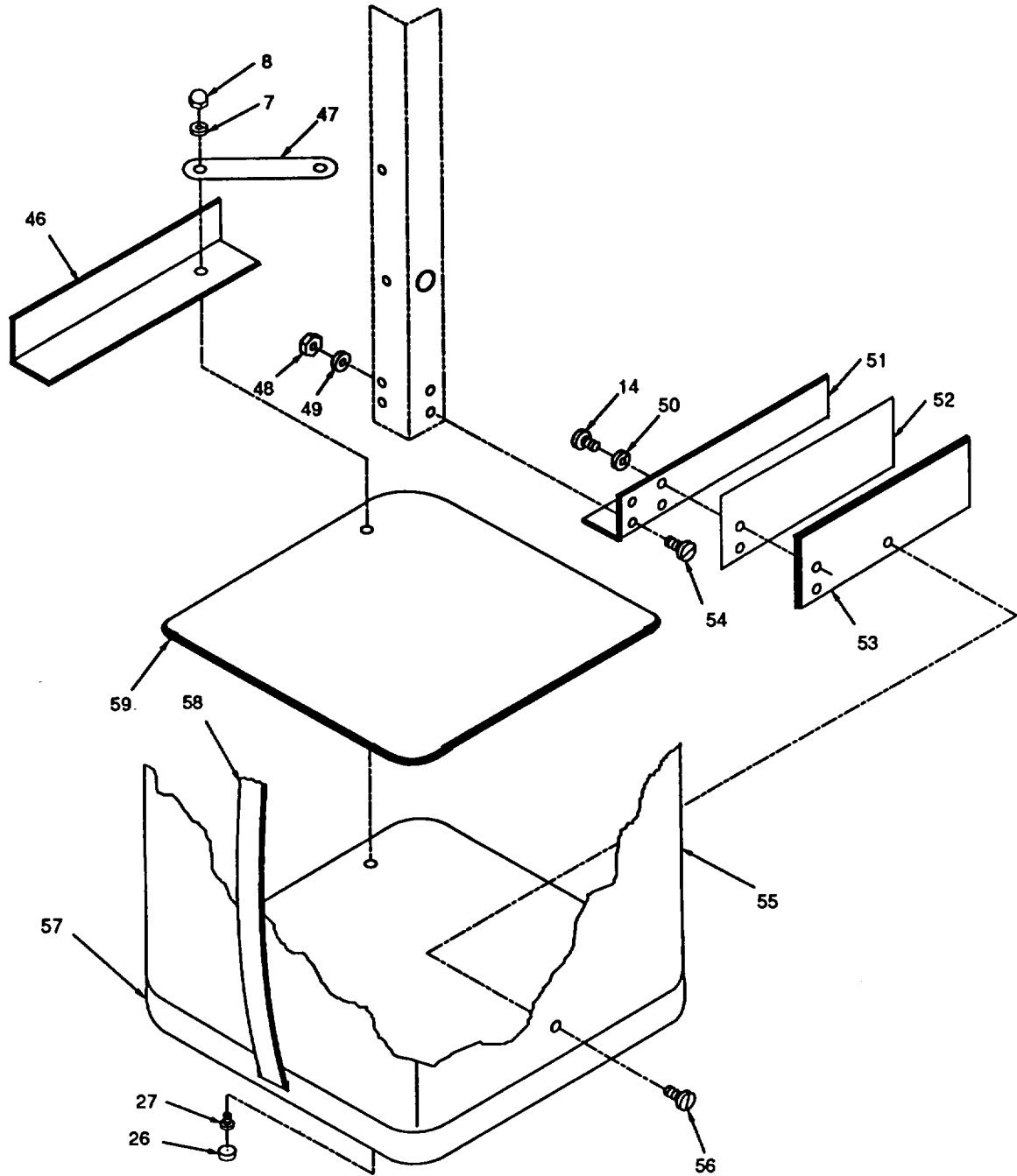

CE2MG012

Figure 5. High Voltage Unit (Sheet 3 of 4).

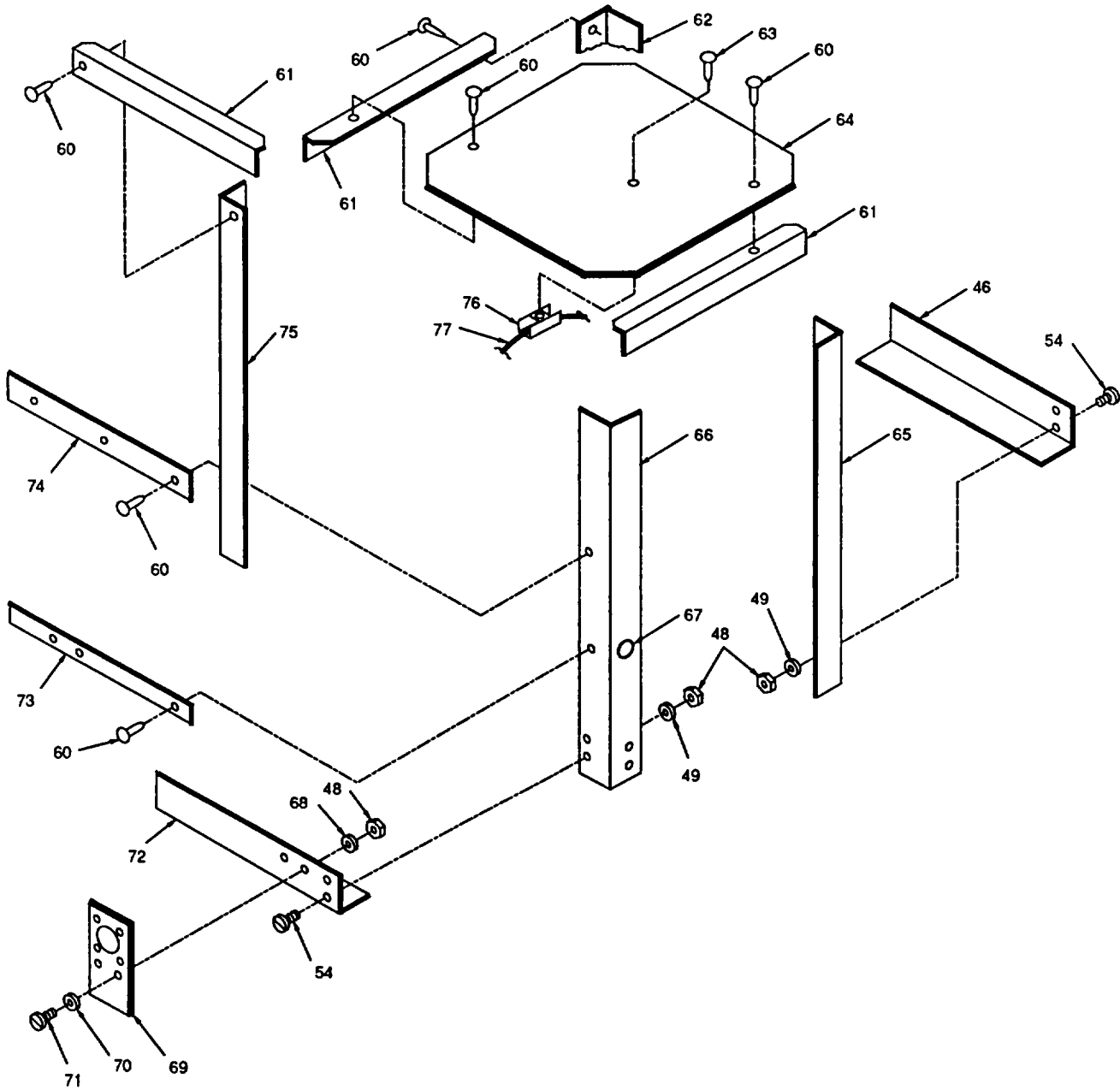

CE2MG013

Figure 5. High Voltage Unit (Sheet 4 of 4).

(1) ITEM NO	(2) SMR CODE	(3) CAGEC	(4) PART NUMBER	(5) DESCRIPTION AND USABLE ON CODES (UOC)	(6) QTY
GROUP 02 HIGH VOLTAGE UNIT					
FIGURE 5					
1	PADZZ	07239	18540-2	RESISTOR, FIXED, COMP	1
2	PADZZ	07239	18540-1	RESISTOR, FIXED, COMP	1
3	PADZZ	07239	18541-1	RESISTOR, FIXED, COMP	2
4	PADZZ	07239	18542	RESISTOR, FIXED, COMP	1
5	PADZZ	96906	MS51957-26	SCREW, MACHINE	1
6	PADZZ	00779	31891	TERMINAL, LUG	2
7	PADZZ	96906	MS35338-138	WASHER, LOCK	1
8	PADZZ	07239	1361-6	NUT, PLAIN, CAP	12
9	PADZZ	64959	101722	NUT, PLAIN, CAP	4
10	PADZZ	96906	MS35338-139	WASHER, LOCK	4
11	PADZZ	82152	APS18-111-63	SCREW, MACHINE	1
12	PADZZ	07239	18571	CORONA BALL	1
13	PADZZ	07239	18307-1	CAPACITOR, FIXED, PLA	1
14	PADZZ	65664	FHNY-016	SCREW, MACHINE	9
15	XBDZZ	07239	15319-5	POST, ELECTRICAL-MEC	1
16	PADZZ	07239	18546-1	CORONA BALL	1
17	XBDZZ	07239	18548	RETAINER, CAPACITOR	1
18	PADZZ	07239	29596-3	CABLE ASSEMBLY, SPEC	2
19	PADZZ	07239	18566	BOOT, DUST AND MOIST	1
20	PADZZ	07239	18352	TRANSFORMER, POWER	1
21	PAOZZ	07239	5026	NUT, PLAIN, WING	1
22	PAOZZ	07239	9091	NUT, PLAIN, HEXAGON	1
23	PAOZZ	96906	MS35338-140	WASHER, LOCK	1
24	PAOZZ	80064	533944PC114	STUD, CONTINUOUS THR	1
25	PADZZ	96906	MS51957-83	SCREW, MACHINE	4
26	PAOZZ	07239	18567	CAP, SNAP ON	12
27	PADZZ	96906	MS51957-66	SCREW, MACHINE	1
28	PADZZ	96906	MS3105-20	DUMMY CONNECTOR, REC	1
29	PADZZ	96906	MS51957-19	SCREW, MACHINE	4
30	PADZZ	07239	18671	CONNECTOR BODY, RECE	1
31	PADZZ	07239	18572	RECTIFIER, METALLIC	2
32	PADZZ	07239	18570-1	CORONA BALL	1
33	PADZZ	24446	7133855P121	STUD, CONTINUOUS THR	3
34	XBDZZ	07239	18026	STRAP, RETAINING	1
35	PADZZ	13764	0425020HNXM02	NUT, PLAIN, HEXAGON	4
36	XBDZZ	07239	23255	SPACER, SLEEVE	2
37	XBDZZ	07239	23256	STUD, CONTINUOUS THR	2
38	PADZZ	07239	18307-2	CAPACITOR, FIXED, PLA	1
39	XBDZZ	07239	18343-1	RETAINER, CAPACITOR	1
40	PADZZ	96906	MS35214-69	SCREW, MACHINE	1
41	PADZZ	96906	MS51957-15	SCREW, MACHINE	4
42	PADZA	96906	MS3452W18-8S	CONNECTOR, RECEPTAC	1
43	PADZZ	25088	S8-C90	ARRESTER, ELECTRICAL	2
44	PADZZ	07239	9865-1	CAPACITOR, FIXED, CER	1
45	PADZZ	96906	MS18212-81	SCREW, STRUCTURAL	2
46	XBDZZ	07239	29591	ANGLE, STRUCTURAL	2
47	XBDZZ	07239	18549	STRAP, RETAINING	3

SECTION II

TM11-6625-3265-24P

(1) ITEM NO	(2) SMR CODE	(3) CAGEC	(4) PART NUMBER	(5) DESCRIPTION AND USABLE ON CODES (UOC)	(6) QTY
48	PADZZ	96906	MS17830-06C	NUT, SELF-LOCKING, HE	16
49	PADZO	96906	MS15795-806	WASHER, FLAT	16
50	PAHZZ	96906	MS35333-73	WASHER, LOCK	4
51	XBDZZ	07239	29580-2	ANGLE, STRUCTURAL	1
52	XBDZZ	07239	18330	INSULATOR, PLATE	1
53	XBDZZ	07239	18326	PLATE, MOUNTING	1
54	PADZZ	96906	MS51957-31	SCREW, MACHINE	16
55	XBDZZ	07239	18345	COVER, ELECTRICAL-EL	1
56	PADZZ	96906	MS51957-82	SCREW, MACHINE	4
57	XBDZZ	07239	18346	BASE, CHASSIS	1
58	XBDZZ	07239	19021	SLING, BAG AND CASE	1
59	XBDZZ	07239	18336	PLATE, MOUNTING	1
60	PADZZ	02768	201-161341-01-01 01	RIVET, SPLIT	20
61	XBDZZ	07239	18332-1	ANGLE, STRUCTURAL	4
62	XBDZZ	07239	18334-1	INSULATOR, ANGLE BRA	1
63	PADZZ	02768	201-121541-00-01 01	RIVET, SPLIT	4
64	XBDZZ	07239	18335	PLATE, MOUNTING	1
65	XBDZZ	07239	18334-2	INSULATOR, ANGLE BRA	1
66	XBDZZ	07239	18334-3	INSULATOR, ANGLE BRA	1
67	PADZZ	06383	PBMS-H25	MOUNTING BASE, TIEDO	6
68	PADZO	96906	MS15795-806	WASHER, FLAT	2
69	XBDZZ	07239	18069	PLATE, MOUNTING	1
70	PADZZ	96906	MS15795-805	WASHER, FLAT	2
71	PADZZ	96906	MS51957-30	SCREW, MACHINE	2
72	XBDZZ	07239	29591-1	ANGLE, STRUCTURAL	1
73	XBDZZ	07239	18329-1	INSULATOR, ANGLE BRA	1
74	XBDZZ	07239	18028-1	RETAINER, CAPACITOR	1
75	XBDZZ	07239	18334-4	INSULATOR, ANGLE, TIEDO	4
76	PADZZ	06383	TMEH-S10-0	MOUNTING BASE, TIEDO	4
77	PADZZ	06383	PLT3S	STRAP, TIEDOWN, ELECT	11

END OF FIGURE

tm 11-6625-3265-24P

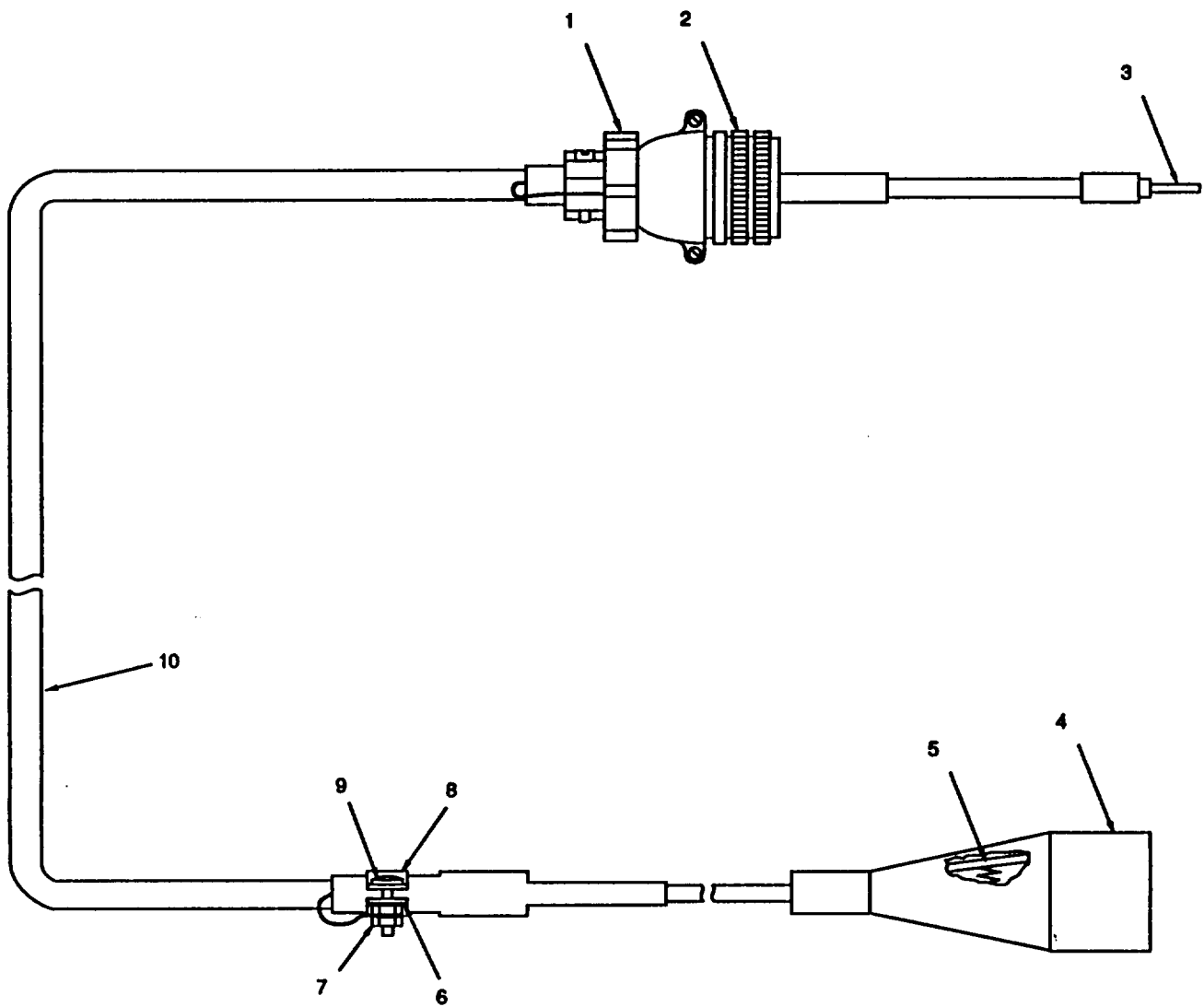

CE2MG007

Figure 6. HV CABLE Assembly

SECTION II

TM11-6625-3265-24P

(1) ITEM NO	(2) SMR CODE	(3) CAGEC	(4) PART NUMBER	(5) DESCRIPTION AND USABLE ON CODES (UOC)	(6) QTY
GROUP 03 HV CABLE ASSEMBLY					
FIGURE 6					
1	PAHZZ	81349	M85049/41-12A	CLAMP,CABLE,ELECTRI	1
2	PAHZZ	96906	MS3456W20-15P	CONNECTOR,PLUG,ELEC	1
3	PAHZZ	77569	815	PLUG,TIP	1
4	PAHZZ	76545	23	CABLE NIPPLE,ELECTR	1
5	PAHZZ	17866	R716	CLIP	1
6	PAHZZ	96906	MS35335-32	WASHER, LOCK	1
7	PAHZZ	96906	MS35649-202	NUT, PLAIN, HEXAGON	2
8	PAHZZ	84971	TA/731SS8	CLAMP, LOOP	1
9	PAHZZ	96906	MS51957-65	SCREW, MACHINE	1
10	XBHZZ	07239	8914	CABLE,RADIO FREQUEN	16
END OF FIGURE					

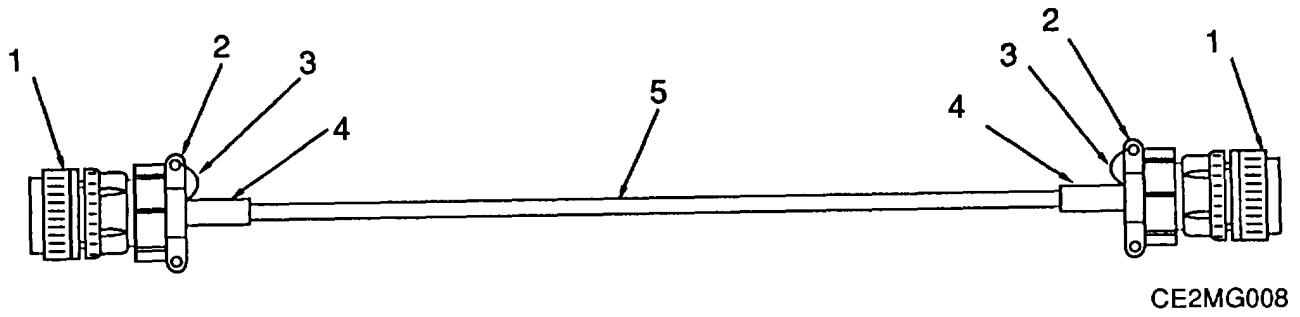

Figure 7. Interconnection Cable

SECTION II

TM11-6625-3265-24P

(1) ITEM NO	(2) SMR CODE	(3) CAGEC	(4) PART NUMBER	(5) DESCRIPTION AND USABLE ON CODES (UOC)	(6) QTY
				GROUP 04 INTERCONNECTION CABLE	
				FIGURE 7	
1	PAHZZ	96906	MS3456W18-8P	CONNECTOR, PLUG, ELEC	2
2	PAHZZ	81349	M85049/41-10A	CLAMP, CABLE, ELECTRI	2
3	PAHZZ	07239	3533-7	WIRE, ELECTRICAL	28
4	XDHZZ	92194	FIT-300-3/8	INSULATION SLEEVING	4
5	XBHZZ	92194	3405	CABLE, SPECIAL PURPO	15

END OF FIGURE

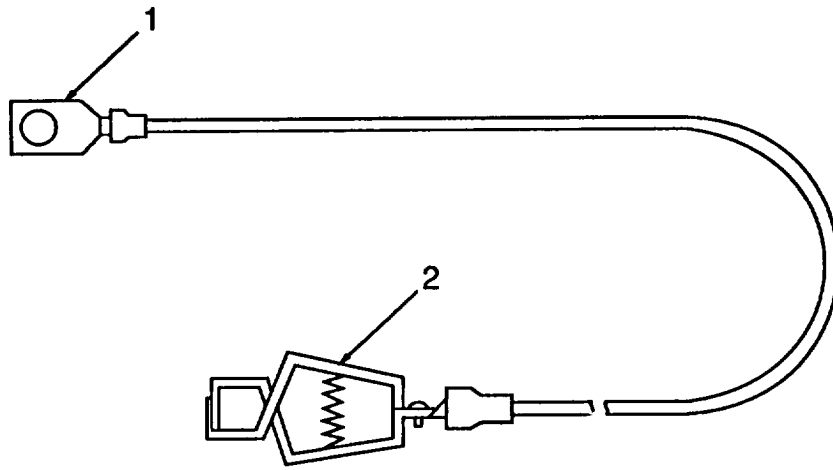

CE2MG009

Figure 8. Ground Cable

SECTION II

TM11-6625-3265-24P

(1) ITEM NO	(2) SMR CODE	(3) CAGEC	(4) PART NUMBER	(5) DESCRIPTION AND USABLE ON CODES (UOC)	(6) QTY
				GROUP 05 GROUND CABLE	
				FIGURE 8	
1	PAHZZ	59730	54131SP	TERMINAL,LUG	1
2	PAHZZ	78801	38066	CLAMP,ELECTRICAL	1
				END OF FIGURE	

CROSS-REFERENCE INDEXES

NATIONAL STOCK NUMBER INDEX

STOCK NUMBER	FIG.	ITEM	STOCK NUMBER	FIG.	ITEM
5920-00-003-9812	3	41	5307-00-720-8308	5	33
5905-00-006-6986	4	28	5910-00-722-3049	4	17
5910-00-007-3974	4	18	5310-00-722-5998	5	70
5305-00-050-9229	3	27	5307-00-853-2391	5	24
5305-00-050-9231	6	9	5310-00-880-5976	5	49
5305-00-050-9232	5	27		5	68
5305-00-054-5649	3	3	5975-00-902-5935	6	4
	5	41	5310-00-933-8120	5	7
5305-00-054-5651	3	17	5310-00-933-8121	5	10
5305-00-054-5653	5	29	5310-00-934-9758	6	7
5305-00-054-6650	5	5	5310-00-974-6623	5	23
5305-00-054-6651	3	32	5935-00-990-6295	5	28
5305-00-054-6652	4	1	5305-01-010-2312	5	11
5305-00-054-6654	3	6	5935-01-018-4286	3	34
	5	71	5930-01-024-6600	3	12
5305-00-054-6655	5	54	5940-01-035-8776	8	1
5305-00-054-6672	4	5	5935-01-089-0663	6	2
5305-00-071-1317	5	56	5935-01-096-8847	3	5
5305-00-071-1318	5	25	5305-01-102-2665	5	45
5930-00-079-9901	3	37	5945-01-105-9837	4	12
5905-00-107-4881	4	23	5975-01-111-0130	5	67
5905-00-141-0727	4	29	6150-01-111-1717	1	5
5940-00-143-4771	5	6	5935-01-160-1788	3	33
6145-00-160-4775	7	3	5935-01-167-6148	6	1
5310-00-176-6341	5	48	5910-01-182-8166	4	16
5310-00-187-4258	5	9	5935-01-201-9223	7	2
5999-00-230-1195	6	5	5340-01-203-8529	6	8
5905-00-243-1778	4	26	5935-01-228-1621	3	1
5905-00-261-6518	4	19		5	42
6240-00-295-1617	3	19	5920-01-250-3473	5	43
5905-00-317-8960	4	13	5935-01-251-3213	7	1
5905-00-320-6544	4	14	5910-01-258-4620	4	24
5905-00-359-5434	4	22	5975-01-265-6900	5	77
5905-00-375-1051	4	10	5305-01-276-8593	5	14
5905-00-396-2989	4	20	5975-01-285-0284	5	76
5905-00-451-7532	4	11	5355-01-296-3354	3	38
5935-00-481-7326	3	4	5340-01-297-8889	3	28
5905-00-524-5794	4	9	6130-01-355-7418	1	1
5905-00-528-8858	4	21	5310-01-362-6784	5	35
5310-00-543-2739	4	6	5905-01-362-6965	5	3
5310-00-543-5933	3	25	5905-01-362-6967	5	4
	5	50	5365-01-362-7280	4	8
6240-00-577-8456	4	30	5340-01-362-7298	5	63
5310-00-595-6772	3	24	5340-01-362-7299	5	60
5310-00-596-7691	6	6	5930-01-362-7959	3	20
5930-00-611-3277	3	14	5945-01-362-9696	4	4
5310-00-616-3555	3	2	5305-01-362-9904	2	1
5305-00-637-1119	5	40	5905-01-363-1044	3	21
5950-00-688-2881	3	39	5999-01-363-1048	8	2
5305-00-701-5074	3	13	5961-01-363-1087	4	25

CROSS-REFERENCE INDEXES

NATIONAL STOCK NUMBER INDEX

STOCK NUMBER	FIG.	ITEM	STOCK NUMBER	FIG.	ITEM
5999-01-363-1092	3	16			
5850-01-363-1427	3	9			
5850-01-363-1428	3	8			
5910-01-363-2061	4	27			
	5	44			
6150-01-363-2159	5	18			
6625-01-363-2429	1	6			
5310-01-363-3236	5	8			
5310-01-363-3237	5	21			
5925-01-363-3242	3	29			
5950-01-363-3354	5	20			
6625-01-363-3420	3	35			
5998-01-363-3483	3	26			
5935-01-363-4578	6	3			
6130-01-363-4743	4	3			
5310-01-363-4928	5	22			
5310-01-363-4929	3	23			
5935-01-363-6256	4	2			
5910-01-363-6274	5	13			
5910-01-363-6275	5	38			
5935-01-363-6310	3	7			
5920-01-363-7411	5	12			
5920-01-363-7412	5	16			
5905-01-363-7570	5	2			
5905-01-363-7571	5	1			
5340-01-363-7635	3	22			
5355-01-363-8231	3	36			
6130-01-363-8393	5	31			
6625-01-363-8583	5	30			
5325-01-363-9162	5	26			
6625-01-363-9454	2	4			
5920-01-364-1234	5	32			
5935-01-364-3610	4	7			
5940-01-364-6910	4	15			
5970-01-365-1377	5	19			
8105-01-365-3084	1	9			
5975-01-367-6547	3	15			

CROSS-REFERENCE INDEXES

CAGEC	PART NUMBER	PART NUMBER INDEX STOCK NUMBER	FIG.	ITEM
82152	APS18-111-63	5305-01-010-2312	5	11
80204	A9A	6240-00-577-8456	4	30
88245	B-1013-12		3	10
71482	CG-90L	5920-00-003-9812	3	41
60969	CR2940UA200C	5930-00-611-3277	3	14
08805	CR2940UA200F	5930-01-362-7959	3	20
24446	CR2940U301A		3	18
02295	CR2940U310A		3	40
58474	C210492-G2	5975-01-367-6547	3	15
55840	D5PR3A	5945-01-105-9837	4	12
82389	EAC-310	5935-01-096-8847	3	5
65664	FHNY-016	5305-01-276-8593	5	14
92194	FIT-300-3/8		7	4
96906	MS15795-805	5310-00-722-5998	5	70
96906	MS15795-806	5310-00-880-5976	5	49
			5	68
96906	MS15795-808	5310-00-595-6772	3	24
96906	MS17830-06C	5310-00-176-6341	5	48
96906	MS18212-81	5305-01-102-2665	5	5
96906	MS3105-20	5935-00-990-6295	5	28
96906	MS3452W16-10S	5935-01-160-1788	3	33
96906	MS3452W18-8S	5935-01-228-1621	3	1
			5	42
96906	MS3456W18-8P	5935-01-251-3213	7	1
96906	MS3456W20-15P	5935-01-089-0663	6	2
96906	MS35214-69	5305-00-637-1119	5	40
96906	MS35333-71	5310-00-616-3555	3	2
96906	MS35333-72	5310-00-543-2739	4	6
96906	MS35333-73	5310-00-543-5933	3	25
			5	50
96906	MS35335-32	5310-00-596-7691	6	6
96906	MS35338-138	5310-00-933-8120	5	7
96906	MS35338-139	5310-00-933-8121	5	10
96906	MS35338-140	5310-00-974-6623	5	23
96906	MS35649-202	5310-00-934-9758	6	7
96906	MS51957-15	5305-00-054-5649	3	3
			5	41
96906	MS51957-17	5305-00-054-5651	3	17
96906	MS51957-19	5305-00-054-5653	5	29
96906	MS51957-26	5305-00-054-6650	5	
96906	MS51957-27	5305-00-054-6651	3	32
96906	MS51957-28	5305-00-054-6652	4	1
96906	MS51957-30	5305-00-054-6654	3	6
			5	71
96906	MS51957-31	5305-00-054-6655	5	54
96906	MS51957-47	5305-00-054-6672	4	5
96906	MS51957-63	5305-00-050-9229	3	27
96906	MS51957-65	5305-00-050-9231	6	9
96906	MS51957-66	5305-00-050-9232	5	27
96906	MS51957-82	5305-00-071-1317	5	56
96906	MS51957-83	5305-00-071-1318	5	25

CROSS-REFERENCE INDEXES

CAGEC	PART NUMBER	PART NUMBER INDEX STOCK NUMBER	FIG.	ITEM
96906	MS51959-63	5305-00-701-5074	3	13
81349	M21097/21-091	5935-01-018-4286	3	34
81349	M39003/01-2991	5910-00-007-3974	4	18
81349	M39003/01-8204	5910-01-258-4620	4	24
81349	M85049/41-10A	5935-01-201-9223	7	2
81349	M85049/41-12A	5935-01-167-6148	6	1
06383	PBMS-H25	5975-01-111-0130	5	67
06383	PLT3S	5975-01-265-6900	5	77
21604	PS-95-TS-2	5355-01-363-8231	3	36
04729	P2928-M04-F16-44 0	5340-01-363-7635	3	22
24444	P6KE12C	5961-01-363-1087	4	25
81349	RCR20G201JS	5905-00-141-0727	4	29
81349	RNC60K1052FS	5905-00-320-6544	4	14
81349	RNC60K4991FS	5905-00-451-7532	4	11
81349	RNC60K5491FS	5905-00-006-6986	4	28
81349	RNC60K90R9FS	5905-00-261-6518	4	19
81349	RNC60K9530FS	5905-00-528-8858	4	21
81349	RNC60K9532FS	5905-00-317-8960	4	13
17866	R716	5999-00-230-1195	6	5
25088	S8-C90	5920-01-250-3473	5	43
84971	TA731SS8	5340-01-203-8529	6	8
06383	TMEH-S10-0	5975-01-285-0284	5	76
03508	VP150A20	5905-00-524-5794	4	9
77342	W68X2Q1-0-5	5925-01-363-3242	3	29
53279	XIX7-5	6130-01-363-4743	4	3
13764	0425020HNXM02	5310-01-362-6784	5	35
64959	101722	5310-00-187-4258	5	9
07239	10226	5935-01-363-6310	3	7
00724	11-00593-111	5910-01-182-8166	4	16
82389	112A	5935-00-481-7326	3	4
07239	1361-6	5310-01-363-3236	5	8
95542	146-030-0006	5930-00-079-9901	3	37
07239	1462-6		1	2
07239	15319-5		5	15
16428	17743	6150-01-111-1717	1	5
07239	18024		1	7
07239	18026		5	34
07239	18028-1		5	74
07239	18069		5	69
07239	18302	5945-01-362-9696	4	4
07239	18303-4	5935-01-363-6256	4	2
07239	18307-1	5910-01-363-6274	5	13
07239	18307-2	5910-01-363-6275	5	38
07239	18313	8105-01-365-3084	1	9
07239	18320		1	4
07239	18326		5	53
07239	18328		1	10
07239	18329-1		5	73
07239	18330		5	52
07239	18332-1		5	61

CROSS-REFERENCE INDEXES

CAGEC	PART NUMBER	PART NUMBER INDEX STOCK NUMBER	FIG.	ITEM
07239	18334-1		5	62
07239	18334-2		5	65
07239	18334-3		5	66
07239	18334-4		5	75
07239	18335		5	64
07239	18336		5	59
07239	18343-1		5	39
07239	18345		5	55
07239	18346		5	57
07239	18348	5998-01-363-3483	3	26
07239	18350	6130-01-355-7418	1	1
07239	18352	5950-01-363-3354	5	20
07239	18521-1	5365-01-362-7280	4	8
07239	18540-1	5905-01-363-7570	5	2
07239	18540-2	5905-01-363-7571	5	1
07239	18541-1	5905-01-362-6965	5	3
07239	18542	5905-01-362-6967	5	4
07239	18546-1	5920-01-363-7412	5	16
07239	18548		5	17
07239	18549		5	47
07239	18566	5970-01-365-1377	5	19
07239	18567	5325-01-363-9162	5	26
07239	18570-1	5920-01-364-1234	5	32
07239	18571	5920-01-363-7411	5	12
07239	18572	6130-01-363-8393	5	31
07239	18671	6625-01-363-8583	5	30
07239	19021		5	58
07239	19253		2	3
02768	201-121541-00-01 01	5340-01-362-7298	5	63
02768	201-161341-01-01 01	5340-01-362-7299	5	60
28480	2100-3154	5905-00-107-4881	4	23
32873	215-3-JB06	6625-01-363-3420	3	35
76545	23	5975-00-902-5935	6	4
07239	23202	5999-01-363-1092	3	16
07239	23255		5	36
07239	23256		5	37
07239	23303-15	5305-01-362-9904	2	1
07239	25743-1	6625-01-363-9454	2	4
07239	25745-1		2	2
07239	25746-1	6625-01-363-2429	1	6
07239	25789		3	11
07239	26125		3	30
07239	26764		1	11
			3	31
07239	29580-2		5	51
07239	29591		5	46
07239	29591-1		5	72
07239	29596-3	6150-01-363-2159	5	18
80294	3006P-1-101	5905-00-359-5434	4	22

CROSS-REFERENCE INDEXES

CAGEC	PART NUMBER	PART NUMBER INDEX STOCK NUMBER	FIG.	ITEM
80294	3006P-1-103	5905-00-243-1778	4	26
80294	3006P-1-104	5905-00-375-1051	4	10
80294	3006P-1-200	5905-00-396-2989	4	20
00779	31891	5940-00-143-4771	5	6
79500	331C239H01	5950-00-688-2881	3	39
08806	334	6240-00-295-1617	3	19
92194	3405		7	5
07239	3533-7	6145-00-160-4775	7	3
60705	36C218	5910-00-722-3049	4	17
78290	36579	5935-01-364-3610	4	7
78801	38066	5999-01-363-1048	8	2
07239	4500-91	5905-01-363-1044	3	21
1AA96	46125		1	3
07239	4690-25	5355-01-296-3354	3	38
07239	4702-5		1	8
07239	5026	5310-01-363-3237	5	21
80064	533944PC114	5307-00-853-2391	5	24
59730	54131SP	5940-01-035-8776	8	1
53337	6PCV-12	5940-01-364-6910	4	15
07239	6023-2	5310-01-363-4929	3	23
07239	6867-19	5850-01-363-1427	3	9
07239	6867-36	5850-01-363-1428	3	8
24446	7133855P121	5307-00-720-8308	5	33
77569	815	5935-01-363-4578	6	3
04009	83501	5930-01-024-6600	3	12
91967	8472	5340-01-297-8889	3	28
07239	8914		6	10
07239	9091	5310-01-363-4928	5	22
07239	9865-1	5910-01-363-2061	4	27
			5	44

CROSS-REFERENCE INDEXES

FIG.	ITEM	FIGURE AND ITEM NUMBER INDEX		PART NUMBER
		STOCK NUMBER	CAGEC	
1	1	6130-01-355-7418	07239	18350
1	2		07239	1462-6
1	3		1AA96	46125
1	4		07239	18320
1	5	6150-01-111-1717	16428	17743
1	6	6625-01-363-2429	07239	25746-1
1	7		07239	18024
1	8		07239	4702-5
1	9	8105-01-365-3084	07239	18313
1	10		07239	18328
1	11		07239	26764
2	1	5305-01-362-9904	07239	23303-15
2	2		07239	25745-1
2	3		07239	19253
2	4	6625-01-363-9454	07239	25743-1
3	1	5935-01-228-1621	96906	MS3452W18-8S
3	2	5310-00-616-3555	96906	MS35333-71
3	3	5305-00-054-5649	96906	MS51957-15
3	4	5935-00-481-7326	82389	112A
3	5	5935-01-096-8847	82389	EAC-310
3	6	5305-00-054-6654	96906	MS51957-30
3	7	5935-01-363-6310	07239	10226
3	8	5850-01-363-1428	07239	6867-36
3	9	5850-01-363-1427	07239	6867-19
3	10		88245	B-1013-12
3	11		07239	25789
3	12	5930-01-024-6600	04009	83501
3	13	5305-00-701-5074	96906	MS51959-63
3	14	5930-00-611-3277	60669	CR2940UA200C
3	15	5975-01-367-6547	58474	C210492-G2
3	16	5999-01-363-1092	07239	23202
3	17	5305-00-054-5651	96906	MS51957-17
3	18		24446	CR2940U301A
3	19	6240-00-295-1617	08806	334
3	20	5930-01-362-7959	08805	CR2940UA200F
3	21	5905-01-363-1044	07239	4500-91
3	22	5340-01-363-7635	04729	P2928-M04-F16-44
				0
3	23	5310-01-363-4929	07239	6023-2
3	24	5310-00-595-6772	96906	MS15795-808
3	25	5310-00-543-5933	96906	MS35333-73
3	26	5998-01-363-3483	07239	18348
3	27	5305-00-050-9229	96906	MS51957-63
3	28	5340-01-297-8889	91967	8472
3	29	5925-01-363-3242	77342	W68X2Q1-0-5
3	30		07239	26125
3	31		07239	26764
3	32	5305-00-054-6651	96906	MS51957-27
3	33	5935-01-160-1788	96906	MS3452W16-10S
3	34	5935-01-018-4286	81349	M21097/21-091
3	35	6625-01-363-3420	32873	215-3-JB06

CROSS-REFERENCE INDEXES

FIG.	ITEM	FIGURE AND ITEM NUMBER INDEX		PART NUMBER
		STOCK NUMBER	CAGEC	
3	36	5355-01-363-8231	21604	PS-95-TS-2
3	37	5930-00-079-9901	95542	146-030-0006
3	38	5355-01-296-3354	07239	4690-25
3	39	5950-00-688-2881	79500	331C239H01
3	40		02295	CR2940U310A
3	41	5920-00-003-9812	71482	CG-90L
4	1	5305-00-054-6652	96906	MS51957-28
4	2	5935-01-363-6256	07239	18303-4
4	3	6130-01-363-4743	53279	XIX7-5
4	4	5945-01-362-9696	07239	18302
4	5	5305-00-054-6672	96906	MS51957-47
4	6	5310-00-543-2739	96906	MS35333-72
4	7	5935-01-364-3610	78290	36579
4	8	5365-01-362-7280	07239	18521-1
4	9	5905-00-524-5794	03508	VP150A20
4	10	5905-00-375-1051	80294	3006P-1-104
4	11	5905-00-451-7532	81349	RNC60K4991FS
4	12	5945-01-105-9837	55840	D5PR3A
4	13	5905-00-317-8960	81349	RNC60K9532FS
4	14	5905-00-320-6544	81349	RNC60K1052FS
4	15	5940-01-364-6910	53337	6PCV-12
4	16	5910-01-182-8166	00724	11-00593-111
4	17	5910-00-722-3049	60705	36C218
4	18	5910-00-007-3974	81349	M39003/01-2991
4	19	5905-00-261-6518	81349	RNC60K90R9FS
4	20	5905-00-396-2989	80294	3006P-1-200
4	21	5905-00-528-8858	81349	RNC60K9530FS
4	22	5905-00-359-5434	80294	3006P-1-101
4	23	5905-00-107-4881	28480	2100-3154
4	24	5910-01-258-4620	81349	M39003/01-8204
4	25	5961-01-363-1087	24444	P6KE12C
4	26	5905-00-243-1778	80294	3006P-1-103
4	27	5910-01-363-2061	07239	9865-1
4	28	5905-00-006-6986	81349	RNC60K5491FS
4	29	5905-00-141-0727	81349	RRC20G201JS
4	30	6240-00-577-8456	80204	A9A
5	1	5905-01-363-7571	07239	18540-2
5	2	5905-01-363-7570	07239	18540-1
5	3	5905-01-362-6965	07239	18541-1
5	4	5905-01-362-6967	07239	18542
5	5	5305-00-054-6650	96906	MS51957-26
5	6	5940-00-143-4771	00779	31891
5	7	5310-00-933-8120	96906	MS35338-138
5	8	5310-01-363-3236	07239	1361-6
5	9	5310-00-187-4258	64959	101722
5	10	5310-00-933-8121	96906	MS35338-139
5	11	5305-01-010-2312	82152	APS18-111-63
5	12	5920-01-363-7411	07239	18571
5	13	5910-01-363-6274	07239	18307-1
5	14	5305-01-276-8593	65664	FHNY-016
5	15		07239	15319-5

CROSS-REFERENCE INDEXES

FIG.	ITEM	FIGURE AND ITEM NUMBER INDEX		PART NUMBER
		STOCK NUMBER	CAGEC	
5	16	5920-01-363-7412	07239	18546-1
5	17		07239	18548
5	18	6150-01-363-2159	07239	29596-3
5	19	5970-01-365-1377	07239	18566
5	20	5950-01-363-3354	07239	18352
5	21	5310-01-363-3237	07239	5026
5	22	5310-01-363-4928	07239	9091
5	23	5310-00-974-6623	96906	MS35338-140
5	24	5307-00-853-2391	80064	533944PC114
5	25	5305-00-071-1318	96906	MS51957-83
5	26	5325-01-363-9162	07239	18567
5	27	5305-00-050-9232	96906	MS51957-66
5	28	5935-00-990-6295	96906	MS3105-20
5	29	5305-00-054-5653	96906	MS51957-19
5	30	6625-01-363-8583	07239	18671
5	31	6130-01-363-8393	07239	18572
5	32	5920-01-364-1234	07239	18570-1
5	33	5307-00-720-8308	24446	7133855P121
5	34		07239	18026
5	35	5310-01-362-6784	13764	0425020HNXM02
5	36		07239	23255
5	37		07239	23256
5	38	5910-01-363-6275	07239	18307-2
5	39		07239	18343-1
5	40	5305-00-637-1119	96906	MS35214-69
5	41	5305-00-054-5649	96906	MS51957-15
5	42	5935-01-228-1621	96906	MS3452W18-8S
5	43	5920-01-250-3473	25088	S8-C90
5	44	5910-01-363-2061	07239	9865-1
5	45	5305-01-102-2665	96906	MS18212-81
5	46		07239	29591
5	47		07239	18549
5	48	5310-00-176-6341	96906	MS17830-06C
5	49	5310-00-880-5976	96906	MS15795-806
5	50	5310-00-543-5933	96906	MS35333-73
5	51		07239	29580-2
5	52		07239	18330
5	53		07239	18326
5	54	5305-00-054-6655	96906	MS51957-31
5	55		07239	18345
5	56	5305-00-071-1317	96906	MS51957-82
5	57		07239	18346
5	58		07239	19021
5	59		07239	18336
5	60	5340-01-362-7299	02768	201-161341-01-01
5	61		07239	18332-1
5	62		07239	18334-1
5	63	5340-01-362-7298	02768	201-121541-00-01
				01
5	64		07239	18335

CROSS-REFERENCE INDEXES

FIG.	ITEM	FIGURE AND ITEM NUMBER INDEX		PART NUMBER
		STOCK NUMBER	CAGEC	
5	65		07239	18334-2
5	66		07239	18334-3
5	67	5975-01-111-0130	06383	PBMS-H25
5	68	5310-00-880-5976	96906	MS15795-806
5	69		07239	18069
5	70	5310-00-722-5998	96906	MS15795-805
5	71	5305-00-054-6654	996906	MS51957-30
5	72		07239	29591-1
5	73		07239	18329-1
5	74		07239	18028-1
5	75		07239	18334-4
5	76	5975-01-285-0284	06383	TMEH-S10-0
5	77	5975-01-265-6900	06383	PLT3S
6	1	5935-01-167-6148	81349	M85049/41-12A
6	2	5935-01-089-0663	96906	MS3456W20-15P
6	3	5935-01-363-4578	77569	815
6	4	5975-00-902-5935	76545	23
6	5	5999-00-230-1195	17866	R716
6	6	5310-00-596-7691	96906	MS35335-32
6	7	5310-00-934-9758	96906	MS35649-202
6	8	5340-01-203-8529	84971	TA731SS8
6	9	5305-00-050-9231	96906	MS51957-65
6	10		07239	8914
7	1	5935-01-251-3213	96906	MS3456W18-8P
7	2	5935-01-201-9223	81349	M85049/41-10A
7	3	6145-00-160-4775	07239	3533-7
7	4		92194	FIT-300-3/8
7	5		92194	3405
8	1	5940-01-035-8776	59730	54131SP
8	2	5999-01-363-1048	78801	38066

SOMETHING WRONG WITH THIS PUBLICATION



THEN ... JOT DOWN THE DOPE ABOUT IT ON THIS FORM. CAREFULLY TEAR IT OUT. FOLD IT AND DROP IT IN THE MAIL.

FROM: (PRINT YOUR UNIT'S COMPLETE ADDRESS)
 Commander
 Stateside Army Depot
 ATTN: AMSTA-US
 Stateside, N.J. 07703-5007

DATE SENT
 10 July 1975

PUBLICATION NUMBER
 TM 11-5840-340-20P

PUBLICATION DATE
 23 Jan 74

PUBLICATION TITLE
 Radar Set AN/PRC-76

BE EXACT PIN-POINT WHERE IT IS

IN THIS SPACE TELL WHAT IS WRONG AND WHAT SHOULD BE DONE ABOUT IT:

PAGE NO	PARA-GRAPH	FIGURE NO	TABLE NO
2-25	2-28		
3-10	3-3		3-1
5-6	5-8		
		FO-3	

Recommend that the installation antenna alignment procedure be changed throughout to specify a 2° IFF antenna lag rather than 1°.

REASON: Experience has shown that with only a 1° lag, the antenna servo system is too sensitive to wind gusting in excess of 25 knots, and has a tendency to rapidly accelerate and decelerate as it hunts, causing strain to the drive train. Hunting is minimized by adjusting the lag to 2° without degradation of operation.

Item 5, Functional Column. Change "2 dB" to "3 dB".

REASON: The adjustment procedure for the TRANS POWER FAULT indicator calls for a 3 dB (500 watts) adjustment to light the TRANS POWER FAULT indicator.

and new step f.1 to read, "Replace cover plate removed in step above."

REASON: To replace the cover plate.

Zone C 3. On J1-2, change "+24 VDC" to "+5 VDC".

REASON: This is the output line of the 5 VDC power supply. +24 VDC is the input voltage.

SAMPLE

PRINTED NAME, GRADE OR TITLE AND TELEPHONE NUMBER

SSG I. M. DeSpirito 999-1776

SIGN HERE

TEAR ALONG DOTTED LINE

FILL IN YOUR
UNIT'S ADDRESS

FOLD BACK

DEPARTMENT OF THE ARMY

OFFICIAL BUSINESS

PLEASE
AFFIX
STAMP
POSTAGE
REQUIRED

SAMPLE

Commander
U.S. Army Communications-Electronics Command
and Fort Monmouth
ATTN: MSEL-LC-LM-LT
Fort Monmouth, New Jersey 07703-5007

TEAR ALONG DOTTED LINE

FILL IN YOUR
UNIT'S ADDRESS

FOLD BACK

DEPARTMENT OF THE ARMY

OFFICIAL BUSINESS

PLEASE
AFFIX
STAMP
POSTAGE
REQUIRED

TEAR ALONG DOTTED LINE

Commander
U.S. Army Communications-Electronics Command
and Fort Monmouth
ATTN: AMSEL-LC-LM-LT
Fort Monmouth, New Jersey 07703-5007

SOMETHING WRONG WITH THIS PUBLICATION



THEN ... JOT DOWN THE DOPE ABOUT IT ON THIS FORM. CAREFULLY TEAR IT OUT. FOLD IT AND DROP IT IN THE MAIL.

FROM: (PRINT YOUR UNIT'S COMPLETE ADDRESS)

DATE SENT

PUBLICATION NUMBER

PUBLICATION DATE

PUBLICATION TITLE

BE EXACT PIN-POINT WHERE IT IS

IN THIS SPACE TELL WHAT IS WRONG AND WHAT SHOULD BE DONE ABOUT IT:

PAGE
NO

PARA-
GRAPH

FIGURE
NO

TABLE
NO

TEAR ALONG DOTTED LINE

PRINTED NAME, GRADE OR TITLE AND TELEPHONE NUMBER

SIGN HERE

FILL IN YOUR
UNIT'S ADDRESS

FOLD BACK

DEPARTMENT OF THE ARMY



OFFICIAL BUSINESS

PLEASE
AFFIX
STAMP
POSTAGE
REQUIRED

TEAR ALONG DOTTED LINE

Commander
U.S. Army Communications-Electronics Command
and Fort Monmouth
ATTN: AMSEL-LC-LM-LT
Fort Monmouth, New Jersey 07703-5007

SOMETHING WRONG WITH THIS PUBLICATION



THEN ... JOT DOWN THE DOPE ABOUT IT ON THIS FORM. CAREFULLY TEAR IT OUT. FOLD IT AND DROP IT IN THE MAIL.

FROM: (PRINT YOUR UNIT'S COMPLETE ADDRESS)

DATE SENT

PUBLICATION NUMBER

PUBLICATION DATE

PUBLICATION TITLE

BE EXACT PIN-POINT WHERE IT IS

IN THIS SPACE TELL WHAT IS WRONG AND WHAT SHOULD BE DONE ABOUT IT:

PAGE NO

PARA-GRAPH

FIGURE NO

TABLE NO

TEAR ALONG DOTTED LINE

PRINTED NAME, GRADE OR TITLE AND TELEPHONE NUMBER

SIGN HERE

FILL IN YOUR
UNIT'S ADDRESS

FOLD BACK

DEPARTMENT OF THE ARMY

OFFICIAL BUSINESS

PLEASE
AFFIX
STAMP
POSTAGE
REQUIRED

TEAR ALONG DOTTED LINE

**Commander
U.S. Army Communications-Electronics Command
and Fort Monmouth
ATTN: AMSEL-LC-LM-LT
Fort Monmouth, New Jersey 07703-5007**

By Order of the Secretary of the Army:

GORDON R. SULLIVAN
General, United States Army
Chief of Staff

Official:

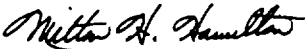
MILTON H. HAMILTON
Administrative Assistant to the,
Secretary of the Army

06189

DISTRIBUTION:

To be distributed in accordance with DA Form 12-36-E, block 9654 requirements for TM 11-6625-3265-24P.

