

**TM 11-6625-3165-24P**

**TECHNICAL MANUAL**

---

**ORGANIZATIONAL, DIRECT SUPPORT AND  
GENERAL SUPPORT MAINTENANCE  
REPAIR PARTS AND SPECIAL TOOLS LIST**

**FOR**

**SIGNAL GENERATOR  
SG-1207/U**

**(6625-01-233-8615)**

Distribution authorized to the Department of Defense and DOD contractors only for official use or for administration or operational purposes. This determination was made on 14 July 1987. Other requests for this document will be referred to Commander, US Army Communications-Electronics Command and Fort Monmouth, ATTN: AMSEL-ME-P, Fort Monmouth, NJ 07703-5000.

DESTRUCTION NOTICE - Destroy by any method that will prevent disclosure of contents or reconstruction of the document.

---

**HEADQUARTERS, DEPARTMENT OF THE ARMY**

**1 OCTOBER 1987**



Technical Manual  
 No. 11-6625-3165-24P

HEADQUARTERS  
 DEPARTMENT OF THE ARMY  
 Washington, DC, 1 October 1987

**ORGANIZATIONAL, DIRECT SUPPORT AND  
 GENERAL SUPPORT MAINTENANCE  
 REPAIR PARTS AND SPECIAL TOOLS LIST  
 FOR  
 SIGNAL GENERATOR SG-1207/U**

**(6625-01-233-8615)**

**Current as of 17 July 1987**

**REPORTING ERRORS AND RECOMMENDING IMPROVEMENTS**

You can help improve this manual. If you find any mistakes or if you know of away to improve the procedures, please let us know. Mail your letter, DA Form 2028 (Recommended Changes to Publications and Blank Forms), or DA Form 2028-2 located in back of this manual direct to: Commander, US Army Communications-Electronics Command and Fort Monmouth, ATTN: AMSEL-ME-MP, Fort Monmouth, NJ 07703-5000. A reply will be furnished to you.

TABLE OF CONTENTS

	Page	Illus/ Figure
Section I. INTRODUCTION .....	1	
Section II. REPAIR PARTS LIST .....	1-1	
Group 00 Signal Generator SG-1207/U .....	1-1	1
0001 Keyboard/LCD/Display Module (A1) No repair parts authorized		
0002 Modulation Module (A2) No repair parts authorized		
0003 Processor/Memory Module (A3) No repair parts authorized		
0004 Latch Module (A4) No repair parts authorized		
0005 FM Loop/Counter/Time Module (A6) No repair parts authorized		
0006 SAWR Loop Module (A7) No repair parts authorized		
0007 IF Loop Module (A9) No repair parts authorized		

TABLE OF CONTENTS—Continued

	Page	Illus/ Figure
Group 00		
0008 Reference Loop Module (A11)		
No repair parts authorized		
0009 Sum Loop/Divider Module (A12)		
No repair parts authorized		
0010 Output Filters/ALC Module (A13)		
No repair parts authorized		
0011 Heterodyne Module (A14)		
No repair parts authorized		
0012 Power Supply/Regulator/Attenuator Drivers Module (A17) . . . . .	2-1	2
0013 Power Supply/Rectifier/Filter Module (A18) . . . . .	3-1	3
0012 Doubler/Attenuator Module (A19)		
No repair parts authorized		
Section III.		
Group 99		
SPECIAL TOOLS LIST .		
Special Tools for general support maintenance . . . . .	4-1	4
Section IV.		
NATIONAL STOCK NUMBER AND PART NUMBER INDEX . . . . .	I-1	

## SECTION I INTRODUCTION

---

### 1. Scope

This manual lists and authorizes spares and repair parts; special tools; special test, measurement, and diagnostic equipment (TMDE), and other special support equipment required for performance of organizational and direct support maintenance of the SG-1207/U. It authorizes the requisitioning, issue, and disposition of spares, repair parts and special tools as indicated by the source, maintenance and recoverability (SMR) codes.

### 2. General

This Repair Parts and Special Tools List is divided into the following sections:

*a. Section II. Repair Parts List.* A list of spares and repair parts authorized by this RPSTL for use in the performance of maintenance. The list also includes parts which must be removed for replacement of the authorized parts. Parts lists are composed of functional groups in ascending numeric sequence, with the parts in each group listed in ascending item number sequence. Figure numbers are listed directly beneath the group header.

*b. Section III. Special Tools List.* A list of special tools, special TNDE, and other special support equipment authorized by this RPSTL (as indicated by Basis of Issue (BOI) information in (column (5)) for the performance of maintenance,

*c. Section IV. National Stock Number and Part Number Index.* A list, in National item identification number (NIIN) sequence, of all National stock numbered items appearing in the listings, followed by a list in alphameric sequence of all part numbers appearing in the listings. National stock numbers and part numbers are cross-referenced to each illustration figure and item number appearance.

### 3. Explanation of Columns (Section II and III)

*a. Item No. (Column (1)).* Indicates the number used to identify items called out in the illustration.

*b. SMR Code (Column (2)).* The source, maintenance, and recoverability (SMR) code is a five-position code containing supply/requisitioning information, maintenance category authorization criteria, and disposition instruction, as shown in the following breakout:

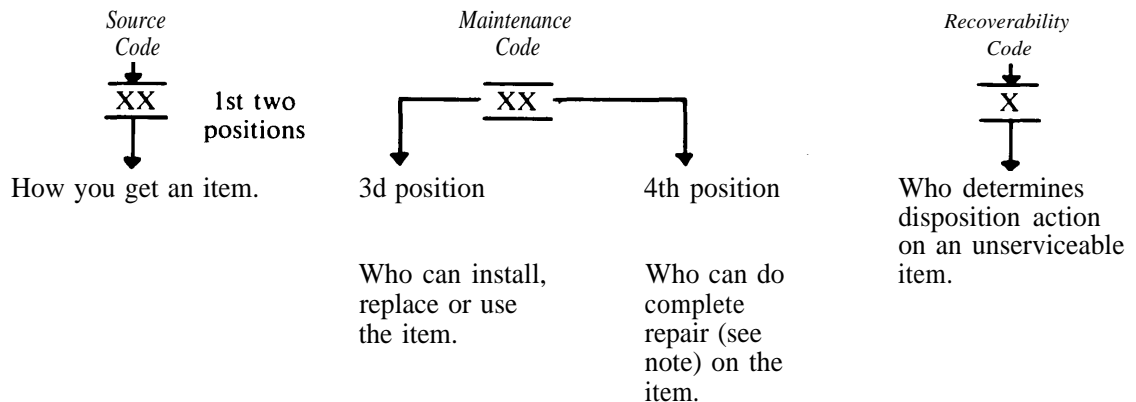

**NOTE**

Complete repair: Maintenance capacity, capability, and authority to perform all corrective maintenance tasks of the "Repair" function in a use/user environment in order to restore serviceability to a failed item.

(1) *Source Code.* The source code tells you how to get an item needed for maintenance, repair, or overhaul of an end item/equipment. Explanations of source codes follows:

<i>Code</i>	<i>Explanation</i>
PA PB PC PD PE PF PG	Stocked items; use the applicable NSN to request/requisition items with these source codes. They are authorized to the category indicated by the code entered in the third position of the SMR code.

**NOTE**

Items coded PC are subject to deterioration.

KD KF KB	Items with these codes are not to be requested/requisitioned individually. They are part of a kit which is authorized to the maintenance category indicated in the third position of the SMR code. The complete kit must be requisitioned and applied.
----------------	--

MO— Made at erg/ AVUM category MF — Made at DS/ AVUM category MH— Made at GS category ML — Made at Spec- ialized Repair Activity (SRA) MD— Made at Depot	Items with these codes are not to be requested/requisitioned individually. They must be made from bulk material which is identified by the part number in the description and usable on code (UOC) column and listed in the Bulk Material group of the repair parts list. If the item is authorized to you by the third position code of the SMR code, but the source code indicates it is made at a higher category, order the item from the higher category of maintenance.
---	---

AO — Assembled by erg/ AVUM category AF — Assembled by DS/ AVIM category AH — Assembled by GS category AL — Assembled by SRA AD — Assembled by Depot	Items with these codes are not to be requested/requisitioned individually. The parts that make up the assembled item must be requisitioned or fabricated and assembled at the category of maintenance indicated by the source code. If the third position code of the SMR code authorizes you to replace the item, but the source code indicates the item is assembled at a higher category, order the item from the higher category of maintenance.
---	--

- XA — Do not requisition an "XA" coded item. Order its next higher assembly.
- XB — If an "XB" item is not available from salvage, order it using the FSCM and part number given.
- XC — Installation drawing, diagram, instruction sheet, field service drawing, that is identified by manufacturers part number.
- XD — Item is not stocked. Order an "XD" coded item through normal supply channels using the FSCM and part number given, if no NSN is available.

**NOTE**

Cannibalization or controlled exchange, when authorized, may be used as a source of supply for items with the above source codes, except for those source coded "XA" or those aircraft support items restricted by requirements of AR 750-1.

(2) *Maintenance Code*, Maintenance codes tell you the category of maintenance authorized to USE and REPAIR support items. The maintenance codes are entered in the third and fourth positions of the SMR code as follows:

(a) The maintenance code entered in the third position tells you the lowest maintenance category authorized to remove, replace, and use an item. The maintenance code entered in the third position will indicate authorization to one of the following categories of maintenance.

<i>Code</i>	<i>Application/Explanation</i>
C	— Crew or operator maintenance done within organizational or aviation maintenance.
O	— Organizational or aviation unit category can remove, replace, and use the item.
F	— Direct support or aviation intermediate category can remove, replace, and use the item.
H	— General support category can remove, replace, and use the item.
L	— Specialized repair activity can remove, replace, and use the item.
D	— Depot category can remove, replace, and use the item.

(b) The maintenance code entered in the fourth position tells whether or not the item is to be repaired and identifies the lowest maintenance category with the capability to do complete repair (i. e., perform all authorized repair functions). This position will contain one of the following maintenance codes:

**NOTE**

Some limited repair may be done on the item at a lower category of maintenance, if authorized by the Maintenance Allocation Chart (MAC) and SMR codes.

<i>Code</i>	<i>Application/Explanation</i>
O	— Organizational or aviation unit is the lowest category that can do complete repair of the item.
F	— Direct support or aviation intermediate is the lowest category that can do complete repair of the item.
H	— General support is the lowest category that can do complete repair of the item.
L	— Specialized repair activity (designate the specialized repair activity) is the lowest category that can do complete repair of the item.
D	— Depot is the lowest category that can do complete repair of the item.
Z	— Nonreparable. No repair is authorized.
B	— No repair is authorized. (No parts or special tools are authorized for the maintenance of a "B" coded item. ) However, the item may be reconditioned by adjusting, lubricating, etc., at the user category.

(3) *Recoverability Code*. Recoverability codes preassigned to items to indicate the disposition action on unserviceable items. The recoverability code is entered in the fifth position of the SMR Code as follows:

<i>Recoverability codes</i>	<i>Application/Explanation</i>
Z	— Nonreparable item. When unserviceable, condemn and dispose of the item at the category of maintenance shown in the third position of SMR Code.
O	— Repairable item. When uneconomically repairable, condemn and dispose of the item at organizational or aviation unit category.
F	— Repairable item. When uneconomically repairable, condemn and dispose of the item at the direct support or aviation intermediate category.
H	— Repairable item. When uneconomically repairable, condemn and dispose of the item at general support category.
D	— Repairable item. When beyond lower level repair capability, return to depot. Condemnation and disposal of item not authorized below depot category.
L	— Repairable item. Condemnation and disposal not authorized below specialized repair activity (SRA).
A	— Item requires special handling or condemnation procedures because of specific reasons (e.g., precious metal content, high dollar value, critical material, or hazardous material). Refer to appropriate manuals/directives for specific instructions.

c. *FSCM (Column (3))*. The Federal Supply Code for Manufacturer (FSCM) is a 5-digit numeric code which is used to identify the manufacturer, distributor, or Government agency, etc., that supplies the item.

d. *Part Number (Column (4))*. Indicates the primary number used by the manufacturer (individual, company, firm, corporation, or Government activity), which controls the design and characteristics of the item by means of its engineering drawings, specifications, standards, and inspection requirements to identify an item or range of items.

**NOTE**

When you use a NSN to requisition an item, the item you receive may have a different part number from the part ordered.

e. *Description and Usable on Code (UOC)(Column(5))*. This column includes the following information.

(1) The Federal item name and, when required, a minimum description to identify the item.

(2) In the Special Tools section, the basis of issue (BOI) appears as the last line in the entry for each special tool, special TM DE, and other special support equipment. When density of equipments supported exceeds density spread indicated in the basis of issue, the total authorization is increased proportionately.

(3) The statement “END OF FIGURE” appears just below the last item description in Column (5) for a given figure in both section II and section III.

f. *Qty (Column (6))*. Indicates the quantity of the item used in the breakout shown on the illustration figure, which is prepared for a functional group, subfunctional group, or an assembly. A “V” appearing in this column in lieu of a quantity indicates that the quantity is variable and the quantity may vary from application to application.



## 4. Explanation of Columns (Section IV)

### a. National Stock Number (NSN) Index.

(1) *Stock number column.* This column lists the NSN by National item identification number (NIIN) sequence. The NIIN consists of the last nine digits of the NSN. When using this column to locate an item, ignore the first four digits of the NSN. When requisitioning items use the complete NSN (13 digits).

(2) *Fig. column.* This column lists the number of the figure where the item is identified/located. The illustrations are in numerical sequence in sections 11 and III.

(3) *Item column.* The item number identifies the item associated with the figure listed in the adjacent Fig. column. This item is also identified by the NSN listed on the same line.

b. *Part Number Index.* Part numbers in this index are listed by part number in ascending alphanumeric sequence.

(1) *FSCM column.* This column lists the Federal supply code for manufacturer (FSCM).

(2) *Part number column.* This column indicates the part number assigned to the item.

(3) *Stock number column.* This column lists the National stock number for the associated part number and manufacturer identified in the part number and FSCM columns to the left.

(4) *Fig. column.* This column lists the number of the figure where the item is identified/located in sections II and III.

(5) *Item column.* The item number is that number assigned to the item as it appears in the figure referenced in the adjacent figure number column.

## 5. Special Information

a. *Associated Publications.* The publication listed below pertains to the SG-1207/U and its components:

TM 11-6625-3165-14, Signal Generator SG-1207/U

b. *National Stock Numbers.* National stock numbers (NSN's) that are missing from P source coded items have been applied for and will be added to this TM by future change/revision when they are entered in the Army Master Data File (AMDF). Until the NSN's are established and published, submit exception requisitions to: Commander, US Army Communications-Electronics Command and Fort Monmouth, ATTN: AMSEL-MM, Fort Monmouth, NJ 07703-5000 for the part required to support your equipment.

## 6. How to Locate Repair Parts

a. *When National stock number or part number is not known.*

(1) *First.* Using the table of contents, determine the assembly group or subassembly group to which the item belongs. This is necessary since figures are prepared for assembly groups and subassembly groups, and listings are divided into the same groups.

(2) *Second.* Find the figure covering the assembly group or subassembly group to which the item belongs.

(3) *Third.* Identify the item on the figure and note the item number.

(4) *Fourth.* Refer to the Repair Parts List for the figure to find the part number for the item number noted on the figure.

(5) *Fifth.* Refer to the Part Number Index to find the NSN, if assigned.

*b. When National stock number or part number is known.*

(1) *First.* Using the Index of National stock numbers and part numbers, find the pertinent National stock number or part number. The NSN index is in National item identification number (NIIN) sequence (para 4 *a* (1)). The part numbers in the part number index are listed in ascending alphameric sequence (para 4 *b* ). Both indexes cross-reference you to the illustration figure and item number of the item you are looking for.

(2) *Second.* After finding the figure and item number, verify that the item is the one you're looking for, then locate the item number in the repair parts list for the figure.

## **7. Abbreviations**

Not applicable.



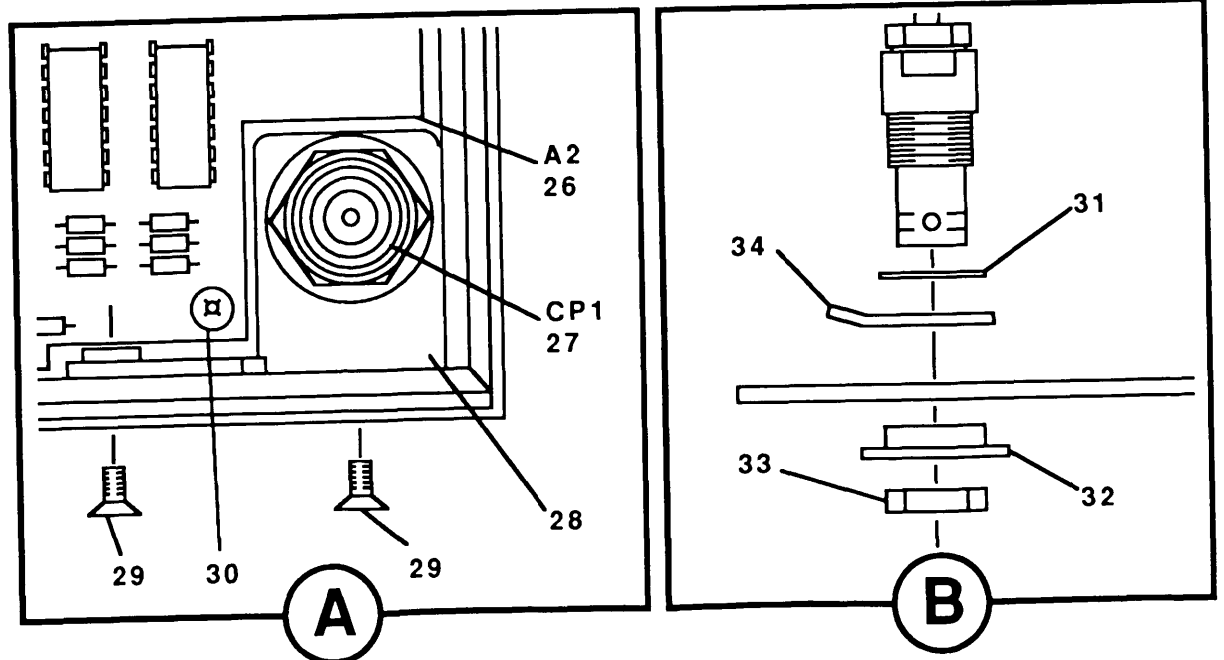
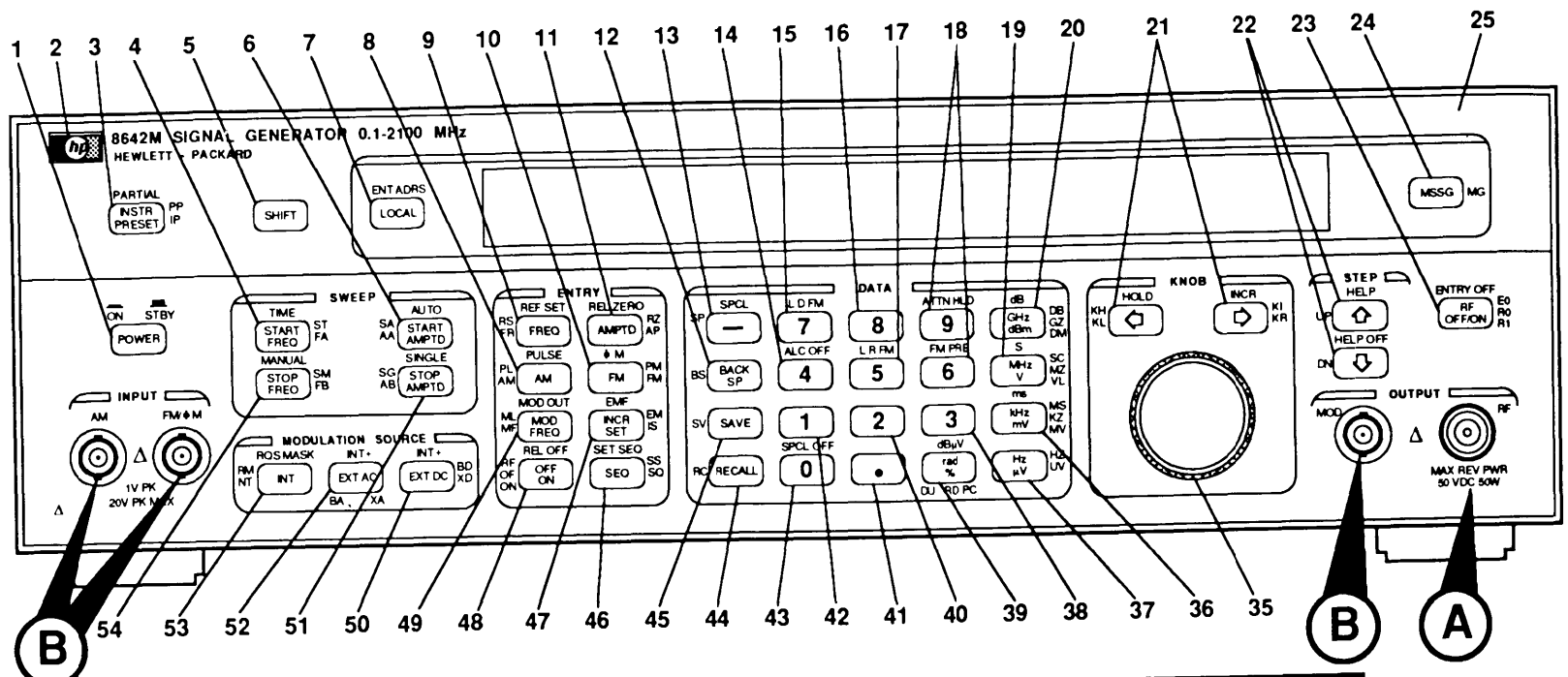
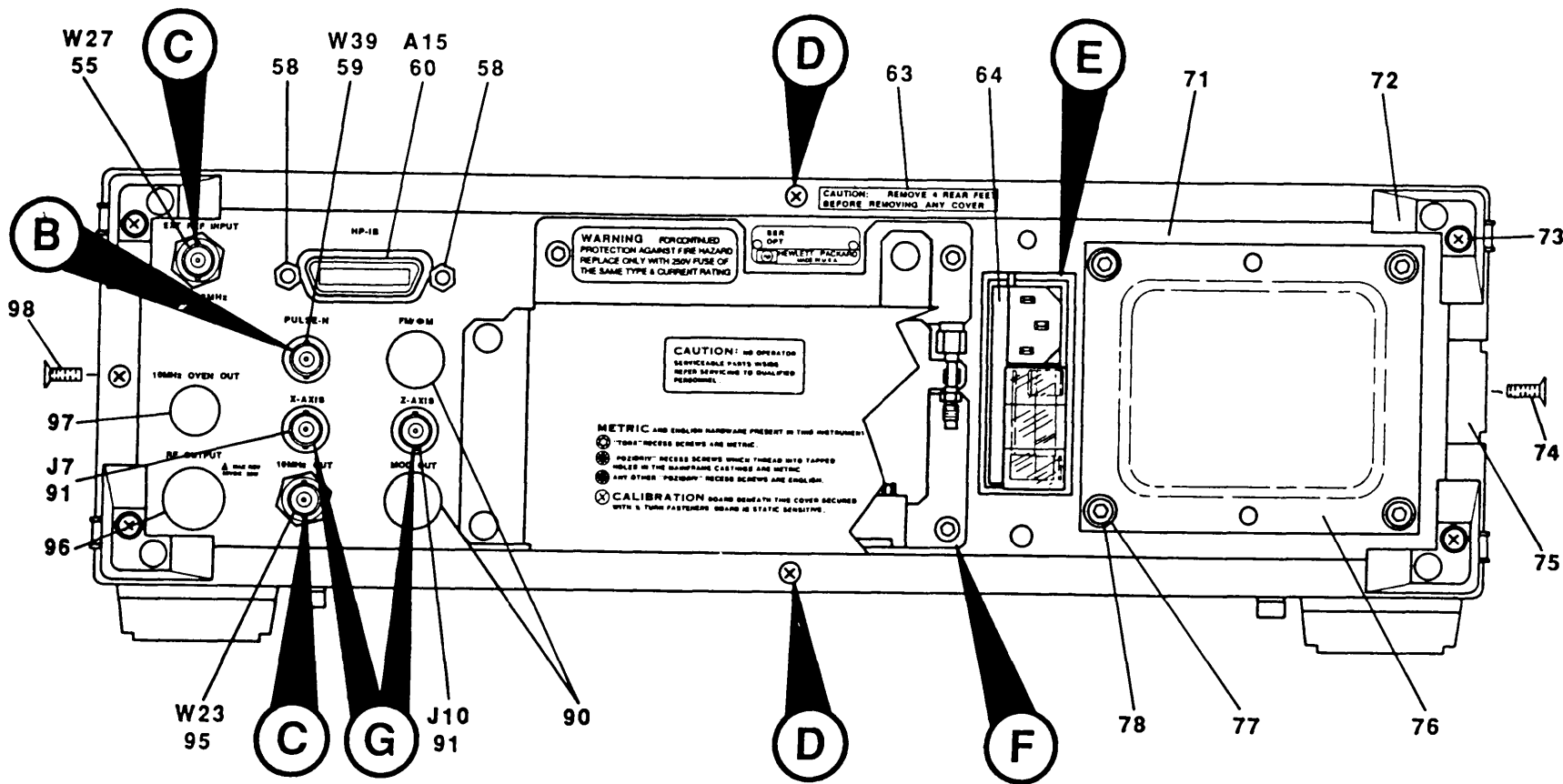

Figure 1. Signal Generator SG-1207/U (Sheet 1 of 13).

TM 11-6625-3165-24P

CE0WR001



TM 11-6625-3165-24P

Figure 1. Signal Generator SG-1207/U (Sheet 2 of 13).

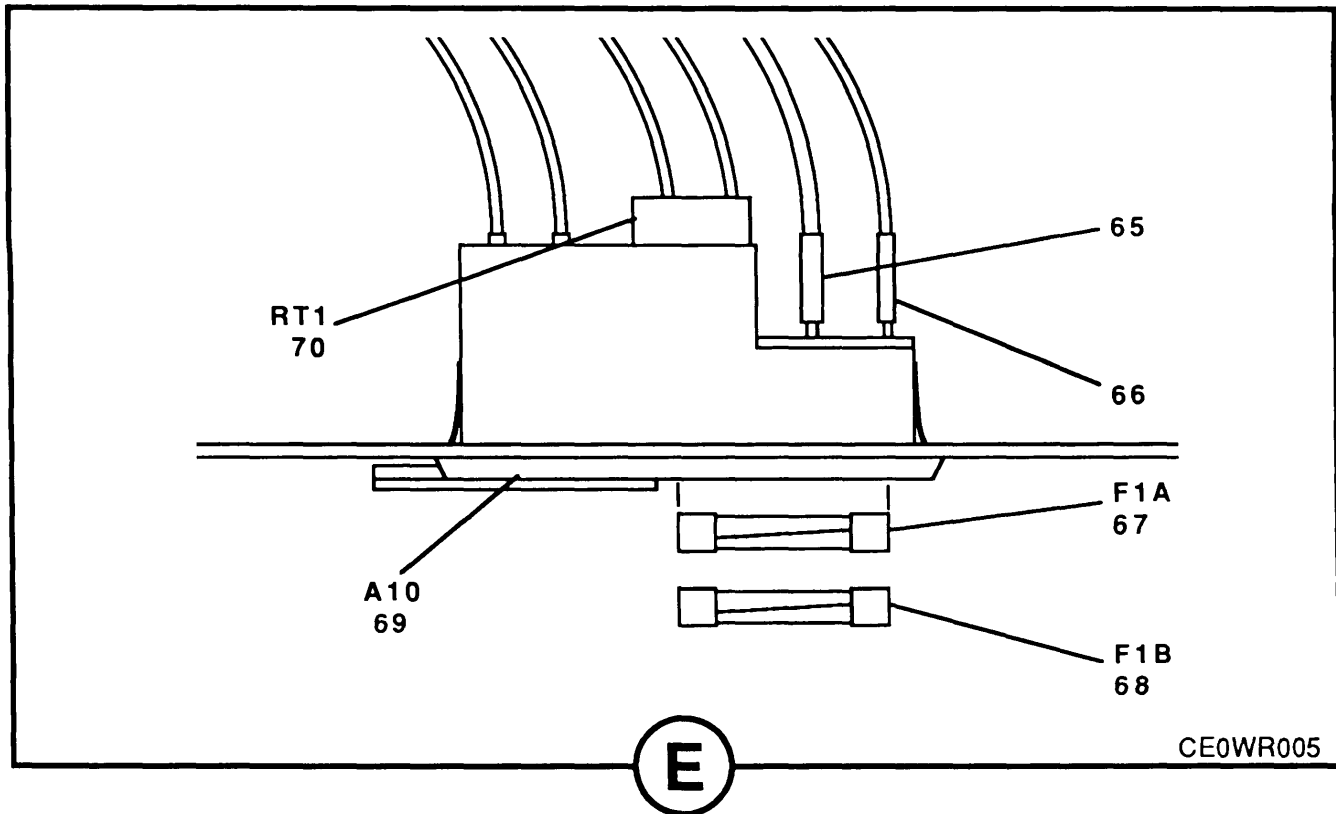
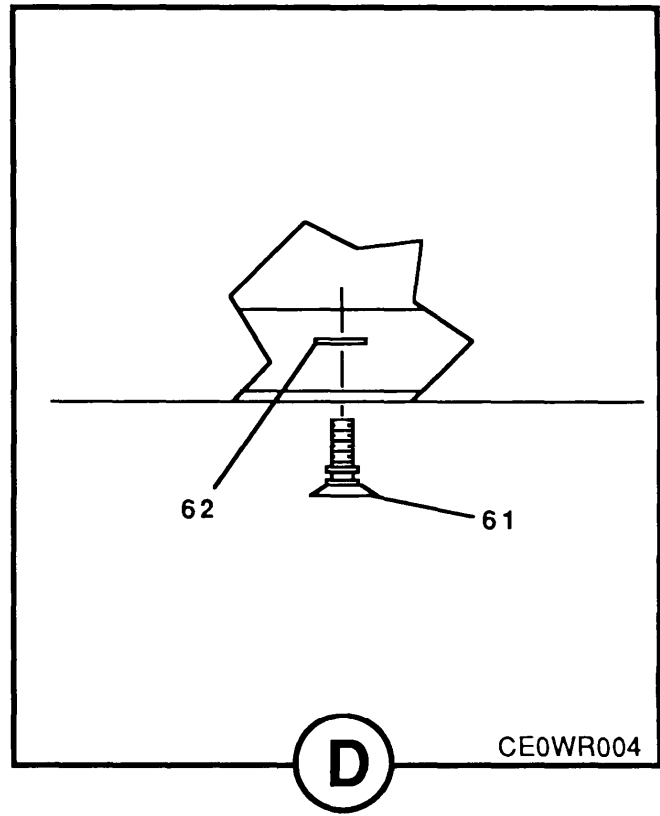
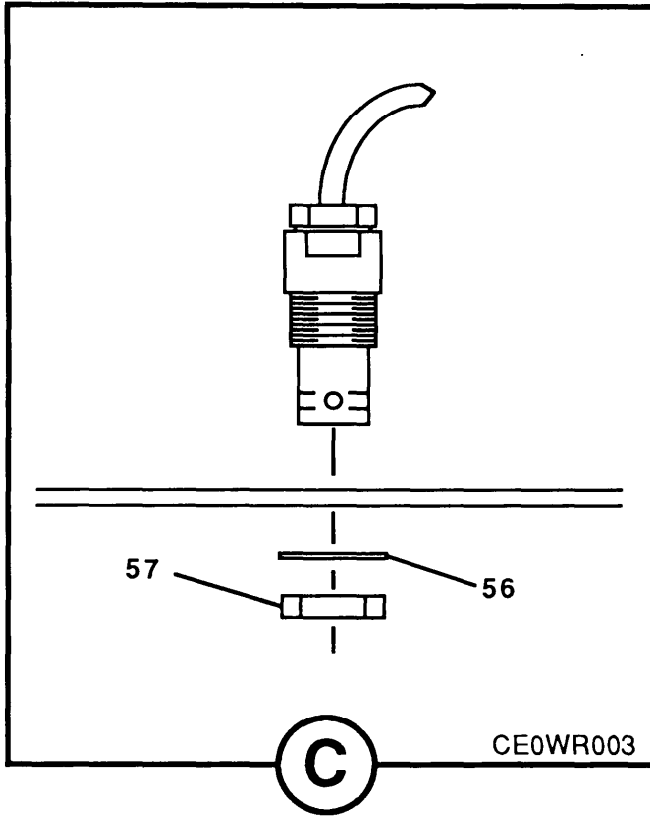

Figure 1. Signal Generator SG-1207/U (Sheet 3 of 13).

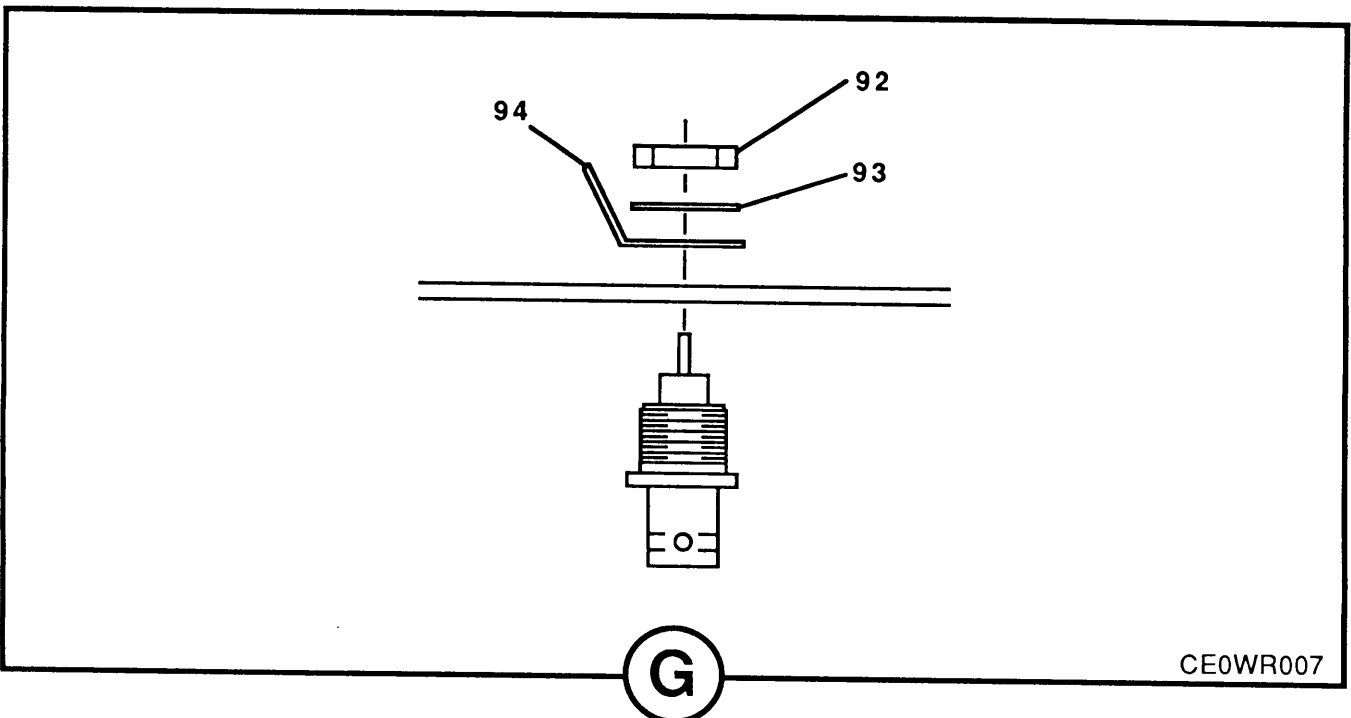
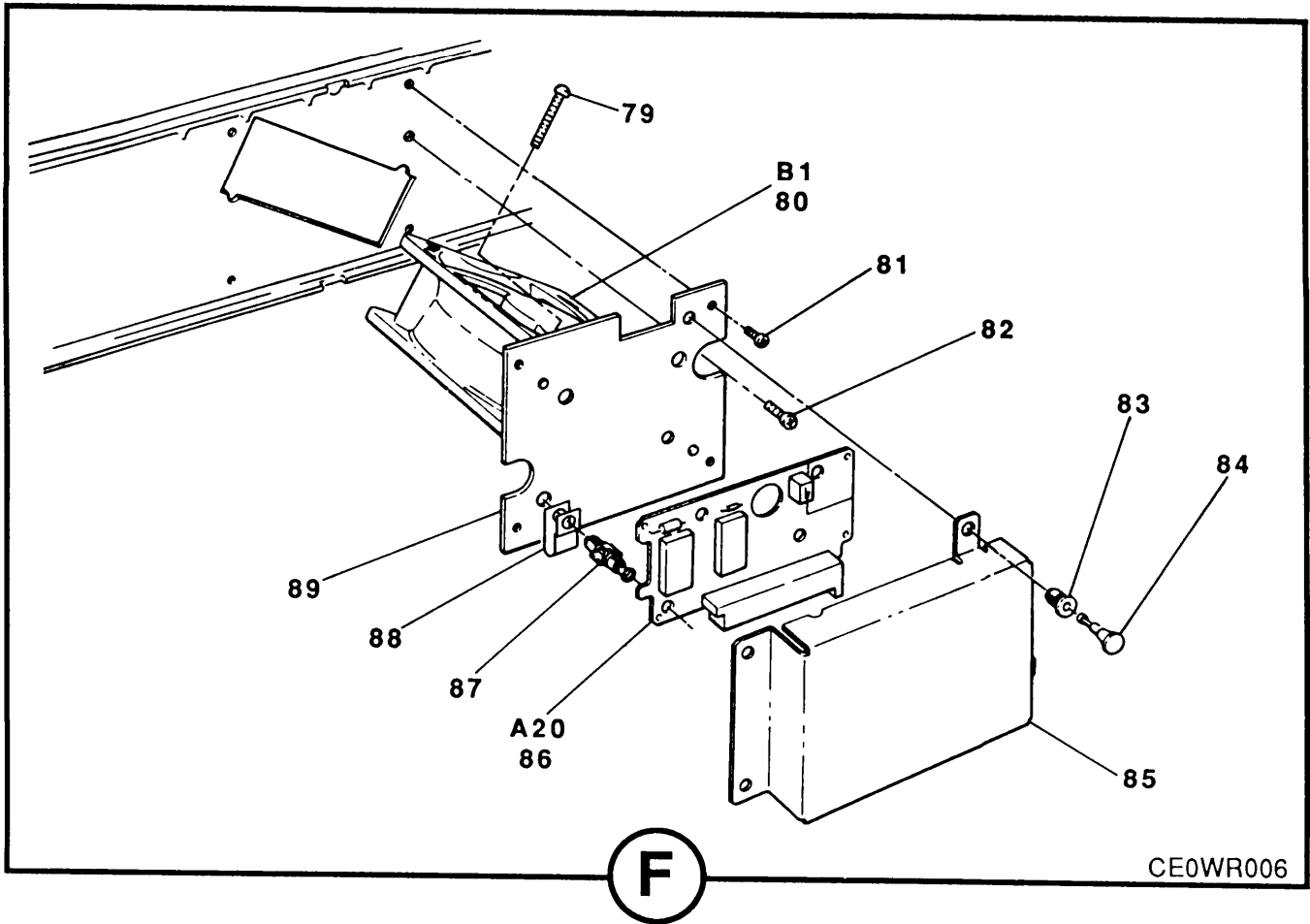
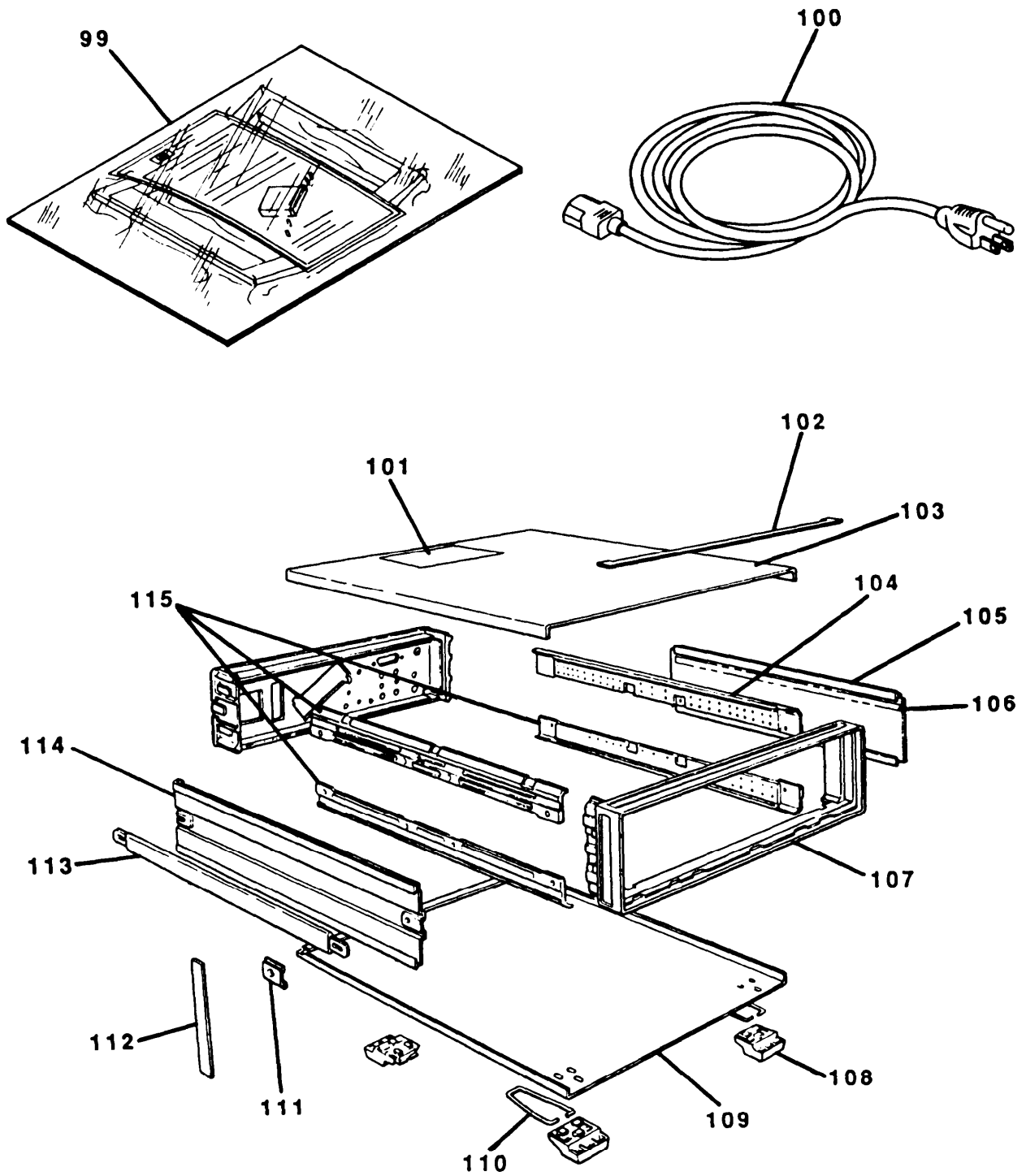

Figure 1. Signal Generator SG-1207/U (Sheet 4 of 13).



CE0WR008

Figure 1. Signal Generator SG-1207/U (Sheet 5 of 13).



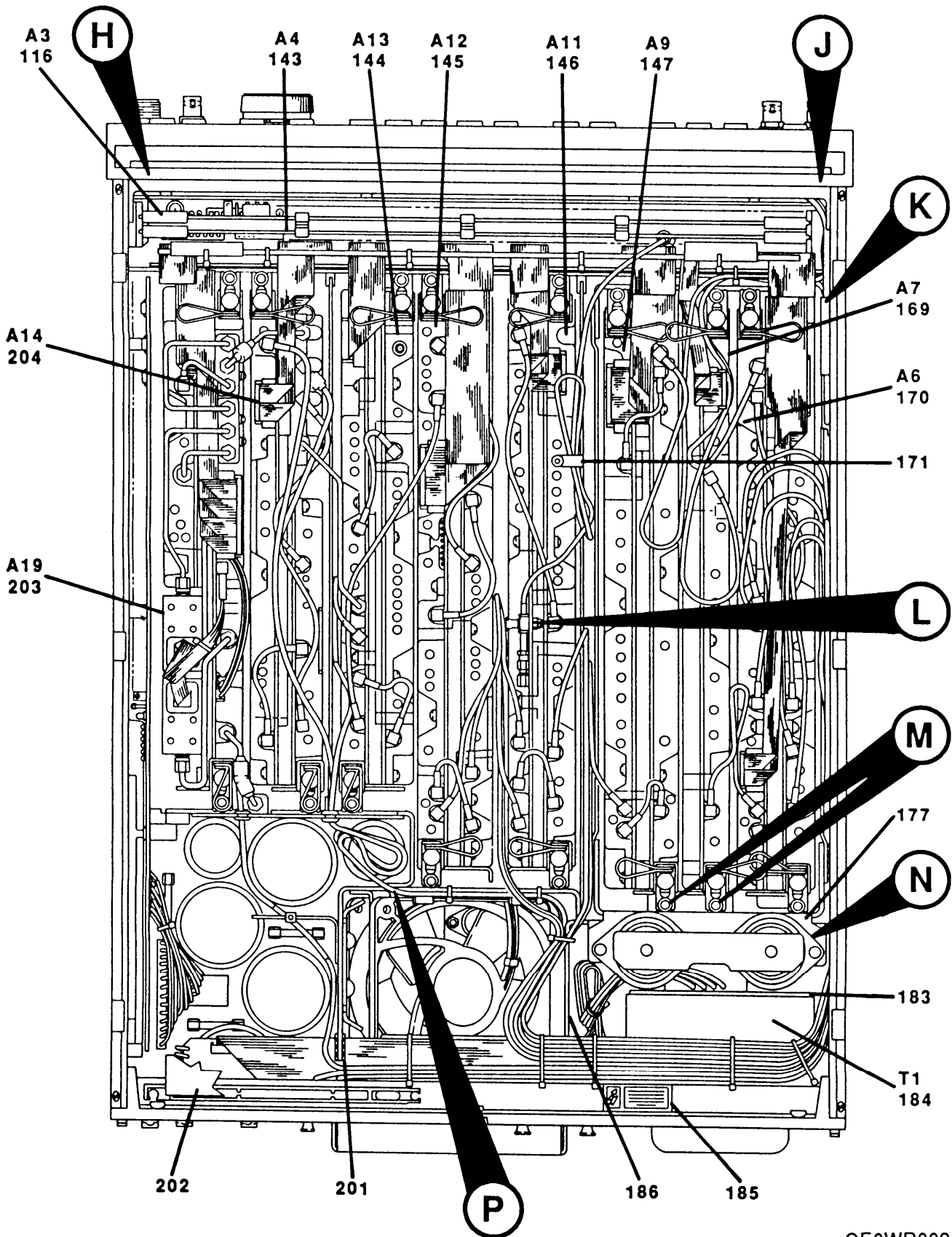

Figure 1. Signal Generator SG-1207/U (Sheet 6 of 13)

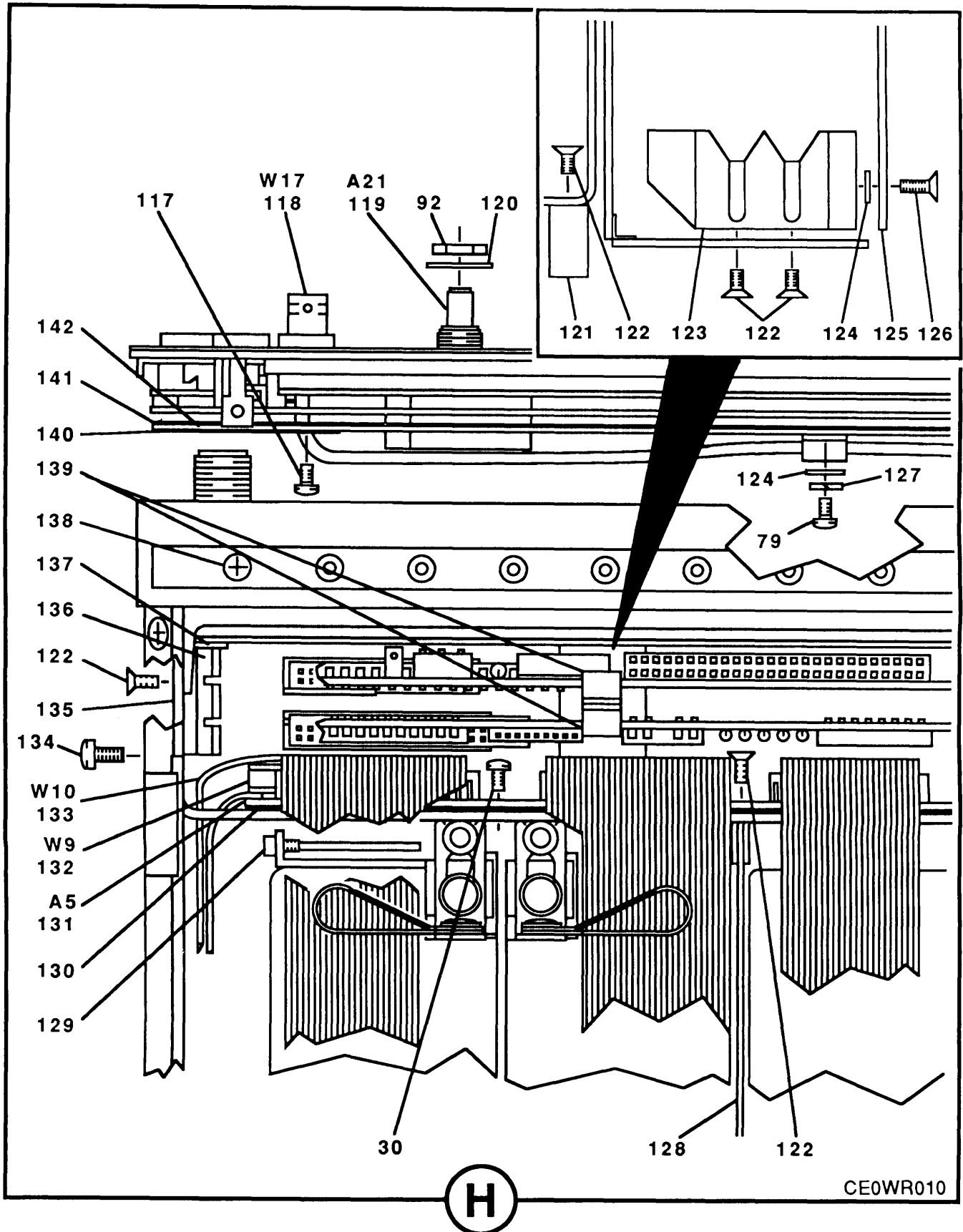

Figure 1. Signal Generator SG-1207/U (Sheet 7 of 13).

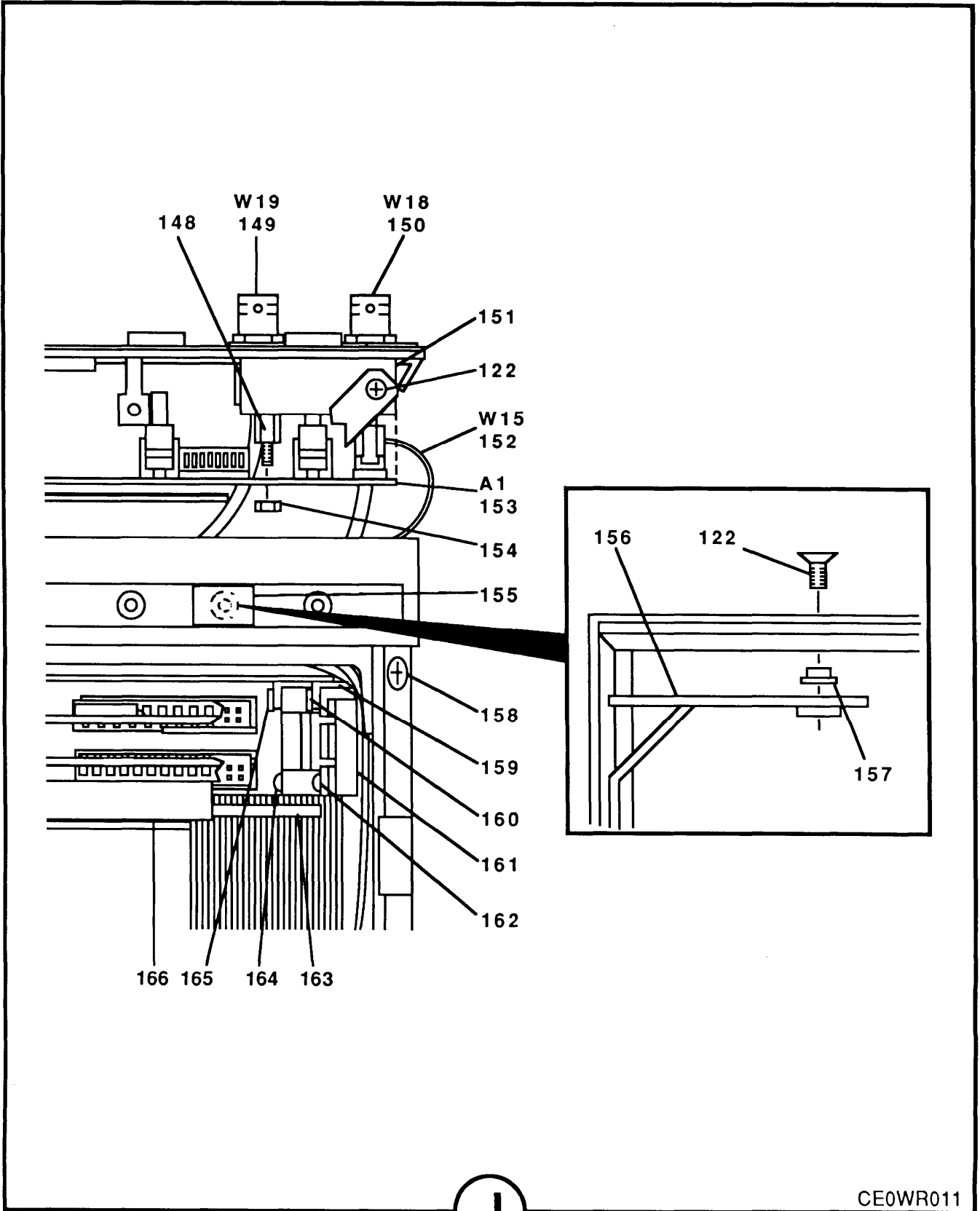

Figure 1. Signal Generator SG-1207/U (Sheet 8 of 13).

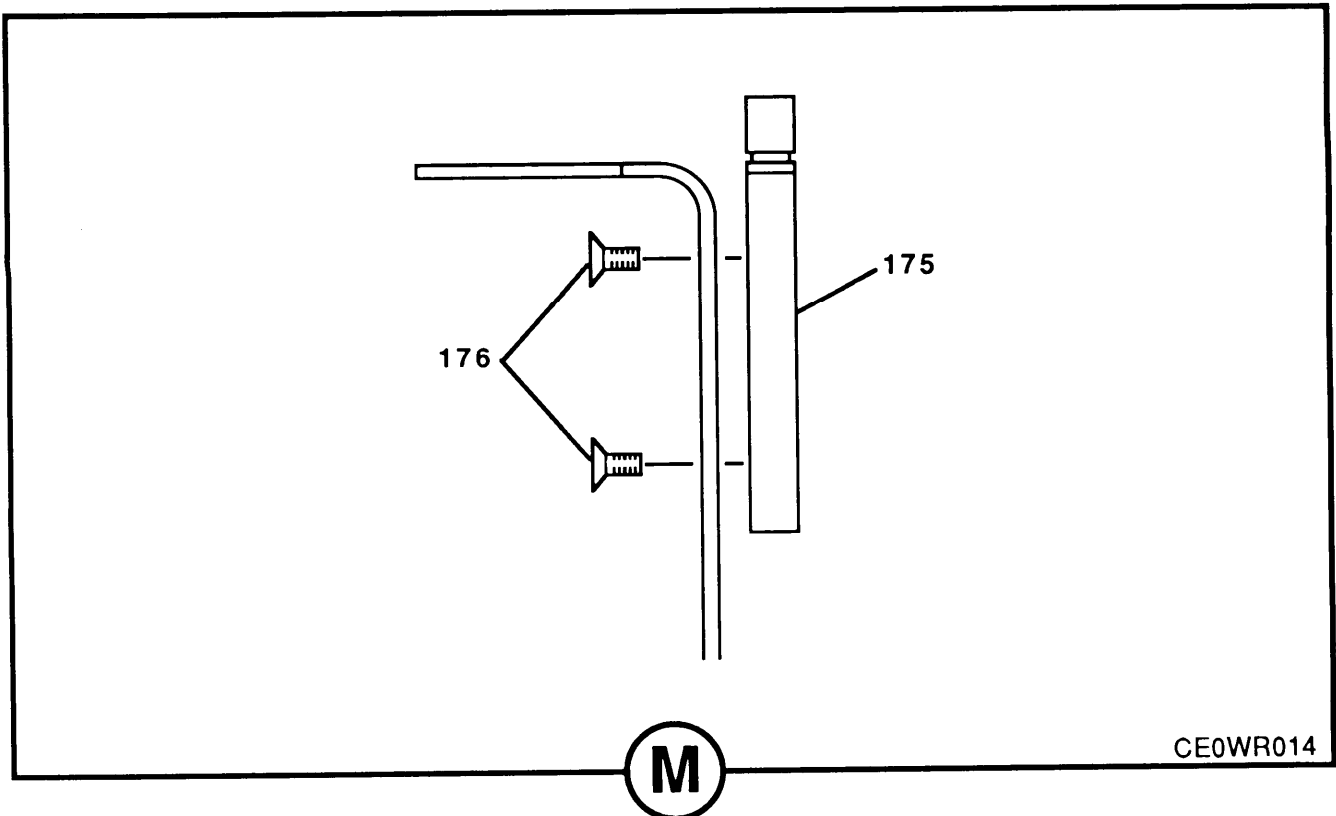
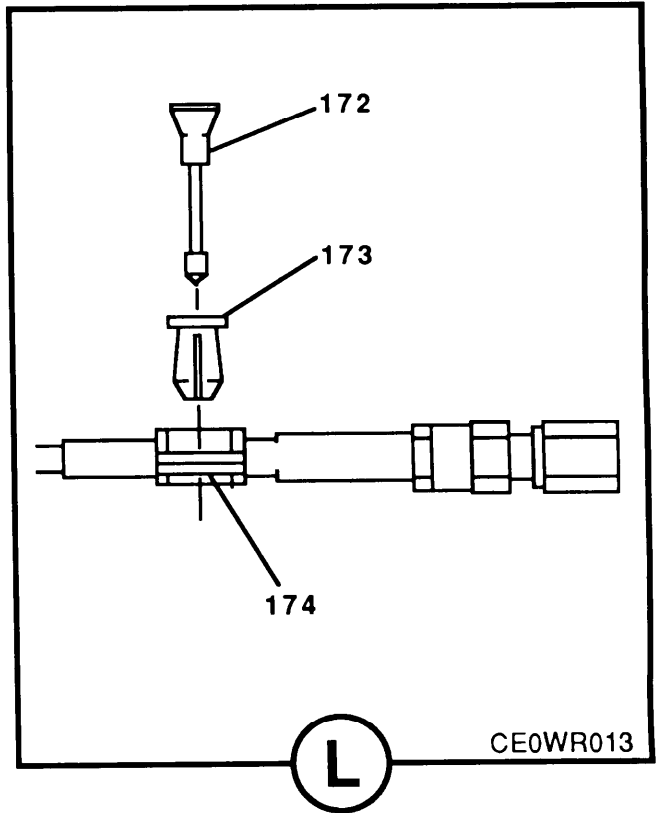
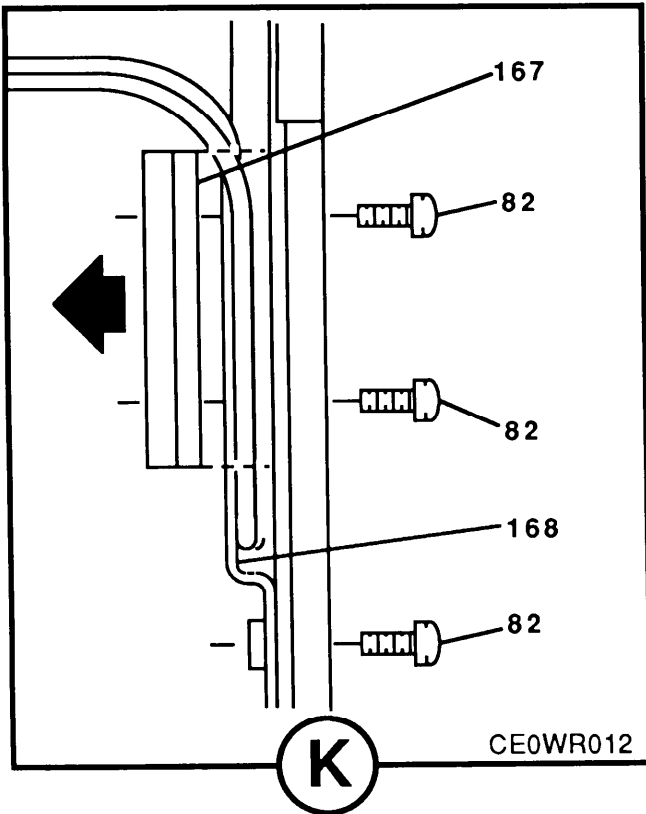

Figure 1. Signal Generator SG-1207/U (Sheet 9 of 13)



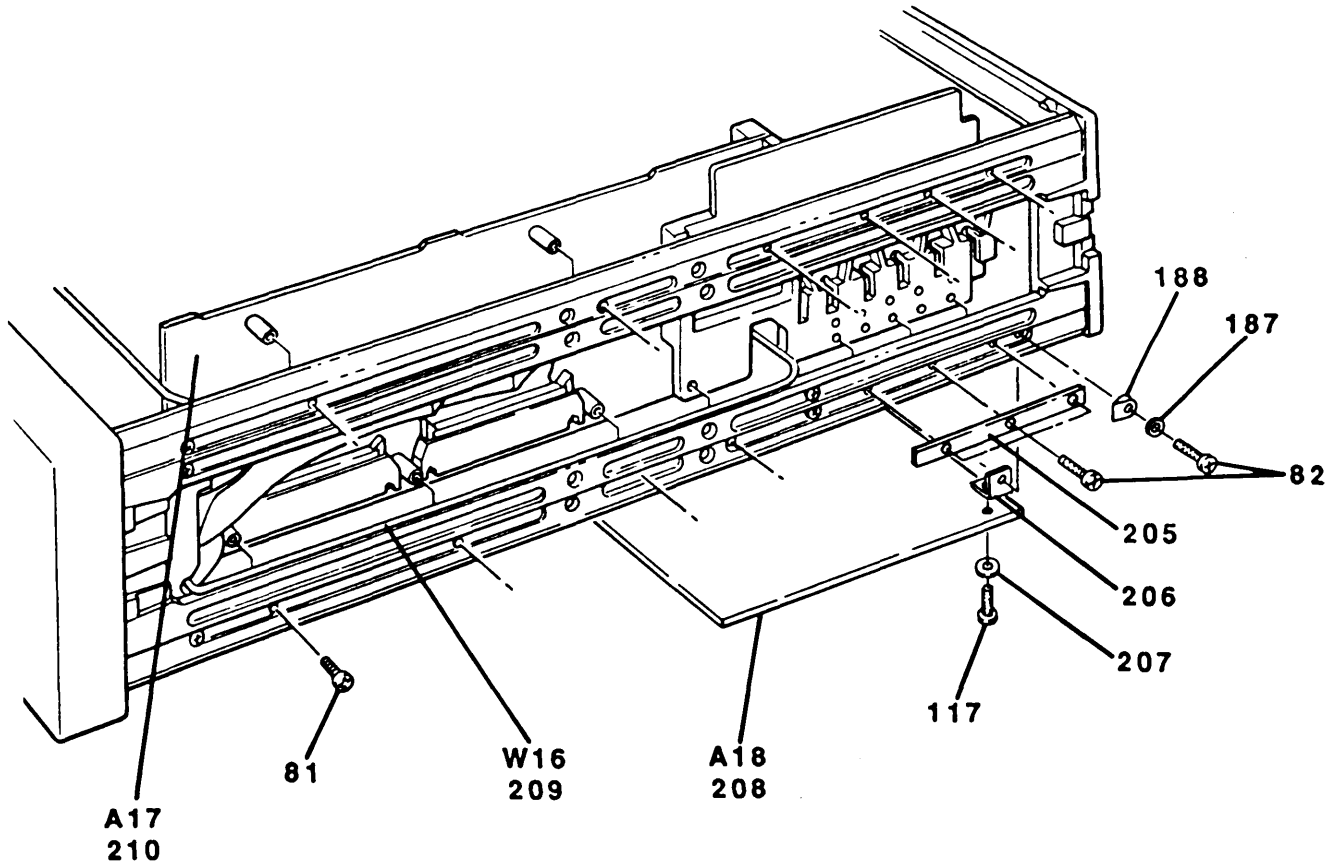

Figure 1. Signal Generator SG-1207/U (Sheet 11 of 13).

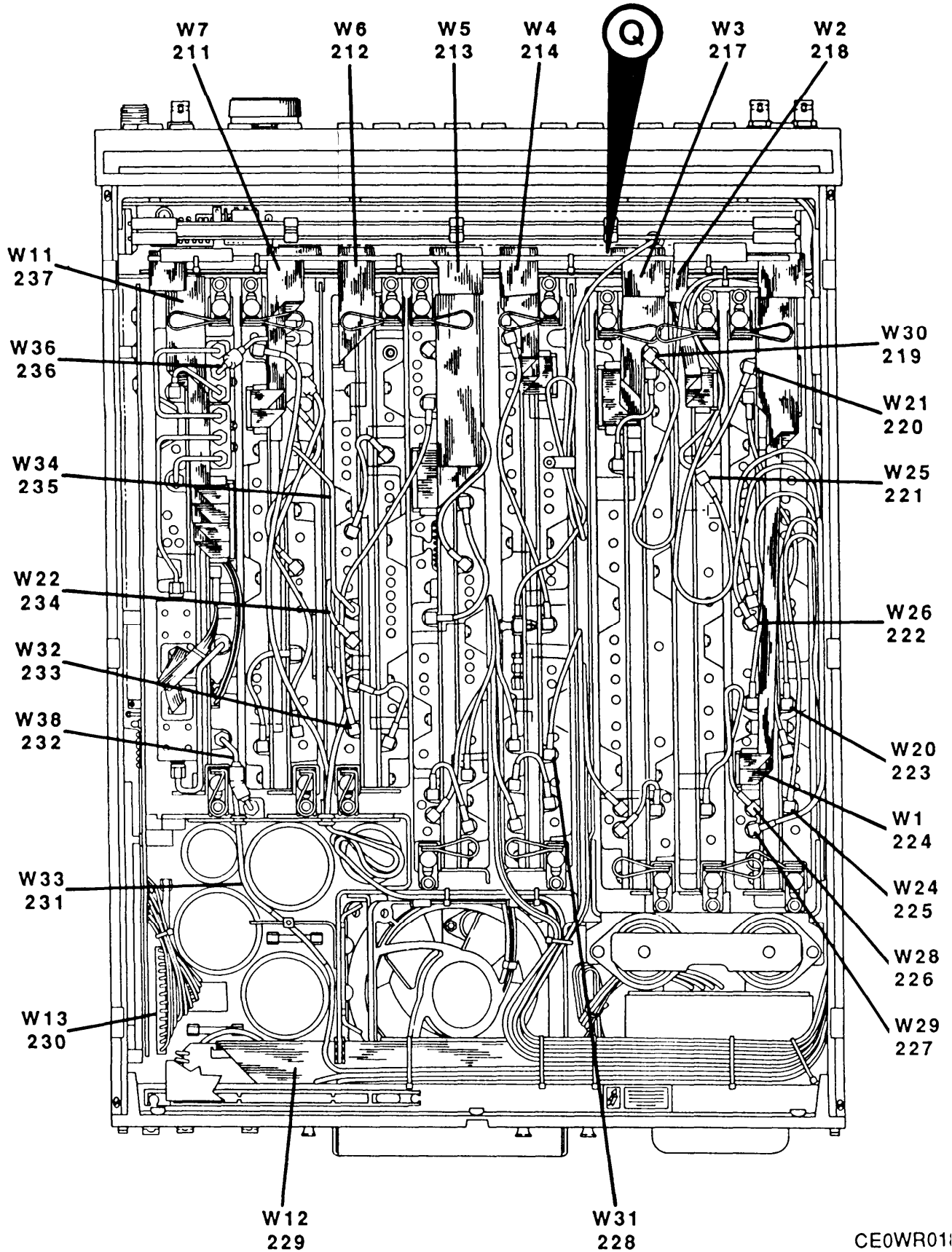

Figure 1. Signal Generator SG-1207/U (Sheet 12 of 13).

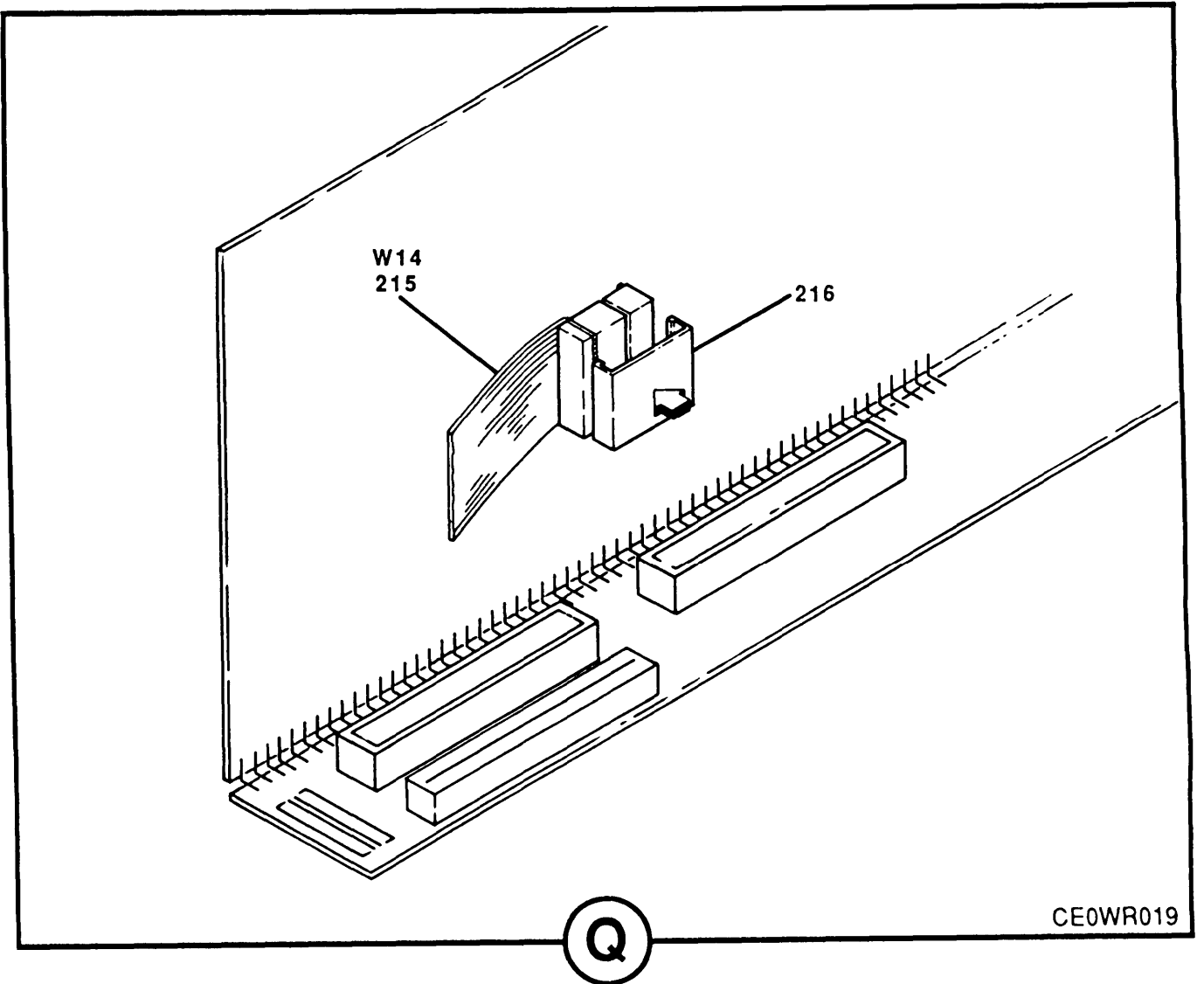

Figure 1. Signal Generator SG-1207/U (Sheet 13 of 13).



(1) ITEM NO	(2) SMR CODE	(3) FSCM	(4) PART NUMBER	(5) DESCRIPTION AND USABLE ON CODE (UOC)  GROUP OO SIGNAL GENERATOR SG-1207/U  FIGURE 1	(6) QTY
1	PAHZZ	28480	5041-0944	PUSH BUTTON	1
2	XBHZZ	28480	7120-1254	PLATE, IDENT	1
3	PAHZZ	28480	5041-0720	PUSH BOTTON	1
4	PAHZZ	28480	5041-2719	PUSH BUTTON	1
5	PAHZZ	28480	5041-4537	PUSH BUTTON	1
6	PAHZZ	28480	5041-2823	PUSH BUTTON	1
7	PAHZZ	28480	5041-1792	PUSH BUTTON	1
8	PAHZZ	28480	5041-2818	PUSH BUTTON	1
9	PAHZZ	28480	5041-1749	PUSH BUTTON	1
10	PAHZZ	28480	5041-2819	PUSH BUTTON	1
11	PAHZZ	28480	5041-2820	PUSH BUTTON	1
12	PAHZZ	28480	5041-2837	PUSH BUTTON	1
13	PAHZZ	28480	5041-1835	PUSH BUTTON	1
14	PAHZZ	28480	5041-0814	PUSH BUTTON	1
15	PAHZZ	28480	5041-0817	PUSH BUTTON	1
16	PAHZZ	28480	5041-0818	PUSH BUTTON	1
17	PAHZZ	28480	5041-0815	PUSH BUTTON	1
18	PAHZZ	28480	5041-0816	PUSH BUTTON	2
19	PAHZZ	28480	5041-2938	PUSH BUTTON	1
20	PAHZZ	28480	5041-2939	PUSH BUTTON	1
21	PAHZZ	28480	5041-2835	PUSH BUTTON	2
22	PAHZZ	28480	5041-0855	PUSH BUTTON	2
23	PAHZZ	28480	5041-2830	PUSH BUTTON	1
24	PAHZZ	28480	5041-4538	PUSH BUTTON	1
25	XBHZZ	28480	08642-00176	PANEL, FRONT	1
26	PAHDD	28480	08642-69890	MODULATION MODULE CONTRACTOR REPAIR REQUIRES EXCHANGE AND NEW A20 CAL CARD DATA	1
27	PAHZZ	98291	050-675-0469-89	ADAPTER, CONNECTOR	1
28	XBHZZ	28480	08642-00010	BRACKET, MTG, CONN	1
29	PAHZZ	28480	0515-1101	SCREW, MACHINE	2
30	PAHZZ	28480	0515-0680	SCREW, MACHINE	16
31	PAHZZ	86928	5710-191-20	SPACER, RING	4
32	XBHZZ	28480	08642-40072	INSULATOR, BUSHING	4
33	PAHZZ	28480	0590-1251	NUT, SPECIALTY	4
34	XBHZZ	28480	08642-00139	WASHER, SPECIAL	4
35	PAOZZ	28480	0370-2389	KNOB	1
36	PAHZZ	28480	5041-0926	PUSH BUTTON	1
37	PAHZZ	28480	5041-2940	PUSH BUTTON	1
38	PAHZZ	28480	5041-0813	PUSH BUTTON	1
39	PAHZZ	28480	5041-2832	PUSH BUTTON	1
40	PAHZZ	28480	5041-0812	PUSH BUTTON	1
41	PAHZZ	28480	5041-0808	PUSH BUTTON	1
42	PAHZZ	28480	5041-0811	PUSH BUTTON	1
43	PAHZZ	28480	5041-0819	PUSH BUTTON	1
44	PAHZZ	28480	5041-0775	PUSH BUTTON	1
45	PAHZZ	28480	5041-0095	PUSH BUTTON	1
46	PAHZZ	28480	5041-2836	PUSH BUTTON	1

## SECTION II TM11-6625-3165-24P

(1) ITEM NO	(2) SMR CODE	(3) FSCM	(4) PART NUMBER	(5) DESCRIPTION AND USABLE ON CODE (UOC)	(6) QTY
47	PAHZZ	28480	5041-2826	PUSH BUTTON	1
48	PAHZZ	28480	5041-2829	PUSH BUTTON	1
49	PAHZZ	28480	5041-2825	PUSH BUTTON	1
50	PAHZZ	28480	5041-2827	PUSH BUTTON	1
51	PAHZZ	28480	5041-2824	PUSH BUTTON	1
52	PAHZZ	28480	5041-2828	PUSH BUTTON	1
53	PAHZZ	28480	5041-2834	PUSH BUTTON	1
54	PAHZZ	28480	5041-2720	PUSH BUTTON	1
55	PAHZZ	28480	08642-60056	CABLE ASSEMBLY, RADI	1
56	PAHZZ	96906	MS35333-112	WASHER, LOCK	2
57	PAHZZ	53655	11-341LN	NUT, PLAIN, HEXAGON	2
58	PAHZZ	28480	0380-1180	BOLT, SHOULDER	2
59	PAHZZ	28480	08642-60197	CABLE ASSEMBLY, RADI	1
60	PAHZZ	28480	08642-60129	CIRCUIT CARD ASSEMB	1
61	PAHZZ	28480	0515-1245	SCREW, MACHINE	3
62	PAHZZ	28480	0510-1253	RING, RETAINING	3
63	XBHZZ	28480	7120-8138	PLATE, INFORMATION	1
64	XBHZZ	28480	7121-4815	PLATE, INFORMATION	1
65	PAHZZ	27264	02-05-5204	CONTACT, ELECTRICAL	1
66	PAHZZ	27264	2125	TERMINAL, QUICK DISC	4
67	PAOZZ	81349	F02A250V2A	FUSE, CARTRIDGE	1
68	PAOZZ	81349	F02A250V3A	FUSE, CARTRIDGE	1
69	PAHZZ	05245	F1927	LINE MODULE ASSY	1
70	PAHZZ	28480	0837-0366	RESISTOR, THERMAL	1
71	XBHZZ	28480	08642-60956	PANEL, REAR	1
72	PAOZZ	28480	5040-7221	BUMPER, PLASTIC	4
73	PAHZZ	28480	0515-1232	SCREW, MACHINE	4
74	PAHZZ	28480	0515-1132	SCREW, MACHINE	2
75	PAOZZ	28480	5041-6820	BRACKET, LEVER	1
76	XBHZZ	28480	7100-1115	COVER, ACCESS	1
77	PAHZZ	06540	2711-21562PHF169 -30	WASHER, SHOULDERED	4
78	PAHZZ	28480	0515-1082	SCREW, MACHINE	4
79	PAHZZ	28480	0515-0373	SCREW, MACHINE	4
80	PAHZZ	28480	08642-80019	FAN CENTRIFUGAL	1
81	PAHZZ	28480	0515-0381	SCREW, MACHINE	17
82	PAHZZ	28480	0515-1142	SCREW, MACHINE	21
83	PAHZZ	83014	HN4G43-1	GROMMET, NONMETALLIC	4
84	PAHZZ	83014	HN4643-4-1	STUD, SELF-LOCKING	4
85	XBHZZ	28480	08642-00157	COVER, ACCESS	1
86	XBHZZ	28480	08642-60133	CIRCUIT CARD ASSY	1
87	PAHZZ	83014	HNST4-250-1	POST, ELECTRICAL-MEC	4
88	XBHZZ	28480	08642-00092	STRAP, ESD GROUNDING	1
89	XBHZZ	28480	08642-60082	COVER, ACCESS	1
90	PAHZZ	28520	DP562	BUTTON, PLUG	2
91	PAHZZ	81349	M39012/21-0002	CONNECTOR, RECEPTAC	2
92	PAHZZ	73734	9002	NUT, PLAIN, HEXAGON	3
93	PAHZZ	78189	1920-02	WASHER, LOCK	5
94	PAHZZ	79963	720-380H	TERMINAL, LUG	2
95	PAHZZ	28480	08642-60057	CABLE ASSEMBLY, RADI	1
96	PAHZZ	28480	6960-0027	PLUG, PROTECTIVE, DUS	1
97	PAHZZ	28520	2643BLK	BUTTON, PLUG	1

## SECTION II TM11-6625-3165-24P

(1) ITEM NO	(2) SMR CODE	(3) FSCM	(4) PART NUMBER	(5) DESCRIPTION AND USABLE ON CODE (UOC)	(6) QTY
98	PAHZZ	28480	0515-0604	SCREW,MACHINE	2
99	PAOZZ	28480	5061-9689	PARTS KIT,ELECTRONI	1
100	PAOZZ	24342	12201	CABLE ASSEMBLY,POWE	1
101	XBHZZ	28480	08642-00138	PLATE,INFORMATION	1
102	PAOZZ	28480	5040-7202	TRIM, TOP	1
103	XBHZZ	28480	08642-00169	COVER, TOP	1
104	XBHZZ	28480	08642-60957	STRUT, CORNER	1
105	XBHZZ	28480	08642-00152	COVER, SIDE	1
106	XBHZZ	28480	5001-5531	STRIP, RFI SHIELD	4
107	XBHZZ	28480	5021-5803	FRAME, FRONT	1
108	PAOZZ	28480	5040-7201	BUMPER, PLASTIC	4
109	XBHZZ	28480	08642-61002	COVER, BOTTOM	1
110	PAOZZ	28480	1460-1345	CLIP, RETAINING	2
111	PAOZZ	28480	5041-6819	RETAINER, HANDLE	1
112	PAOZZ	28480	5001-0439	PAD, CUSHIONING	2
113	PAOZZ	28480	5060-9805	STRAP HANDLE	1
114	XBHZZ	28480	5060-9881	COVER, SIDE	1
115	XBHZZ	28480	5021-5838	STRUT, CORNER	3
116	PAHDD	28480	08642-69891	MEMORY MODULE CONTRACTOR REPAIR REQUIRES EXCHANGE AND NEW A20 CAL CARD DATA	1
117	PAHZZ	28480	0515-0655	SCREW,MACHINE	9
118	PAHZZ	28480	08642-60060	CABLE ASSEMBLY,RADI	1
119	PAHZZ	28480	08642-60093	GENERATOR,PULSE	1
120	PAHZZ	73734	31-550	WASHER, FLAT	1
121	XBHZZ	28480	08642-20073	SUPPORT, COVER	1
122	PAHZZ	28480	0515-1102	SCREW,MACHINE	42
123	XBHZZ	28480	08642-40031	SUPPORT,CIRCUIT CD	3
124	PAHZZ	28480	3050-0891	WASHER, FLAT	5
125	XBHZZ	28480	08642-00186	PLATE,ELEC SHIELD	1
126	PAHZZ	28480	0515-1227	SCREW,MACHINE	14
127	PAHZZ	28480	2190-0584	WASHER, LOCK	2
128	XBHZZ	28480	08642-00021	GUSSET	1
129	XBHZZ	28480	08642-20072	SCREW,SPECIAL	8
130	XBHZZ	28480	08642-00014	INSULATOR, PLATE	1
131	PAHZZ	28480	08642-60126	CIRCUIT CARD ASSEMB	1
132	PAHZZ	28480	08642-60013	CABLE ASSEMBLY,SPEC	1
133	PAHZZ	28480	08642-60012	CABLE ASSEMBLY,SPEC	1
134	PAHZZ	28480	0515-0684	SCREW,MACHINE	5
135	XBHZZ	28480	08642-00015	SUPPORT,MAIN BRACE	1
136	XBHZZ	28480	08642-40030	GUIDE,CIRCUIT CARD	1
137	XBHZZ	28480	08642-00079	BRACKET, MTG, GUIDE	1
138	PAHZZ	28480	0515-1127	SCREW,MACHINE	5
139	XBHZZ	28480	08642-40032	SUPPORT,CIRCUIT CD	6
140	XBHZZ	28480	08642-00170	INSULATOR, PLATE	1
141	XBHZZ	28480	08642-00140	INSULATOR, PLATE	1
142	XBHZZ	28480	08642-00011	PLATE,ELEC SHIELD	1
143	PAHDD	28480	08642-69892	LATCH MODULE CONTRACTOR REPAIR REQUIRES EXCHANGE	1
144	PAHDD	28480	08642-69849	OUTPUT FILTER MODUL CONTRACTOR REPAIR REQUIRES EXCHANGE AND NEW A20 CAL CARD DATA	1

## SECTION II TM11-6625-3165-24P

(1) ITEM NO	(2) SMR CODE	(3) FSCM	(4) PART NUMBER	(5) DESCRIPTION AND USABLE ON CODE (UOC)	(6) QTY
145	PAHDD	28480	08642-69897	SUM LOOP MODULE CONTRACTOR REPAIE REQUIRES EXCHANGE AND NEW A20 CAL CARD DATA	1
146	PAHDD	28480	08642-69896	REFERENCE LOOP MODU CONTRACTOR REPAIR REQUIRES EXCHANGE AND NEW A20 CAL CARD DATA	1
147	PAHDD	28480	08642-69895	IF LOOP MODULE CONTRACTOR REPAIR REQUIRES EXCHANGE	1
148	XBHZZ	28480	0380-1362	POST,ELEC-MECH EQPT	10
149	PAHZZ	28480	08642-60058	CABLE ASSEMBLY,RADI	1
150	PAHZZ	28480	08642-60059	CABLE ASSEMBLY,RADI	1
151	XBHZZ	28480	08642-00008	PANEL,FRONT	1
152	PAHZZ	28480	08642-60011	CABLE ASSEMBLY,SPEC	1
153	PAHDD	28480	08642-69889	KEYBOARD MODULE CONTRACTOR REPAIR REQUIRES EXCHANGE	1
154	PAHZZ	28480	0535-0004	NUT,PLAIN,HEXAGON	10
155	XBHZZ	28480	08642-00123	PLATE,INFORMATION	4
156	XBHZZ	28480	08642-00009	HINGE,FRONT PANEL	1
157	XBHZZ	28480	08642-20040	WASHER,SHOULDERED	3
158	PAHZZ	28480	0515-1331	SCREW,MACHINE	16
159	XBHZZ	28480	08642-00078	BRACKET,MTG,GUIDE	1
160	PAHZZ	28480	0515-1134	SCREW,MACHINE	1
161	XBHZZ	28480	08642-40029	GUIDE,CIRCUIT CARD	1
162	PAHZZ	28480	0515-0682	SCREW,MACHINE	1
163	XBHZZ	28480	08642-00066	CLAMP,LOOP	1
164	PAHZZ	28480	0515-0683	SCREW,MACHINE	1
165	PAHZZ	28480	0515-1135	SCREW,MACHINE	1
166	XBHZZ	28480	08642-00086	SLIDE,RIBBON CABLE	2
167	XBHZZ	28480	08642-00125	GUIDE,TUBULAR	1
168	XBHZZ	28480	08642-60080	BRACE ASSEMBLY	1
169	PAHDD	28480	08642-69894	SAWR LOOP MODULE CONTRACTOR REPAIR REQUIRES EXCHANGE	1
170	PAHDD	28480	08642-69893	FM LOOP MODULE CONTRACTOR REPAIR REQUIRES EXCHANGE AND NEW A20 CAL CARD DATA	1
171	PAHZZ	31827	3-4-1	CLAMP,LOOP	1
172	PAHZZ	83014	HN3P34-4-1	STUD,SELF-LOCKING	1
173	PAHZZ	83014	HN3G33-1	GROMMET,NONMETALLIC	1
174	PAHZZ	85480	F4NY-125NA	CLAMP,LOOP	3
175	XBHZZ	28480	08642-40046	GUIDE,MODULE	2
176	PAHZZ	28480	0515-1103	SCREW,MACHINE	30
177	XBHZZ	28480	08642-60068	SHOCK BOX ASSEMBLY	1
178	PAHZZ	81860	6821-2DN	MOUNT,RESILIENT	4
179	PAHZZ	28480	0515-1138	SCREW,MACHINE	8
180	XBHZZ	28480	0380-0010	SPACER,SLEEVE	4
181	PAHZZ	28480	0515-1140	SCREW,MACHINE	4
182	XBHZZ	28480	08642-00080	LIMITER,SHOCK	2
183	XBHZZ	28480	08642-00171	RETAINER,XMFR	1
184	PAHZZ	28480	9100-4417	TRANSFORMER,POWER	1
185	XBHZZ	28480	7120-4296	PLATE,INFORMATION	2
186	XBHZZ	28480	08642-60089	BRACE ASSEMBLY	1
187	PAHZZ	78189	1908-00	WASHER,LOCK	3

## SECTION II TM11-6625-3165-24P

(1) ITEM NO	(2) SMR CODE	(3) FSCM	(4) PART NUMBER	(5) DESCRIPTION AND USABLE ON CODE (UOC)	(6) QTY
188	PAHZZ	28480	08642-00116	COVER, ACCESS	6
189	PAHZZ	96906	MS35489-1	GROMMET, NONMETALLIC	1
190	XBHZZ	28480	08642-00028	BRACKET, MTG, CONN	1
191	XBHZZ	28480	08642-00031	BRACKET, MOUNTING	1
192	PAHZZ	96906	MS35489-4	GROMMET, NONMETALLIC	1
193	XBHZZ	28480	08642-00089	PLATE, AIR SEAL	1
194	XBHZZ	28480	08642-00020	GUSSET	1
195	XBHZZ	28480	08642-60086	BRACE ASSEMBLY	1
196	PAHZZ	59730	TYB23M8	STRAP, TIEDOWN, ELECT	52
197	XBHZZ	28480	08642-40034	GUIDE, MODULE	14
198	PAHZZ	00779	500001-2	TUBING, PLASTIC, SPIR	1
199	PAHZZ	28480	0515-1228	SCREW, MACHINE	3
200	XBHZZ	28480	08642-20037	SUPPORT, BRACKET	1
201	PAHZZ	K1793	G51PC	NONMETALLIC CHANNEL	1
202	XBHZZ	28480	08642-60143	COVER, ACCESS	1
203	PAHDD	28480	08642-60850	DOUBLER MODULE CONTRACTOR REPAIR REQUIRES EXCHANGE AND NEW A20 CAL CARD DATA	1
204	PAHDD	28480	08642-69899	HETERODYNE MODULE CONTRACTOR REPAIR REQUIRES EXCHANGE AND NEW A20 CAL CARD DATA	1
205	XBHZZ	28480	08642-00150	SPACER, PLATE	1
206	XBHZZ	28480	08642-00104	BRACKET, MOUNTING	1
207	PAHZZ	96906	MS35333-105	WASHER, LOCK	7
208	PAHDD	28480	08642-69844	POWER SUPPLY MODULE CONTRACTOR REPAIR REQUIRES EXCHANGE	1
209	PAHZZ	28480	08642-20044	CABLE ASSEMBLY, RADI	1
210	PAHDL	28480	08642-69843	POWER SUPPLY MODULE CONTRACTOR REPAIR REQUIRES EXCHANGE	1
211	PAHZZ	28480	08642-60021	CABLE ASSEMBLY, SPEC	1
212	PAHZZ	28480	08642-60020	CABLE ASSEMBLY, SPEC	1
213	PAHZZ	28480	08642-60019	CABLE ASSEMBLY, SPEC	1
214	PAHZZ	28480	08642-60018	CABLE ASSEMBLY, SPEC	1
215	PAHZZ	28480	08642-60010	CABLE ASSEMBLY, SPEC	1
216	XBHZZ	28480	08642-40070	RETAINER, CABLE	6
217	PAHZZ	28480	08642-60017	CABLE ASSEMBLY, SPEC	1
218	PAHZZ	28480	08642-60016	CABLE ASSEMBLY, SPEC	1
219	PAHZZ	28480	08642-60036	CABLE ASSEMBLY, SPEC	1
220	PAHZZ	28480	08642-60062	CABLE ASSEMBLY, RADI	1
221	PAHZZ	28480	08642-60052	CABLE ASSEMBLY, RADI	1
222	PAHZZ	28480	08642-60053	CABLE ASSEMBLY, RADI	1
223	PAHZZ	28480	08642-60064	CABLE ASSEMBLY, RADI	1
224	PAHZZ	28480	08642-60015	CABLE ASSEMBLY, SPEC	1
225	PAHZZ	28480	08642-60051	CABLE ASSEMBLY, RADI	1
226	PAHZZ	28480	08642-60054	CABLE ASSEMBLY, RADI	1
227	PAHZZ	28480	08642-60035	CABLE ASSEMBLY, RADI	1
228	PAHZZ	28480	08642-60039	CABLE ASSEMBLY, RADI	1
229	PAHZZ	28480	08642-60014	CABLE ASSEMBLY, SPEC	1
230	PAHZZ	28480	08642-60038	CABLE ASSEMBLY, SPEC	1
231	PAHZZ	28480	08642-60063	CABLE ASSEMBLY, RADI	1
232	PAHZZ	28480	08642-20054	CABLE ASSEMBLY, RADI	1
233	PAHZZ	28480	08642-60037	CABLE ASSEMBLY, RADI	1

## SECTION II TM11-6625-3165-24P

(1) ITEM NO	(2) SMR CODE	(3) FSCM	(4) PART NUMBER	(5) DESCRIPTION AND USABLE ON CODE (UOC)	(6) QTY
234	PAHZZ	28480	08642-60061	CABLE ASSEMBLY, RADI	1
235	PAHZZ	28480	08642-20095	CABLE ASSEMBLY, RADI	1
236	PAHZZ	28480	08642-20094	CABLE ASSEMBLY, RADI	1
237	PAHZZ	28480	08642-60023	CABLE ASSEMBLY, SPEC	1

END OF FIGURE



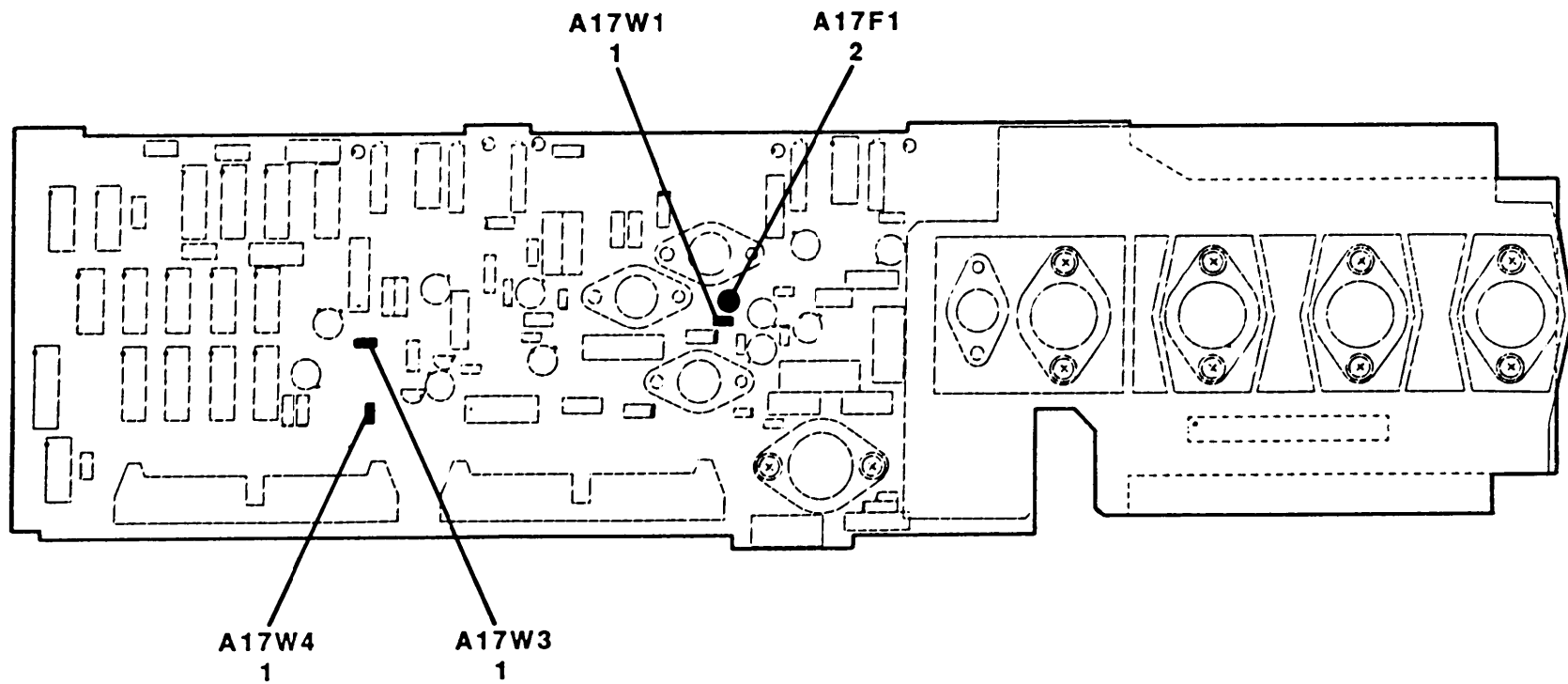

TM 11-6625-3165-24P

Figure 2. Power Supply/Regulator/Attenuator Drivers Module.

CE0WR020



SECTION II TM11-6625-3165-24P

(1) ITEM NO	(2) SMR CODE	(3) FSCM	(4) PART NUMBER	(5) DESCRIPTION AND USABLE ON CODE (UOC)	(6) QTY
				GROUP 0012 POWER SUPPLY/REGULATOR/ ATTENUATOR DRIVERS MODULE(A17)	
				FIGURE 2	
1	PAHZZ	00779	531220-2	RESISTOR, FIXED	3
2	PAHZZ	81349	FM01A125V1A	FUSE, CARTRIDGE	1
				END OF FIGURE	

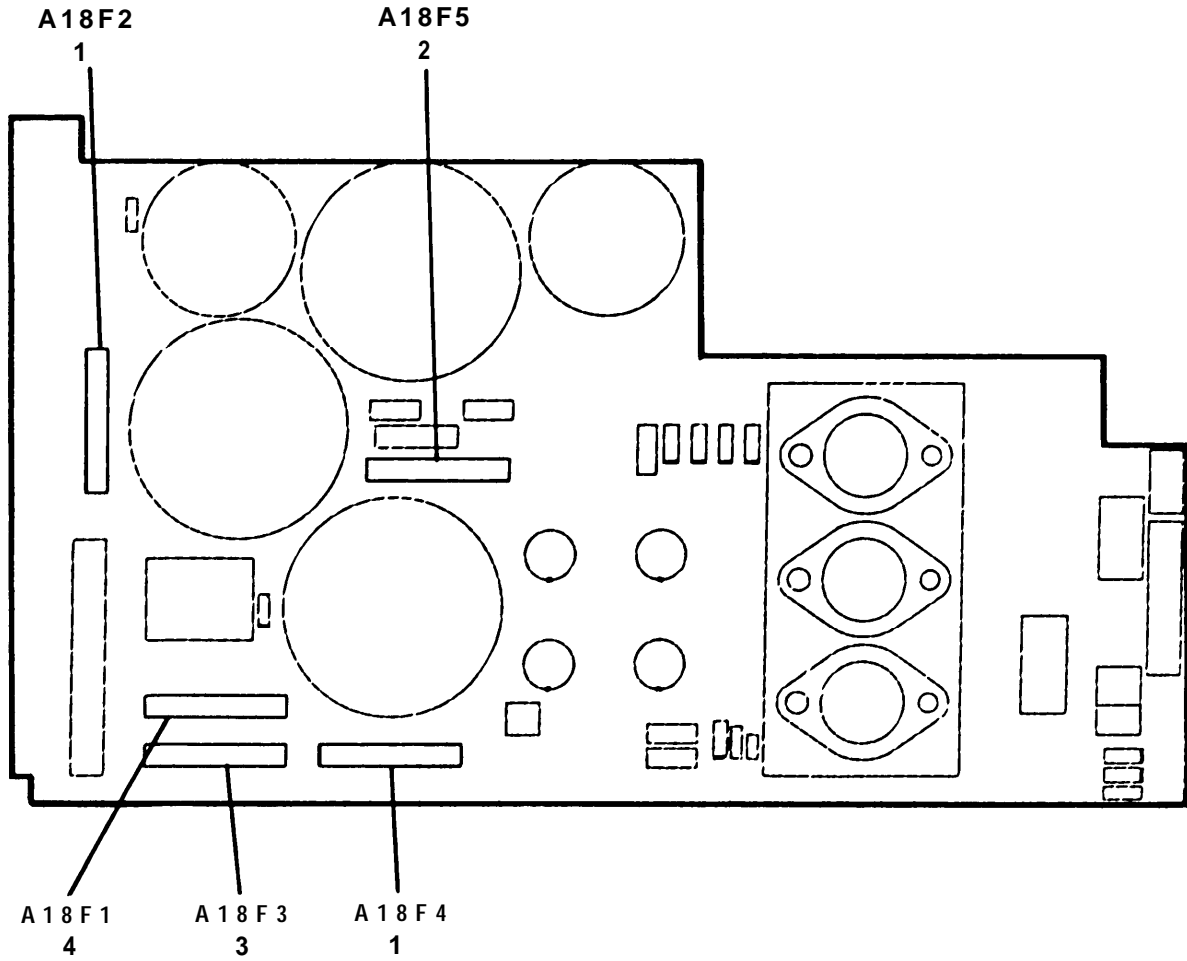
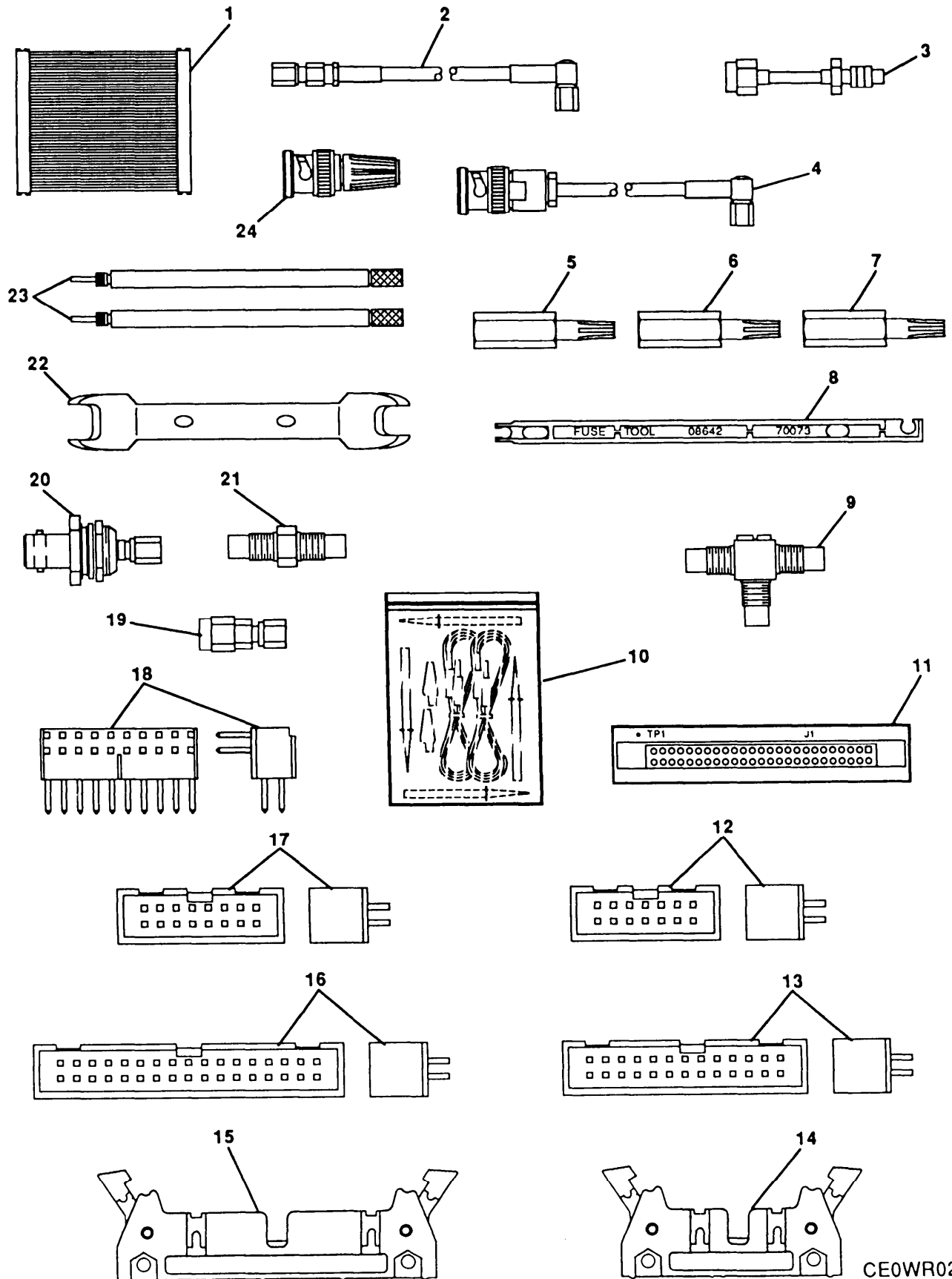

Figure 3. Power Supply/Rectifier/Filter Module.

SECTION II      TM11-6625-3165-24P

(1) ITEM NO	(2) SMR CODE	(3) FSCM	(4) PART NUMBER	(5) DESCRIPTION AND USABLE ON CODE (UOC)	(6) QTY
				GROUP 0013 POWER SUPPLY/RECTIFIER/ FILTER MODULE(A18)	
				FIGURE 3	
1	PAHZZ	81349	F02A250V2A	FUSE, CARTRIDGE	2
2	PAHZZ	81349	F02A250V1/4A	FUSE, CARTRIDGE	1
3	PAHZZ	81349	F02A125V8A	FUSE, CARTRIDGE	1
4	PAHZZ	81349	F02A250V5A	FUSE, CARTRIDGE	1
				END OF FIGURE	



CE0WR022

Figure 4. Special Tools for General Support Maintenance.

(1) ITEM NO	(2) SMR CODE	(3) FSCM	(4) PART NUMBER	(5) DESCRIPTION AND USABLE ON CODE (UOC)	(6) QTY
GROUP 99 SPECIAL TOOLS FOR GENERAL SUPPORT MAINTENANCE					
FIGURE 4					
BOI: 1 EA PER EQUIPMENT					
1	PAHZZ	28480	08642-60959	CABLE ASSEMBLY, SPEC	4
2	PAHZZ	28480	08662-60080	CABLE ASSEMBLY, RADI	4
3	PAHZZ	28480	08642-20082	CABLE ASSEMBLY, RADI	4
4	PAHZZ	28480	08662-60075	CABLE ASSEMBLY, RADI	4
5	PAHZZ	03705	440TX15	TOOL, TORX DRIVE	4
6	PAHZZ	03705	440TX10	TOOL, TORX DRIVE	4
7	PAHZZ	03705	440TX05	TOOL, TORX DRIVE	4
8	PAHZZ	28480	08642-40073	EXTRACTOR, FUSE	4
9	PAHZZ	98291	50-083-0000	ADAPTER, CONNECTOR	4
10	PAHZZ	28480	34118A	TEST LEAD KIT	4
11	PAHZZ	28480	08642-80053	BOARD ASSEMBLY TEST	4
12	PAHZA	75037	3598-6002	CONNECTOR, RECEPTACL	4
13	PAHZA	75037	3593-6002	CONNECTOR, RECEPTACL	4
14	PAHZZ	75037	3433-1202	CONNECTOR, RECEPTACL	4
14	PAHZA	75037	3593-6002	CONNECTOR, RECEPTACL	4
15	PAHZA	75037	3593-6002	CONNECTOR, RECEPTACL	4
16	PAHZA	75037	3594-6002	CONNECTOR, RECEPTACL	4
17	PAHZZ	75037	3599-6002	CONNECTOR	4
18	PAHZA	27264	10-91-1201	CONNECTOR, RECEPTACL	4
19	PAHZA	98291	50-073-6200-31	ADAPTER, CONNECTOR	4
20	PAHZZ	98291	50-077-6801	ADAPTER, CONNECTOR	4
21	PAHZA	98291	050-072-0000-220	ADAPTER, CONNECTOR,	4
22	PAHZZ	28480	08642-00070	WRENCH, RADIO, FREQUE	4
23	PAHZZ	28480	08642-20041	POST, ELECTRICAL-MEC	4
24	PAHZZ	28480	5021-0844	ADAPTER, CONNECTOR	4

END OF FIGURE



## SECTION IV

TM 11-6625-3165-24P

## NATIONAL STOCK NUMBER AND PART NUMBER INDEX

NATIONAL STOCK NUMBER INDEX					
STOCK NUMBER	FIG.	ITEM	STOCK NUMBER	FIG.	ITEM
5920-00-010-6652	1	68	5975-01-181-0232	1	7
5310-00-019-0669	1	207	5935-01-191-9892	1	27
5310-00-019-0670	1	187	5340-01-195-4926	1	178
5920-00-043-2641	3	2	5340-01-202-6652	1	113
5940-00-127-9997	1	66	6625-01-220-3003	1	99
5325-00-174-5317	1	192	6625-01-234-7171	1	112
5340-00-253-3413	1	171	6625-01-234-7180	1	75
5310-00-269-6498	1	57	5305-01-239-0603	1	73
5920-00-280-4960	1	67	5305-01-239-1280	1	74
	3	1	5305-01-239-1283	1	158
5920-00-284-6787	3	4	5930-01-244-7753	1	36
5325-00-286-6047	1	189	6625-01-248-6775	1	210
5310-00-401-6931	1	93	6625-01-248-6776	1	208
5340-00-407-2813	1	174	6625-01-248-6777	1	144
5310-00-778-2758	1	56	6625-01-248-6778	1	203
5935-00-828-0700	4	9	6625-01-248-6779	1	153
5935-00-853-7596	1	91	6625-01-248-6780	1	26
5310-00-878-2193	1	92	6625-01-248-6781	1	116
5920-00-901-9938	2	2	6625-01-248-6782	1	143
5935-00-920-6183	4	20	6625-01-248-6783	1	169
7330-00-980-1419	1	198	6625-01-248-6784	1	147
5920-01-013-2389	3	3	6625-01-248-6785	1	146
5940-01-016-5118	1	94	6625-01-248-6786	1	145
5340-01-062-6736	1	110	6625-01-248-6787	1	204
5340-01-063-2862	1	108	6625-01-248-7612	1	170
5340-01-064-1897	1	72	5995-01-250-8727	1	213
5915-01-982-5158	1	69	5995-01-250-8728	1	237
5325-01-096-5569	1	83	5930-01-250-8924	1	6
6150-01-111-1717	1	100	5995-01-250-9528	1	228
6625-01-118-8222	1	102	5995-01-250-9529	1	225
5340-01-121-8277	1	96	6625-01-251-0094	4	10
5930-01-130-9310	1	44	5930-01-251-0104	1	8
5330-01-130-9311	1	41	5930-01-251-0105	1	10
5930-01-130-9312	1	42	5930-01-251-0106	1	10
5930-01-130-9313	1	40	6625-01-251-0115	1	119
5930-01-130-9314	1	38	5995-01-251-0346	1	215
5930-01-130-9315	1	14	5995-01-251-0347	1	133
5930-01-130-9316	1	17	5995-01-251-0348	1	132
5930-01-130-9317	1	18	5995-01-251-0349	1	217
5930-01-130-9318	1	15	5995-01-251-0350	1	214
5930-01-130-9319	1	16	5995-01-251-0351	1	212
5930-01-130-9320	1	43	5995-01-251-0352	4	3
5930-01-130-9321	1	22	5995-01-251-0353	4	4
5975-01-130-9327	1	9	5995-01-251-0354	4	2
5306-01-134-6916	1	58	5995-01-251-0355	1	209
5340-01-135-3719	1	90	5995-01-251-0356	1	232
5930-01-142-6165	1	1	5995-01-251-0357	1	236
5325-01-157-3481	1	173	5995-01-251-0358	1	235
5975-01-169-0839	1	45	5995-01-251-0359	1	233
5355-01-169-6348	1	35	5995-01-251-0360	1	221

## NATIONAL STOCK NUMBER AND PART NUMBER INDEX

STOCK NUMBER	NATIONAL STOCK NUMBER INDEX		STOCK NUMBER	FIG.	ITEM
	FIG.	ITEM			
5995-01-251-0361	1	222	5935-01-252-1416	4	12
5995-01-251-0362	1	226	6625-01-252-7052	4	24
5995-01-251-0363	1	55	5305-01-253-9803	1	160
5995-01-251-0364	1	95	5305-01-253-9804	1	165
5995-01-251-0365	1	149	5305-01-254-0845	1	82
5995-01-251-0366	1	150	5305-01-254-1343	1	117
5995-01-251-0367	1	118	5305-01-254-1344	1	134
5995-01-251-0368	1	234	5305-01-254-1345	1	78
5995-01-251-0369	1	220	5305-01-254-1346	1	29
5995-01-251-0370	1	231	5305-01-254-1347	1	122
5995-01-251-0371	1	223	5305-01-254-1348	1	176
5995-01-251-0424	1	152	5305-01-254-1349	1	179
5995-01-251-0425	1	229	5305-01-254-1350	1	181
5995-01-251-0426	1	224	5305-01-254-1351	1	199
5930-01-251-0504	1	3	5305-01-254-5397	1	30
5930-01-251-0505	1	13	5305-01-254-5398	1	164
5930-01-251-0506	1	49	5305-01-254-7252	1	126
5930-01-251-0507	1	47	5120-01-255-4508	4	8
5930-01-251-0508	1	50	5305-01-256-0404	1	81
5930-01-251-0509	1	52	5120-01-256-0537	4	22
5930-01-251-0510	1	48			
5930-01-251-0511	1	23			
5930-01-251-0512	1	39			
5930-01-251-0513	1	53			
5930-01-251-0514	1	21			
5930-01-251-0515	1	46			
5930-01-251-0516	1	12			
5930-01-251-0517	1	19			
5930-01-251-0518	1	20			
5930-01-251-0519	1	37			
5930-01-251-0520	1	5			
5930-01-251-0521	1	24			
5999-01-251-0538	1	60			
4140-01-251-1429	1	80			
5930-01-251-1476	1	4			
5930-01-251-1477	1	54			
5930-01-251-1478	1	51			
5999-01-251-1537	1	131			
5995-01-251-2457	1	230			
5995-01-251-3093	1	218			
5935-01-251-5044	4	16			
5950-01-251-7022	1	184			
5935-01-251-8042	4	18			
5935-01-252-0215	4	21			
5935-01-252-0216	4	19			
5935-01-252-0231	4	13			
	4	14			
	4	15			
5340-01-252-1347	4	23			
5340-01-252-1348	1	87			



## NATIONAL STOCK NUMBER AND PART NUMBER INDEX

FSCM	PART NUMBER	PART NUMBER INDEX	
		STOCK NUMBER	FIG. ITEM
28520	DP562	5340-01-135-3719	1 90
81349	FM01A125V1A	5920-00-901-9938	2 2
81349	F02A125V8A	5920-01-013-2389	3 3
81349	F02A250V1/4A	5920-00-043-2641	3 2
81349	F02A250V2A	5920-00-280-4960	1 67
			3 1
81349	F02A250V3A	5920-00-010-6652	1 68
81349	F02A250V5A	5920-00-284-6787	3 4
05245	F1927	5915-01-082-5158	1 69
85480	F4NY-125NA	5340-00-407-2813	1 174
K1793	G51PC		1 201
83014	HNST4-250-1	5340-01-252-1348	1 87
83014	HN3G33-1	5325-01-157-3481	1 173
83014	HN3P34-4-1		1 172
83014	HN4G43-1	5325-01-096-5569	1 83
83014	HN4643-4-1		1 84
96906	MS35333-105	5310-00-019-0669	1 207
96906	MS35333-112	5310-00-778-2758	1 56
96906	MS35489-1	5325-00-286-6047	1 189
96906	MS35489-4	5325-00-174-5317	1 192
81349	M39012/21-0002	5935-00-853-7596	1 91
59730	TYB23M8		1 196
27264	02-05-5204		1 65
28480	0370-2389	5355-01-169-6348	1 35
28480	0380-0010		1 180
28480	0380-1180	5306-01-134-6916	1 58
28480	0380-1362		1 148
98291	050-072-0000-220	5935-01-252-0215	4 21
98291	050-675-0469-89	5935-01-191-9892	1 27
28480	0510-1253		1 62
28480	0515-0373		1 79
28480	0515-0381	5305-01-256-0404	1 81
28480	0515-0604		1 98
28480	0515-0655	5305-01-254-1343	1 117
28480	0515-0680	5305-01-254-5397	1 30
28480	0515-0682		1 162
28480	0515-0683	5305-01-254-5398	1 164
28480	0515-0684	5305-01-254-1344	1 134
28480	0515-1082	5305-01-254-1345	1 78
28480	0515-1101	5305-01-254-1346	1 29
28480	0515-1102	5305-01-254-1347	1 122
28480	0515-1103	5305-01-254-1348	1 176
28480	0515-1127		1 138
28480	0515-1132	5305-01-239-1280	1 74
28480	0515-1134	5305-01-253-9803	1 160
28480	0515-1135	5305-01-253-9804	1 165
28480	0515-1138	5305-01-254-1349	1 179
28480	0515-1140	5305-01-254-1350	1 181
28480	0515-1142	5305-01-254-0845	1 82
28480	0515-1227	5305-01-254-7252	1 126
28480	0515-1228	5305-01-254-1351	1 199

## SECTION IV

TM11-6625-3165-24P

## NATIONAL STOCK NUMBER AND PART NUMBER INDEX

FSCM	PART NUMBER	PART NUMBER INDEX STOCK NUMBER	FIG.	ITEM
28480	0515-1232	5305-01-239-0603	1	73
28480	0515-1245		1	61
28480	0515-1331	5305-01-239-1283	1	158
28480	0535-0004		1	154
28480	0590-1251		1	33
28480	0837-0366		1	70
28480	08642-00008		1	151
28480	08642-00009		1	156
28480	08642-00010		1	28
28480	08642-00011		1	142
28480	08642-00014		1	130
28480	08642-00015		1	135
28480	08642-00020		1	194
28480	08642-00021		1	128
28480	08642-00028		1	190
28480	08642-00031		1	191
28480	08642-00066		1	163
28480	08642-00070	5120-01-256-0537	4	22
28480	08642-00078		1	159
28480	08642-00079		1	137
28480	08642-00080		1	182
28480	08642-00086		1	166
28480	08642-00089		1	193
28480	08642-00092		1	88
28480	08642-00104		1	206
28480	08642-90116		1	188
28480	08642-00123		1	155
28480	08642-00125		1	167
28480	08642-00138		1	101
28480	08642-00139		1	34
28480	08642-00140		1	141
28480	08642-00150		1	205
28480	08642-00152		1	105
28480	08642-00157		1	85
28480	08642-00169		1	103
28480	08642-00170		1	140
28480	08642-00171		1	183
28480	08642-00176		1	25
28480	08642-00186		1	125
28480	08642-20037		1	200
28480	08642-20040		1	157
28480	08642-20041	5340-01-252-1347	4	23
28480	08642-20044	5995-01-251-0355	1	209
28480	08642-20054	5995-01-251-0356	1	232
28480	08642-20072		1	129
28480	08642-20073		1	121
28480	08642-20082	5995-01-251-0352	1	3
28480	08642-20094	5995-01-251-0357	1	236
28480	08642-20095	5995-01-251-0358	1	235
28480	08642-40029		1	161
28480	08642-40030		1	136

## NATIONAL STOCK NUMBER AND PART NUMBER INDEX

FSCM	PART NUMBER	PART NUMBER INDEX	
		STOCK NUMBER	FIG. ITEM
28480	08642-40031		1 123
28480	08642-40032		1 139
28480	08642-40034		1 197
28480	08642-40046		1 175
28480	08642-40070		1 216
28480	08642-40072		1 32
28480	08642-40073	5120-01-255-4508	4 8
28480	08642-60010	5995-01-251-0346	1 215
28480	08642-60011	5995-01-251-0424	1 152
28480	08642-60012	5995-01-251-0347	1 133
28480	08642-60013	5995-01-251-0348	1 132
28480	08642-60014	5995-01-251-0425	1 229
28480	08642-60015	5995-01-251-0426	1 224
28480	08642-60016	5995-01-251-3093	1 218
28480	08642-60017	5995-01-251-0349	1 217
28480	08642-60018	5995-01-251-0350	1 214
28480	08642-60019	5995-01-250-8727	1 213
28480	08642-60020	5995-01-251-0351	1 212
28480	08642-60021		1 211
28480	08642-60023	5995-01-250-8728	1 237
28480	08642-60035		1 227
28480	08642-60036		1 219
28480	08642-60037	5995-01-251-0359	1 233
28480	08642-60038	5995-01-251-2457	1 230
28480	08642-60039	5995-01-250-9528	1 228
28480	08642-60051	5995-01-250-9529	1 225
28480	08642-60052	5995-01-251-0360	1 221
28480	08642-60053	5995-01-251-0361	1 222
28480	08642-60054	5995-01-251-0362	1 226
28480	08642-60056	5995-01-251-0363	1 55
28480	08642-60057	5995-01-251-0364	1 95
28480	08642-60058	5995-01-251-0365	1 149
28480	08642-60059	5995-01-251-0366	1 150
28480	08642-60060	5995-01-251-0367	1 118
28480	08642-60061	5995-01-251-0368	1 234
28480	08642-60062	5995-01-251-0369	1 220
28480	08642-60063	5995-01-251-0370	1 231
28480	08642-60064	5995-01-251-0371	1 223
28480	08642-60068		1 177
28480	08642-60080		1 168
28480	08642-60082		1 89
28480	08642-60086		1 195
28480	08642-60089		1 186
28480	08642-60093	6625-01-251-0115	1 119
28480	08642-60126	5999-01-251-1537	1 131
28480	08642-60129	5999-01-251-0538	1 60
28480	08642-60133		1 86
28480	08642-60143		1 202
28480	08642-60197		1 59
28480	08642-60850	6625-01-248-6778	1 203
28480	08642-60956		1 71

## NATIONAL STOCK NUMBER AND PART NUMBER INDEX

FSCM	PART NUMBER	PART NUMBER INDEX	
		STOCK NUMBER	FIG. ITEM
28480	08642-60957		1 104
28480	08642-60959		4 1
28480	08642-61002		1 109
28480	08642-69843	6625-01-248-6775	1 210
28480	08642-69844	6625-01-248-6776	1 208
28480	08642-69849	6625-01-248-6777	1 144
28480	08642-69889	6625-01-248-6779	1 153
28480	08642-69890	6625-01-248-6780	1 26
28480	08642-69891	6625-01-248-6781	1 116
28480	08642-69892	6625-01-248-6782	1 143
28480	08642-69893	6625-01-248-7612	1 170
28480	08642-69894	6625-01-248-6783	1 169
28480	08642-69895	6625-01-248-6784	1 147
28480	08642-69896	6625-01-248-6785	1 146
28480	08642-69897	6625-01-248-6786	1 145
28480	08642-69899	6625-01-248-6787	1 204
28480	08642-80019	4140-01-251-1429	1 80
28480	08642-80053		4 11
28480	08662-60075	5995-01-251-0353	4 4
28480	08662-60080	5995-01-251-0354	4 2
27264	10-91-1201	5935-01-251-8042	4 18
53655	11-341LN	5310-00-269-6498	1 57
24342	12201	6150-01-111-1717	1 100
28480	1460-1345	5340-01-062-6736	1 110
78189	1908-00	5310-00-019-0670	1 187
78189	1920-02	5310-00-401-6931	1 93
27264	2125	5940-00-127-9997	1 66
28480	2190-0584		1 127
28520	2643BLK		1 97
06540	2711-21562PHF169 -30		1 77
31827	3-4-1	5340-00-253-3413	1 171
28480	3050-0891		1 124
73734	31-550		1 120
28480	34118A	6625-01-251-0094	4 10
75037	3433-1202		4 14
75037	3593-6002	5935-01-252-0231	4 13
			4 14
			4 15
75037	3594-6002	5935-01-251-5044	4 16
75037	3598-6002	5935-01-252-1416	4 12
75037	3599-6002		4 17
03705	440TX05		4 7
03705	440TX10		4 6
03705	440TX15		4 5
98291	50-073-6200-31	5935-01-252-0216	4 19
98291	50-077-6801	5935-00-920-6183	4 20
98291	50-083-0000	5935-00-828-0700	4 9
00779	500001-2	9330-00-980-1419	1 198
28480	5001-0439	6625-01-234-7171	1 112
28480	5001-5531		1 106

## NATIONAL STOCK NUMBER AND PART NUMBER INDEX

FSCM	PART NUMBER	PART NUMBER INDEX	
		STOCK NUMBER	FIG. ITEM
28480	5021-0844	6625-01-252-7052	4 24
28480	5021-5803		1 107
28480	5021-5838		1 115
28480	5040-7201	5340-01-063-2862	1 108
28480	5040-7202	6625-01-118-8222	1 102
28480	5040-7221	5340-01-064-1897	1 72
28480	5041-0095	5975-01-169-0839	1 45
28480	5041-0720	5930-01-251-0504	1 3
28480	5041-0775	5930-01-130-9310	1 44
28480	5041-0808	5930-01-130-9311	1 41
28480	5041-0811	5930-01-130-9312	1 42
28480	5041-0812	5930-01-130-9313	1 40
28480	5041-0813	5930-01-130-9314	1 38
28480	5041-0814	5930-01-130-9315	1 14
28480	5041-0815	5930-01-130-9316	1 17
28480	5041-0816	5930-01-130-9317	1 18
28480	5041-0817	5930-01-130-9318	1 15
28480	5041-0818	5930-01-130-9319	1 16
28480	5041-0819	5930-01-130-9320	1 43
28480	5041-0855	5930-01-130-9321	1 22
28480	5041-0926	5930-01-244-7753	1 36
28480	5041-0944	5930-01-142-6165	1 1
28480	5041-1749	5975-01-130-9327	1 9
28480	5041-1792	5975-01-181-0232	1 7
28480	5041-1835	5930-01-251-0505	1 13
28480	5041-2719	5930-01-251-1476	1 4
28480	5041-2720	5930-01-251-1477	1 54
28480	5041-2818	5930-01-251-0104	1 8
28480	5041-2819	5930-01-251-0105	1 10
28480	5041-2820	5930-01-251-0106	1 11
28480	5041-2823	5930-01-250-8924	1 6
28480	5041-2824	5930-01-251-1478	1 51
28480	5041-2825	5930-01-251-0506	1 49
28480	5041-2826	5930-01-251-0507	1 47
28480	5041-2827	5930-01-251-0508	1 50
28480	5041-2828	5930-01-251-0509	1 52
28480	5041-2829	5930-01-251-0510	1 48
28480	5041-2830	5930-01-251-0511	1 23
28480	5041-2832	5930-01-251-0512	1 39
28480	5041-2834	5930-01-251-0513	1 53
28480	5041-2835	5930-01-251-0514	1 21
28480	5041-2836	5930-01-251-0515	1 46
28480	5041-2837	5930-01-251-0516	1 12
28480	5041-2938	5930-01-251-0517	1 19
28480	5041-2939	5930-01-251-0518	1 20
28480	5041-2940	5930-01-251-0519	1 37
28480	5041-4537	5930-01-251-0520	1 5
28480	5041-4538	5930-01-251-0521	1 24
28480	5041-6819		1 111
28480	5041-6820	6625-01-234-7180	1 75
28480	5060-9805	5340-01-202-6652	1 113

## NATIONAL STOCK NUMBER AND PART NUMBER INDEX

FSCM	PART NUMBER	PART NUMBER INDEX STOCK NUMBER	FIG.	ITEM
28480	5060-9881		1	114
28480	5061-9689	6625-01-220-3003	1	99
00779	531220-2		2	1
86928	5710-191-20		1	31
81860	6821-2DN	5340-01-195-4926	1	178
28480	6960-0027	5340-01-121-8277	1	96
28480	7100-1115		1	76
28480	7120-1254		1	2
28480	7120-4296		1	185
28480	7120-8138		1	63
28480	7121-4815		1	64
79963	720-380H	5940-01-016-5118	1	94
73734	9002	5310-00-878-2193	1	92
28480	9100-4417	5950-01-251-7022	1	184

RECOMMENDED CHANGES TO EQUIPMENT TECHNICAL PUBLICATIONS



THEN... JOT DOWN THE DOPE ABOUT IT ON THIS FORM. CAREFULLY TEAR IT OUT. FOLD IT AND DROP IT IN THE MAIL!

SOMETHING WRONG WITH THIS PUBLICATION?

FROM (PRINT YOUR UNIT'S COMPLETE ADDRESS)  
 Commander  
 Stateside Army Depot  
 ATTN: AMSTA-US  
 Stateside, N.J. 07703-5007

DATE SENT  
 10 July 1975

PUBLICATION NUMBER  
 TM 11-5840-340-20P

PUBLICATION DATE  
 23 Jan 78

PUBLICATION TITLE  
 Radar Set AN/PRC-76

BE EXACT. PIN-POINT WHERE IT IS

PAGE NO	PARA-GRAPH	FIGURE NO	TABLE NO
33			
44		19	
45			

IN THIS SPACE TELL WHAT IS WRONG AND WHAT SHOULD BE DONE ABOUT IT:

For item 2, change the NSN to read: 5835-00-134-9186.  
 Reason: Accuracy.

Identify the cover on the junction box (item no. 5).  
 Reason: It is a separate item and is not called out on figure 19.

Add the cover of the junction box as an item in the listing for figure 19.  
 Reason: Same as above

SAMPLE

PRINTED NAME, GRADE OR TITLE AND TELEPHONE NUMBER  
 SSG I. M. DeSpirit of 999-1776

SIGN HERE

TEAR ALONG PERFORATED LINE

FILL IN YOUR  
UNIT'S ADDRESS

FOLD BACK

DEPARTMENT OF THE ARMY

\_\_\_\_\_  
\_\_\_\_\_

POSTAGE AND FEES PAID  
DEPARTMENT OF THE ARMY  
DOD 314



OFFICIAL BUSINESS  
PENALTY FOR PRIVATE USE \$300

**SAMPLE**

Commander  
US Army Communications-Electronics Command  
and Fort Monmouth  
ATTN: AMSEL-ME-MP  
Fort Monmouth, New Jersey 07703-5000

TEAR ALONG PERFORATED LINE



RECOMMENDED CHANGES TO EQUIPMENT TECHNICAL PUBLICATIONS



THEN...JOT DOWN THE DOPE ABOUT IT ON THIS FORM. CAREFULLY TEAR IT OUT. FOLD IT AND DROP IT IN THE MAIL.

SOMETHING WRONG WITH THIS PUBLICATION?

FROM: (PRINT YOUR UNIT'S COMPLETE ADDRESS)

DATE SENT

PUBLICATION NUMBER

TM 11-6625-3165-24P

PUBLICATION DATE

1 October 1987

PUBLICATION TITLE

Signal Generator SG-1207/U

BE EXACT PIN-POINT WHERE IT IS

PAGE NO.	PARA-GRAPH	FIGURE NO.	TABLE NO.

IN THIS SPACE TELL WHAT IS WRONG AND WHAT SHOULD BE DONE ABOUT IT:

11-18 UOONG PERORATED 11-18

PRINTED NAME GRADE OR TITLE AND TELEPHONE NUMBER

SIGN HERE

DA FORM 1 JUL 79 2028-2

PREVIOUS EDITIONS ARE OBSOLETE

P.S. IF YOUR OUTFIT WANTS TO KNOW ABOUT YOUR RECOMMENDATION MAKE A CARBON COPE OF THIS AND GIVE IT TO YOUR HEADQUARTERS.

FILL IN YOUR  
UNIT'S ADDRESS

FOLD BACK

DEPARTMENT OF THE ARMY

\_\_\_\_\_  
\_\_\_\_\_

OFFICIAL BUSINESS  
PENALTY FOR PRIVATE USE \$300

POSTAGE AND FEES PAID  
DEPARTMENT OF THE ARMY  
DOD 314



TEAR ALONG PERFORATED LINE

Commander  
US Army Communications-Electronics Command  
and Fort Monmouth  
ATTN: AMSEL-ME-MP  
Fort Monmouth, New Jersey 07703-5007

RECOMMENDED CHANGES TO EQUIPMENT TECHNICAL PUBLICATIONS

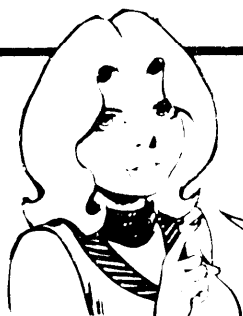

THEN...JOT DOWN THE DOPE ABOUT IT ON THIS FORM. CAREFULLY TEAR IT OUT, FOLD IT AND DROP IT IN THE MAIL.

SOMETHING WRONG WITH THIS PUBLICATION?

FROM: (PRINT YOUR UNIT'S COMPLETE ADDRESS)

DATE SENT

PUBLICATION NUMBER

TM 11-6625-3165-24P

PUBLICATION DATE

1 October 1987

PUBLICATION TITLE

Signal Generator SG-1207/U

BE EXACT PIN-POINT WHERE IT IS

PAGE NO.

PARA-GRAPH

FIGURE NO.

TABLE NO.

IN THIS SPACE TELL WHAT IS WRONG AND WHAT SHOULD BE DONE ABOUT IT:

TEAR ALONG PRIOR VERTICAL LINE

PRINTED NAME GRADE OR TITLE AND TELEPHONE NUMBER

SIGN HERE

FILL IN YOUR  
UNIT'S ADDRESS

FOLD BACK

TEAR ALONG

DEPARTMENT OF THE ARMY

\_\_\_\_\_  
\_\_\_\_\_

OFFICIAL BUSINESS  
PENALTY FOR PRIVATE USE \$300

POSTAGE AND FEES PAID  
DEPARTMENT OF THE ARMY  
DOD 314



TEAR ALONG

Commander  
US Army Communications-Electronics Command  
and Fort Monmouth  
ATTN: AMSEL-ME-MP  
Fort Monmouth, New Jersey 07703-5007



FILL IN YOUR  
UNIT'S ADDRESS

FOLD BACK

TEAR ALONG

DEPARTMENT OF THE ARMY

\_\_\_\_\_  
\_\_\_\_\_

POSTAGE AND FEES PAID  
DEPARTMENT OF THE ARMY  
DOD 314



TEAR ALONG

OFFICIAL BUSINESS  
PENALTY FOR PRIVATE USE \$300

Commander  
US Army Communications-Electronics Command  
and Fort Monmouth  
ATTN: AMSEL-ME-MP  
Fort Monmouth, New Jersey 07703-5007

By Order of the Secretary of the Army:

Official:

CARL E. VUONO  
*General, United States Army*  
*Chief of Staff*

R.L. DILWORTH  
*Brigadier General, United States Army*  
*The Adjutant General*

DISTRIBUTION:

To be distributed in accordance with DA Form 12-51 literature requirements for SG-1207/U.







